

STATE OF NEW MEXICO
OIL CONSERVATION
COMMISSION
DISTRICT NO. 3
Phone 99 P. O. Box 697
AZTEC, NEW MEXICO

(SUBMIT IN TRIPLICATE)
UNITED STATES
DEPARTMENT OF THE INTERIOR
GEOLOGICAL SURVEY

Santa Fe
Land Office 67019
Lease No. _____
Unit _____

SEP 14 1951
OIL CON. COM.
DIST. 3

SUNDRY NOTICES AND REPORTS ON WELLS

NOTICE OF INTENTION TO DRILL	SUBSEQUENT REPORT OF WATER SHUT-OFF
NOTICE OF INTENTION TO CHANGE PLANS	SUBSEQUENT REPORT OF SHOOTING OR ACIDIZING
NOTICE OF INTENTION TO TEST WATER SHUT-OFF	SUBSEQUENT REPORT OF ALTERING CASING
NOTICE OF INTENTION TO RE-DRILL OR REPAIR WELL	SUBSEQUENT REPORT OF REDRILLING OR REPAIR
NOTICE OF INTENTION TO SHOOT OR ACIDIZE	SUBSEQUENT REPORT OF ABANDONMENT
NOTICE OF INTENTION TO PULL OR ALTER CASING	SUPPLEMENTARY WELL HISTORY
NOTICE OF INTENTION TO ABANDON WELL	

(INDICATE ABOVE BY CHECK MARK NATURE OF REPORT, NOTICE, OR OTHER DATA)

September 12, 1951

51

19

19

Well No. Stewart 1-3 is located 1010 ft. from [N] line and 1090 ft. from [E] line of sec. 19
S. E. 1/4 Sec. 19 T-30-N R-10E NM PM
(1/4 Sec. and Sec. No.) (Twp.) (Range) (Meridian) New Mexico
Wildcat (Field) San Juan (County or Subdivision) (State or Territory)
(Will be furnished later.)

The elevation of the derrick floor above sea level is _____ ft.

DETAILS OF WORK

(State names of and expected depths to objective sands; show sizes, weights, and lengths of proposed casings; indicate mudding jobs, cement-
No propose to drill with rotary tools to the top of the Pictured Cliffs formation,
set 5 1/2" casing-then move in cable tools to drill in-then shoot with ANS, for gas
completion in Pictured Cliffs formation.

Formations

Casing Programs

120' of 9 5/8" surface casing-circulate cement to surface
2600' of 5 1/2" Production string.
2700' of 1" Siphon Line.

I understand that this plan of work must receive approval in writing by the Geological Survey before operations may be commenced.

Company Delhi Oil Corporation

Address P. O. Box 1175
Harrington, New Mexico

By [Signature]
Title Superintendent

DEPARTMENT OF THE INTERIOR
BUREAU OF LAND MANAGEMENT
WASHINGTON, D. C. 20090

[illegible]

SUNDREY, LINDA - TWO REPORTS ON WALLS

1. PRELIMINARY REPORT OF THE INVESTIGATOR

1. THE UNITED STATES OF AMERICA
2. DEPARTMENT OF COMMERCE
3. OFFICE OF THE SECRETARY
4. WASHINGTON, D. C.
5. RECEIVED
6. NOV 10 1964
7. FROM: [illegible]
8. SUBJECT: [illegible]
9. RE: [illegible]
10. DATE: [illegible]
11. BY: [illegible]
12. FOR: [illegible]
13. THROUGH: [illegible]
14. TO: [illegible]
15. FROM: [illegible]
16. SUBJECT: [illegible]
17. RE: [illegible]
18. DATE: [illegible]
19. BY: [illegible]
20. FOR: [illegible]
21. THROUGH: [illegible]
22. TO: [illegible]
23. FROM: [illegible]
24. SUBJECT: [illegible]
25. RE: [illegible]
26. DATE: [illegible]
27. BY: [illegible]
28. FOR: [illegible]
29. THROUGH: [illegible]
30. TO: [illegible]
31. FROM: [illegible]
32. SUBJECT: [illegible]
33. RE: [illegible]
34. DATE: [illegible]
35. BY: [illegible]
36. FOR: [illegible]
37. THROUGH: [illegible]
38. TO: [illegible]
39. FROM: [illegible]
40. SUBJECT: [illegible]
41. RE: [illegible]
42. DATE: [illegible]
43. BY: [illegible]
44. FOR: [illegible]
45. THROUGH: [illegible]
46. TO: [illegible]
47. FROM: [illegible]
48. SUBJECT: [illegible]
49. RE: [illegible]
50. DATE: [illegible]
51. BY: [illegible]
52. FOR: [illegible]
53. THROUGH: [illegible]
54. TO: [illegible]
55. FROM: [illegible]
56. SUBJECT: [illegible]
57. RE: [illegible]
58. DATE: [illegible]
59. BY: [illegible]
60. FOR: [illegible]
61. THROUGH: [illegible]
62. TO: [illegible]
63. FROM: [illegible]
64. SUBJECT: [illegible]
65. RE: [illegible]
66. DATE: [illegible]
67. BY: [illegible]
68. FOR: [illegible]
69. THROUGH: [illegible]
70. TO: [illegible]
71. FROM: [illegible]
72. SUBJECT: [illegible]
73. RE: [illegible]
74. DATE: [illegible]
75. BY: [illegible]
76. FOR: [illegible]
77. THROUGH: [illegible]
78. TO: [illegible]
79. FROM: [illegible]
80. SUBJECT: [illegible]
81. RE: [illegible]
82. DATE: [illegible]
83. BY: [illegible]
84. FOR: [illegible]
85. THROUGH: [illegible]
86. TO: [illegible]
87. FROM: [illegible]
88. SUBJECT: [illegible]
89. RE: [illegible]
90. DATE: [illegible]
91. BY: [illegible]
92. FOR: [illegible]
93. THROUGH: [illegible]
94. TO: [illegible]
95. FROM: [illegible]
96. SUBJECT: [illegible]
97. RE: [illegible]
98. DATE: [illegible]
99. BY: [illegible]
100. FOR: [illegible]
101. THROUGH: [illegible]
102. TO: [illegible]
103. FROM: [illegible]
104. SUBJECT: [illegible]
105. RE: [illegible]
106. DATE: [illegible]
107. BY: [illegible]
108. FOR: [illegible]
109. THROUGH: [illegible]
110. TO: [illegible]
111. FROM: [illegible]
112. SUBJECT: [illegible]
113. RE: [illegible]
114. DATE: [illegible]
115. BY: [illegible]
116. FOR: [illegible]
117. THROUGH: [illegible]
118. TO: [illegible]
119. FROM: [illegible]
120. SUBJECT: [illegible]
121. RE: [illegible]
122. DATE: [illegible]
123. BY: [illegible]
124. FOR: [illegible]
125. THROUGH: [illegible]
126. TO: [illegible]
127. FROM: [illegible]
128. SUBJECT: [illegible]
129. RE: [illegible]
130. DATE: [illegible]
131. BY: [illegible]
132. FOR: [illegible]
133. THROUGH: [illegible]
134. TO: [illegible]
135. FROM: [illegible]
136. SUBJECT: [illegible]
137. RE: [illegible]
138. DATE: [illegible]
139. BY: [illegible]
140. FOR: [illegible]
141. THROUGH: [illegible]
142. TO: [illegible]
143. FROM: [illegible]
144. SUBJECT: [illegible]
145. RE: [illegible]
146. DATE: [illegible]
147. BY: [illegible]
148. FOR: [illegible]
149. THROUGH: [illegible]
150. TO: [illegible]
151. FROM: [illegible]
152. SUBJECT: [illegible]
153. RE: [illegible]
154. DATE: [illegible]
155. BY: [illegible]
156. FOR: [illegible]
157. THROUGH: [illegible]
158. TO: [illegible]
159. FROM: [illegible]
160. SUBJECT: [illegible]
161. RE: [illegible]
162. DATE: [illegible]
163. BY: [illegible]
164. FOR: [illegible]
165. THROUGH: [illegible]
166. TO: [illegible]
167. FROM: [illegible]
168. SUBJECT: [illegible]
169. RE: [illegible]
170. DATE: [illegible]
171. BY: [illegible]
172. FOR: [illegible]
173. THROUGH: [illegible]
174. TO: [illegible]
175. FROM: [illegible]
176. SUBJECT: [illegible]
177. RE: [illegible]
178. DATE: [illegible]
179. BY: [illegible]
180. FOR: [illegible]
181. THROUGH: [illegible]
182. TO: [illegible]
183. FROM: [illegible]
184. SUBJECT: [illegible]
185. RE: [illegible]
186. DATE: [illegible]
187. BY: [illegible]
188. FOR: [illegible]
189. THROUGH: [illegible]
190. TO: [illegible]
191. FROM: [illegible]
192. SUBJECT: [illegible]
193. RE: [illegible]
194. DATE: [illegible]
195. BY: [illegible]
196. FOR: [illegible]
197. THROUGH: [illegible]
198. TO: [illegible]
199. FROM: [illegible]
200. SUBJECT: [illegible]
201. RE: [illegible]
202. DATE: [illegible]
203. BY: [illegible]
204. FOR: [illegible]
205. THROUGH: [illegible]
206. TO: [illegible]
207. FROM: [illegible]
208. SUBJECT: [illegible]
209. RE: [illegible]
210. DATE: [illegible]
211. BY: [illegible]
212. FOR: [illegible]
213. THROUGH: [illegible]
214. TO: [illegible]
215. FROM: [illegible]
216. SUBJECT: [illegible]
217. RE: [illegible]
218. DATE: [illegible]
219. BY: [illegible]
220. FOR: [illegible]
221. THROUGH: [illegible]
222. TO: [illegible]
223. FROM: [illegible]
224. SUBJECT: [illegible]
225. RE: [illegible]
226. DATE: [illegible]
227. BY: [illegible]
228. FOR: [illegible]
229. THROUGH: [illegible]
230. TO: [illegible]
231.

01

.....

(continued)

43. _____ is/are _____ in _____.

HOW TO GET IT

[illegible]

1. *Journal of the American Medical Association*, 1997; 277: 1033-1038.

[illegible]

Santa Fe
075196

Company Delhi Oil Corporation

Lease Stewart Well No. 1-3

Sec. 19 T. 30 N., R. 10 W., N.E.P.M.

Location 1040' from the South line and 1090'
from the East line.

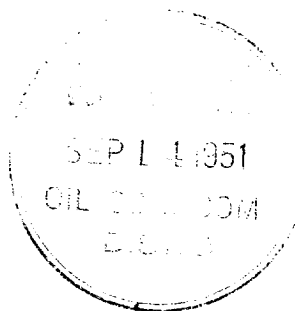

San Juan County

New Mexico

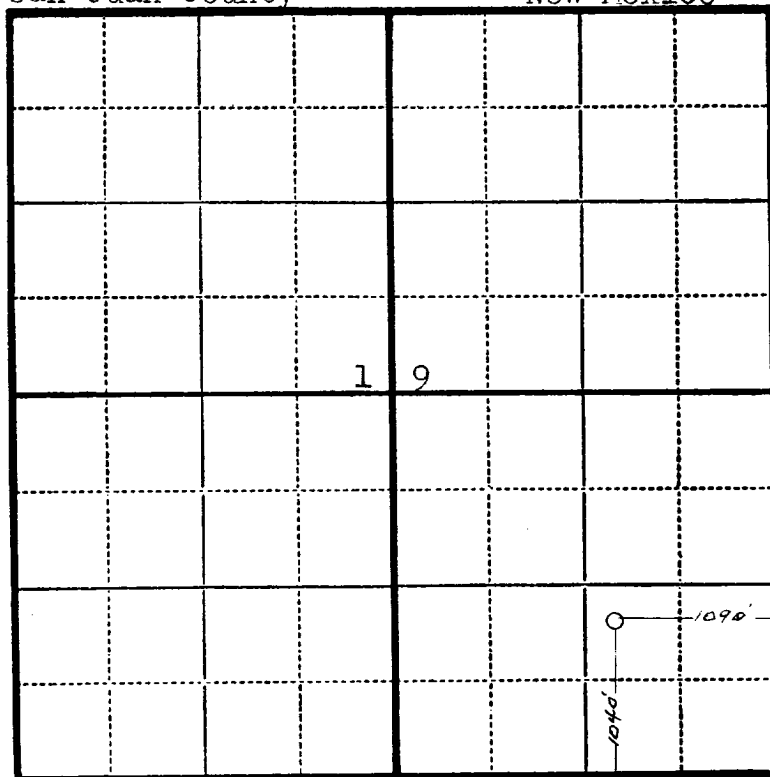

Scale—4 inches equals 1 mile.

This is to certify that the above plat was prepared from field notes of actual surveys made by me or under my supervision and that the same are true and correct to the best of my knowledge and belief.

Seal:

Registered Professional Charles J. Finklea
Engineer and Land Surveyor. N. Mex. Reg. No. 1302

Surveyed September 11, 1951