

NUMBER OF COPIES RECEIVED	
DISTRIBUTION	
SANTA FE	1
FILE	1
U.S.G.S.	2
LAND OFFICE	1
TRANSPORTER	
OIL GAS	
PROBATION OFFICE	
OPERATOR	1

NEW MEXICO OIL CONSERVATION COMMISSION
Santa Fe, New Mexico

Form C-101
Revised (12/1/55)

NOTICE OF INTENTION TO DRILL

Notice must be given to the District Office of the Oil Conservation Commission and approval obtained before drilling or recompletion begins. If changes in the proposed plan are considered advisable, a copy of this notice showing such changes will be returned to the sender. Submit this notice in QUINTUPLICATE. One copy will be returned following approval. See additional instructions in Rules and Regulations of the Commission.

If State Land submit 6 Copies Attach Form C-128 in triplicate to first 3 copies of form C-101

207 Petr. Club Plaza, Farmington, New Mexico

9/5/61

(Place)

(Date)

OIL CONSERVATION COMMISSION
SANTA FE, NEW MEXICO

6-OCC, 3-Tidewater, 1-NW, 1-Lien, 1-Texas Nat'l. 1-D, 1-F

Gentlemen:

You are hereby notified that it is our intention to commence the Drilling of a well to be known as
Southwest Production Company

(Company, or Operator)

Irene Brown

(Lease)

Well No. **1**, in **0** (Unit) The well is

located **990** feet from the **South** line and **1450** feet from the

East

line of Section **22**, T. **30N**, R. **12W**, NMPM.

(GIVE LOCATION FROM SECTION LINE)

Undes. Mesaverde

Pool,

San Juan

County

If State Land the Oil and Gas Lease is No.

If patented land the owner is.

Address.

We propose to drill well with drilling equipment as follows: **Rotary**

The status of plugging bond is **\$10,000.00 Blanket Bond in Effect**

Drilling Contractor **Aspen Drilling Company**

P. O. Box 2060

Farmington, New Mexico

We intend to complete this well in the **Mesaverde**

formation at an approximate depth of **3450** feet.

CASING PROGRAM

We propose to use the following strings of Casing and to cement them as indicated:

Size of Hole	Size of Casing	Weight per Foot	New or Second Hand	Depth	Sacks Cement
12 1/4"	9 5/8"	32.50#	New	300'	250
7 7/8"	4 1/2"	10.50#	New	Total Depth	300

If changes in the above plans become advisable we will notify you immediately.

ADDITIONAL INFORMATION (If recompletion give full details of proposed plan of work.)

A DW tool will be placed for the protection of the Pictured Cliffs formation.

Approved....., 19. **61**
Except as follows:

Sincerely yours,

Southwest Production Company

Original signed by (Company or Operator)

By..... **Carl W. Smith**

Position..... **Production Superintendent**

Name..... **Southwest Production Company**

Address..... **207 Petr. Club Plaza, Farmington, N. M.**

OIL CONSERVATION COMMISSION

By..... **Carl W. Smith**

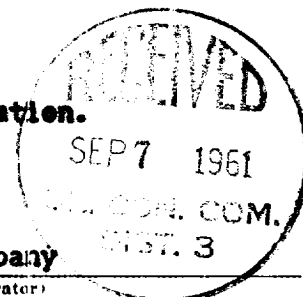

NEW MEXICO OIL CONSERVATION COMMISSION

Well Location and Acreage Dedication Plat

Section A.

Date 9/3/61

Operator SOUTHWEST PRODUCTION COMPANY Lease IRENE BROWN
 Well No. _____ Unit Letter 0 Section 22 Township 30 NORTH Range 12 WEST NMPM
 Located 990 Feet From THE SOUTH Line, 1450 Feet From THE EAST Line
 County SAN JUAN G. L. Elevation 5500.0 Dedicated Acreage E/320 Acres
 Name of Producing Formation MESAVERDE Pool UNDES. MESAVERDE

1. Is the Operator the only owner in the dedicated acreage outlined on the plat below?
 Yes ☒ No _____
2. If the answer to question one is "no", have the interests of all the owners been consolidated by communitization agreement or otherwise? Yes _____ No _____. If answer is "yes", Type of Consolidation.

3. If the answer to question two is "no", list all the owners and their respective interests below:

OwnerLand Description

Section B.

This is to certify that the information in Section A above is true and complete to the best of my knowledge and belief.

SOUTHWEST PRODUCTION CO.

(Operator) Original signed by
Carl W. Smith

(Representative)

207 Petr. Club Plaza

(Address)

Farmington, N. M.

Ref. GLO Plat dated: 7 April 1881

Note: All distances must be from outer boundaries of section.

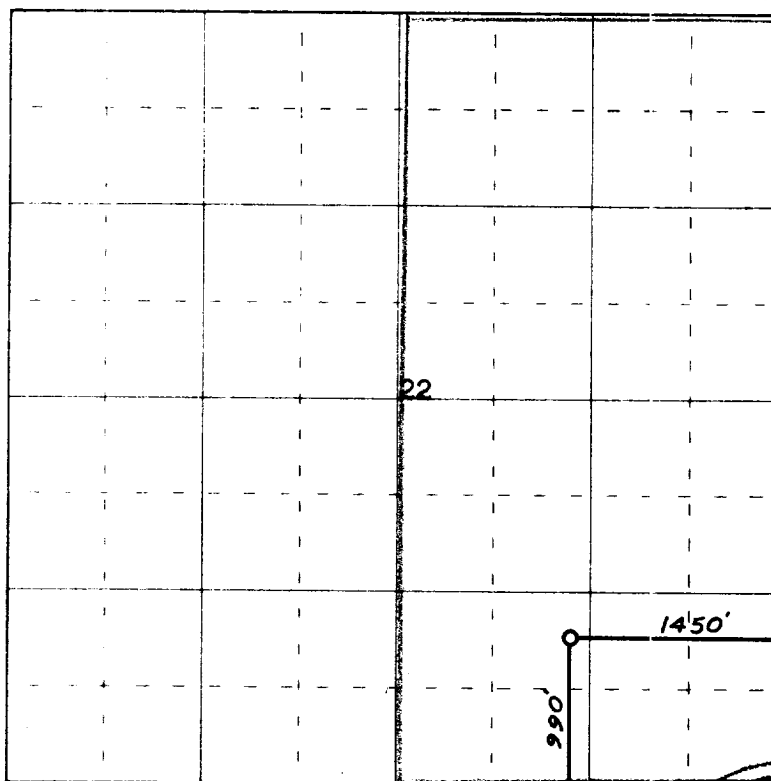

0 330 660 990 1320 1650 1980 2310 2640 2000 1500 1000 500

Scale 4 inches equal 1 mile

This is to certify that the above plat was prepared from field notes of actual surveys made by me or under my supervision and that the same are true and correct to the best of my knowledge and belief.

Date Surveyed August 3, 1961

James P. Lease
 Registered Professional Engineer and/or Land Surveyor
James P. Lease N. Mex. Reg. No. 1463

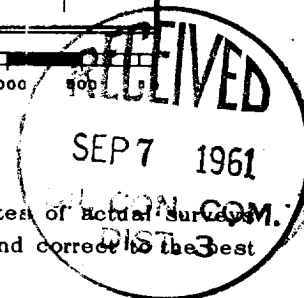

Well Location and Acreage Dedication Plat

Section A.

Date 9/1/61

Operator SOUTHWEST PRODUCTION COMPANY Lease IRENE BROWN
 Well No. 1 Unit Letter Q Section 22 Township 30 NORTH Range 12 WEST NMPM
 Located 990 Feet From THE SOUTH Line, 1450 Feet From THE EAST Line
 County SAN JUAN G. L. Elevation 5500.0 Dedicated Acreage SE 1/16 Acres
 Name of Producing Formation MESAVERDE Pool UNDES. MESAVERDE

1. Is the Operator the only owner in the dedicated acreage outlined on the plat below?

Yes X No

2. If the answer to question one is "no", have the interests of all the owners been consolidated by communitization agreement or otherwise? Yes No If answer is "yes", Type of Consolidation.

3. If the answer to question two is "no", list all the owners and their respective interests below.

Owner

Land Description



Section B.

Note: All distances must be from outer boundaries of section.

This is to certify that the information
 in Section A above is true and complete
 to the best of my knowledge and belief.

SOUTHWEST PRODUCTION CO.

(Operator)

Original signed by
Carl W. Smith

(Representative)

207 Petr. Club Plaza

(Address)

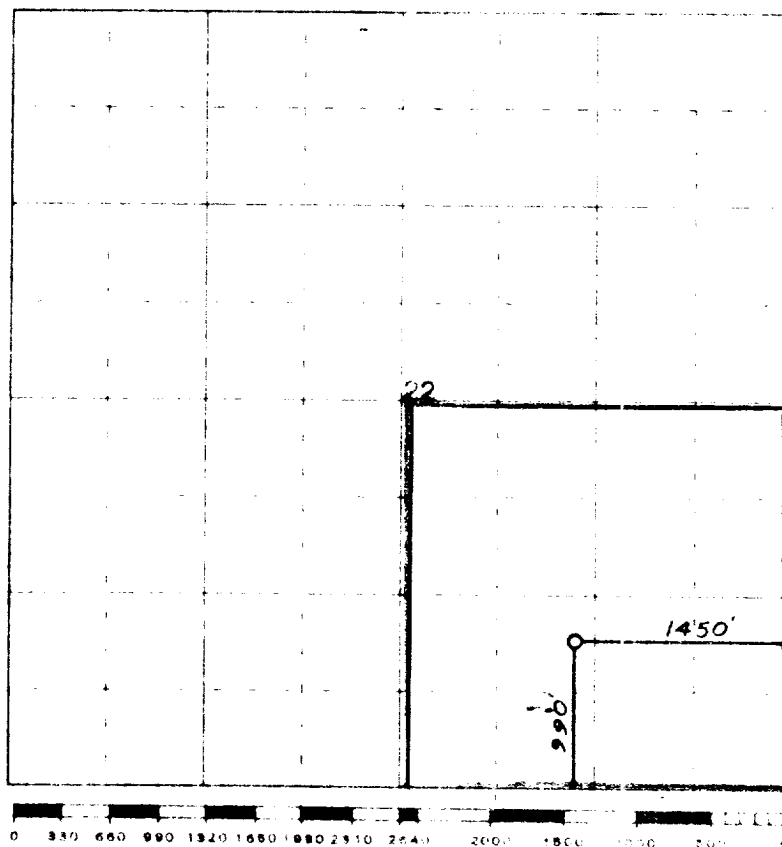
Farmington, N. M.

Scale 4 inches equal 1 mile

Ref. GLO Plat dated: 7 April 1881

This is to certify that the above plat was prepared from field notes of actual surveys
 made by me or under my supervision and that the same are true and correct to the best
 of my knowledge and belief.

Date Surveyed August 3, 1961

James P. Lease
 Registered Professional Engineer and a Land Surveyor
 James P. Lease N. Mex. Reg. No. 1163

