

(SUBMIT IN TRIPLICATE)

UNITED STATES  
DEPARTMENT OF THE INTERIOR  
GEOLOGICAL SURVEY

Indian Agency \_\_\_\_\_

Alottee \_\_\_\_\_

Lease No. **11-00-403-186**

\_\_\_\_\_

SUNDRY NOTICES AND REPORTS ON WELLS

NOTICE OF INTENTION TO DRILL	<input checked="" type="checkbox"/>	SUBSEQUENT REPORT OF WATER SHUT-OFF	
NOTICE OF INTENTION TO CHANGE PLANS		SUBSEQUENT REPORT OF SHOOTING OR ACIDIZING	
NOTICE OF INTENTION TO TEST WATER SHUT-OFF		SUBSEQUENT REPORT OF ALTERING CASING	
NOTICE OF INTENTION TO REDRILL OR REPAIR WELL		SUBSEQUENT REPORT OF REDRILLING OR REPAIR	
NOTICE OF INTENTION TO SHOOT OR ACIDIZE		SUBSEQUENT REPORT OF ABANDONMENT	
NOTICE OF INTENTION TO PULL OR ALTER CASING		SUPPLEMENTARY WELL HISTORY	
NOTICE OF INTENTION TO ABANDON WELL			

(INDICATE ABOVE BY CHECK MARK NATURE OF REPORT, NOTICE, OR OTHER DATA)

RECEIVED  
OCT 19 1961  
U. S. GEOLOGICAL SURVEY  
ARMINGTON, NEW MEXICO

October 16, 1961

Core Hole  
Well No. **23** is located **660** ft. from **S** line and **660** ft. from **W** line of sec. **23**  
**SW SW Section 23** **30N** **19W** **100TH**  
(4 Sec. and Sec. No.) (Twp.) (Range) (Meridian)  
**Willamette** **San Juan** **New Mexico**  
(Field) (County or Subdivision) (State or Territory)

The elevation of the derrick floor above sea level is \_\_\_\_\_ ft. **5021' Ungraded ground.**

DETAILS OF WORK

(State names of and expected depths to objective sands; show sizes, weights, and lengths of proposed casings; indicate mudding jobs, cementing points, and all other important proposed work)

Rotary drilling equipment will be used to drill to approximately 235' to the Samaroo Formation. If production is found, casing will be set and cemented with required amount of cement. Native mud and water will be used in drilling. Shows will be tested and electric logs will be run prior to setting casing or abandonment. Stimulation treatments may be employed in completion.

I understand that this plan of work must receive approval in writing by the Geological Survey before operations may be commenced.

Company **Humble Oil & Refining Company**  
Address **P. O. Box 3082,**  
**Durango, Colorado**



By **COPY (ORIGINAL SIGNED) B. M. BRADLEY**  
**B. M. Bradley**  
Title **Dist. Supt.**

NUMBER OF COPIES RECEIVED	
DISTRIBUTION	
SANTA FE	
FILE	
U.S.G.S.	
LAND OFFICE	
TRANSPORTER	OIL GAS
PRORATION OFFICE	
OPERATOR	

**NEW MEXICO OIL CONSERVATION COMMISSION**  
**WELL LOCATION AND ACREAGE DEDICATION PLAT**  
 SEE INSTRUCTIONS FOR COMPLETING THIS FORM ON THE REVERSE SIDE

FORM C-128  
 Revised 5/1/57

**SECTION A**

Operator <b>Humble Oil &amp; Refining Company</b>			Lease <b>Core Hole</b>		Well No. <b>28</b>
Unit Letter <b>M</b>	Section <b>23</b>	Township <b>30 N</b>	Range <b>19 W</b>	County <b>San Juan</b>	
Actual Footage Location of Well: <b>660</b> feet from the <b>South</b> line and <b>660</b> feet from the <b>West</b> line					
Ground Level Elev. <b>5017'</b>	Producing Formation		Pool <b>Wildcat</b>	Dedicated Acreage: Acres	

1. Is the Operator the only owner in the dedicated acreage outlined on the plat below? YES ☒ NO \_\_\_\_ . ("Owner" means the person who has the right to drill into and to produce from any pool and to appropriate the production either for himself or for himself and another. (65-3-29 (e) NMSA 1935 Comp.)
2. If the answer to question one is "no," have the interests of all the owners been consolidated by communitization agreement or otherwise? YES \_\_\_\_ NO \_\_\_\_ . If answer is "yes," Type of Consolidation \_\_\_\_\_
3. If the answer to question two is "no," list all the owners and their respective interests below:

Owner	Land Description

**SECTION B**

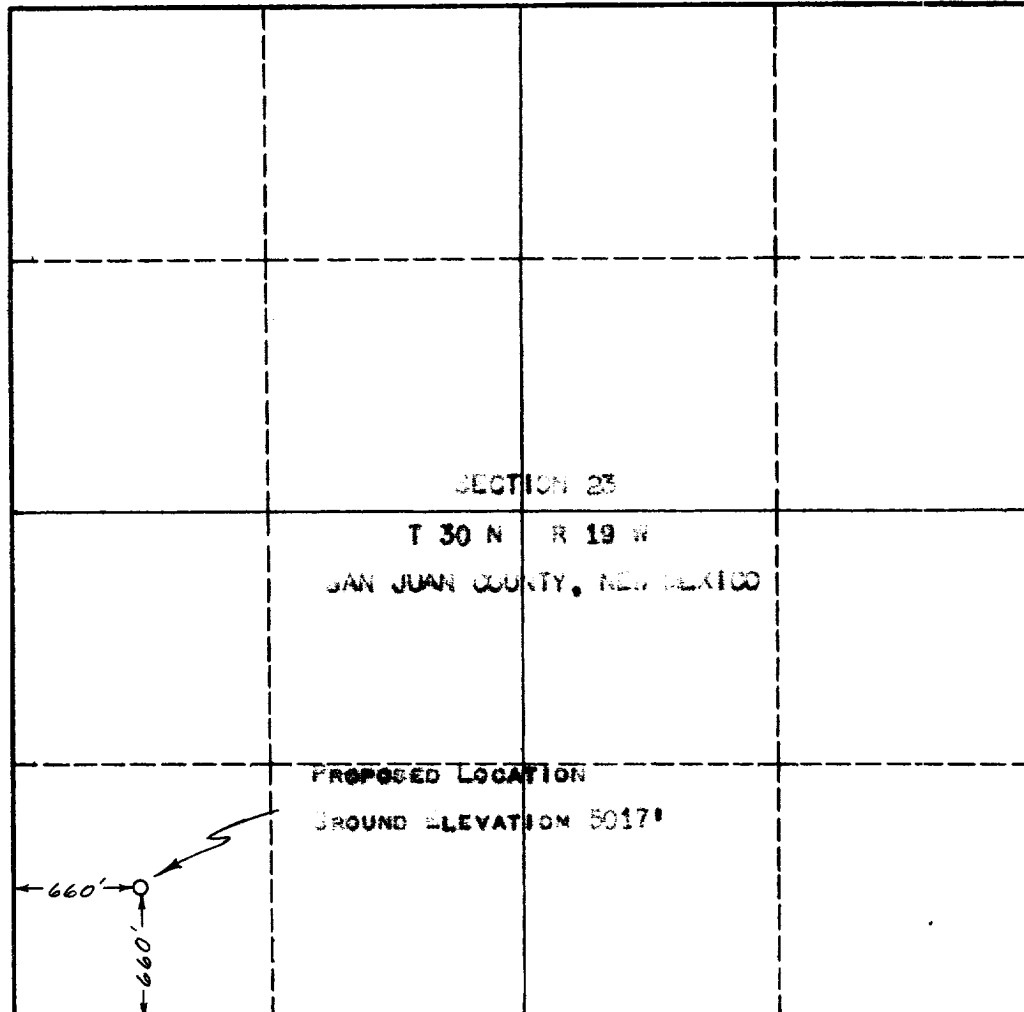

**RECEIVED**  
**OCT 20 1961**

**OIL CONSERVATION**  
**DIST. 3**

I hereby certify that the information in SECTION A above is true and complete to the best of my knowledge and belief.

**COPY (ORIGINAL SIGNED) B. M. BRADLEY**

Position **B. M. Bradley**  
**Dist. Supt.**

Company  
**Humble Oil & Refining Co.**

Date  
**October 16, 1961**

I hereby certify that the well location shown on the plat in SECTION B was plotted from field notes of actual surveys made by me or under my supervision, and that the same is true and correct to the best of my knowledge and belief.

Date Surveyed  
**October 13, 1961**

Registered Professional Engineer  
 and/or Land Surveyor

*Thomas M. Clark*  
 Certificate No. **3189**

## INSTRUCTIONS FOR COMPLETION OF FORM C-128

1. Operator shall furnish and certify to the information called for in Section A.
2. Operator shall outline the dedicated acreage for *both* oil and gas wells on the plat in Section B.
3. A registered professional engineer or land surveyor registered in the State of New Mexico or approved by the Commission shall show on the plat the location of the well and certify this information in the space provided.
4. All distances shown on the plat must be from the outer boundaries of the Section.
5. If additional space is needed for listing owners and their respective interests as required in question 3 of Section A, please use space below.