

(SUBMIT IN TRIPLICATE)

UNITED STATES
DEPARTMENT OF THE INTERIOR
GEOLOGICAL SURVEY

Land Office Santa Fe

Lease No. SF 078213

W/2, Sec. 23, T-30N,
R-13W, N.M.P.M., San Juan
Cty., New Mexico

SUNDRY NOTICES AND REPORTS ON WELLS

NOTICE OF INTENTION TO DRILL	<input checked="" type="checkbox"/>	SUBSEQUENT REPORT OF WATER SHUT-OFF	
NOTICE OF INTENTION TO CHANGE PLANS		SUBSEQUENT REPORT OF SHOOTING OR ACIDIZING	
NOTICE OF INTENTION TO TEST WATER SHUT-OFF		SUBSEQUENT REPORT OF ALTERING CASING	
NOTICE OF INTENTION TO RE-DRILL OR REPAIR WELL		SUBSEQUENT REPORT OF RE-DRILLING OR REPAIR	
NOTICE OF INTENTION TO SHOOT OR ACIDIZE		SUBSEQUENT REPORT OF ABANDONMENT	
NOTICE OF INTENTION TO PULL OR ALTER CASING		SUPPLEMENTARY WELL HISTORY	
NOTICE OF INTENTION TO ABANDON WELL			

(INDICATE ABOVE BY CHECK MARK NATURE OF REPORT, NOTICE, OR OTHER DATA)

December 3, 1962

Well No. 1-B/ McCord is located 1175 ft. from S line and 1140 ft. from W line of sec. 23
SW SW Sec. 23 30-N 13-W N.M.P.M.
(1/4 Sec. and Sec. No.) (Twp.) (Range) (Meridian)
Basin Dakota San Juan New Mexico
(Field) (County or Subdivision) (State or Territory)

The elevation of the derrick floor above sea level is 5767 ft. G.L.

DETAILS OF WORK

(State names of and expected depths to objective sands; show sizes, weights, and lengths of proposed casings; indicate mudding jobs, cementing points, and all other important proposed work)

1. The objective sand is the Dakota anticipated at 6320 ft.
2. Proposed casing program: 250', 8-5/8", 24.00#, J-55 cemented to surface.
6570', 4-1/2", 10.50#, J-55 cemented w/250 sacks.
3. Rotary tools will be employed from surface to Est. T.D. of 6570'.
4. Well will be Sand Fraced in an effort to stimulate production.

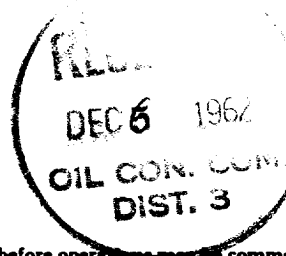

I understand that this plan of work must receive approval in writing by the Geological Survey before operations may be commenced.

Company SOUTHERN UNION PRODUCTION COMPANY

Address P. O. Box 808
Farmington, New Mexico

By L. S. Muennink
Title Area Superintendent

NEW MEXICO OIL CONSERVATION COMMISSION

Well Location and Acreage Dedication Plat

Section A.

Date December 3, 1962

Operator SOUTHERN UNION PRODUCTION COMPANY Lease McCord
 Well No. 1-B Unit Letter M Section 23 Township 30 NORTH Range 13 WEST NMPM
 Located 1175 Feet From the SOUTH Line, 1140 Feet From the WEST Line
 County SAN JUAN G. L. Elevation 5767.0' Dedicated Acreage 320 Acres
 Name of Producing Formation Dakota Pool Basin Dakota

1. Is the Operator the only owner in the dedicated acreage outlined on the plat below?
 Yes _____ No XX
2. If the answer to question one is "no", have the interests of all the owners been consolidated by communitization agreement or otherwise? Yes XX No _____. If answer is "yes", Type of Consolidation.
Communitization Agreement
3. If the answer to question two is "no", list all the owners and their respective interests below:

Owner

Land Description

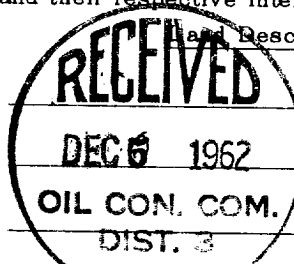

RECEIVED
 DEC 6 1962

U. S. GEOLOGICAL SURVEY
 FARMINGTON, NEW MEXICO

Section B.

Note: All distances must be from outer boundaries of section.

This is to certify that the information in Section A above is true and complete to the best of my knowledge and belief.

Southern Union Production Company

(Operator)

L. S. Muennink

(Representative)

Area Superintendent

(Address)

P. O. Box 808

Farmington, New Mexico

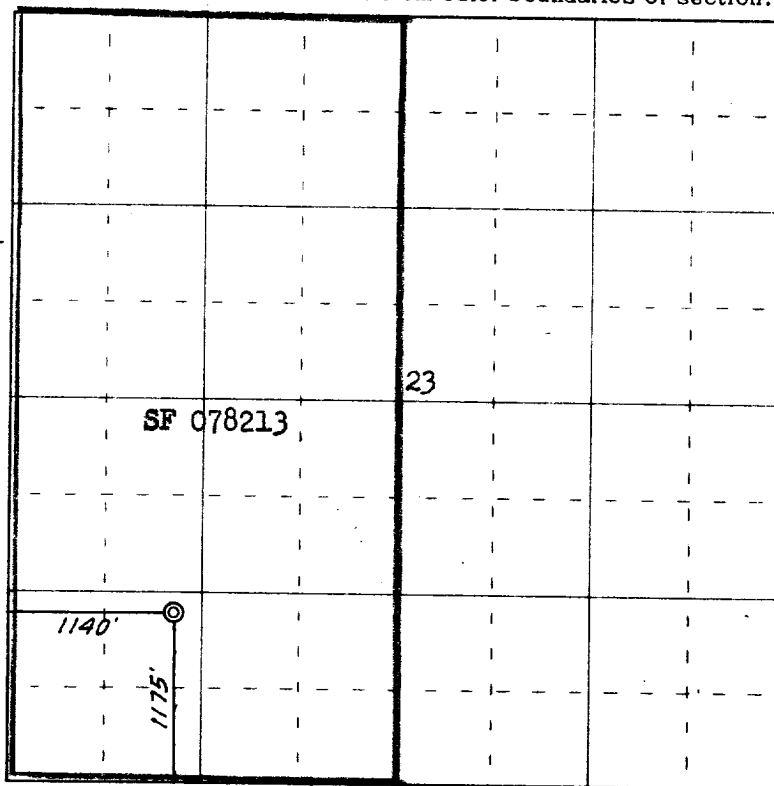

0 330 660 990 1320 1650 1980 2310 2640 2000 1500 1000 500 0

Scale 4 inches equal 1 mile

Ref: BLM plat dated 12 May 1955

This is to certify that the above plat was prepared from field notes of actual surveys made by me or under my supervision and that the same are true and correct to the best of my knowledge and belief.

Date Surveyed 1 December 1962

James P. Leese
 Registered Professional Engineer and/or Land Surveyor
 James P. Leese, N. Mex. Reg. No. 1463

Farmington, New Mexico