

APPROVED

Budget Bureau No. 42-R358.4.
Approval expires 12-31-60.

FEB	2	1959
JERRY W. LONG		
ACTING DISTRICT ENGINEER		

(SUBMIT IN TRIPLICATE)

UNITED STATES
DEPARTMENT OF THE INTERIOR
GEOLOGICAL SURVEY

Land Office Santa Fe
Lease No. SF 081231-B
Unit

SUNDRY NOTICES AND REPORTS ON WELLS

NOTICE OF INTENTION TO DRILL	<input checked="" type="checkbox"/>	SUBSEQUENT REPORT OF WATER SHUT-OFF	
NOTICE OF INTENTION TO CHANGE PLANS		SUBSEQUENT REPORT OF SHOOTING OR ACIDIZING	
NOTICE OF INTENTION TO TEST WATER SHUT-OFF		SUBSEQUENT REPORT OF ALTERING CASING	
NOTICE OF INTENTION TO RE-DRILL OR REPAIR WELL		SUBSEQUENT REPORT OF RE-DRILLING OR REPAIR	
NOTICE OF INTENTION TO SHOOT OR ACIDIZE		SUBSEQUENT REPORT OF ABANDONMENT	
NOTICE OF INTENTION TO PULL OR ALTER CASING		SUPPLEMENTARY WELL HISTORY	
NOTICE OF INTENTION TO ABANDON WELL			

(INDICATE ABOVE BY CHECK MARK NATURE OF REPORT, NOTICE, OR OTHER DATA)

U.S.A. Carpenter

21 January, 1959

Well No. 24-1 is located 1160 ft. from ☒ line and 1180 ft. from ☒ line of sec. 24

SW¹ SW¹ Sec 24 30 N 14 W, N.M.P.M.
(1/4 Sec. and Sec. No.) (Twp.) (Range) (Meridian)

wildcat - ground level San Juan Co. New Mexico
(Field) (County or Subdivision) (State or Territory)

The elevation of the derrick floor above sea level is 5694 ft.

DETAILS OF WORK

(State names of and expected depths to objective sands; show sizes, weights, and lengths of proposed casings; indicate mudlogging jobs, cementing points, and all other important proposed work)

11" surface hole to 90 feet. 90 feet of 3-5/8" used 24# csg. 90' with 12# sax.

7-7/8" hole to total depth. Gel mud to be used. Blow-out preventer to be used.

Production casing to be 5", cemented back above Ojo Alamo (water) sand.

App. as a Pictured Cliffs test

I understand that this plan of work must receive approval in writing by the Geological Survey before operations may be commenced.

Company Henry S. Birdseye Operating Account

Address P. O. Box 8294

Albuquerque, N. M.

By Henry S. Birdseye
Title Operator

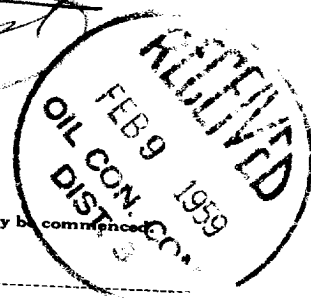

NEW MEXICO OIL CONSERVATION COMMISSION

Well Location and Acreage Dedication Plat

Section A.

Date 21 January, 1959

Operator Henry S. Birdseye Lease SF 081231-B
Well No. 24-1 Unit Letter M Section 24 Township 30 North Range 14 West NMPM
Located 1160 Feet From South Line 1180 Feet From West Line
County San Juan G. L. Elevation 5684 Dedicated Acreage 150 Acres
Name of Producing Formation Pictured Cliffs Pool wildcat

1. Is the Operator the only owner* in the dedicated acreage outlined on the plat below?
Yes x No
2. If the answer to question one is "no," have the interests of all the owners been consolidated by communitization agreement or otherwise? Yes No . If answer is "yes,"
Type of Consolidation
3. If the answer to question two is "no," list all the owners and their respective interests below:

Owner

Land Description

Section. B

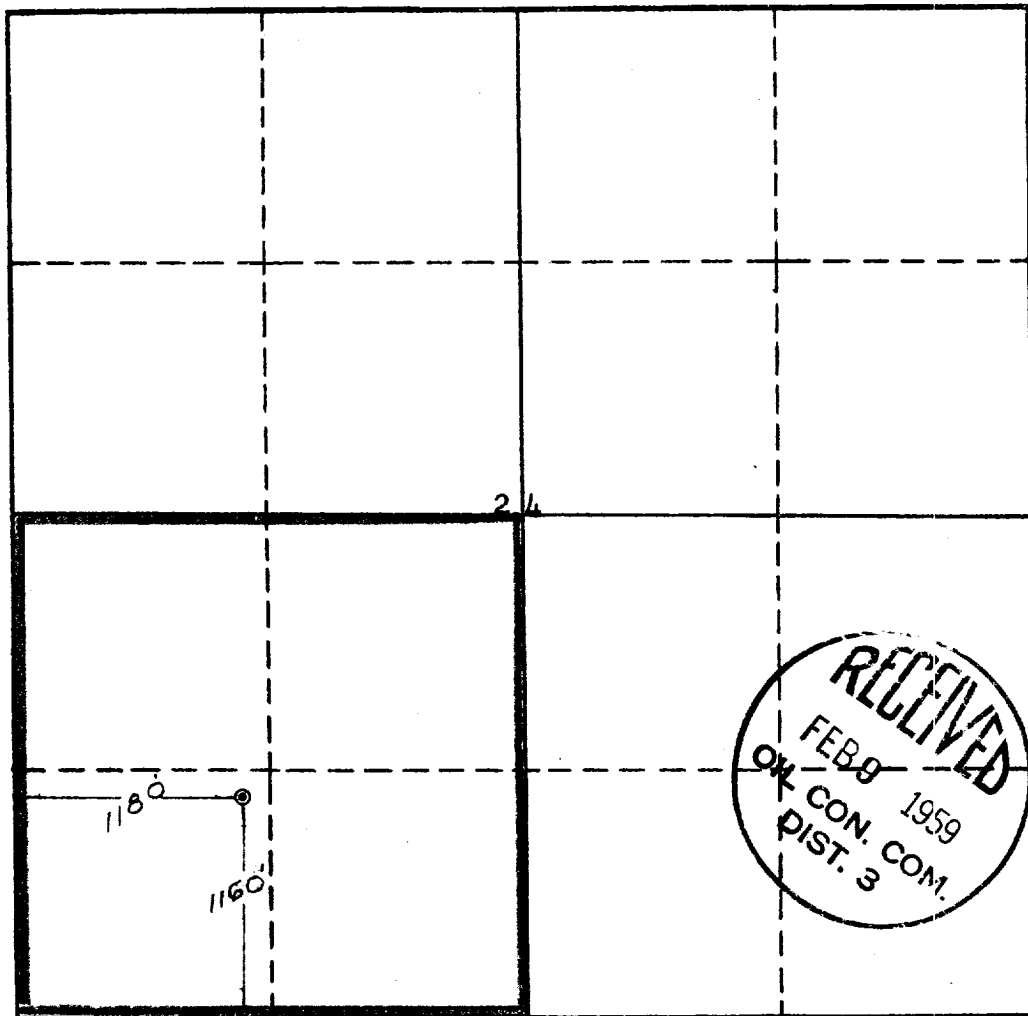

This is to certify that the information in Section A above is true and complete to the best of my knowledge and belief.

Henry S. Birdseye
(Operator)

Henry S. Birdseye
Consulting Geologist
P. O. Box 8294
Albuquerque, N. M.

Address

This is to certify that the well location shown on the plat in Section B was plotted from field notes of actual surveys made by me or under my supervision and the same is true and correct to the best of my knowledge and belief.

Date Surveyed Jan. 21, 1959

Ernest V. Echshaw
Ernest V. Echshaw
Registered Land Surveyor.

Certificate No. 1545