

P. O. Box 965  
Farmington, New Mexico

July 24, 1956

Stanolind Oil & Gas Company  
Box 487  
Farmington, New Mexico

RE: New Mexico Oil 443-B

Gentlemen:

Receipt is acknowledged of your "Notice of Intention to Drill" dated July 23, 1956 covering your well No. 1 O. J. Hoover "A" in sec. 23, T. 30 N., R. 16 W., N. M. P. M., San Juan County, New Mexico, Wildcat pool.

Your proposed work is hereby approved subject to compliance with the provisions of the "Oil and Gas Operating Regulations" revised May 25, 1942, a copy of which will be sent to you on request, and subject to the following conditions:

1. Drilling operations so authorized are subject to the attached sheet for general conditions of approval.
2. Furnish copies of all logs.

Very truly yours,

(SIGNED)

P. T. McGrath  
District Engineer

PTMcGrath:al

COPY TO O. C. C.

COBY TO O O

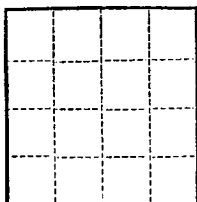

(SUBMIT IN TRIPLICATE)

UNITED STATES  
DEPARTMENT OF THE INTERIOR  
GEOLOGICAL SURVEYLand Office New Mexico  
Lease No. 0443-B  
Unit O. J. Hoover "A"

## SUNDRY NOTICES AND REPORTS ON WELLS

NOTICE OF INTENTION TO DRILL.....	<input checked="" type="checkbox"/>	SUBSEQUENT REPORT OF WATER SHUT-OFF.....
NOTICE OF INTENTION TO CHANGE PLANS.....		SUBSEQUENT REPORT OF SHOOTING OR ACIDIZING.....
NOTICE OF INTENTION TO TEST WATER SHUT-OFF.....		SUBSEQUENT REPORT OF ALTERING CASING.....
NOTICE OF INTENTION TO RE-DRILL OR REPAIR WELL.....		SUBSEQUENT REPORT OF RE-DRILLING OF WELL.....
NOTICE OF INTENTION TO SHOOT OR ACIDIZE.....		SUBSEQUENT REPORT OF ABANDONMENT.....
NOTICE OF INTENTION TO PULL OR ALTER CASING.....		SUPPLEMENTARY WELL HISTORY.....
NOTICE OF INTENTION TO ABANDON WELL.....		

RECEIVED  
JUL 21 1956  
U. S. GEOLOGICAL SURVEY  
FARMINGTON, NEW MEXICO

(INDICATE ABOVE BY CHECK MARK NATURE OF REPORT, NOTICE, OR OTHER DATA)

Farmington, New MexicoJuly 23, 1956

Well No. 1 is located 1780 ft. from S line and 913 ft. from W line of sec. 23  
SW/4 of Section 23 T-30-N R-16-W N.M.P.M.  
(1/4 Sec. and Sec. No.) (Twp.) (Range) (Meridian)  
Wildcat San Juan New Mexico  
(Field) (County or Subdivision) (State or Territory)

The elevation of the derrick floor above sea level is ..... ft. to be reported later.

## DETAILS OF WORK

(State names of and expected depths to objective sands; show sizes, weights, and lengths of proposed casings; indicate mudding jobs, cementing points, and all other important proposed work)

We propose to drill the above well to approximately 11,500'. Rotary tools will be used to total depth. Anticipate production from the Pre-Cambrian formation. Stimulation and completion will be as indicated upon reaching this formation.

The following casing program is proposed:

Size	Depth	Cement	Remarks
13-3/8"	500'	200 sx.	200% theoretical amount to fill
9-5/8"	5590'	460 sx. 8% gel w/1# TufPlug per sx. 100 sx neat to btm.	150% theoretical fill.
7"	8780'	200 sx. 8% gel w/1# TufPlug per sx.	150% theoretical fill.
5"	8600' to TD Liner	Cement from TD to Liner Hanger	

(over)

I understand that this plan of work must receive approval in writing by the Geological Survey before operations may be commenced.

Company Stanolind Oil & Gas Company  
Address Box 487  
Farmington, N. Mex.

By L. O. J. Hoover, Jr.  
Title Field Superintendent

100' Diamond Core from 3550' to 3650' Gallup Sand.  
Copies of location plat are attached. A copy of any survey taken will be  
submitted upon completion of well.

NEW MEXICO  
OIL CONSERVATION COMMISSION

Form C-128

WELL LOCATION AND/OR GAS PRORATION PLAT

DATE July 14, 1956

OPERATOR Standard Oil & Gas Co. LEASE U.S.A. - G.J. Meyer

WELL NO. 4-20-1 SECTION 23 TOWNSHIP 20 North RANGE 26 West NMPM

LOCATED 1720 FEET FROM South LINE 913 FEET FROM West LINE

COUNTY, NEW MEXICO Santa Fe S.L. ELEVATION 8250 FEET

NAME OF PRODUCING FORMATION Wilcox POOL Wilcox DEDICATED ACREAGE 2.00

Note: All distances must be from outer boundaries of section.

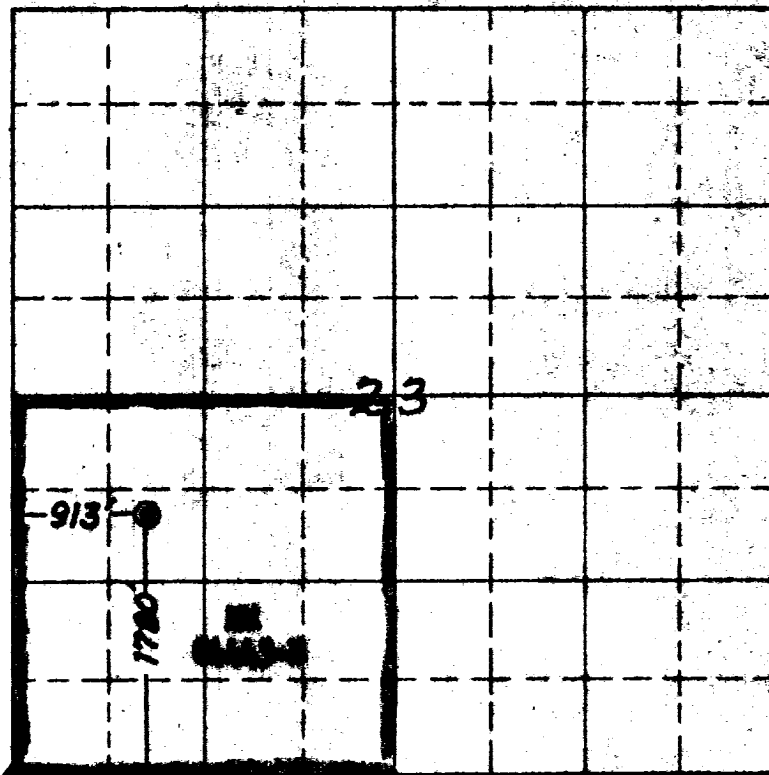

Marked Stone

Scale 4 inches equal 1 mile

RECEIVED  
JUL 24 1956  
U.S. GEOLOGICAL SURVEY  
FARMINGTON, NEW MEXICO

NOTE

This section of form is to be used for gas wells only.

This is to certify that the above plat was prepared from field notes of actual surveys made by me or under my supervision and that the same are true and correct to the best of my knowledge and belief.

Date Surveyed July 14, 1956

Charles J. Pittman  
Registered Professional Engineer and/or Land Surveyor

Charles J. Pittman  
Reg. No. 1902 New Mexico.

1. Is this well a Dual Comp.  
Yes \_\_\_\_\_ No Yes

2. If the answer to Question 1 is yes, are there any otherdualy completed wells within the dedicated acreage.

Yes \_\_\_\_\_ No \_\_\_\_\_

Name R. H. Meyer, Jr.

Position State Engineer

Representing Standard Oil & Gas Co.

Address Box 607, Farmington, N. M.