

(SUBMIT IN TRIPLICATE)

UNITED STATES
DEPARTMENT OF THE INTERIOR
GEOLOGICAL SURVEY

Indian Agency

14-30-403-2051

Allottee

Lease No.

SUNDRY NOTICES AND REPORTS ON WELLS

| | | | |
|---|--|--|--|
| NOTICE OF INTENTION TO DRILL | | SUBSEQUENT REPORT OF WATER SHUT-OFF | |
| NOTICE OF INTENTION TO CHANGE PLANS | | SUBSEQUENT REPORT OF SHOOTING OR ACIDIZING | |
| NOTICE OF INTENTION TO TEST WATER SHUT-OFF | | SUBSEQUENT REPORT OF ALTERING CASING | |
| NOTICE OF INTENTION TO REDRILL OR REPAIR WELL | | SUBSEQUENT REPORT OF REDRILLING OR REPAIR | |
| NOTICE OF INTENTION TO SHOOT OR ACIDIZE | | SUBSEQUENT REPORT OF ABANDONMENT | |
| NOTICE OF INTENTION TO PULL OR ALTER CASING | | SUPPLEMENTARY WELL HISTORY | |
| NOTICE OF INTENTION TO ABANDON WELL | | | |

(INDICATE ABOVE BY CHECK MARK NATURE OF REPORT, NOTICE, OR OTHER DATA)

Navajo "K" No. 2
C NY 85 Sec 20

December 3, 1957

Well No. "K" 2 is located 1900 ft. from ~~24~~ S line and 1900 ft. from ~~24~~ E line of sec. 20
22 1/4 Sec 20 30 North 15 East 10W
(1/4 Sec. and Sec. No.) (Twp.) (Range) (Meridian)
Wildcat San Juan New Mexico
(Field) (County or Subdivision) (State or Territory)

The elevation of the derrick floor above sea level is 5337 ft.

DETAILS OF WORK

(State names of and expected depths to objective sands; show sizes, weights, and lengths of proposed casings; indicate mudding jobs, cementing points, and all other important proposed work)

Surface casing of 20 feet 10 3/4" with 20 notch cement.

Test will be drilled to the Gallup sand to approximately 1000 feet.

If production is encountered 5 1/2 inch pipe will be run thru the pay, pipe cemented thru the pay section and above, perforated and fraced.

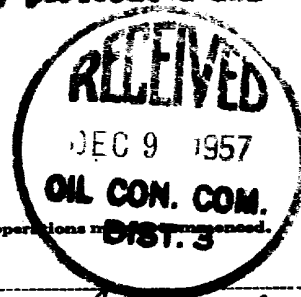

I understand that this plan of work must receive approval in writing by the Geological Survey before operations are commenced.

Company King Oil Company

Address 610 Patterson Bldg.
Denver 2, ColoradoBy W. C. Jaulander
Tilden G. Jaulander
Petroleum Geologist
Title 3019 Monte Vista St.
Albuquerque, NM

NEW MEXICO OIL CONSERVATION COMMISSION
Well Location and Acreage Dedication Plat

Section A.

Date _____

Operator KING OIL COMPANY Lease NAVAJO "K"
Well No. 2 Unit Letter J Section 20 Township 30 NORTH Range 16 WEST, NMPM
Located 1980 Feet From the SOUTH Line, 1980 Feet From the EAST Line
County SAN JUAN G. L. Elevation 5386.6 Dedicated Acreage 40 Acres
Name of Producing Formation _____ Pool _____

1. Is the Operator the only owner* in the dedicated acreage outlined on the plat below?
Yes ☒ No ☐.
2. If the answer to question one is "no," have the interests of all the owners been consolidated by communitization agreement or otherwise? Yes ☐ No ☐. If answer is "yes," Type of Consolidation _____
3. If the answer to question two is "no," list all the owners and their respective interests below:
Ref: GLO plat dated 24 May 1928

Owner

Land Description

Section B

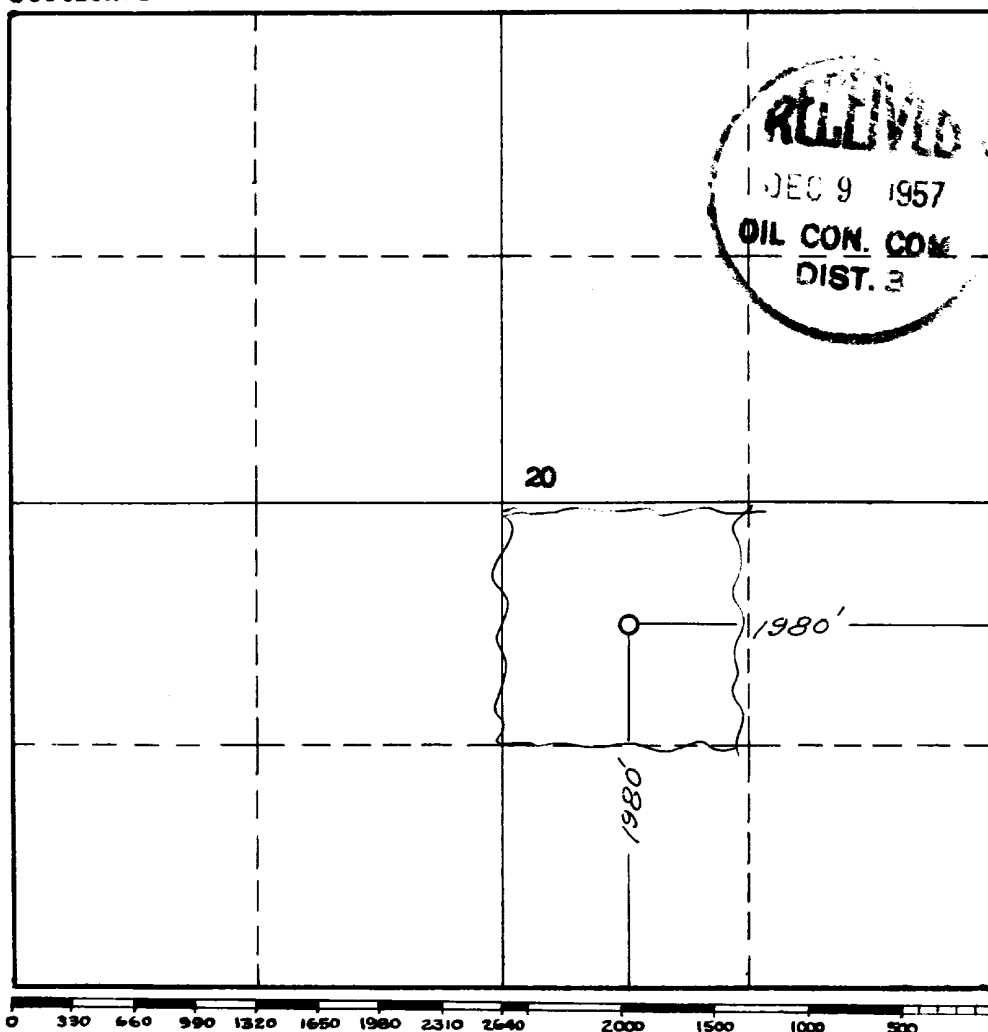

This is to certify that the information in Section A above is true and complete to the best of my knowledge and belief.

King Oil Co.
(Operator)
610 Patterson Bldg
(Representative)
Denver 2 Colo
Address

W. C. Anderson
Petroleum Geol
This is to certify that the well location shown on the plat in Section B was plotted from field notes of actual surveys made by me or under my supervision and that the same is true and correct to the best of my knowledge and belief.

Date Surveyed 16 November 1957

James P. Reese
Registered Professional
Engineer and/or Land Surveyor.
James P. Reese

Certificate No. 1463

(See instructions for completing this form on the reverse side)

INSTRUCTIONS FOR COMPLETION:

1. Operator shall furnish and certify to the information called for in Section A.
2. Operator shall outline the dedicated acreage for both oil and gas wells on the plat in Section B.
3. A registered professional engineer or land surveyor registered in the State of New Mexico or approved by the Commission shall show on the plat the location of the well and certify this information in the space provided.
4. All distances shown on the plat must be from the outer boundaries of Section.
5. If additional space is needed for listing owners and their respective interests as required in question 3, Section A, please use space below

* "Owner" means the person who has the right to drill into and to produce from any pool and to appropriate the production either for himself or for himself and another. (65-3-29 (e) NMSA 1953 Comp.)