

NEW MEXICO OIL CONSERVATION COMMISSION

Santa Fe, New Mexico

NOTICE OF INTENTION TO DRILL

Notice must be given to the Oil Conservation Commission or its proper agent and approval obtained before drilling begins. If changes in the proposed plan are considered advisable, a copy of this notice showing such changes will be returned to the sender. Submit this notice in triplicate. One copy will be returned following approval. See additional instructions in Rules and Regulations of the Commission.

Farmington, New Mexico

Dec. 8, 1952

Place

Date

OIL CONSERVATION COMMISSION,
Santa Fe, New Mexico,

Gentlemen:

You are hereby notified that it is our intention to commence the drilling of a well to be known as _____

JOHN G. POLOKOFF - BLANCETT
Company or Operator

Well No. 1 in NE $\frac{1}{4}$

of Sec. 24, T. 30 N, R. 12 W, N. M. P. M., Aztec Field, San Juan County.

N

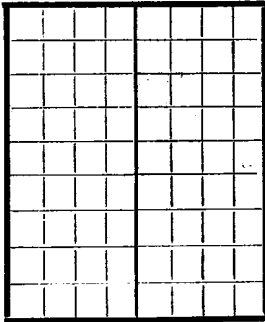

AREA 640 ACRES

LOCATE WELL CORRECTLY

The well is 1750 feet (N) (S.) of the N line and 940 feet (E) (W.) of the E line of NE $\frac{1}{4}$, Sec. 24, Twp. 30 N, R. 12 W, N.M.P.M.

(Give location from section or other legal subdivision lines. Cross out wrong directions.)

If state land the oil and gas lease is No. _____ Assignment No. _____

If patented land the owner is Marcellus Blancett, et al

Address Aztec, New Mexico

If government land the permittee is _____

Address _____

The lessee is John G. Polokoff, dba Franklin Steel Products

Address 5725 Broadway, Los Angeles, California

We propose to drill well with drilling equipment as follows: rotary

The status of a bond for this well in conformance with Rule 39 of the General Rules and Regulations of the Commission is as follows: \$10,000 blanket bond filed in the office of the Commission

We propose to use the following strings of casing and to land or cement them as indicated:

Size of Hole	Size of Casing	Weight Per Foot	New or Second Hand	Depth	Landed or Cemented	Sacks Cement
8 5/8"	6 5/8"	20 lb.	second hand	2,000 ft.	cemented	200

If changes in the above plan become advisable we will notify you before cementing or landing casing. We estimate that the first productive oil or gas sand should occur at a depth of about 1,950 feet.

Additional information: Will test Pictured Cliffs formation and if production is indicated, shoot section with approximately 3 qts. per foot of Solidified Nitro-gel.

Approved Dec 8, 19 52

except as follows:

Sincerely yours,

John G. Polokoff, dba Franklin Steel
Company or Operator Products

By John G. Polokoff
Position Lessee, Sole Operator

Send communications regarding well to

Name John G. Polokoff

Address 5725 Broadway, Los Angeles, California

OIL CONSERVATION COMMISSION,

By Emery C. Arnold
Title Oil and Gas Inspector Dist. #3.



Well Elevation Survey

Company Franklin Steel Products

Lease _____ Well No. _____

Sec. 24 T. 30 N., R. 12 W., N.M.P.M.

Location 1750' from the North line and 940' from the East line.

San Juan County

New Mexico

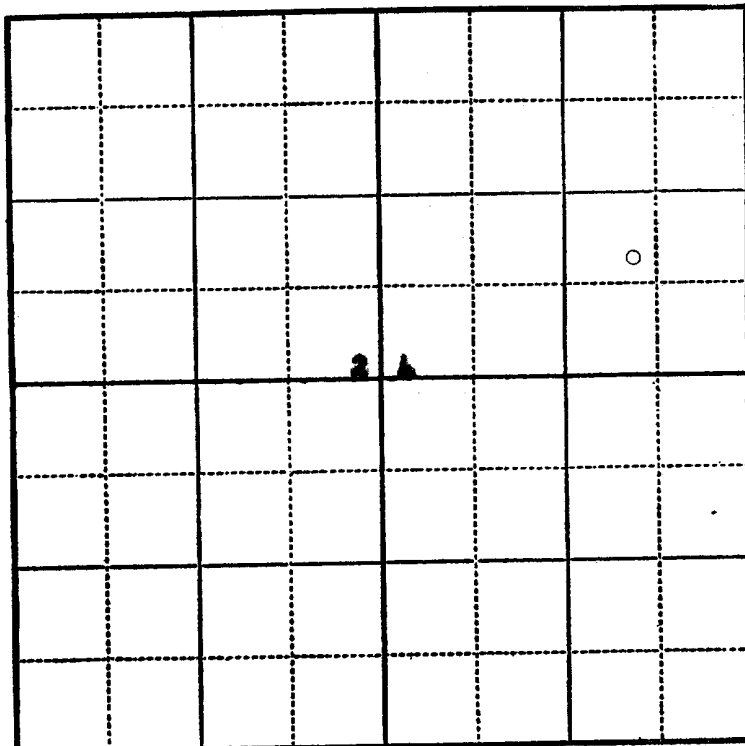

Scale—4 inches equals 1 mile.

Ungraded ground elevation 5563

Graded ground elevation _____

Derrick floor elevation _____

Temporary bench mark elevation _____

Remarks: Sea Level Datum. Surveyed off U.S.C. & G. Bench Mark / H-16 at Flora Vista.

SAN JUAN ENGINEERING CO.
Farmington, New Mexico

Date Surveyed December 6 19 52



Company Franklin Steel Products

Lease _____ Well No. _____

Sec. 24, T. 30 N., R. 12 W., N.M.P.M.

Location 1750' from the North line and 940' from
the East line.

San Juan County

New Mexico

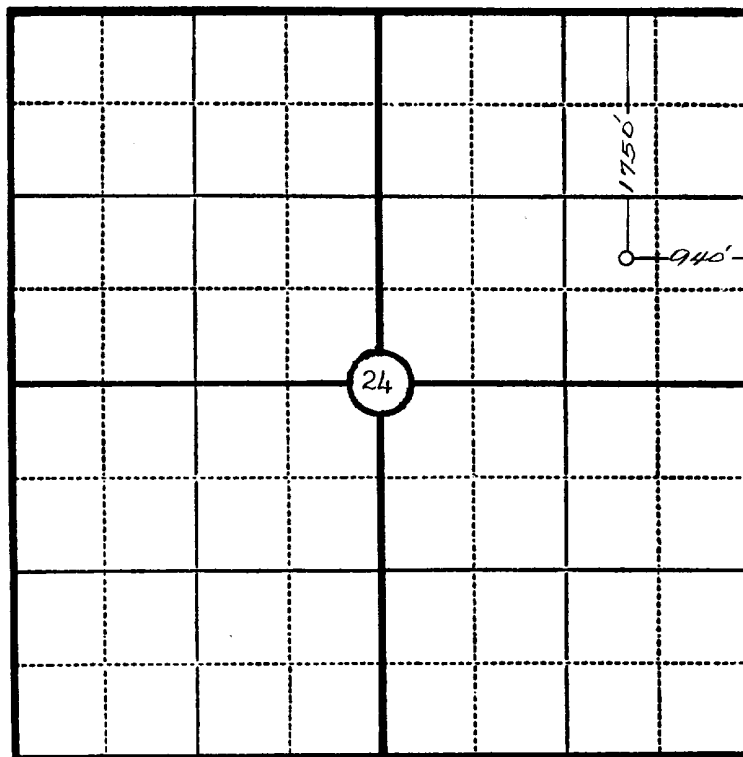

Scale—4 inches equal 1 mile.

This is to certify that the above plat was prepared from field notes of actual surveys made by me or under my supervision and that the same are true and correct to the best of my knowledge and belief.

Charles J. Finklea

Seal:

Registered Professional
Engineer and Land Surveyor. Charles J. Finklea
N. Mex. Reg. No. 1302

Surveyed December 6 1952

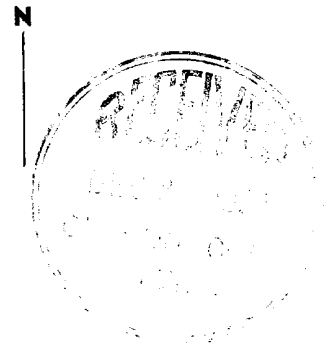

December 8, 1952

Mr. Emery Arnold
Oil and Gas Inspector
Aztec, New Mexico

Dear Mr. Arnold:

We hand you herewith Notice of Intention to Drill,
together with surveyor's certificate on location of well.

You will please note that the well is only 940 feet
from the East line of the section. The reason for the
variation is that to be entirely within the prescribed
distance, it would be necessary that we drill in or on
the bank of an irrigation ditch. This would be unfeasible
due to the fact that the ditch is an old, established one,
and naturally they would not consent that a gas well be
drilled in or immediately adjacent to the ditch.

I believe this matter was mentioned to you, but I
am writing this letter for the purpose of giving you a
record as to the reason for the location as shown in the
surveyor's certificate.

Your cooperation on this is greatly appreciated.

Very truly yours,

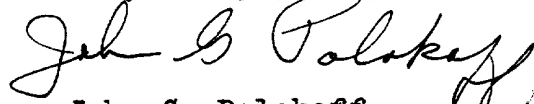

John G. Polokoff
5725 Broadway
Los Angeles, California

P. S. In event you need to get in touch with me on short
notice at any time, please notify G. W. R. Hoy, Attorney
at Law, Farmington, New Mexico, and he will get in touch
with me by phone, if necessary.

JGP

NEW MEXICO OIL CONSERVATION COMMISSION
Santa Fe, New Mexico

(Form C-104)
(Revised 7/1/52)

REQUEST FOR (OIL) - (GAS) ALLOWABLE

New Well
Recompletion

This form shall be submitted by the operator before an initial allowable will be assigned to any completed Oil or Gas well. Form C-104 is to be submitted in QUADRUPLICATE to the same District Office to which Form C-101 was sent. The allowable will be assigned effective 7:00 A.M. on date of completion or recompletion, provided this form is filed during calendar month of completion or recompletion. The completion date shall be that date in the case of an oil well when oil is delivered into the stock tanks. Gas must be reported on 15.025 psia at 60° Fahrenheit.

LOS ANGELES, CALIF. Sept. 24, 1953
(Place) (Date)

WE ARE HEREBY REQUESTING AN ALLOWABLE FOR A WELL KNOWN AS:

FRANKLIN STEEL PRODUCTS BLANCHETT, Well No. 1, in NE 1/4,
(Company or Operator) (Lease)
H, Sec. 24, T. 30 N, R. 12 W, NMPM, Pool
(Unit)
SAN JUAN County. Date Spudded 12-8-52, Date Completed 2-24-53

Please indicate location:

240' FR/E 1750' FR/W

Casing and Cementing Record
Size Feet Sax

6 5/8	1835	300

Elevation 5563 Total Depth 1900, P.B.
Top oil/gas pay 1830 Prod. Form PICTURED GLIF
Casing Perforations: NONE or
Depth to Casing shoe of Prod. String 1835
Natural Prod. Test _____ BOPD
based on _____ bbls. Oil in _____ Hrs. _____ Mins.
Test after acid or shot NONE BOPD
Based on _____ bbls. Oil in _____ Hrs. _____ Mins.
Gas Well Potential _____
Size choke in inches _____
Date first oil run to tanks or gas to Transmission system: _____
Transporter taking Oil or Gas: EL PASO NATURAL GAS CO.

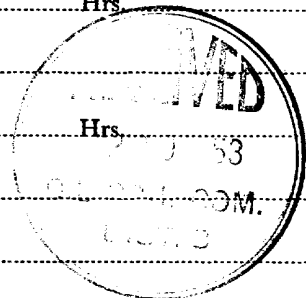

Remarks: _____

I hereby certify that the information given above is true and complete to the best of my knowledge.

Approved 9-30, 1953

OIL CONSERVATION COMMISSION

Original Signed Emery C. Arnold

y: _____
le _____ Oil and Gas Inspector Dist. #3, _____

FRANKLIN STEEL PRODUCTS
(Company or Operator)
By: John B. Polakoff
(Signature)

Title OWNER
Send Communications regarding well to:
Name FRANKLIN STEEL PRODUCTS
Address 5725 So. Broadway, Los Angeles

OIL CONSERVATION COMMISSION		
SITCO DISTRICT OFFICE		
No. Copies Furnished 4		
DISTRIBUTION		
	NO. FURNISHED	
Operator	1	
Santa Fe	1	
Production Office	1	
State Land Office		
U. S. G. S.		
Transporter		
File	1	1

NEW MEXICO OIL CONSERVATION COMMISSION

Santa Fe, New Mexico

It is necessary that Form C-104 be approved before this form can be approved an an *initial* allowable be assigned to any completed Oil or Gas well. Submit this form in QUADRUPLICATE.

CERTIFICATE OF COMPLIANCE AND AUTHORIZATION TO TRANSPORT OIL AND NATURAL GAS

Company or Operator.....**FRANKLIN STEEL PRODUCTS**..... Lease.....**BLANCETT**.....

Address.....**3725 SO. BROADWAY**..... **LOS ANGELES, CALIFORNIA**.....
(Local or Field Office) (Principal Place of Business)

Unit.....**H**....., Well(s) No.....**1**....., Sec.....**24**....., T.....**30 N**....., R.....**12 W**....., Pool.....

County.....**SAN JUAN**..... Kind of Lease:.....**OIL & GAS**.....

If Oil well Location of Tanks.....

Authorized Transporter.....**EL PASO NATURAL GAS CO.**..... Address of Transporter

(Local or Field Office)

(Principal Place of Business)

Per cent of Oil or Natural Gas to be Transported.....**30%**..... Other Transporters authorized to transport Oil or Natural Gas from this unit are.....

REASON FOR FILING: (Please check proper box)

NEW WELL.....☒..... CHANGE IN OWNERSHIP.....☐

CHANGE IN TRANSPORTER.....☐..... OTHER (Explain under Remarks).....☐

REMARKS:

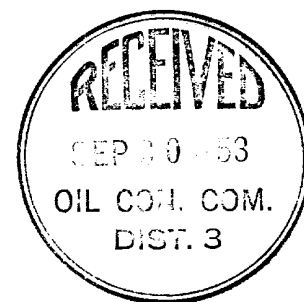

The undersigned certifies that the Rules and Regulations of the Oil Conservation Commission have been complied with.

Executed this the.....**24**..... day of.....**SEPTEMBER**..... 19.....**53**

Approved.....**9-30**....., 19.....**53**

OIL CONSERVATION COMMISSION
Original Signed **Emory C. Arnold**

By.....

Title.....**Oil and Gas Inspector Dist. #3.**.....

By.....**John G. Polakoff**.....

Title.....**OWNER**.....

INSTRUCTIONS

This form shall be executed and filed in QUADRUPLICATE with the District Office of the Oil Conservation Commission, covering each unit from which oil or gas is produced. A separate certificate shall be filed for each transporter authorized to transport oil or gas from a unit. After said certificate has been approved by the Oil Conservation Commission, one copy shall be forwarded to the transporter, one copy returned to the producer, and two copies retained by the Oil Conservation Commission.

A new certificate shall be filed to cover each change in operating ownership and each change in the transporter, except that in the case of a temporary change in the transporter involving less than the allowable production for one proration period, the operator shall in lieu of filing a new certificate notify the Oil Conservation Commission District Office, and the transporter authorized by certificate on file with the Commission, by letter of the estimated amount of oil or gas to be moved by the transporter temporarily moving oil or gas from the unit and the name of such temporary transporter and a copy of such notice shall also be furnished such temporary transporter. Such temporary transporter shall not move any more oil or gas than the estimated amount shown in said notice.

This certificate when properly executed and approved by the Oil Conservation Commission shall constitute a permit for pipe line connection and authorization to transport oil and gas from the property named therein and shall remain in full force and effect until

- (a) Operating ownership changes
- (a) The transporter is changed or
- (c) The permit is cancelled by the Commission.

If any of the rules and regulations of the Oil Conservation Commission have not been complied with at the same time this report is filed, explain fully under the heading "REMARKS."

In all cases where this certificate is filed to cover a change in operating ownership or a change in the transporter designated to move oil or gas, show under "REMARKS" the previous owner or operator and the transporter previously authorized to transport oil or gas.

A separate report shall be filed to cover each producing unit as designated by the Oil Conservation Commission.

OIL CONSERVATION COMMISSION		
AZTEC DISTRICT OFFICE		
No. Copies Received 4		
DISTRIBUTION		
	NO. FURNISHED	
Operator	1	
Santa Fe	1	
Proration Office		
State Land Office		
U. S. G. S.		
Transporter	1	
File	1	✓

NEW MEXICO
OIL CONSERVATION COMMISSION

Gas Well Plat

Date Feb. 18, 1954

Franklin Steel Products

Blansett

1

Operator

Lease

Well No.

Name of Producing Formation Pictured Cliff

Pool _____

No. Acres Dedicated to the Well 160

Indicate land status and show ownership.

SECTION 24 TOWNSHIP 30 N. RANGE 12 W.

		M. L.	
		BLANCETT	O

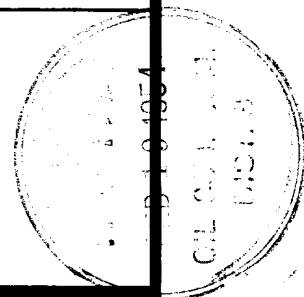

I hereby certify that the information given above is true and complete to the best of my knowledge.

Name John G. Polokoff

Position Owner

Representing Franklin Steel Prod.

Address 5725 So. Broadway

Los Angeles, Calif.

(over)

OIL CONSERVATION COMMISSION
AZTEC DISTRICT OFFICE

Copies Received 4

DISTRIBUTION

	NO. FURNISHED	
Operator	1	
Santa Fe	1	
Exploration Office		
State Land Office		
U. S. G. S.	1	
Transporter		
File	1	✓

NEW MEXICO OIL CONSERVATION COMMISSION
Santa Fe, New Mexico

MISCELLANEOUS REPORTS ON WELLS

Submit this report in TRIPLICATE to the District Office, Oil Conservation Commission, within 10 days after the work specified is completed. It should be signed and filed as a report on Beginning Drilling Operations, Results of test of casing shut-off, result of plugging of well, result of well repair, and other important operations, even though the work was witnessed by an agent of the Commission. See additional instructions in the Rules and Regulations of the Commission.

Indicate Nature of Report by Checking Below

REPORT ON BEGINNING DRILLING OPERATIONS		REPORT ON RESULT OF TEST OF CASING SHUT-OFF		REPORT ON REPAIRING WELL	
REPORT ON RESULT OF PLUGGING WELL	X	REPORT ON RECOMPLETION OPERATION		REPORT ON (Other)	

Feb. 4
(Date)

(Place)

Following is a report on the work done and the results obtained under the heading noted above at the

John G. Polekoff

Blancett No. 1

(Company or Operator)

(Lease)

Harmon Owen

(Contractor)

Well No. 1 in the NE 1/4 of Sec. 24

30 N 12 W

Asteo

T. R., NMPM., Pool, San Juan County.

The Dates of this work were as follows:

Notice of intention to do the work (was) (was not) submitted on Form C-102 on _____, 19____, (Cross out incorrect words)

and approval of the proposed plan (was) (was not) obtained.

DETAILED ACCOUNT OF WORK DONE AND RESULTS OBTAINED

Approximately 25 sacks of cement at bottom of hole



Witnessed by _____ (Name) _____ (Company) _____ (Title)

ORIGINAL SIGNED BY

Approved:

OIL CONSERVATION COMMISSION

S. V. Roberts

(Name)

I hereby certify that the information given above is true and complete to the best of my knowledge.

Name

Position

Representing

Address

PETROLEUM ENGINEER DIST. NO. 3

(Title)

(Date)

FEB 8 1955

OIL CONSERVATION COMMISSION
AZTEC DISTRICT OFFICE

No. Copies Received 3

DISTRIBUTION

	NO. FURNISHED	
Operator	1	
Santa Fe	1	
Operation Office		
State Land Office		
U. S. G. S.	#	
Transporter		
File	1	✓

AREA 640 ACRES
LOCATE WELL CORRECTLY

NEW MEXICO OIL CONSERVATION COMMISSION

Santa Fe, New Mexico

WELL RECORD

Mail to District Office, Oil Conservation Commission, to which Form C-101 was sent not later than twenty days after completion of well. Follow instructions in Rules and Regulations of the Commission. Submit in QUINTUPLICATE.

FRANKLIN STEEL PRODUCTS

(Company or Operator)

BLANCETT

(Lease)

Well No. 1, in H, $\frac{1}{4}$ of 24, of Sec. 24, T. 30N, R. 12W, NMPM.Pool, SAN JUAN County.Well is 940 feet from EAST line and 1750 feet from NORTH lineof Section 24. If State Land the Oil and Gas Lease No. is _____Drilling Commenced DECEMBER, 19 52 Drilling was Completed DECEMBER, 19 52Name of Drilling Contractor BANNER DRILLING COMPANYAddress 410 - CITY NATIONAL BLDG., WICHITA FALLS, TEXASElevation above sea level at Top of Tubing Head 5563 The information given is to be kept confidential until _____, 19 _____

OIL SANDS OR ZONES

No. 1, from _____ to _____ No. 4, from _____ to _____

No. 2, from _____ to _____ No. 5, from _____ to _____

No. 3, from _____ to _____ No. 6, from _____ to _____

IMPORTANT WATER SANDS

Include data on rate of water inflow and elevation to which water rose in hole.

No. 1, from _____ to _____ feet.

No. 2, from _____ to _____ feet.

No. 3, from _____ to _____ feet.

No. 4, from _____ to _____ feet.

CASING RECORD

SIZE	WEIGHT PER FOOT	NEW OR USED	AMOUNT	KIND OF SHOE	CUT AND PULLED FROM	PERFORATIONS	PURPOSE
6 5/8	20	USED	1835				
10"	32 3/4	NEW	90				Surface

MUDDING AND CEMENTING RECORD

SIZE OF HOLE	SIZE OF CASING	WHERE SET	NO. SACKS OF CEMENT	METHOD USED	MUD GRAVITY	AMOUNT OF MUD USED
	6 5/8	1835	300			
	10"	90	100			

RECORD OF PRODUCTION AND STIMULATION

(Record the Process used, No. of Qts. or Gals. used, interval treated or shot.)

250 QTS. SOLIFIED NITRO-GLYCERIN After completion in pictured cliff zone produced 50 MCP gas and water broke in. Now waiting for 2000' 4 1/2" casing to be put in hole instead of trying to cement water off.

Result of Production Stimulation _____

Depth Cleaned Out 1905

RECORD OF DRILL-STEM AND SPECIAL TESTS

If drill-stem or other special tests or deviation surveys were made, submit report on separate sheet and attach hereto

TOOLS USED

Rotary tools were used from 0 feet to 1905 feet, and from feet to feet.
Cable tools were used from feet to feet, and from feet to feet.

PRODUCTION

Put to Producing December 1953
OIL WELL: The production during the first 24 hours was barrels of liquid of which % was
was oil; % was emulsion; % water; and % was sediment. A.P.I.
Gravity.
GAS WELL: The production during the first 24 hours was 50 M.C.F. plus barrels of
liquid Hydrocarbon. Shut in Pressure 675 lbs.
Length of Time Shut in

PLEASE INDICATE BELOW FORMATION TOPS (IN CONFORMANCE WITH GEOGRAPHICAL SECTION OF STATE):

Southeastern New Mexico

Northwestern New Mexico

T. Anhy.	T. Devonian.	T. Ojo Alamo.
T. Salt.	T. Silurian.	T. Kirtland-Fruitland.
B. Salt.	T. Montoya.	T. Farmington.
T. Yates.	T. Simpson.	T. Pictured Cliffs. 1830'
T. 7 Rivers.	T. McKee.	T. Menefee.
T. Queen.	T. Ellenburger.	T. Point Lookout.
T. Grayburg.	T. Gr. Wash.	T. Mancos.
T. San Andres.	T. Granite.	T. Dakota.
T. Glorieta.	T.	T. Morrison.
T. Drinkard.	T.	T. Penn.
T. Tubbs.	T.	T.
T. Abo.	T.	T.
T. Penn.	T.	T.
T. Miss.	T.	T.

FORMATION RECORD

From	To	Thickness in Feet	Formation	From	To	Thickness in Feet	Formation
1830			PICTURED CLIFFS				

OIL CONSERVATION COMMISSION
AZTEC DISTRICT OFFICE
No. Copies Received 5
DISTRIBUTION
NO. FURNISHED
Operator /
Santa Fe /
Proration Office /
State Land Office /
S. G. S. /
Transporter /
File /

ATTACH SEPARATE SHEET IF ADDITIONAL SPACE IS NEEDED

I hereby swear or affirm that the information given herewith is a complete and correct record of the well and all work done on it so far as can be determined from available records.

JANUARY 26, 1954

Company or Operator FRANKLIN STEEL PRODUCTS
Name John G. Polakoff
JOHN G. POLOKOFF

Address 5725 So. Broadway, Los Angeles (Date)
California
Position or Title OWNER

✓
EL PASO NATURAL GAS COMPANY

Memorandum

To: Distribution
From: W. M. Rodgers

Date: June 1, 1955
Place: Farmington, New Mexico

J. J. Polokoff

Blancett #1

1750N, 940E, Sec. 24, T 30N, R 12W

Above well has been plugged and abandoned, also
disconnected from our system.

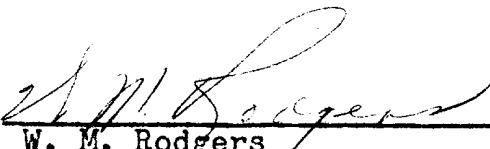
W. M. Rodgers
Chief Dispatcher

WMR/mm

cc: F. N. Woodruff
W. M. Flood
B. D. Adams
New Mexico Oil Conservation Commission - Aztec
C. O. Walker
G. H. Peppin

File (2)

