

(SUBMIT IN TRIPLICATE)
**UNITED STATES
DEPARTMENT OF THE INTERIOR
GEOLOGICAL SURVEY**

Land Office Santa Fe
Lease No. SP 076200
Unit W. H. Riddle

SUNDRY NOTICES AND REPORTS ON WELLS

RECEIVED

NOTICE OF INTENTION TO DRILL	<input checked="" type="checkbox"/>	SUBSEQUENT REPORT OF WATER SHUT-OFF	JUN 26 1958
NOTICE OF INTENTION TO CHANGE PLANS		SUBSEQUENT REPORT OF SHOOTING OR ACIDIZING	
NOTICE OF INTENTION TO TEST WATER SHUT-OFF		SUBSEQUENT REPORT OF ALTERING CASING	
NOTICE OF INTENTION TO RE-DRILL OR REPAIR WELL		SUBSEQUENT REPORT OF RE-DRILLING OR REPAIR	
NOTICE OF INTENTION TO SHOOT OR ACIDIZE		SUBSEQUENT REPORT OF ABANDONMENT	
NOTICE OF INTENTION TO PULL OR ALTER CASING		SUPPLEMENTARY WELL HISTORY	
NOTICE OF INTENTION TO ABANDON WELL			

(INDICATE ABOVE BY CHECK MARK NATURE OF REPORT, NOTICE, OR OTHER DATA)

W. H. Riddle

Farmington, New Mexico June 25, 1958

Well No. 2 is located 1450 ft. from N line and 790 ft. from W line of sec. 24

NW 1/4 of Section 24
(1/4 Sec. and Sec. No.)

T-30-N
(Twp.)

R-10-W
(Range)

N.M.P.M.
(Meridian)

Painted Pictured Cliffs
(Field)

San Juan
(County or Subdivision)

New Mexico
(State or Territory)

The elevation of the derrick floor above sea level is _____ ft. (To be reported later.)

DETAILS OF WORK

(State names of and expected depths to objective sands; show sizes, weights, and lengths of proposed casings; indicate mudding jobs, cementing points, and all other important proposed work)

We propose drilling the above well with rotary tools to an approximate total depth of 3100 feet to complete in the Painted Cliffs formation. Stimulation will be as indicated upon reaching total depth.

Casing Program:

SIZE	DEPTH	CEMENT	REMARKS
8-5/8"	300	250	Circulate to surface sufficient to fill above pay.
5-1/2"	3100		

Copies of location plat are attached. Logs will be furnished upon completion of well.

I understand that this plan of work must receive approval in writing by the Geological Survey before operations may be commenced.

Company Pan American Petroleum Corporation

Address Box 487

Farmington, New Mexico

By ORIGINAL SIGNED BY

Title D. J. SCOTT
Field Clerk

NEW MEXICO OIL CONSERVATION COMMISSION

Well Location and Acreage Dedication Plat

Section A.

Date June 25, 1958

Operator PAN AMERICAN PETROLEUM CORPORATION Lease M. H. RIDDLE
 Well No. 2 Unit Letter E Section 24 Township 30 NORTH Range 10 WEST, NMPM
 Located 1450 Feet From the NORTH Line, 790 Feet From the WEST Line
 County SAN JUAN G. L. Elevation * Dedicated Acreage 160 Acres
 Name of Producing Formation Pictured Cliffs Pool Pictured Cliffs

1. Is the Operator the only owner in the dedicated acreage outlined on the plat below?
 Yes X No * To be reported later.
2. If the answer to question one is "no", have the interests of all the owners been consolidated by communitization agreement or otherwise? Yes No . If answer is "yes", Type of Consolidation.
3. If the answer to question two is "no", list all the owners and their respective interests below:

Owner

Land Description

RECEIVED

JUN 26 1958

U. S. GEOLOGICAL SURVEY
FARMINGTON, NEW MEXICO

RECEIVED

JUN 27 1958

OIL CON. COM.

Section B.

Note: All distances must be from outer boundaries of section.

This is to certify that the information in Section A above is true and complete to the best of my knowledge and belief.

PAN AMERICAN PETROLEUM CORPORATION

(Operator)

ROY M. BAUER, JR.

(Representative)

Box 147, Farmington, New Mexico

(Address)

Ref: GLO plat dated 7 April 1951

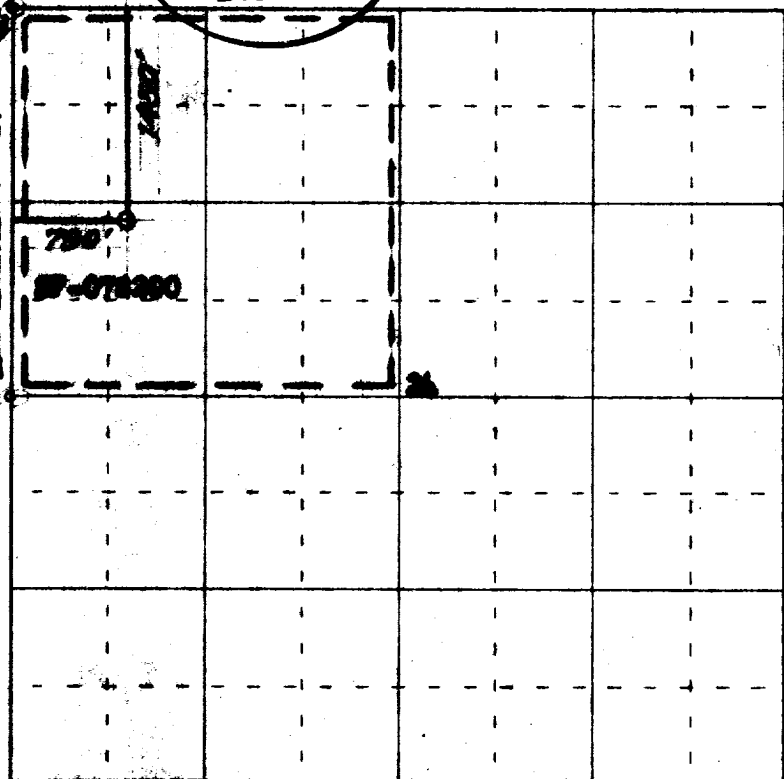

0 200 400 600 800 1000 1200 1400 1600 1800 2000 2200 2400 2600 2800 3000 3200 3400 3600 3800 4000

Scale 4 inches equal 1 mile

This is to certify that the above plat was prepared from field notes of actual surveys made by me or under my supervision and that the same are true and correct to the best of my knowledge and belief.

Date Surveyed 21 June 1958

James P. Linn
 Registered Professional Engineer and/or Land Surveyor
 JAMES P. LINN E. REG. NO. 2449

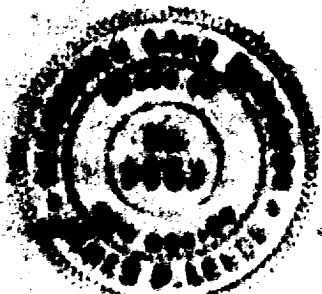

Farmington, New Mexico