

UNITED STATES
DEPARTMENT OF THE INTERIOR
GEOLOGICAL SURVEY

APPLICATION FOR PERMIT TO DRILL, DEEPEN, OR PLUG BACK

1a. TYPE OF WORK
 DRILL DEEPEN PLUG BACK

b. TYPE OF WELL
 OIL WELL GAS WELL OTHER SINGLE ZONE MULTIPLE ZONE

2. NAME OF OPERATOR
Tenneco Oil Company

3. ADDRESS OF OPERATOR
P. O. Box 1714, Durango, Colorado

4. LOCATION OF WELL (Report location clearly and in accordance with any State requirements.*)
 At surface
990 FNL, 790 FEL
 At proposed prod. zone

14. DISTANCE IN MILES AND DIRECTION FROM NEAREST TOWN OR POST OFFICE*
10 Miles

5. LEASE DESIGNATION AND SERIAL NO.
SF 078116

6. IF INDIAN, ALLOTTEE OR TRIBE NAME

7. UNIT AGREEMENT NAME

8. FARM OR LEASE NAME
Florance

9. WELL NO.
51

10. FIELD AND POOL, OR WILDCAT
Blanco PC

11. SEC., T., R., M., OR BLK. AND SURVEY OR AREA
Sec. 20, T30N, R9W

12. COUNTY OR PARISH 13. STATE
San Juan New Mexico

15. DISTANCE FROM PROPOSED* LOCATION TO NEAREST PROPERTY OR LEASE LINE, FT. (Also to nearest drlg. unit line, if any)

16. NO. OF ACRES IN LEASE
160

17. NO. OF ACRES ASSIGNED TO THIS WELL
160

18. DISTANCE FROM PROPOSED LOCATION* TO NEAREST WELL, DRILLING, COMPLETED, OR APPLIED FOR, ON THIS LEASE, FT.

19. PROPOSED DEPTH
3000'

20. ROTARY OR CABLE TOOLS
Rotary

21. ELEVATIONS (Show whether DF, RT, GR, etc.)
6004 GR

22. APPROX. DATE WORK WILL START*
August 7, 1965

23. PROPOSED CASING AND CEMENTING PROGRAM

SIZE OF HOLE	SIZE OF CASING	WEIGHT PER FOOT	SETTING DEPTH	QUANTITY OF CEMENT
8-3/4"	7"	20#	100	Cement to surface.
6-1/4"	3-1/2" NUE	5.75#	3000	Cement w/sufficient amount to circulate to surface.

We propose to rig up and drill 8-3/4" hole to 100' and set approximately 100' of 7" 20# J-55 casing. WOC. Drill 6-1/4" hole to approximate TD 3000. Log and run 3-1/2" 5.75# 10 Round J-55 casing to TD. Cement back to surface. Clean out to PSTD. Perforate Pictured Cliffs and frac.

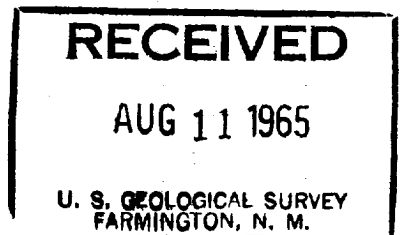

IN ABOVE SPACE DESCRIBE PROPOSED PROGRAM: If proposal is to deepen or plug back, give data on present productive zone and proposed new productive zone. If proposal is to drill or deepen directionally, give pertinent data on subsurface locations and measured and true vertical depths. Give blowout preventer program, if any.

24. Original Signed By: J. H. WATKINS TITLE District Office Supervisor DATE 8-10-65
 SIGNED J. H. WATKINS

(This space for Federal or State office use)

PERMIT NO. _____ APPROVAL DATE _____

APPROVED BY ekal TITLE _____

CONDITIONS OF APPROVAL, IF ANY:

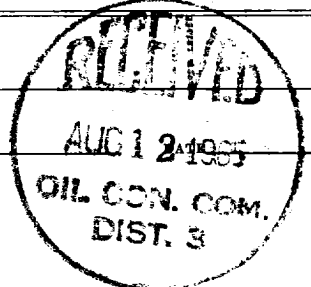

Instructions

General: This form is designed for submitting proposals to perform certain well operations, as indicated, on all types of lands and leases for appropriate action by either a Federal or a State agency, or both, pursuant to applicable Federal and/or State laws and regulations. Any necessary special instructions concerning the use of this form and the number of copies to be submitted, particularly with regard to local, area, or regional procedures and practices, either are shown below or will be issued by, or may be obtained from, the local Federal and/or State office.

Item 1: If the proposal is to redrill to the same reservoir at a different subsurface location or to a new reservoir, use this form with appropriate notations. Consult applicable State or Federal regulations concerning subsequent work proposals or reports on the well.

Item 4: If there are no applicable State requirements, locations on Federal or Indian land should be described in accordance with Federal requirements. Consult local State or Federal office for specific instructions.

Item 14: Needed only when location of well cannot readily be found by road from the land or lease description. A plat, or plats, separate or on this reverse side, showing the roads to, and the surveyed location of, the well, and any other required information, should be furnished when required by Federal or State agency offices.

Items 15 and 18: If well is to be, or has been directionally drilled, give distances for subsurface location of hole in any present or objective production zone.

Item 22: Consult applicable Federal or State regulations, or appropriate officials, concerning approval of the proposal before operations are started.

NEW MEXICO OIL CONSERVATION COMMISSION
WELL LOCATION AND ACREAGE DEDICATION PLAT

Form 1-61
Supersedes C-128
Effective 1-1-61

All distances must be from the outer boundaries of the Section

Operator TENNECO OIL COMPANY		Lease Florance			Well No. 51		
Unit Letter A	Section 20	Range 30 North	Township 9 West	County San Juan			
Actual Footage Location of Well							
990	feet from the	North	line and	790	feet from the	East	line
Ground Level Elev. 6004' ungraded	Underlying Formation Pictured Cliffs		Foot Blanco FC	Dedicated Acreage 160			Acres

1. Outline the acreage dedicated to the subject well by colored pencil or hachure marks on the plat below.
2. If more than one lease is dedicated to the well, outline each and identify the ownership thereof (both as to working interest and royalty).
3. If more than one lease of different ownership is dedicated to the well, have the interests of all owners been consolidated by communitization, unitization, force-pooling, etc?

Yes No If answer is "yes," type of consolidation _____

If answer is "no," list the owners and tract descriptions which have actually been consolidated (Use reverse side of this form if necessary.) _____

No allowable will be assigned to the well until all interests have been consolidated (by communitization, unitization, forced-pooling, or otherwise) or until a non-standard unit, eliminating such interests, has been approved by the Commission.

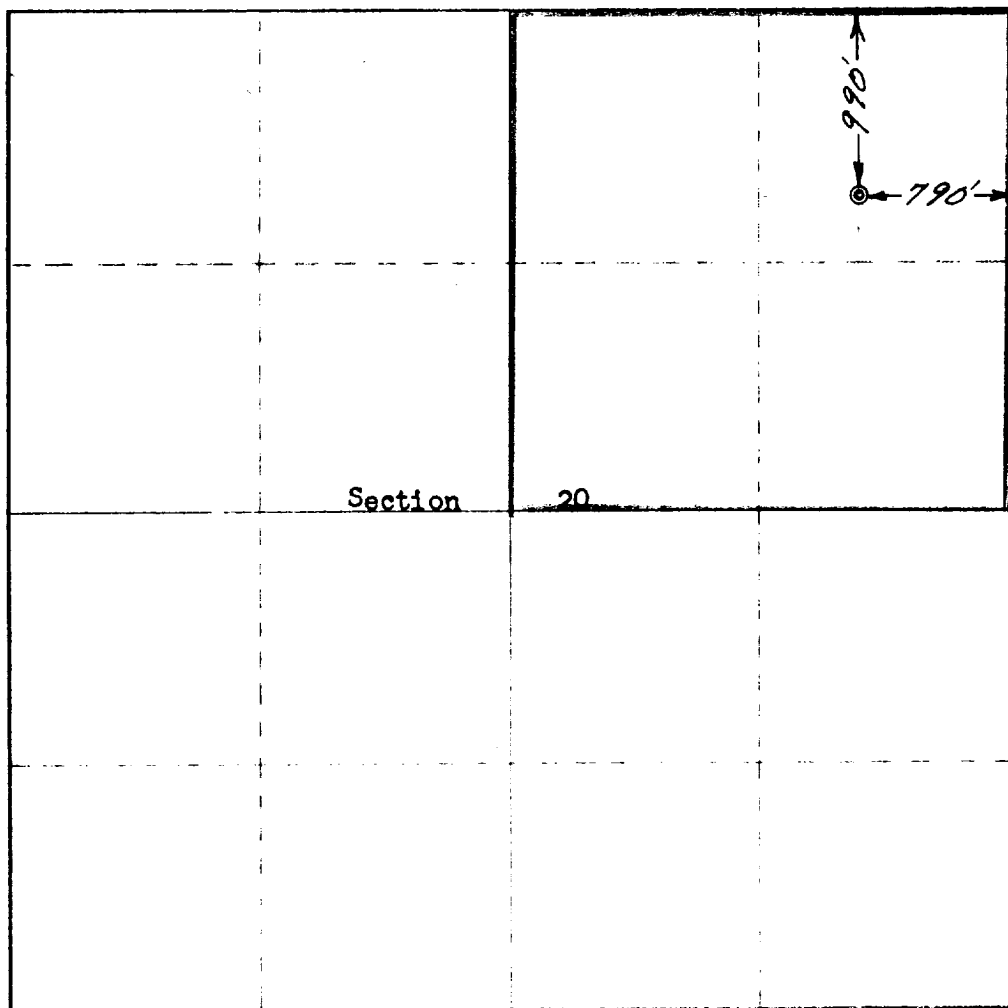

CERTIFICATION

I hereby certify that the information contained herein is true and complete to the best of my knowledge and belief.

Original Signed By
HAROLD C. NICHOLS
Name

Position
Senior Production Clerk

Company
Tenneco Oil Company

Date
8-10-65

I hereby certify that the well location shown on this plat was plotted from field notes of actual surveys made by me or under my supervision and that the same are correct to the best of my knowledge and belief.

Date
5 August 1965

Signature
ROBERT H. ERNST

N. Mex. PE & IS 2463