

NUMBER OF COPIES RECEIVED	
DISTRIBUTION	
SANTA FE	
FILE	
U.S.G.S.	
LAND OFFICE	
TRANSPORTER	OIL GAS
PRORATION OFFICE	
OPERATOR	

4-OCC, 2-EPNG, El Paso, Farm., 1-F

**NEW MEXICO OIL CONSERVATION COMMISSION**  
**Santa Fe, New Mexico**

Form C-101  
Revised (12/1/55)

**NOTICE OF INTENTION TO DRILL**

Notice must be given to the District Office of the Oil Conservation Commission and approval obtained before drilling or recompletion begins. If changes in the proposed plan are considered advisable, a copy of this notice showing such changes will be returned to the sender. Submit this notice in QUINTUPPLICATE. One copy will be returned following approval. See additional instructions in Rules and Regulations of the Commission.

If State Land submit 6 Copies Attach Form G- 128 in triplicate to first 3 copies of form C-101

**Farmington, New Mexico**

(Place)

**February 19, 1964**

(Date)

**OIL CONSERVATION COMMISSION**  
**SANTA FE, NEW MEXICO**

Gentlemen:

You are hereby notified that it is our intention to commence the Drilling of a well to be known as  
**Beta Development Co.**

(Company, or Operator)

**Vasaly Unit**

(Lease)

Well No. **1**, in **A** (Unit) The well is

located **970** feet from the **North** line and **1090** feet from the

**East** line of Section **22**, T. **30 N**, R. **11 W**, NMPM.

(GIVE LOCATION FROM SECTION LINE) **Basin Dakota** Pool, **San Juan** County

D	C	B	A
E	F	G	H
L	K	J	I
M	N	O	P

If State Land the Oil and Gas Lease is No

If patented land the owner is **Miss Alta Vasaly**

Address **P. O. Box 173, Sumner, Washington**

We propose to drill well with drilling equipment as follows:

**Rotary to total depth**

The status of plugging bond is **Bond on file**

Drilling Contractor **Loffland Brothers Company**

**P. O. Box 688, Farmington, New Mexico**

We intend to complete this well in the **Dakota**

formation at an approximate depth of **6950'** feet.

**CASING PROGRAM**

We propose to use the following strings of Casing and to cement them as indicated:

Size of Hole	Size of Casing	Weight per Foot	New or Second Hand	Depth	Sacks Cement
<b>12 1/4"</b>	<b>8 5/8"</b>	<b>24#</b>	<b>New</b>	<b>300</b>	<b>175 sx</b>
<b>7 7/8"</b>	<b>4 1/2"</b>	<b>10.5#</b>	<b>New</b>	<b>6950</b>	<b>250 1st stage</b>
					<b>1000 cu. ft.</b>
					<b>2nd stage</b>

If changes in the above plans become advisable we will notify you immediately.

ADDITIONAL INFORMATION (If recompletion give full details of proposed plan of work.)

**Production casing will be cemented in 2 stages**

**1st stage to protect the Dakota and Gallup formations**

**2nd stage to protect the Pictured Cliffs, Kirtland, Fruitland formations**

Approved.....  
Except as follows:

Sincerely yours,

**Beta Development Co.**

Original signed by (or Operator)

By **JOHN T. HAMPTON**

Position **Manager**

Send Communications regarding well to

Name **Beta Development Co.**

Address **234 Petr. Club Plaza, Farmington, New Mex**

**OIL CONSERVATION COMMISSION**

By *Cary Chase*

## NEW MEXICO OIL CONSERVATION COMMISSION

Well Location and Acreage Dedication Plat

Section A.

Date February 19, 1964

Operator BETA DEVELOPMENT COMPANY Lease Vasaly Unit  
 Well No. 1 Unit Letter A Section 22 Township 30 NORTH Range 11 WEST, NMPM  
 Located 970 Feet From NORTH Line, 1090 Feet From EAST Line  
 County San Juan G. L. Elevation 5879.4 Dedicated Acreage N/320 Acres  
 Name of Producing Formation Dakota Pool Basin Dakota

1. Is the Operator the only owner in the dedicated acreage outlined on the plat below?  
 Yes X No \_\_\_\_\_
2. If the answer to question one is "no", have the interests of all the owners been consolidated by communitization agreement or otherwise? Yes \_\_\_\_\_ No \_\_\_\_\_. If answer is "yes", Type of Consolidation.

Operator owns 100% working interest. Royalty will be communitized.

3. If the answer to question two is "no", list all the owners and their respective interests below:

OwnerLand Description

\_\_\_\_\_  
 \_\_\_\_\_  
 \_\_\_\_\_

\_\_\_\_\_  
 \_\_\_\_\_  
 \_\_\_\_\_

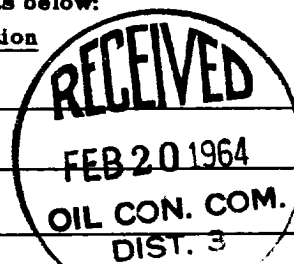

Section B.

Note: All distances must be from outer boundaries of section.

This is to certify that the information  
 in Section A above is true and complete  
 to the best of my knowledge and belief.

Beta Development Co.

(Operator)

JOHN T. HAMPTONManager

(Representative)

234 Petr. Club Plaza

(Address)

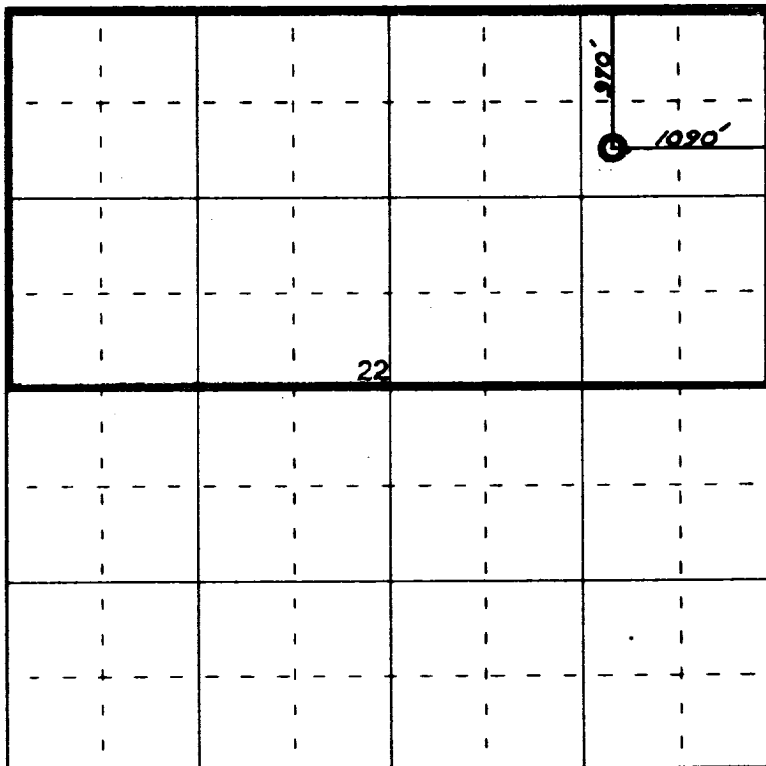
Farmington, New MexicoRef: GLO ~~plat~~ dated April 7, 1887

0 330 660 990 1320 1650 1980 2310 2640 2000 1500 1000 500 0

Scale 4 inches equal 1 mile



Farmington, New Mexico

This is to certify that the above plat was prepared from field notes of actual surveys  
 made by me or under my supervision and that the same are true and correct to the best  
 of my knowledge and belief.

Date Surveyed 11 February 1964

James P. Leese  
 Registered Professional Engineer and/or Land Surveyor  
 James P. Leese