

(SUBMIT IN TRIPLICATE)

UNITED STATES  
DEPARTMENT OF THE INTERIOR  
GEOLOGICAL SURVEY

Land Office Santa Fe  
Lease No. 078194  
Unit Ladwick

SUNDRY NOTICES AND REPORTS ON WELLS

NOTICE OF INTENTION TO DRILL.....	<input checked="" type="checkbox"/>	SUBSEQUENT REPORT OF WATER SHUT-OFF.....
NOTICE OF INTENTION TO CHANGE PLANS.....		SUBSEQUENT REPORT OF SHOOTING OR ACIDIZING.....
NOTICE OF INTENTION TO TEST WATER SHUT-OFF.....		SUBSEQUENT REPORT OF ALTERING CASING.....
NOTICE OF INTENTION TO RE-DRILL OR REPAIR WELL.....		SUBSEQUENT REPORT OF RE-DRILLING OR REPAIR.....
NOTICE OF INTENTION TO SHOOT OR ACIDIZE.....		SUBSEQUENT REPORT OF ABANDONMENT.....
NOTICE OF INTENTION TO PULL OR ALTER CASING.....		SUPPLEMENTARY WELL HISTORY.....
NOTICE OF INTENTION TO ABANDON WELL.....		

(INDICATE ABOVE BY CHECK MARK NATURE OF REPORT, NOTICE, OR OTHER DATA)

May 25, 1956

Well No. 11 is located 990 ft. from (N) line and 1580 ft. from (E) line of sec. 19

NE Section 19 30N 10W R6PM  
(1/4 Sec. and Sec. No.) (Twp.) (Range) (Meridian)  
Blanco San Juan New Mexico  
(Field) (County or Subdivision) (State or Territory)

The elevation of the derrick floor above sea level is 6338 ft.

DETAILS OF WORK

(State names of and expected depths to objective sands; show sizes, weights, and lengths of proposed casings; indicate mudding jobs, cementing points, and all other important proposed work)

It is intended to drill a well with rotary tools thru the Mesa Verde formation. Mud circulation will be used thru the Pictured Cliffs and set intermediate casing. Gas circulation will be used thru the Mesa Verde and a liner will be set. Possible productive intervals will be perforated and fractured. Est. T.D. 5348'.

Casing Program:

10 3/4" at 170' with 125 sacks cement circulated to the surface.  
7 5/8" at 4693' with 250 sacks cement.  
5 1/2" at 5348' with 150 sacks cement.

The E/2 of Section 19 is dedicated to this well.  
E/2 SF 078194.

I understand that this plan of work must receive approval in writing by the Geological Survey before operations may be commenced.

Company El Paso Natural Gas Company

Address Box 997

Farmington, New Mexico

By [Signature]  
Title Petroleum Engineer

NEW MEXICO  
OIL CONSERVATION COMMISSION

WELL LOCATION AND/OR GAS PRORATION PLAT

MAY 24, 1956

EL PASO NATURAL GAS COMPANY LUDWICK SF 078194

11 19 30-N 10-W

990 NORTH 1580 EAST

SAN JUAN 6328

MESA VERDE BLANCO 320

(1881 PLAT)

Note: All distances must be from outer boundaries of section.

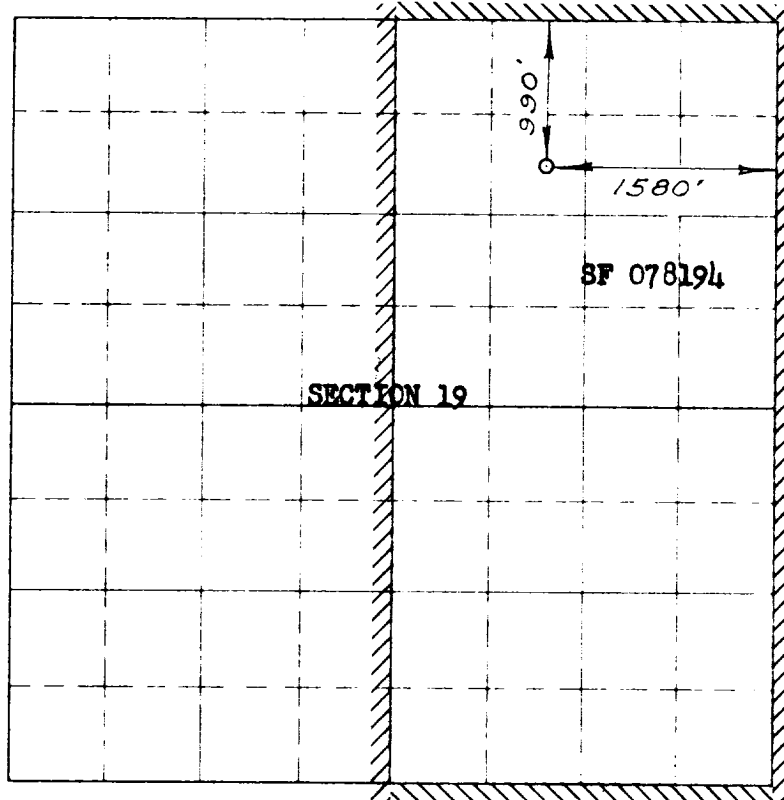

Scale 4 inches equal 1 mile

NOTE

This section of  
land to be used  
for gas wells only

This is to certify that the above plat was prepared from  
field notes of actual surveys made by me or under my  
supervision and that the same are true and correct to the  
best of my knowledge and belief.

Date Surveyed APRIL 27, 1956

*Russell H. McNease*  
Land Surveyor

1. Is this well a Dually Comp.

Yes \_\_\_\_\_ No \_\_\_\_\_

2. If the answer to Question 1  
is yes, are there any other dually  
completed wells within the  
dedicated acreage.

Yes \_\_\_\_\_ No \_\_\_\_\_

*Lawell H. Ullrich*  
Petroleum Engineer

Position \_\_\_\_\_

El Paso Natural Gas Co.

Representing \_\_\_\_\_

Box 997, Farmington, N.M.

Address \_\_\_\_\_

(Seal)



UNITED STATES  
DEPARTMENT OF THE INTERIOR  
GEOLOGICAL SURVEY  
P. O. Box 965  
Farmington, New Mexico

May 25, 1956



El Paso Natural Gas Company  
Box 997  
Farmington, New Mexico

Re: Santa Fe 078194

Gentlemen:

Receipt is acknowledged of your "Notice of Intention to Drill" dated May 25, 1956 covering your well No. 11 Ludwick in NE $\frac{1}{4}$  sec. 19, T. 30 N., R. 10 W., N.M.P.M., San Juan County, New Mexico, Blanco pool.

Your proposed work is hereby approved subject to compliance with the provisions of the "Oil and Gas Operating Regulations" revised May 25, 1942, a copy of which will be sent to you on request, and subject to the following conditions:

1. Drilling operations so authorized are subject to the attached sheet for general conditions of approval.
2. Furnish copies of all logs.

Very truly yours,

(Orig. Sgd.) P. T. McGRATH

P. T. McGrath  
District Engineer

PTMcGrath:ac

UNITED STATES  
DEPARTMENT OF THE INTERIOR  
GEOLOGICAL SURVEY

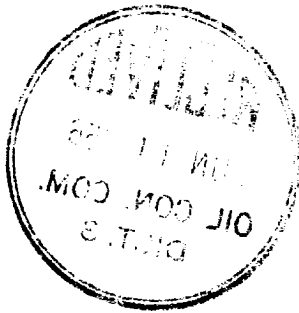

[Faint, mostly illegible text body of the document, possibly containing a letter or report.]