



BRUCE KING  
GOVERNOR

STATE OF NEW MEXICO  
ENERGY, MINERALS AND NATURAL RESOURCES DEPARTMENT

OIL CONSERVATION DIVISION

July 30, 1991

POST OFFICE BOX 2088  
STATE LAND OFFICE BUILDING  
SANTA FE, NEW MEXICO 87504  
(505) 827-5800

Meridian Oil, Inc.  
P.O. Box 4289  
Farmington, New Mexico 87499-4289

Attention: Peggy Bradfield

*Administrative Order NSL-3035*

Dear Ms. Bradfield:

Reference is made to your application dated July 8, 1991 for a non-standard Basin-Fruitland coal gas well location for your existing **Lloyd Well No. 1** which was drilled in 1952 and completed in the Aztec Pictured Cliffs Pool at a standard gas well location 990 feet from the North line and 1650 feet from the West line (Unit C) of Section **24**, Township **30 North**, Range **11 West**, NMPM, San Juan County, New Mexico.

It is my understanding that the Pictured Cliffs zone has been plugged back and said well was recompleted to the Basin-Fruitland Coal Gas Pool which pursuant to the Special Rules and Regulations for the Basin-Fruitland Coal Gas Pool as promulgated by Division Order No. R-8768, as amended, is unorthodox. Further, Lots 1 through 8 (N/2 equivalent) of said Section 24 shall be dedicated to the well forming a standard 314.36-acre gas spacing and proration unit for said pool.

By authority granted me under the provisions of Rule 8 of said Division Order No. R-8768, the above-described unorthodox coal gas well is hereby approved.

Sincerely,

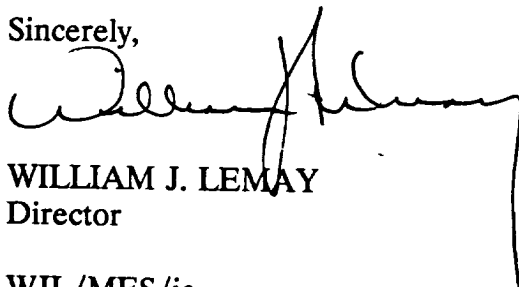

WILLIAM J. LEMAY  
Director

WJL/MES/jc

**RECEIVED**  
AUG 1 1991  
OIL CON. DIV.  
DIST. 3

cc: Oil Conservation Division - Aztec ✓  
U.S. Bureau of Land Management - Farmington



STATE OF NEW MEXICO  
ENERGY, MINERALS and NATURAL RESOURCES DEPARTMENT  
OIL CONSERVATION DIVISION  
AZTEC DISTRICT OFFICE

1000 RIO BRAZOS ROAD  
AZTEC, NEW MEXICO 87410  
(505) 334-6178

Date: 7-15-91

*ATTN: M. STOCKER*

Oil Conservation Division  
P.O. Box 2088  
Santa Fe, NM 87504-2088

RE: Proposed MC \_\_\_\_\_  
Proposed NSL X \_\_\_\_\_  
Proposed WFX \_\_\_\_\_  
Proposed NSP \_\_\_\_\_

Proposed DHC \_\_\_\_\_  
Proposed SWD \_\_\_\_\_  
Proposed PMX \_\_\_\_\_  
Proposed DD \_\_\_\_\_

Gentlemen:

I have examined the application received on 7-15-91  
for the MERIDIAN OIL INC. LLP9D #1  
OPERATOR LEASE & WELL NO.

C-24-30N-11W and my recommendations are as follows:  
UL-S-T-R

*Approve*  
\_\_\_\_\_  
\_\_\_\_\_  
\_\_\_\_\_  
\_\_\_\_\_  
\_\_\_\_\_

Yours truly,

*Eric Bush*

# MERIDIAN OIL

July 8, 1991

Federal Express

Mr. William LeMay  
New Mexico Oil Conservation Division  
310 Old Santa Fe Trail  
Santa Fe, New Mexico 87503

**RECEIVED**  
JUL 12 1991  
OIL CON. DIV.  
DIST. 3

RE: Lloyd #1  
990'FNL, 1650'FWL  
Section 24, T-30-N, R-11-W  
San Juan County, New Mexico

Dear Mr. LeMay:

This is a request for administrative approval for a non-standard gas well location in the Basin Fruitland Pool.

Meridian Oil plugged back and recompleted the Lloyd #1 well from the Aztec Pictured Cliffs pool to the Basin Fruitland Coal pool. This well is located at 990'FNL, 1650'FWL, Section 24, T-30-N, R-11-W, San Juan County, New Mexico. Application to perform this work was made August 18, 1988 and approved by the Bureau of Land Management August 19, 1988, prior to establishment of the northeast-southwest dedicated pattern established for the Basin Fruitland Coal pool. The plugback and recompletion work was performed in August 1989.

To comply with the New Mexico Oil Conservation Division rules, Meridian is submitting the following for your approval of this non-standard location:

1. C-102 plat showing location of the well;
2. Plat showing offset owners/operators;
3. Affidavit of notification of offset owners/operators;
4. Copy of Well Completion Log for original completion.

A copy of this application is being submitted to all offset owners/operators by certified mail with a request that they furnish your Santa Fe office with a Waiver of Objection, and return one copy to this office.

Sincerely yours,



Peggy Bradfield  
encl.

## WAIVER

\_\_\_\_\_ hereby waives objection to Meridian Oil Inc.'s application for a non-standard location for their Lloyd #1 as proposed above.

By: \_\_\_\_\_ Date: \_\_\_\_\_

xc: Amoco Production

Submit to Asst. Secretary  
District Office  
State Lease - 4 copies  
Fee Lease - 3 copies

State of New Mexico  
Energy, Minerals and Natural Resources Department

Form C-102  
Revised 1-1-89

OIL CONSERVATION DIVISION

P.O. Box 2088

Santa Fe, New Mexico 87504-2088

DISTRICT I  
P.O. Box 1980, Hobbs, NM 88240

DISTRICT II  
P.O. Drawer 00, Artesia, NM 88210

DISTRICT III  
1000 Rio Arriba Rd., Aztec, NM 87410

WELL LOCATION AND ACREAGE DEDICATION PLAT

All Distances must be from the outer boundaries of the section

Operator Meridian Oil Inc.		Lease Lloyd (SF-078144)		Well No. I
Unit Lease C	Section 24	Township 30 North	Range 11 West	County NMNM San Juan
Actual Footage Location of Well: 990 feet from the North line and 1650 feet from the West line				
Ground area elev. 6176'	Producing Formation Fruitland Coal Basin		Dedicated Acreage: 320 Acres	

- Outline the acreage dedicated to the subject well by colored pencil or ballpoint marks on the plat below.
- If more than one lease is dedicated to the well, outline each and identify the ownership thereof (both as to working interest and royalty).
- If more than one lease of different ownership is dedicated to the well, have the interest of all owners been consolidated by commutation, unitization, force-pooling, etc.?  
☐ Yes ☐ No If answer is "yes" type of consolidation \_\_\_\_\_  
If answer is "no" list the owners and tract descriptions which have actually been consolidated. (Use reverse side of this form if necessary.) \_\_\_\_\_  
No allowance will be assigned to the well until all interests have been consolidated (by commutation, unitization, force-pooling, or otherwise) or until a non-standard unit, eliminating such interest, has been approved by the Division.

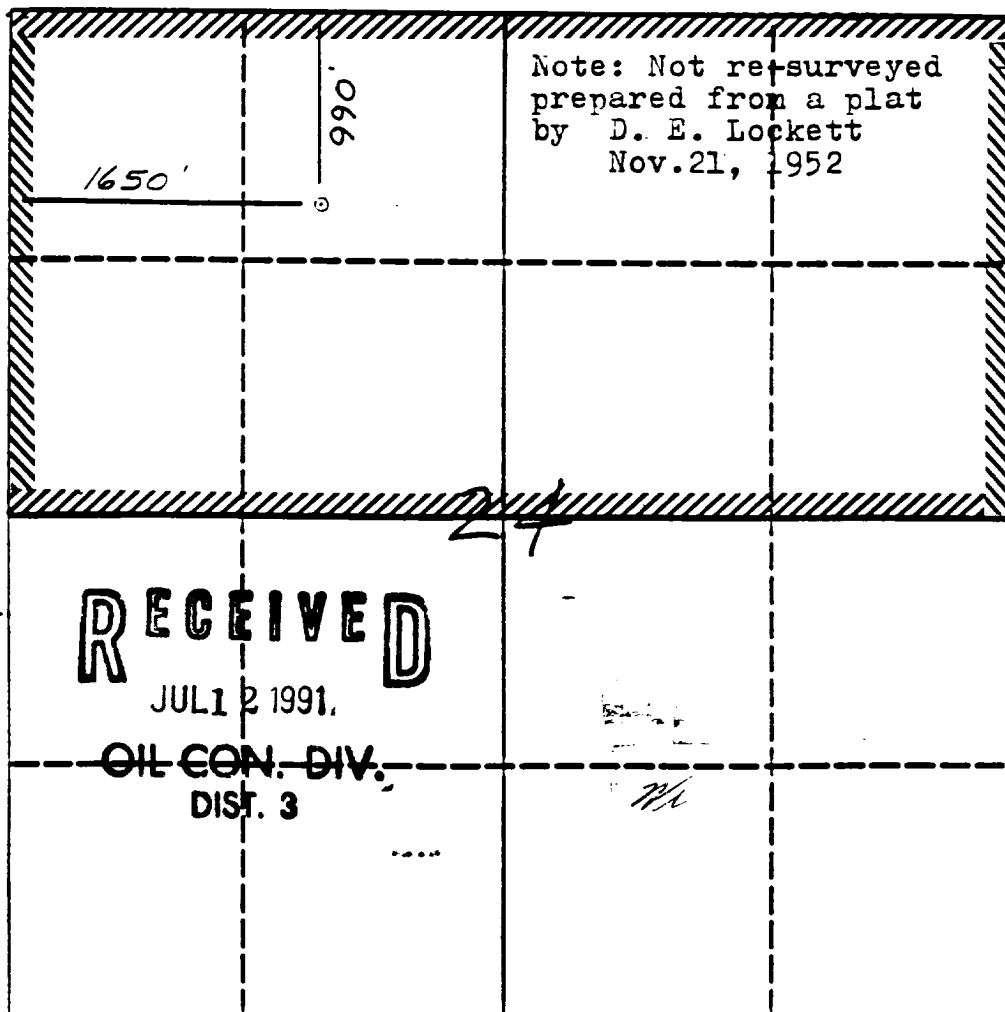

OPERATOR CERTIFICATION

I hereby certify that the information contained herein is true and complete to best of my knowledge and belief.

Signature  
Peggy Bradfield

Printed Name  
Regulatory Affairs

Position  
Meridian Oil Inc.

Company  
1-26-90

Date

SURVEYOR CERTIFICATION

I hereby certify that the well location on this plat was plotted from field notes actual surveys made by me or under supervision, and that the same is true correct to the best of my knowledge and belief.

Date Surveyed  
Neal C. Edwards

Signature of Surveyor  
Professional Surveyor

REGISTERED LAND SURVEYOR  
6857

# OFFSET OPERATOR PLAT

## Lloyd #1

Township 30 North, Range 11 West

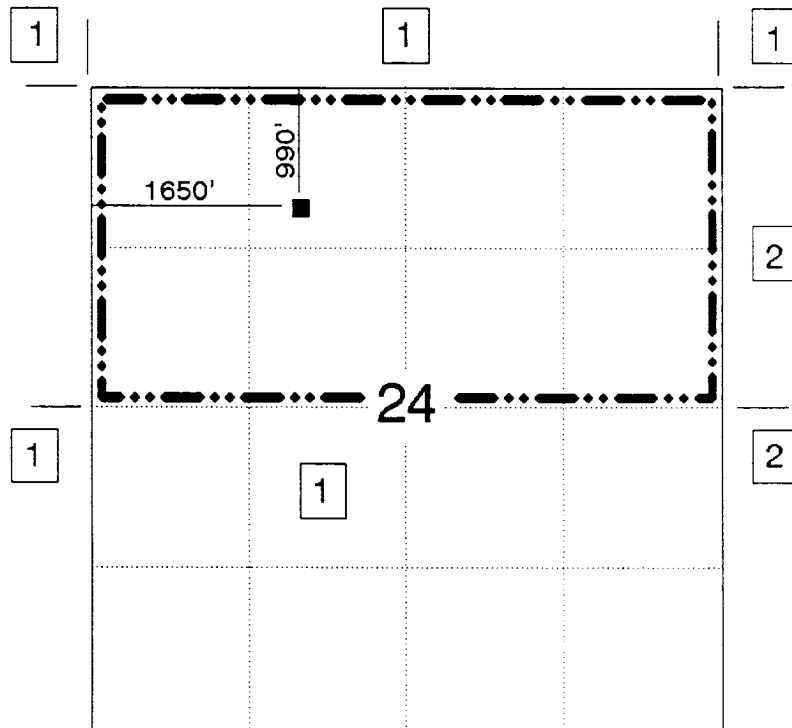

- 1) Meridian Oil Inc.
  - 2) Amoco Production Company  
PO Box 800, Denver, CO 80202
- 
- 
- 
- 
- 
-

Lloyd #1  
990'FNL, 1650'FWL  
Section 24, T-30-N, R-11-W  
San Juan County, New Mexico

I hereby certify that the following offset owners/operators have been notified by certified mail of our application for administrative approval for non-standard gas well location for the plugback and recompletion of the above well.

Amoco Production Company  
Post Office Box 800  
Denver, Colorado 80202

  
Peggy Bradfield  
July 8, 1991

San Juan County  
State of New Mexico

My commission expires August 17, 1992

40

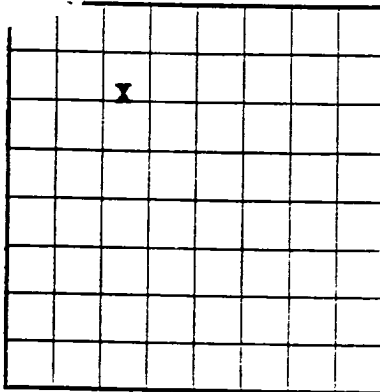

LOCATE WELL CORRECTLY

J. S. LAND OFFICE Santa Fe  
SERIAL NUMBER 078144  
LEASE OR PERMIT TO PROSPECT \_\_\_\_\_

UNITED STATES  
DEPARTMENT OF THE INTERIOR  
GEOLOGICAL SURVEY

LOG OF OIL OR GAS WELL

Company El Paso Natural Gas Company Address P. O. Box 997, Farmington, New Mexico  
Lessor or Tract Lloyd Field Aztec State New Mexico  
Well No. 1 Sec. 24 T. 30N R. 11W Meridian N.M.P.M. County San Juan  
Location 990 ft. {N} of N. Line and 1650 ft. {E.} of W. Line of Section 24 Elevation 6176'  
(Denote gas by G)

The information given herewith is a complete and correct record of the well and all work done thereon so far as can be determined from all available records.

ORIGINAL SIGNED D. E. LOCKETT

Signed \_\_\_\_\_

Date November 21, 1952 Title Petroleum Engineer

The summary on this page is for the condition of the well at above date.

Commenced drilling 11-3, 1952 Finished drilling 11-14-52, 1952

OIL OR GAS SANDS OR ZONES

(Denote gas by G)

No. 1, from 2619 to 2685 (G) No. 4, from \_\_\_\_\_ to \_\_\_\_\_  
No. 2, from \_\_\_\_\_ to \_\_\_\_\_ No. 5, from \_\_\_\_\_ to \_\_\_\_\_  
No. 3, from \_\_\_\_\_ to \_\_\_\_\_ No. 6, from \_\_\_\_\_ to \_\_\_\_\_

IMPORTANT WATER SANDS

No. 1, from \_\_\_\_\_ to \_\_\_\_\_ No. 3, from \_\_\_\_\_ to \_\_\_\_\_  
No. 2, from \_\_\_\_\_ to \_\_\_\_\_ No. 4, from \_\_\_\_\_ to \_\_\_\_\_

CASING RECORD

Size casing	Weight per foot	Threads per inch	Make	Amount	Kind of shoe	Cut and pulled from	Perforated		Purpose
							From—	To—	
<u>8-5/8</u>	<u>26</u>	<u>8</u>	<u>HW</u>	<u>116'</u>	<u>HW</u>	<u>Surface</u>			<u>Surface</u>
<u>5-1/2</u>	<u>15.5</u>	<u>8</u>	<u>HW</u>	<u>2620'</u>	<u>HW</u>	<u>Production</u>			<u>Production</u>
<u>1</u>	<u>1.68</u>	<u>8</u>	<u>HW</u>	<u>2610'</u>	<u>HW</u>	<u>Production</u>			<u>Production</u>

MUDDING AND CEMENTING RECORD

Size casing	Where set	Number sacks of cement	Method used	Mud gravity	Amount of mud used
<u>8-5/8</u>	<u>116'</u>	<u>75</u>	<u>Circulated</u>		
<u>5-1/2</u>	<u>2620'</u>	<u>150</u>	<u>Single Stage</u>		

MARK

Heaving plug—Material ..... Length ..... Depth set .....  
 Adapters—Material ..... Size .....

### SHOOTING RECORD

Size	Shell used	Explosive used	Quantity	Date	Depth shot	Depth cleaned out
2ts	Reg.	S.N.G.	120	11-15-52	2620-2680	2685
2ts	Reg.	S. N. G.	202	12-10-52	2624-2707	2707

### TOOLS USED

Rotary tools were used from ..... feet to 2715 feet, and from ..... feet to ..... feet  
 Cable tools were used from ..... feet to 2715 feet, and from ..... feet to ..... feet  
 Workover

### DATES

December 15, 19 52 Put to producing ..... 19.....

The production for the first 24 hours was ..... barrels of fluid of which ..... % was oil; ..... % emulsion; ..... % water; and ..... % sediment. Gravity, °Bé. ....

If gas well, cu. ft. per 24 hours 560,000 Gallons gasoline per 1,000 cu. ft. of gas .....

Rock pressure, lbs. per sq. in. 590

### EMPLOYEES

....., Driller ..... Driller  
 ..... Driller ..... Driller

### FORMATION RECORD

FROM—	TO—	TOTAL FEET	FORMATION
0	390	390	Tan cr-gr ss w/thin sh breaks.
390	840	450	Varieg sh/with thin ss breaks.
840	1214	374	Tan to gry cr-gr ss interbedded w/gry sh.
1214	1363	149	Ojo Alamo sandstone. White cr-gr sd. T/Ojo Alamo 1214.
1363	2230	867	Kirtland formation. Gry sh interbedded w/tight gry f-gr ss. T/Kirtland 1363.
2230	2619	389	Fruitland formation. Gry carb sh, scattered coal & gry, tight, fine-gr ss. T/Fruitland 2230.
2619	2685	66	Pictured Cliffs formation. Gry, f-gr, tight, vari soft ss. T/Pictured Cliffs 2619.
2685	2715 TD	30	Lewis formation. Gry to white dense sh w/silty to shly ss. breaks. T/Lewis 2685.

(OVER)

16-43094-2

FORMATION RECORD—CONTINUED



UNITED STATES  
DEPARTMENT OF THE INTERIOR  
BUREAU OF LAND MANAGEMENT

SuNDry Notices AND Reports on Wells

1. Type of Well GAS	5. Lease Number SF-078144		
2. Operator Meridian Oil Inc.	6. If INdian, All.or Tribe Name		
3. Address & Phone No. of Operator PO Box 4289, Farmington, NM 87499	7. Unit Agreement Name		
4. Location of Well 990'N, 1650'W	8. Farm or Lease Name Lloyd		
	9. Well No. 1		
	10. Field, Pool, Wildcat Basin FruitlaND Coal		
	11. Sec. T. R. M. or Blk Sec. 24, T-30-N, R-11-W NMMPM		
14. Permit No.	15. Elevations 6166' GR	12. County San Juan	13. State NM
16. Intent to/Subsequent Report of : Recomplete to FruitlaND Coal			
17. Describe proposed or completed operations:			
8-20-89 MOL&RU. NU BOP. TOO H w/127 jts 1" tb g. TIH w/2 3/8" tb g to 2620'. TOO H. SDON.			
8-21-89 TIH, set pkr @ 2612'. Pressure test csg to 2500 psi. Released pkr & TOO H. Ran GR-Neutron & GR-CCL from 1150-1400' and 2150-2620'. TIH & set cmt retainer @ 2612'. SDON.			
8-22-89 TIH w/2 3/8" tb g. Sting into cmt ret @ 2612'. Squeeze Picture Cliff w/20 sx "B" cmt (24 cf). Sting out of ret & reversed out. Circulate hole. POOH to 2505'. Spot acid. TOO H. Perf'd @ 2421-2426', 6 shots, 2440-2444', 5 shots, 2446-2447', 2 shots, 2478-2480', 3 shots, 2498-2499', 2 shots, 2606-2607', 2 shots. TIH w/tb g. SDON.			
8-23-89 Blow well @ 2610'. TOO H w/tb g. SDON.			
8-24-89 Tag btm @ 2609'. Circ hole clean. LaNDED 1 1/4", J-55, 8rd, EUE tb g @ 2510.98', sn @ 2480. ND BOP. NU wh. Rig released.			

18. Authorized by: *Regina Bradford*  
Regulatory Affairs

1-26-90

Date

NOTE: This format is issued in lieu of US BLM Form 3160-5.

=====  
(This space for Federal or State office use)

APPROVED BY \_\_\_\_\_ TITLE \_\_\_\_\_

CONDITION OF APPROVAL, IF ANY:

DATE