

## NEW MEXICO OIL CONSERVATION COMMISSION

Santa Fe, New Mexico

## NOTICE OF INTENTION TO DRILL OR RECOMPLETE

Notice must be given to the District Office of the Oil Conservation Commission and approval obtained before drilling or recompletion begins. If changes in the proposed plan are considered advisable, a copy of this notice showing such changes will be returned to the sender. Submit this notice in QUINTUPLICATE. One copy will be returned following approval. See additional instructions in Rules and Regulations of the Commission.

Farmington, New Mexico

April 21, 1953

(Place)

(Date)

OIL CONSERVATION COMMISSION  
SANTA FE, NEW MEXICO

Gentlemen:

You are hereby notified that it is our intention to commence the (Drilling) (Recompletion) of a well to be known as

El Paso Natural Gas Company

(Company or Operator)

Fuller Pool Unit

(Lease)

Well No. 1, in NW (Unit) The well islocated 990 feet from the North line and 1650 feet from theWest line of Section 22, T. 30N, R. 11W, NMPM.(GIVE LOCATION FROM SECTION LINE) Astec Pool, San Juan CountyIf State Land the Oil and Gas Lease is No. Free LandIf patented land the owner is Mattie FullerAddress Roswell, Georgia (E/2 NW/4)We propose to drill well with drilling equipment as follows Rotary tools to the top of the Pictured Cliffs formation, completing the well with cable tools.The status of plugging bond is Statewide BondDrilling Contractor El Paso Natural Gas CompanyWe intend to complete this well in the Pictured Cliffs formation at an approximate depth of 2278

## CASING PROGRAM

We propose to use the following strings of Casing and to cement them as indicated:

Size of Hole	Size of Casing	Weight per Foot	New or Second Hand	Depth	Sacks Cement
12-1/4	9-5/8"	25.4#	New	100'	75
8-3/4	5-1/2"	15.5#	New	2213'	150

If changes in the above plans become advisable we will notify you immediately.

ADDITIONAL INFORMATION (If recompletion give full details of proposed plan of work.)

The NW/4 of Section 22 is dedicated to this well. It is intended to shoot the well with two quarts S.M.G. per foot. Communitization will be filed as soon as possible.

Other owners: G. Bruington, Astec, New Mexico (SW/4 NW/4)  
I. J. Coury, Farmington, New Mexico (NW/4 NW/4)Approved 4-23, 19 53  
Except as follows:

Sincerely yours,

EL PASO NATURAL GAS COMPANY

(Company or Operator)

By [Signature]Position Petroleum Engineer

Send Communications regarding well to

Name E. J. CoalAddress Box 997, Farmington, New Mexico

OIL CONSERVATION COMMISSION

By Emery C. ArnoldTitle Oil and Gas Inspector Dist. #3.

COMPANY EL PASO NATURAL GAS COMPANY

Well Name & No. Fuller Pool Unit No. 1 Lease No. Fee

Location 990 feet from the North line. 1650 feet from the West line.

Being in NE $\frac{1}{4}$  of the NW $\frac{1}{4}$

Sec. 22, T 30N., R 11W., N.M.P.M., San Juan County, New Mexico

Ground Elevation 5789.36

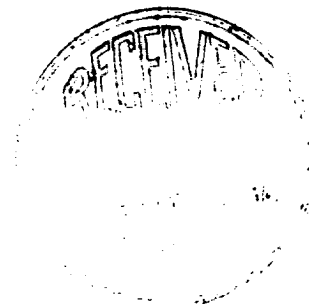
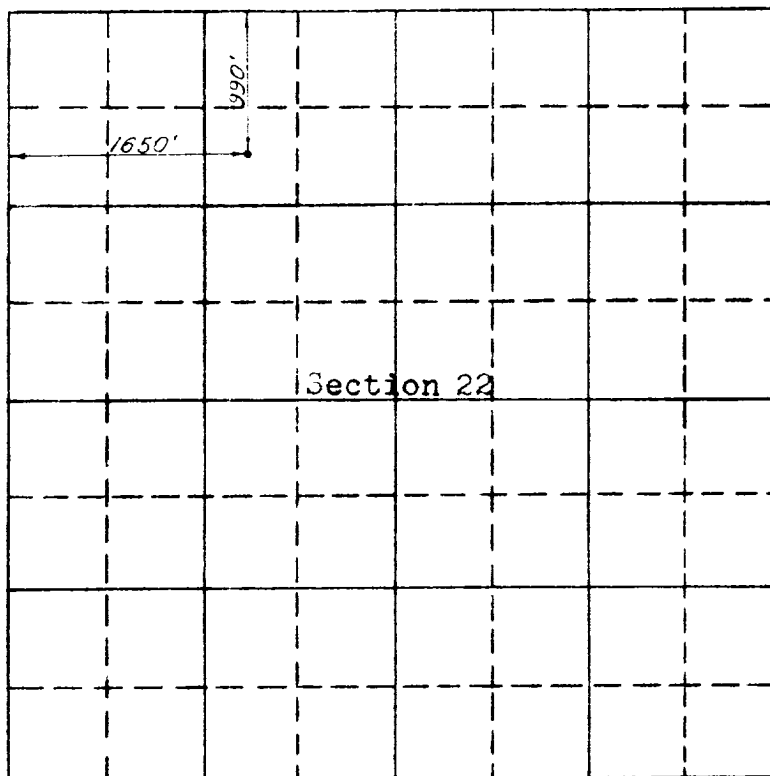

Scale - 4 inches equals 1 mile

Surveyed April 2, 19 53

This is to certify that the above plat was prepared from field notes of actual surveys made by me or under my supervision and that the same are true and correct to the best of my knowledge and belief.

E. O. Walker  
Registered Professional  
Engineer and Land Surveyor.

Seal:

Farmington, New Mexico

OIL CONSERVATION COMMISSION		
AZTEC DISTRICT OFFICE		
No. Copies Received <u>7</u>		
DISTRIBUTION		
	NO. FURNISHED	
Operator	<u>2</u>	
Santa Fe	<u>1</u>	
Promotion Office		
State Land Office	<u>1</u>	
U. S. G. S.	<u>2</u>	
Transporter		
File	<u>1</u>	<input checked="" type="checkbox"/>

NEW MEXICO  
OIL CONSERVATION COMMISSION

Gas Well Plat

Date March 11, 1954

El Paso Natural Gas Company Fuller Pool Unit 1  
Operator Lease Well No.

Name of Producing Formation Picture Cliff Pool Artec

No. Acres Dedicated to the Well 160

Indicate land status and show ownership. Fee

SECTION 22 TOWNSHIP 30N RANGE 11W

Cory, Fee			
	Fuller, Fee		
Bruington, Fee			

I hereby certify that the information given above is true and complete to the best of my knowledge.

ORIGINAL SIGNED E. N. WALSH

Name \_\_\_\_\_  
Position Petroleum Engineer  
Representing El Paso Natural Gas Co.  
Address Farmington, New Mexico

(over)

OIL CONSERVATION COMMISSION		
AZTEC DISTRICT OFFICE		
No. Copies Received		3
DISTRIBUTION		
	NO. FURNISHED	
Operator	1	
Santa Fe		
Proration Office		
State Land Office	1	
U. S. G. S.		
Inspector	1	
		✓

F. Loc. 990/N: 1650/W Elev. 5789GL Spd. 4/20/53 Comp. 6/11/53 TD 3247 PB  
 Casing 9-5/8 @ 121 W 100 Sx. Int. @ W Sx. Pr. 5 1/2 @ 2187 W 150 Sx. T. 1 @ 2222  
 Csg. Perf. Prod. Stim.

Shot 120 qts 2199-2247

LP 1686 ~~85%~~ MCF/D After 3 Hrs. Sic. P. 655 PSI After 11 Days GOR Grav. Ist Del. 7/30/53 EP

TOPS		NWD	Y	Well Log	Y	TEST DATA						
						Schd.	PC	Q	PW	PD	D	AB.
Kirtland	905	C-102	X	Flat	X							
Fruitland	1825	C-103	X	Electric Log	X							
Pictured Cliffs	2185	C-104	X	C-110	X	54	525	288	252	250	288	
Cliff House				Remarks							282	
Menefee						4/14/55	514	303	265	257	308	
Point Lookout						7/24/50	502	263	267	251	273	
Mancos												
Tochito												
Dakota												
Morrison												
Entrada												
PCD	3614											

P Aztec PC San Juan S 22 T 30N R 11W U C Oper. EPNG Loc. Fuller PU No. 1