

(SUBMIT IN TRIPLICATE)

UNITED STATES
DEPARTMENT OF THE INTERIOR
GEOLOGICAL SURVEY

Land Office New Mexico

Lease No. NM-048576

Unit Pan American Federal "C"

			X

SUNDRY NOTICES AND REPORTS ON WELLS

NOTICE OF INTENTION TO DRILL	<input checked="" type="checkbox"/>	SUBSEQUENT REPORT OF WATER SHUT-OFF	<div style="text-align: center;"> RECEIVED JAN 20 1964 U. S. GEOLOGICAL SURVEY FARMINGTON, NEW MEXICO </div>
NOTICE OF INTENTION TO CHANGE PLANS		SUBSEQUENT REPORT OF SHOOTING OR ACIDIZING	
NOTICE OF INTENTION TO TEST WATER SHUT-OFF		SUBSEQUENT REPORT OF ALTERING CASING	
NOTICE OF INTENTION TO RE-DRILL OR REPAIR WELL		SUBSEQUENT REPORT OF RE-DRILLING OR REPAIR	
NOTICE OF INTENTION TO SHOOT OR ACIDIZE		SUBSEQUENT REPORT OF ABANDONMENT	
NOTICE OF INTENTION TO PULL OR ALTER CASING		SUPPLEMENTARY WELL HISTORY	
NOTICE OF INTENTION TO ABANDON WELL			

(INDICATE ABOVE BY CHECK MARK NATURE OF REPORT, NOTICE, OR OTHER DATA)

Pan American Federal "C"

Farmington, New Mexico January 16, 1964

Well No. 2 is located 1190 ft. from N line and 390 ft. from E line of sec. 19

NE 1/4 NE 1/4 Section 19
(1/4 Sec. and Sec. No.)

T-30N
(Twp.)

R-12W
(Range)

N.M.P.M.
(Meridian)

Basin Dakota
(Field)

San Juan
(County or Subdivision)

New Mexico
(State or Territory)

The elevation of the derrick floor above sea level is _____ ft. (To be reported later.)

DETAILS OF WORK

(State names of and expected depths to objective sands; show sizes, weights, and lengths of proposed casings; indicate mudding jobs, cementing points, and all other important proposed work)

We propose to drill the above well to approximately 6650' with rotary tools to evaluate the Dakota zone. Stimulation and completion will be as indicated upon reaching total depth. The following casing program is proposed:

SIZE	DEPTH	CEMENT	REMARKS
8-5/8"	350'	250 sk.	Circulate to surface.
4-1/2"	6650'	First Stage 350 sacks 6% Gel with 1-1/2# Tuf Plug per sack. 100 sacks neat on bottom. Second Stage 1000 sacks 6% Gel cement.	

Two stage tool to be set at about 100' below Mesaverde. A copy of any survey taken will be submitted upon completion of well. Copies of location plat are attached.

I understand that this plan of work must receive approval in writing by the Geological Survey before operations may be commenced.

Company Pan American Petroleum Corporation

Address P. O. Box 480

Farmington, New Mexico

Fred L. Nabors, District Engineer

By _____

Title _____

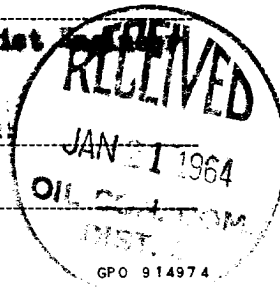

NEW MEXICO OIL CONSERVATION COMMISSION

Well Location and Acreage Dedication Plat

Section A.

Date JANUARY 16, 1964

Operator PAN AMERICAN PETROLEUM CORPORATION Lessee PAN AMERICAN FEDERAL "C"
 Well No. 2 Unit Letter A Section 19 Township 30 NORTH Range 12 WEST, NMPM
 Located 1190 Feet From the NORTH Line 990 Feet From the EAST Line
 County SAN JUAN G. L. Elevation REPORT LATER Dedicated Acreage 318.64 Acres
 Name of Producing Formation DAKOTA Pool EASIN DAKOTA

1. Is the Operator the only owner in the dedicated acreage outlined on the plat below?
 Yes X No _____
2. If the answer to question one is "no", have the interests of all the owners been consolidated by communization agreement or otherwise? Yes _____ No _____ If answer is "yes", Type of Consolidation _____
3. If the answer to question two is "no", list all the owners and their respective interests below:

Owner

Land Description



Section B.

Note: All distances must be from outer boundaries of section.

This is to certify that the information in Section A above is true and complete to the best of my knowledge and belief.

PAN AMERICAN PETROLEUM CORP.

F. H. Hollingsworth

(Representative)

P. O. Box 480

(Address)

Farmington, New Mexico

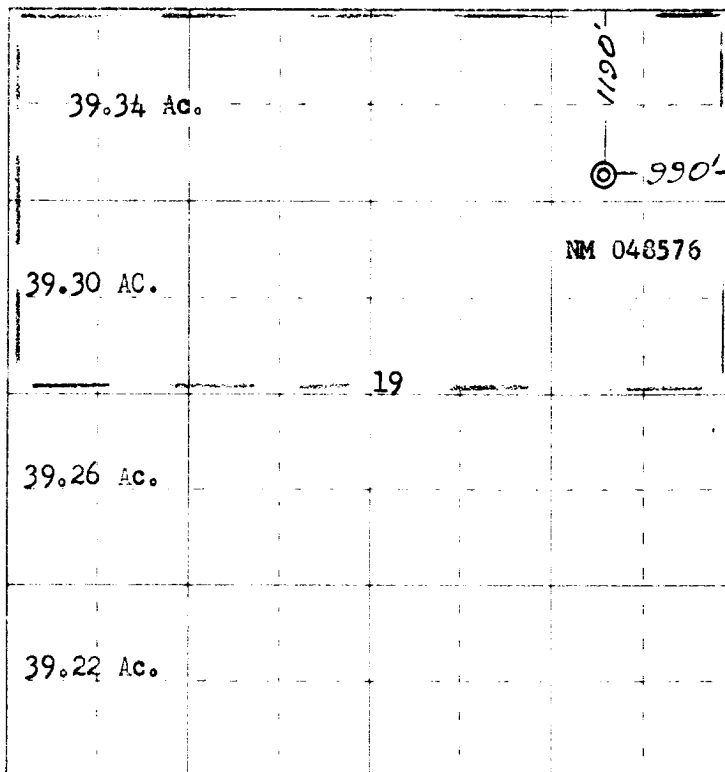

0 330 660 990 1320 1650 1980 2310 2640 2000 1500 1000 500 0

Scale 4 inches equal 1 mile

Ref: GLO plat dated 19 April 1881

This is to certify that the above plat was prepared from field notes of actual surveys made by me or under my supervision and that the same are true and correct to the best of my knowledge and belief.

(Date)

Date Surveyed 8 January 1964

Farmington, New Mexico

James P. Leese
 Registered Professional Engineer and/or Land Surveyor
 James P. Leese N. Mex. Reg. No. 1463
 San Juan Engineering Company