

NEW MEXICO OIL CONSERVATION COMMISSION

Well Location and Acreage Dedication Plat

Section A.

Date July 7, 1959

Operator Elliott Production Company Lease Mary C. Hagwood
Well No. 1 Unit Letter _____ Section 24 Township 30 North Range 14 West NMPM
Located 1050 Feet From North Line, 1040 Feet From East Line
County San Juan G. L. Elevation 5849 Dedicated Acreage 320 Acres
Name of Producing Formation Dakota Pool Undesignated

1. Is the Operator the only owner* in the dedicated acreage outlined on the plat below?
Yes x No _____
2. If the answer to question one is "no," have the interests of all the owners been consolidated by communitization agreement or otherwise? Yes _____ No _____. If answer is "yes,"
Type of Consolidation _____
3. If the answer to question two is "no," list all the owners and their respective interests below:

Owner

Land Description

RECEIVED

JUL 9 1959

OIL CON. COM.
DIST. 3

FEB 27 1959

Section. B

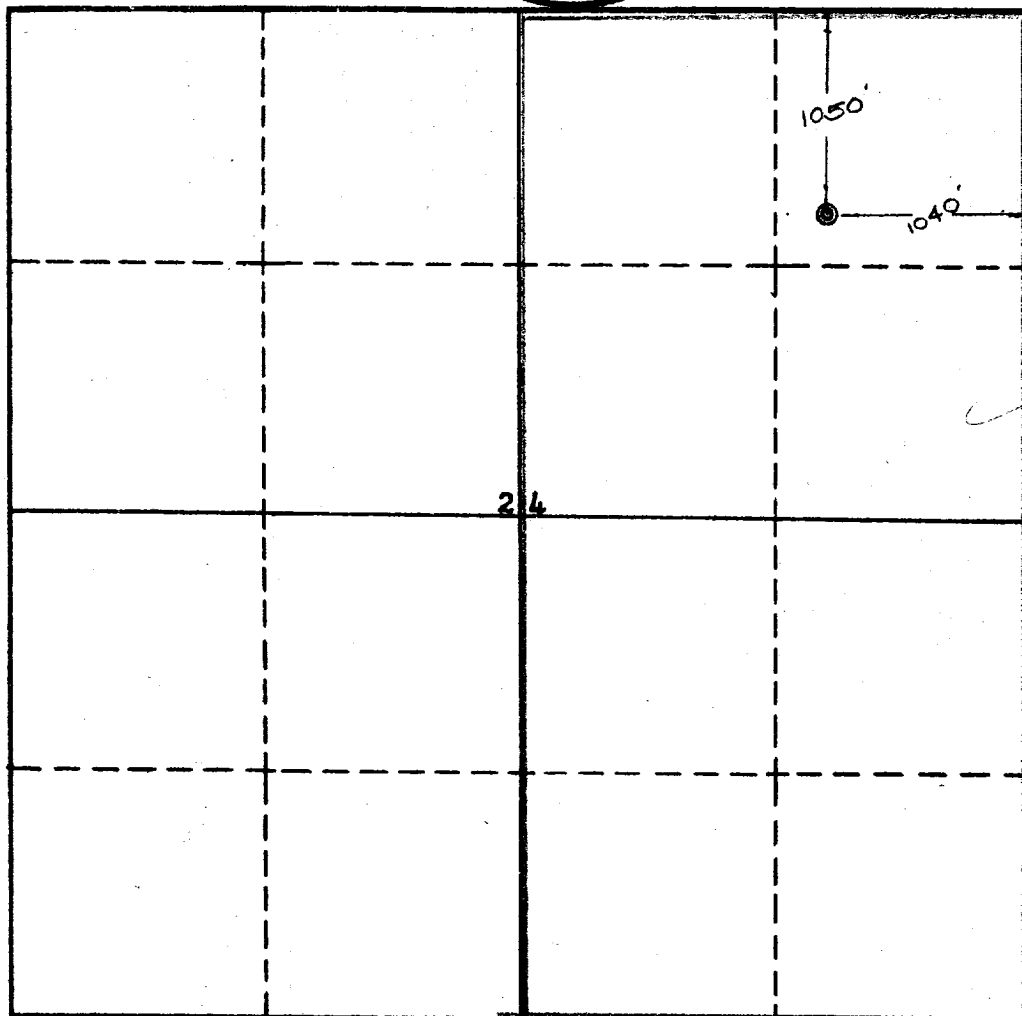

This is to certify that the information in Section A above is true and complete to the best of my knowledge and belief.

ELLIOTT PRODUCTION COMPANY

(Operator)

(Representative)

Box 5669, Roswell, N. M.
Address

This is to certify that the well location shown on the plat in Section B was obtained from field notes, actual surveys made by me or under my supervision, and the same is true to the best of my knowledge and belief.

Date Surveyed Feb. 27, 1959

Ernest V. Echohawk
Ernest V. Echohawk
Registered Land Surveyor.

Certificate No. 1545

OIL CONSERVATION COMMISSION		
AZTEC DISTRICT OFFICE		
No. Copies Received <u>4</u>		
DISTRIBUTION		
	NO. APPROVED	
Operator	/	
Santa Fe	/	
Proration Office		
State Land Office		
U. S. G. S.	/	
Transporter		
File	/	✓