

(SUBMIT IN TRIPLICATE)

UNITED STATES
DEPARTMENT OF THE INTERIOR
GEOLOGICAL SURVEY

Indian Agency _____
Allottee _____
Lease No. **24-02-449-0000**

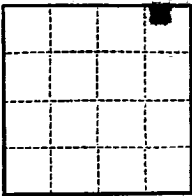

SUNDRY NOTICES AND REPORTS ON WELLS

NOTICE OF INTENTION TO DRILL	<input checked="" type="checkbox"/>	SUBSEQUENT REPORT OF WATER SHUT-OFF	
NOTICE OF INTENTION TO CHANGE PLANS		SUBSEQUENT REPORT OF SHOOTING OR ACIDIZING	
NOTICE OF INTENTION TO TEST WATER SHUT-OFF		SUBSEQUENT REPORT OF ALTERING CASING	
NOTICE OF INTENTION TO REDRILL OR REPAIR WELL		SUBSEQUENT REPORT OF REDRILLING OR REPAIR	
NOTICE OF INTENTION TO SHOOT OR ACIDIZE		SUBSEQUENT REPORT OF ABANDONMENT	
NOTICE OF INTENTION TO PULL OR ALTER CASING		SUPPLEMENTARY WELL HISTORY	
NOTICE OF INTENTION TO ABANDON WELL			

RECEIVED
JUN 18 1958

(INDICATE ABOVE BY CHECK MARK NATURE OF REPORT, NOTICE, OR OTHER DATA) U.S. GEOLOGICAL SURVEY
FARMINGTON, NEW MEXICO

June 20

Well No. **24-02-449-0000** is located **640** ft. from **N** line and **640** ft. from **E** line of sec. **20**
24-02-449-0000 (34 Sec. and Sec. No.) **T 30 N** **R 24 W** **ZONE**
Wildcat (Field) **San Juan** (County or Subdivision) **New Mexico** (State or Territory)

The elevation of the **corner** above sea level is **5432.7** ft.

DETAILS OF WORK

(State names of and expected depths to objective sands; show sizes, weights, and lengths of proposed casings; indicate mudding jobs, cementing points, and all other important proposed work)

Drill 12" hole to 60' and set 8-1/2" csg cemented w/30 cu.
Drill 8" hole to test Guling and Dakota formations to a total
depth of approximately 1000'.

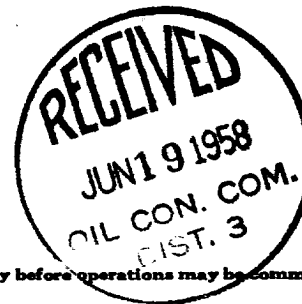

I understand that this plan of work must receive approval in writing by the Geological Survey before operations may be commenced.

Company **King Oil Company**
Address **Vol. 2, Boone & Assoc., Inc.**
120 E. Commercial
Farmington, N.M.
By **0 KEA**
Title **Committing Engineer**

NEW MEXICO OIL CONSERVATION COMMISSION
Well Location and Acreage Dedication Plat

Section A.

Date June 18, 1958

Operator KING OIL COMPANY Lease NAVHWAJE
Well No. 1-2 Unit Letter A Section 20 Township 30 NORTH Range 16 WEST NMPM
Located 660 Feet From the NORTH Line, 660 Feet From the EAST Line
County SAN JUAN G. L. Elevation 3439.7 Dedicated Acreage 40 Acres
Name of Producing Formation Gallup & Dakota Pool Wildcat

1. Is the Operator the only owner* in the dedicated acreage outlined on the plat below?
Yes X No .
2. If the answer to question one is "no," have the interests of all the owners been consolidated by communitization agreement or otherwise? Yes No . If answer is "yes," Type of Consolidation
3. If the answer to question two is "no," list all the owners and their respective interests below:
Ref: GLO plat dated 3 December 1928

Owner

Land Description

Section B

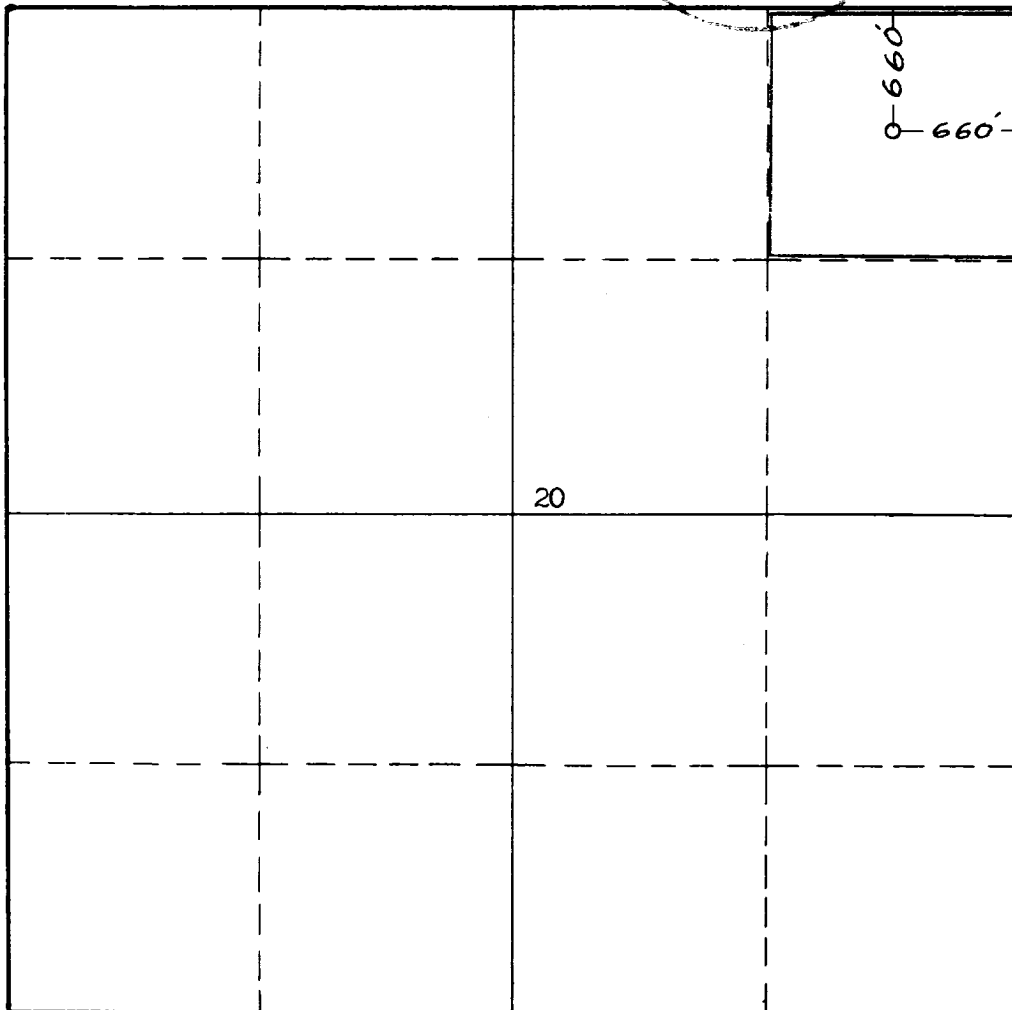

This is to certify that the information in Section A above is true and complete to the best of my knowledge and belief.

King Oil Co.

(Operator)

(Representative)

123 S. Commercial

Barrington, New Mexico

Address

This is to certify that the well location shown on the plat in Section B was plotted from field notes of actual surveys made by me or under my supervision and that the same is true and correct to the best of my knowledge and belief.

Date Surveyed 10 May 1958

James P. Leese
Registered Professional
Engineer and/or Land Surveyor.
JAMES P. LEESE

N. Mex. Certificate No. 1463

INSTRUCTIONS FOR COMPLETION:

1. Operator shall furnish and certify to the information called for in Section A.
2. Operator shall outline the dedicated acreage for both oil and gas wells on the plat in Section B.
3. A registered professional engineer or land surveyor registered in the State of New Mexico or approved by the Commission shall show on the plat the location of the well and certify this information in the space provided.
4. All distances shown on the plat must be from the outer boundaries of Section.
5. If additional space is needed for listing owners and their respective interests as required in question 3, Section A, please use space below

* "Owner" means the person who has the right to drill into and to produce from any pool and to appropriate the production either for himself or for himself and another. (65-3-29 (e) NMSA 1953 Comp.)