

(SUBMIT IN TRIPLICATE)

Land Office **Santa Fe**

Lease No. **077764**

Unit

UNITED STATES
DEPARTMENT OF THE INTERIOR
GEOLOGICAL SURVEY

SUNDRY NOTICES AND REPORTS ON WELLS

NOTICE OF INTENTION TO DRILL
NOTICE OF INTENTION TO CHANGE PLANS
NOTICE OF INTENTION TO TEST WATER SHUT-OFF
NOTICE OF INTENTION TO RE-DRILL OR REPAIR WELL
NOTICE OF INTENTION TO SHOOT OR ACIDIZE
NOTICE OF INTENTION TO PULL OR ALTER CASING
NOTICE OF INTENTION TO ABANDON WELL

XX SUBSEQUENT REPORT OF WATER SHUT-OFF
SUBSEQUENT REPORT OF SHOOTING OR ACIDIZING
SUBSEQUENT REPORT OF ALTERING CASING
SUBSEQUENT REPORT OF RE-DRILLING OR REPAIR
SUBSEQUENT REPORT OF ABANDONMENT
SUPPLEMENTARY WELL HISTORY

INDICATE ABOVE BY CHECK MARK NATURE OF REPORT, NOTICE, OR OTHER DATA

May 25, 1962

Schumacher

Well No. 12 is located 800 ft. from ~~XXXXX~~ line and 800 ft. from ~~XXXXX~~ line of sec. 17

SW/4 Sec. 17 30N 10W N.M.P.M.

Basin Dakota San Juan New Mexico
(State or Territory)

The elevation of the derrick floor above sea level is 6507 ft.

DETAILS OF WORK

State names of soil and rock, and depth to objective section, and sizes, weights, and lengths of proposed casings; indicate mudding jobs, cementing jobs, and other important proposed work.

It is intended to mud drill a well with rotary tools thru the Dakota formation and to perforate and fracture possible producing zones. Est. T. D. 7546'.

Casing Program:

9 5/8" at 280' w/190 sks. cement circulated to surface.

4 1/2" at 7526' w/three stage tool.

Set 2nd stage tool 50' to 100' below base of Mesa Verde.

Cement first stage w/130 sks. to cover 100' above Greenhorn.

Second stage w/200 sks. to cover 100' above Cliff House

Third Stage w/180 sks. to cover Ojo Alamo.

The W/2 of Section 17 is dedicated to this well.

Understand that this work must be done in accordance with the following conditions before operations may be commenced:

Company El Paso Natural Gas Company

Address Box 990

Farmington, New Mexico

By

Title

Petroleum Engineer



Well Location and Acreage Dedication Plat

Section A.

Date **MAY 15, 1962**

Operator **EL PASO NATURAL GAS COMPANY** Lease **SCHUMACHER** SF077764
 Well No. **12** Unit Letter **M** Section **17** Township **30-N** Range **10-W** NMPM
 Located **800** Feet From **SOUTH** Line, **800** Feet From **WEST** Line
 County **SAN JUAN** G. L. Elevation **6367** Dedicated Acreage **320** Acres
 Name of Producing Formation **DAKOTA** Pool **BASIN DAKOTA**

1. Is the Operator the only owner in the dedicated acreage outlined on the plat below?

Yes **X** No

2. If the answer to question one is "no", have the interests of all the owners been consolidated by communization agreement or otherwise? Yes No If answer is "yes", Type of Consolidation.

3. If the answer to question two is "no", list all the owners and their respective interests below:

Owner

Land Description

Section B.

This is to certify that the information in Section A above is true and complete to the best of my knowledge and belief.

El Paso Natural Gas Company

(Operator)

Original Signed **D. W. Meehan**

(Representative)

Box 990

(Address)

Farmington, New Mexico

NOTE:

THIS PLAT REISSUED TO SHOW
CORRECTED ELEVATION.

5 24 62

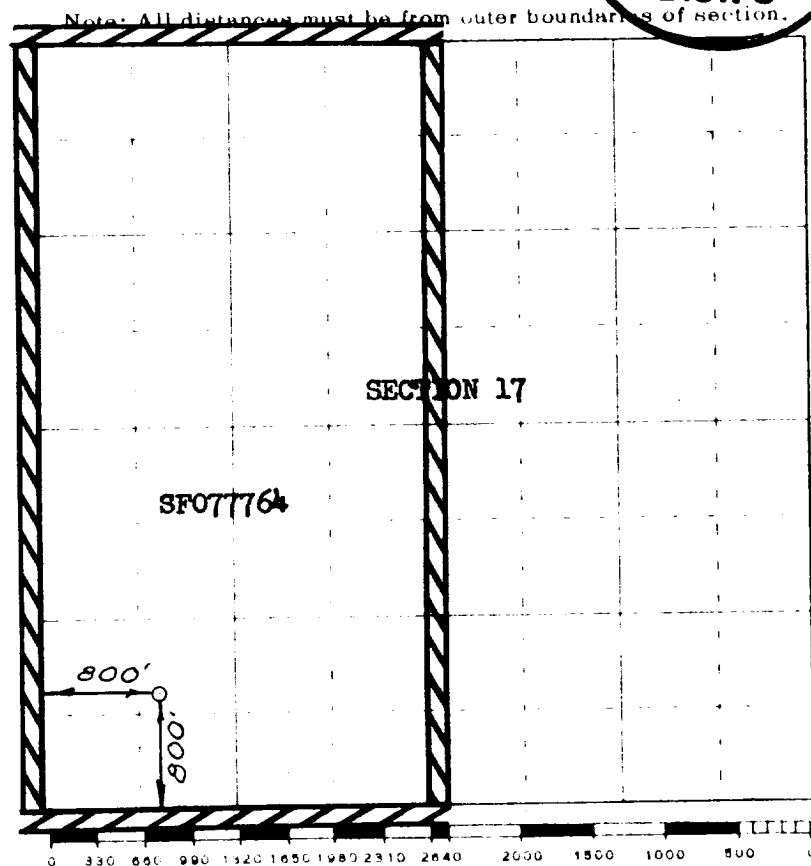

Scale 4 inches equal 1 mile

This is to certify that the above plat was prepared from field notes of actual surveys made by me or under my supervision and that the same are true and correct to the best of my knowledge and belief.

(Seal)

Date Surveyed **MAY 14, 1962**

David O. Kilmer
Registered Professional Engineer and/or Land Surveyor

Farmington, New Mexico