

(SUBMIT IN TRIPLICATE)

UNITED STATES
DEPARTMENT OF THE INTERIOR
GEOLOGICAL SURVEY

Land Office **Santa Fe**
SF-081299-A
Lease No. **J. J. Lemmeri "B"**
Unit _____

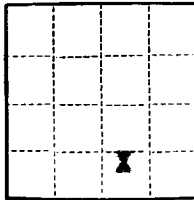

SUNDRY NOTICES AND REPORTS ON WELLS

NOTICE OF INTENTION TO DRILL	<input checked="" type="checkbox"/>	SUBSEQUENT REPORT OF WATER SHUT-OFF	<input checked="" type="checkbox"/>
NOTICE OF INTENTION TO CHANGE PLANS		SUBSEQUENT REPORT OF SHOOTING OR ACIDIZING	
NOTICE OF INTENTION TO TEST WATER SHUT-OFF		SUBSEQUENT REPORT OF ALTERING CASING	
NOTICE OF INTENTION TO RE-DRILL OR REPAIR WELL		SUBSEQUENT REPORT OF RE-DRILLING OR REPAIR	
NOTICE OF INTENTION TO SHOOT OR ACIDIZE		SUBSEQUENT REPORT OF ABANDONMENT	
NOTICE OF INTENTION TO PULL OR ALTER CASING		SUPPLEMENTARY WELL HISTORY	
NOTICE OF INTENTION TO ABANDON WELL			

(INDICATE ABOVE BY CHECK MARK NATURE OF REPORT, NOTICE, OR OTHER DATA)

J. J. Lemmeri "B" **Farmington, New Mexico** **August 7**, 19**59**

Well No. **1** is located **640** ft. from **N** line and **1980** ft. from **E** line of **1/4** of Section **13**
Horrocks Gallup **T-30-N** **R-16-W** **N.M.P.M.**
(1/4 Sec. and Sec. No.) (Twp.) (Range) (Meridian)
Horrocks Gallup **San Juan** **New Mexico**
(Field) (County or Subdivision) (State or Territory)

The elevation of the derrick floor above sea level is _____ ft. (To be reported later.)

DETAILS OF WORK

(State names of and expected depths to objective sands; show sizes, weights, and lengths of proposed casings; indicate mudding jobs, cementing points, and all other important proposed work)

We propose to drill well to an approximate depth of 4100' to test and develop productive Gallup zones. Stimulation will be as indicated upon penetration of Gallup pay. Rotary tools will be used to total depth. Casing program will be as follows:

SIZE	DEPTH	CEMENT	REMARKS
8-5/8"	200'	—	Test - circulate to surface.
4-1/2"	4100'	—	4% gal and test.

Copies of location plat are attached. A copy of any survey taken will be submitted upon completion of well.

I understand that this plan of work must receive approval in writing by the Geological Survey before operations may be commenced.

Company **Pan American Petroleum Corporation**
Address **Box 457**
Farmington, New Mexico
Attn: **L. O. Spear, Jr.**

ORIGINAL SIGNED BY
R. M. Bauer, Jr.
By _____
Title **Area Engineer**

NEW MEXICO OIL CONSERVATION COMMISSION

Well Location and Acreage Dedication Plat

Section A.

Date August 6, 1959

Operator Pan American Petroleum Corporation Lease J. J. Lemmeri "B"
Well No. 1 Unit Letter Q Section 13 Township 30 North Range 14 West NMPM
Located 200 Feet From South Line, 1980 Feet From East Line
County San Juan G. L. Elevation * Dedicated Acreage 40 Acres
Name of Producing Formation Gallup Pool Horseshoe Gallup

1. Is the Operator the only owner* in the dedicated acreage outlined on the plat below?
Yes X No *To be reported later.
2. If the answer to question one is "no," have the interests of all the owners been consolidated by communitization agreement or otherwise? Yes No . If answer is "yes,"
Type of Consolidation
3. If the answer to question two is "no," list all the owners and their respective interests below:

Owner

Land Description

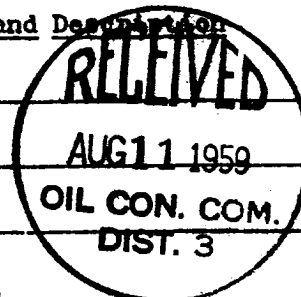

Section B

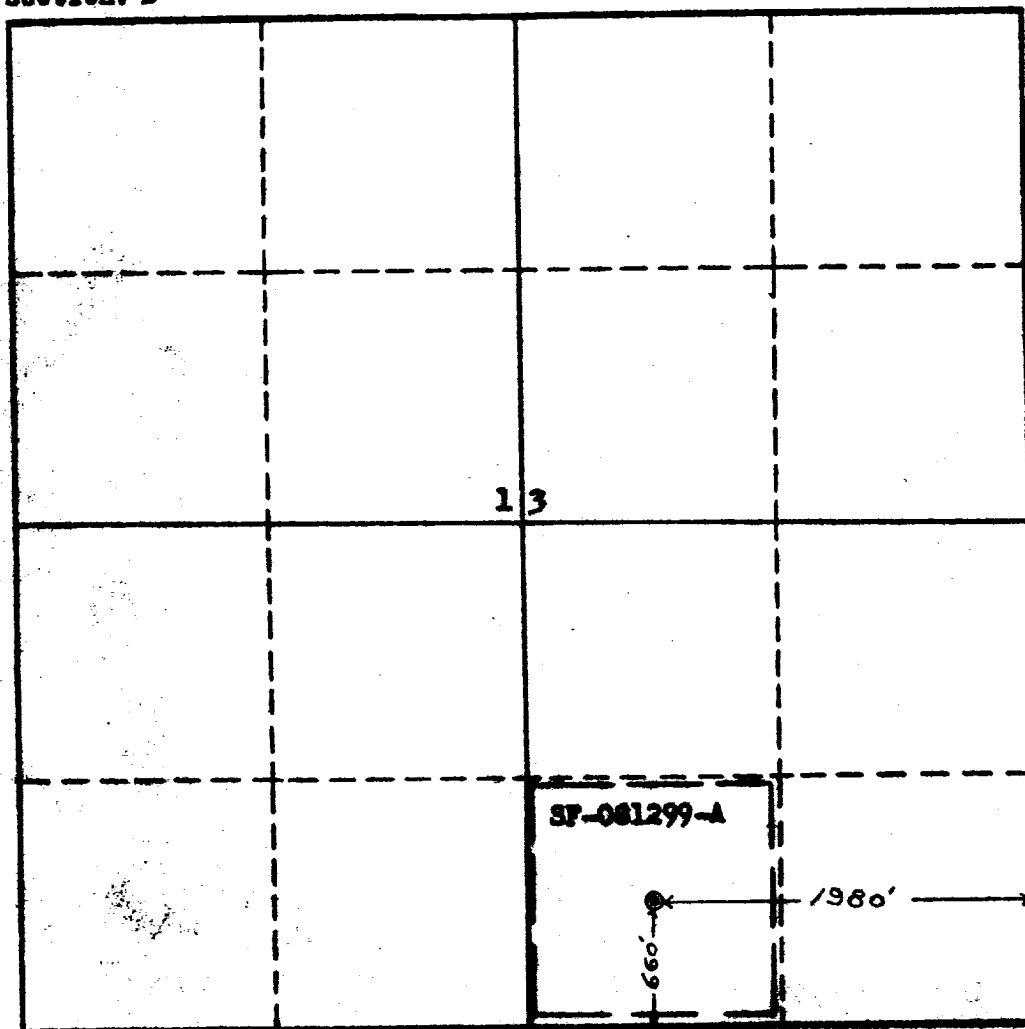

This is to certify that the information in Section A above is true and complete to the best of my knowledge and belief.

Pan American Petroleum Corporation

Operator
R. M. Bauer, Jr.
(Representative)

Box 487, Farmington, New Mexico
Address

This is to certify that the well location shown on the plat in Section B was plotted from field notes of actual surveys made by me or under my supervision and that the same is true and correct to the best of my knowledge and belief.

Date Surveyed August 6, 1959

Ernest V. Echshaw
Ernest V. Echshaw
Registered Land Surveyor.

Certificate No. 1545