

NEW MEXICO OIL CONSERVATION COMMISSION  
Santa Fe, New Mexico

NOTICE OF INTENTION TO DRILL OR RECOMPLETE

Notice must be given to the District Office of the Oil Conservation Commission and approval obtained before drilling or recompletion begins. If changes in the proposed plan are considered advisable, a copy of this notice showing such changes will be returned to the sender. Submit this notice in **QUINTUPLICATE**. One copy will be returned following approval. See additional instructions in Rules and Regulations of the Commission. If State Land submit 6 Copies

**Farmington, New Mexico**

(Place)

**March 9, 1956**

(Date)

OIL CONSERVATION COMMISSION  
SANTA FE, NEW MEXICO

Gentlemen:

You are hereby notified that it is our intention to commence the (Drilling) ~~Recompletion~~ of a well to be known as

**AZTEC OIL & GAS COMPANY**

(Company or Operator)

**Hampton**

(Lease)

Well No. **2**, in **L** (Unit) The well is

located **1850** feet from the **South** line and **790** feet from the

**West**

Line of Section **13**, T. **30-N**, R. **11-W**, NMPM.

(GIVE LOCATION FROM SECTION LINE)

**Astec**

Pool, **San Juan** County

D	C	B	A
E	F	G	H
L	K	J	I
M	N	O	P

If State Land the Oil and Gas Lease is No.

If patented land the owner is **Fee**

Address.

We propose to drill well with drilling equipment as follows: **Rotary and Cable Tools**

The status of plugging bond is **Blanket**

Drilling Contractor **San Juan Drilling Company**

We intend to complete this well in the **Pictured Cliffs** formation at an approximate depth of **2550** feet.

CASING PROGRAM

We propose to use the following strings of Casing and to cement them as indicated:

Size of Hole	Size of Casing	Weight per Foot	New or Second Hand	Depth	Sacks Cement
<b>10 3/4</b>	<b>9 5/8</b>	<b>32.30#</b>	<b>New</b>	<b>100</b>	<b>100</b>
<b>8 5/8</b>	<b>7</b>	<b>20#</b>	<b>New</b>	<b>2550</b>	<b>100</b>
	<b>1</b>	<b>1.70#</b>	<b>New</b>	<b>2525</b>	

If changes in the above plans become advisable we will notify you immediately.

ADDITIONAL INFORMATION (If recompletion give full details of proposed plan of work.)

**Set 9 5/8" casing and drill through Pictured Cliffs formation to an approximate total depth of 2550'. Set 7" casing through Pictured Cliffs. Perforate Pictured Cliffs and sand-water free with approximately 30,000 gallons water and 30,000 lbs. sand. The proration unit of 160 acres, SW 1/4, is assigned.**

Approved **3-10**, 19 **56**  
Except as follows:

Sincerely yours,

**AZTEC OIL & GAS COMPANY**

(Company or Operator)

By **Joe C. Salmon** **MAR 10 1956**  
Position **Drilling Superintendent** **OIL CON. COM.**

Send Communications regarding well to

Name **Joe C. Salmon**

Address **Box 786, Farmington, New Mexico**

OIL CONSERVATION COMMISSION

By **A. R. Kendrick**

COMPANY Astec Oil and Gas Company

Well Name & No. \_\_\_\_\_ Lease No. \_\_\_\_\_

Location 1850' from the South line and 790' from the West line.

Being in NW $\frac{1}{4}$ SW $\frac{1}{4}$

Sec. 13, T30 N., R11 W., N.M.P.M., San Juan County, New Mexico.

Ground Elevation 6037, ungraded ground.

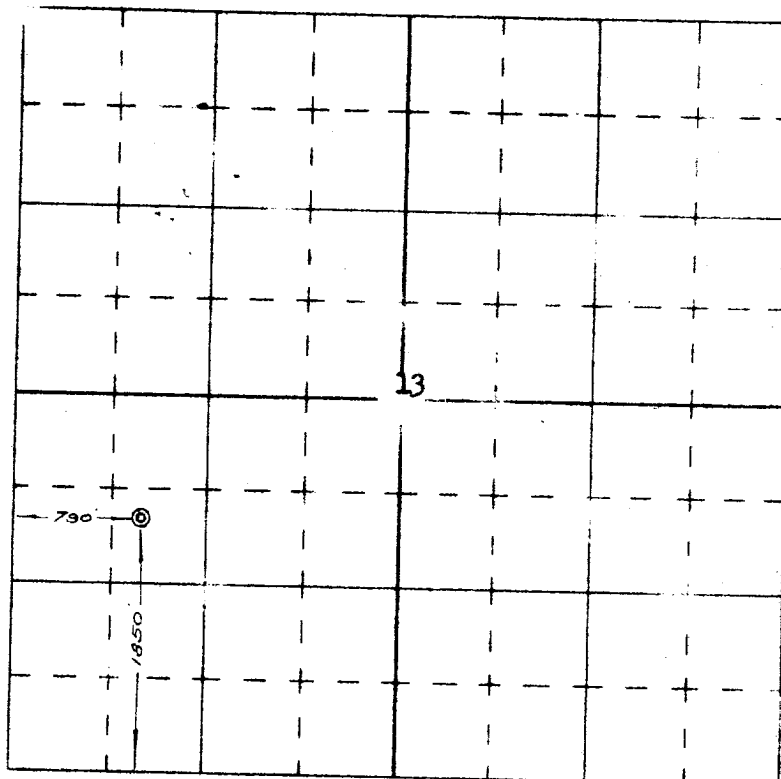

~~RECEIVED~~  
MAR 7 1956  
GEOLOGICAL SURVEY  
SARASOTA, NEW MEXICO

Scale - 4 inches equals 1 mile

Surveyed July 16, 19 55

This is to certify that the above plat was prepared from field notes of actual surveys made by me or under my supervision and that the same are true and correct to the best of my knowledge and belief.

Ernest V. Echshaw

Ernest V. Echshaw  
Registered Land Surveyor  
N. M. Reg. #1545



OIL CONSERVATION COMMISSION		
AZTEC DISTRICT OFFICE		
No. Copies Received <u>6</u>		
DISTRIBUTION		
	40.	
	EX-100-100	
Operator	<u>2</u>	
Santa Fe	<u>1</u>	
Picador Office		
State Land Office		
U. S. G. S.	<u>2</u>	
Transporter		
File	<u>1</u>	<u>✓</u>