

(SUBMIT IN TRIPLICATE)

UNITED STATES  
DEPARTMENT OF THE INTERIOR  
GEOLOGICAL SURVEY

Land Office New Mexico  
Lease No. NH 04407-A  
Unit J. W. Aidlin "C"

SUNDRY NOTICES AND REPORTS ON WELLS

NOTICE OF INTENTION TO DRILL	<input checked="" type="checkbox"/>	SUBSEQUENT REPORT OF WATER SHUT-OFF	
NOTICE OF INTENTION TO CHANGE PLANS		SUBSEQUENT REPORT OF SHOOTING OR ACIDIZING	
NOTICE OF INTENTION TO TEST WATER SHUT-OFF		SUBSEQUENT REPORT OF ALTERING CASING	
NOTICE OF INTENTION TO RE-DRILL OR REPAIR WELL		SUBSEQUENT REPORT OF RE-DRILLING OR REPAIR	
NOTICE OF INTENTION TO SHOOT OR ACIDIZE		SUBSEQUENT REPORT OF ABANDONMENT	
NOTICE OF INTENTION TO PULL OR ALTER CASING		SUPPLEMENTARY WELL HISTORY	
NOTICE OF INTENTION TO ABANDON WELL			

(INDICATE ABOVE BY CHECK MARK NATURE OF REPORT, NOTICE, OR OTHER DATA)

J. W. Aidlin "C"

Farmington, New Mexico, May 12, 1959

Well No. 1 is located 1900 ft. from S line and 895 ft. from E line of sec. 14

SE 1/4 of Section 14  
(1/4 Sec. and Sec. No.)

T-30-N  
(Twp.)

R-16-W  
(Range)

N.M.P.M.  
(Meridian)

Horseshoe Gallup  
(Field)

San Juan  
(County or Subdivision)

New Mexico  
(State or Territory)

The elevation of the derrick floor above sea level is \_\_\_\_\_ ft. (To be reported later.)

DETAILS OF WORK

(State names of and expected depths to objective sands; show sizes, weights, and lengths of proposed casings; indicate mudding jobs, cementing points, and all other important proposed work)

We propose to drill the above well to a depth of approximately 3850' to test and develop productive Gallup zones. Stimulation will be as indicated upon penetration of Gallup pay. Rotary tools will be used to total depth. Casing program will be as follows:

SIZE	DEPTH	CEMENT	REMARKS
8-5/8"	200'	—	Neat - circulate to surface.
5-1/2"	3850'	—	4 1/2 gal and neat.

Copies of location plat are attached. A copy of any survey taken will be submitted upon completion of well.

I understand that this plan of work must receive approval in writing by the Geological Survey before operations may be commenced.

Company Pan American Petroleum Corporation

Address Box 487

Farmington, New Mexico

ORIGINAL SIGNED BY  
By R. M. Bauer, Jr.

Title Area Engineer

NEW MEXICO OIL CONSERVATION COMMISSION

Well Location and Acreage Dedication Plat

Section A.

Date MAY 8, 1959

Operator PAN AMERICAN PETROLEUM CORPORATION Lease J. W. AIDLIN "G"  
Well No. 1 Unit Letter I Section 14 Township 30 NORTH Range 16 WEST NMPN  
Located 1980 Feet From SOUTH Line, 895 Feet From EAST Line  
County SAN JUAN G. L. Elevation \* Dedicated Acreage 40 Acres  
Name of Producing Formation GALLUP Pool HORSESHOE GALLUP

1. Is the Operator the only owner\* in the dedicated acreage outlined on the plat below?  
Yes X No        **\*To be reported later**
2. If the answer to question one is "no," have the interests of all the owners been consolidated by communitization agreement or otherwise? Yes        No       . If answer is "yes,"  
Type of Consolidation
3. If the answer to question two is "no," list all the owners and their respective interests below:

Owner

Land Description

RECEIVED

MAY 14 1959

OIL CON. COM.  
DIST. 3

Section. B

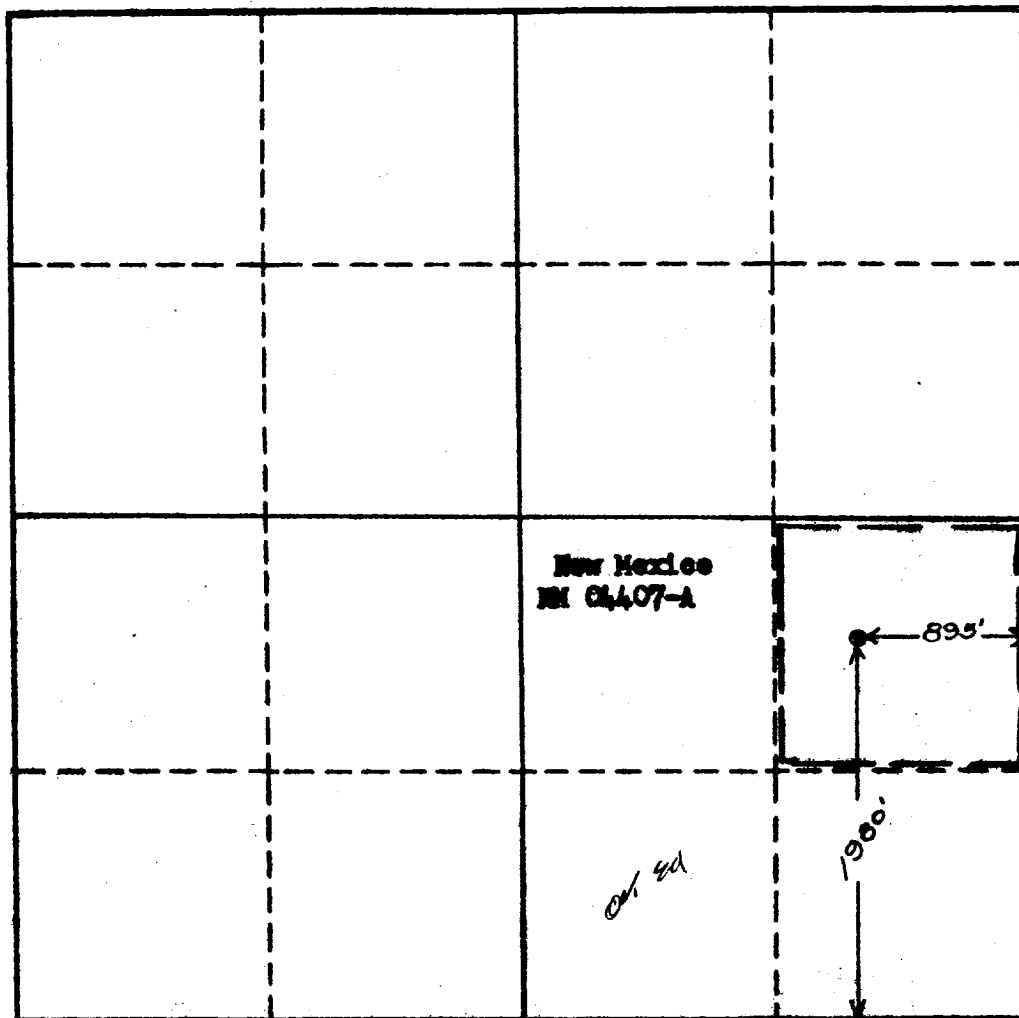

This is to certify that the information in Section A above is true and complete to the best of my knowledge and belief.

PAN AMERICAN PETROLEUM CORP.  
(Operator)

R. M. BAUER, JR. *RMBauer Jr*  
(Representative)

BOX 487, FARMINGTON, N. MEX.  
Address

This is to certify that the well location on the plat is based on actual survey made by me or under my supervision and that the same is true to the best of my knowledge and belief.

Date Surveyed May 7, 1959

*Ernest V. Eshchawk*  
Ernest V. Eshchawk  
Registered Land Surveyor.

Certificate No. 1545