

6-000

1-Tidewater

1-Northwest Prod. NEW MEXICO OIL CONSERVATION COMMISSION

1-Lien

Santa Fe, New Mexico

1-Texas Nat'l.

1-Moncrief

1-D, 1-F

Form C-101  
Revised (12/1/55)

## NOTICE OF INTENTION TO DRILL

Notice must be given to the District Office of the Oil Conservation Commission and approval obtained before drilling or recompletion begins. If changes in the proposed plan are considered advisable, a copy of this notice showing such changes will be returned to the sender. Submit this notice in QUINTUPPLICATE. One copy will be returned following approval. See additional instructions in Rules and Regulations of the Commission. If State Land submit 6 Copies Attach Form C-128 in triplicate to first 3 copies of form C-101

162 Petr. Center Bldg., Farmington, New Mexico

June 2, 1961

(Place)

(Date)

OIL CONSERVATION COMMISSION  
SANTA FE, NEW MEXICO

Gentlemen:

You are hereby notified that it is our intention to commence the Drilling of a well to be known as  
**Southwest Production Company**

(Company, or Operator)

Pearl Wilks

(Lease)

Well No. 1, in A The well is

(Unit)

located 790 feet from the North line and 865 feet from theEastline of Section 14, T. 30N, R. 12W, NMPM.(GIVE LOCATION FROM SECTION LINE) Basin Dakota Pool, San Juan County

If State Land the Oil and Gas Lease is No.....

If patented land the owner is.....

Address.....

We propose to drill well with drilling equipment as follows: RotaryThe status of plugging bond is \$10,000.000 Blanket Bond in Effect.Drilling Contractor Aspen Drilling CompanyP. O. Box 2060Farmington, New MexicoWe intend to complete this well in the Dakota formation at an approximate depth of 6750' or to test the Dakota feet.

## CASING PROGRAM

We propose to use the following strings of Casing and to cement them as indicated:

Size of Hole	Size of Casing	Weight per Foot	New or Second Hand	Depth	Sacks Cement
<u>12 1/2"</u>	<u>9 5/8"</u>	<u>32#</u>	<u>New</u>	<u>300'</u>	<u>250</u>
<u>8 3/4"</u>	<u>4 1/2"</u>	<u>10.50#</u>	<u>New</u>	<u>Total Depth</u>	<u>300 ex or enough</u>
					<u>to cover Gallup</u>
					<u>formation.</u>

If changes in the above plans become advisable we will notify you immediately.

ADDITIONAL INFORMATION (If recompletion give full details of proposed plan of work.)

**DW tools will be placed for the protection of the Pictured Cliffs & Mesaverde formations.**

Approved..... 6-5, 1961

Except as follows:

Sincerely yours,

**Southwest Production Company**

Original signed by (Company or Operator)

By Carl W. SmithPosition Production Superintendent

Send Communications regarding well to

Name Southwest Production CompanyAddress 162 Petr. Center Bldg., Farmington, N.M.

OIL CONSERVATION COMMISSION

By

*Emilio P. Amos*



NUMBER OF COPIES RECEIVED	
DISTRIBUTION	
SANTA FE	
FILE	
U.S.G.S.	
LAND OFFICE	
TRANSPORTER	OIL GAS
PRODUCTION OFFICE	
OPERATOR	

**NEW MEXICO OIL CONSERVATION COMMISSION**  
**WELL LOCATION AND ACREAGE DEDICATION PLAT**  
 SEE INSTRUCTIONS FOR COMPLETING THIS FORM ON THE REVERSE SIDE

FORM C-128  
 Revised 5/1/57

**SECTION A**

Operator <b>SOUTHWEST PRODUCTION COMPANY</b>		Lease <b>PEARL WILKS</b>		Well No. <b>1</b>
Unit Letter <b>A</b>	Section <b>14</b>	Township <b>30 NORTH</b>	Range <b>12 WEST</b>	County <b>SAN JUAN</b>
Actual Footage Location of Well: <b>790</b> feet from the <b>NORTH</b> line and <b>865</b> feet from the <b>EAST</b> line				
Ground Level Elev. <b>5641.0</b>	Producing Formation <b>DAKOTA</b>	Pool <b>BASIN DAKOTA</b>	Dedicated Acreage: <b>1/320</b> Acres	

Ref: GLO plat dated 7 April 1881

1. Is the Operator the only owner in the dedicated acreage outlined on the plat below? YES ☒ NO ☐ ("Owner" means the person who has the right to drill into and to produce from any pool and to appropriate the production either for himself or for himself and another. (65-3-29 (e) NMSA 1935 Comp.)
2. If the answer to question one is "no," have the interests of all the owners been consolidated by communitization or otherwise? YES ☐ NO ☐ . If answer is "yes," Type of Consolidation \_\_\_\_\_
3. If the answer to question two is "no," list all the owners and their respective interests below:

Owner	Land Description

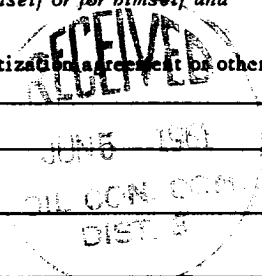

**SECTION B**

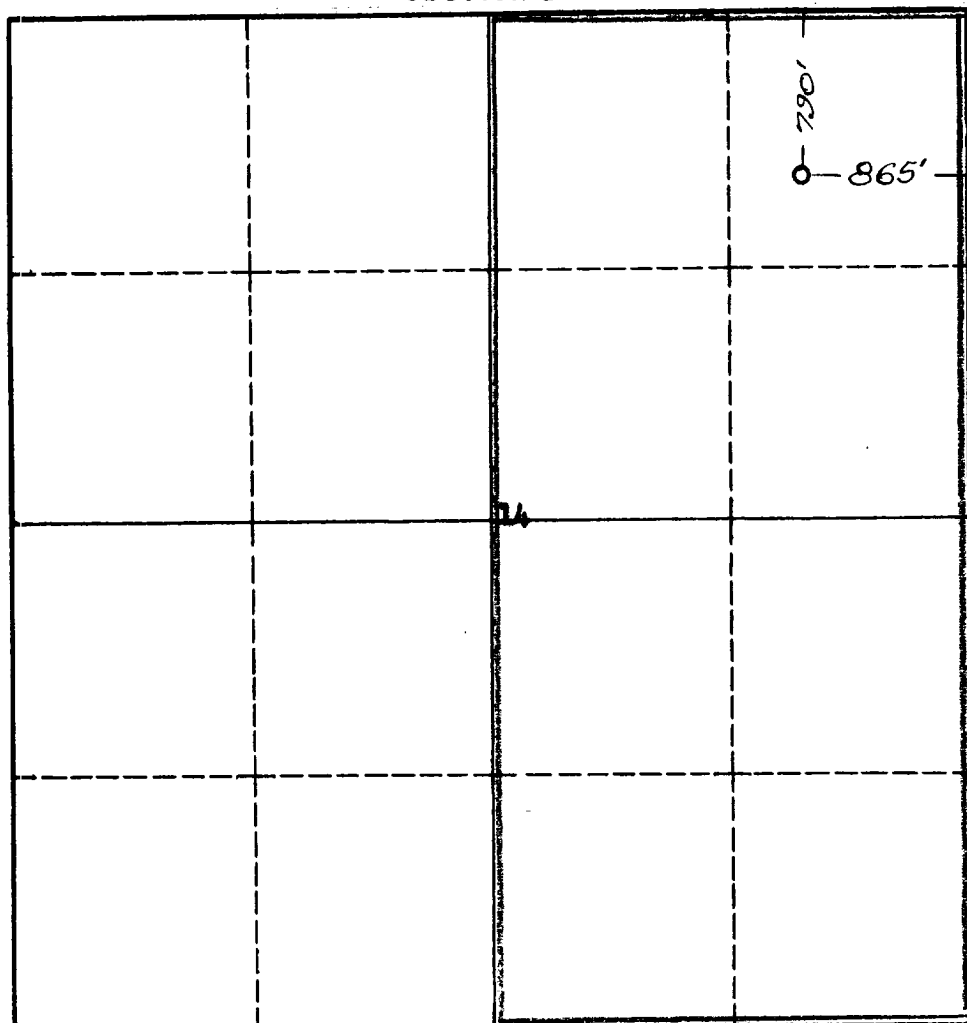

**CERTIFICATION**

I hereby certify that the information in SECTION A above is true and complete to the best of my knowledge and belief.

Name	Original signed by <b>Carl W. Smith</b>
Position	<b>Production Superintendent</b>
Company	<b>Southwest Production Co.</b>
Date	<b>6/2/61</b>

I hereby certify that the well location shown on the plat in SECTION B was plotted from field notes of actual surveys made by me or under my supervision, and that the same is true and correct to the best of my knowledge and belief.

Date Surveyed	<b>17 April 1961</b>
Registered Professional Engineer and/or Land Surveyor	<b>James P. Leese</b>
Certificate No.	<b>1463</b>

0 330 660 990 1320 1650 1980 2310 2640 2000 1500 1000 500 0

## INSTRUCTIONS FOR COMPLETION OF FORM C-128

1. Operator shall furnish and certify to the information called for in Section A.
2. Operator shall outline the dedicated acreage for *both* oil and gas wells on the plat in Section B.
3. A registered professional engineer or land surveyor registered in the State of New Mexico or approved by the Commission shall show on the plat the location of the well and certify this information in the space provided.
4. All distances shown on the plat must be from the outer boundaries of the Section.
5. If additional space is needed for listing owners and their respective interests as required in question 3 of Section A, please use space below.