

(SUBMIT IN TRIPLICATE)

Indian Agency \_\_\_\_\_

UNITED STATES  
DEPARTMENT OF THE INTERIOR  
GEOLOGICAL SURVEY

Allocation No. ~~11020-603-2028~~

Lease No. \_\_\_\_\_

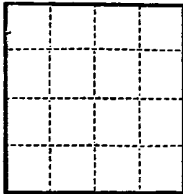

SUNDRY NOTICES AND REPORTS ON WELLS

NOTICE OF INTENTION TO DRILL	<input checked="" type="checkbox"/>	SUBSEQUENT REPORT OF WATER SHUT-OFF	
NOTICE OF INTENTION TO CHANGE PLANS		SUBSEQUENT REPORT OF SHOOTING OR ACIDIZING	
NOTICE OF INTENTION TO TEST WATER SHUT-OFF		SUBSEQUENT REPORT OF ALTERING CASING	
NOTICE OF INTENTION TO REDRILL OR REPAIR WELL		SUBSEQUENT REPORT OF REDRILLING OR REPAIR	
NOTICE OF INTENTION TO SHOOT OR ACIDIZE		SUBSEQUENT REPORT OF ABANDONMENT	
NOTICE OF INTENTION TO PULL OR ALTER CASING		SUPPLEMENTARY WELL HISTORY	
NOTICE OF INTENTION TO ABANDON WELL			

RECEIVED  
JUN 7 1960

(INDICATE ABOVE BY CHECK MARK NATURE OF REPORT, NOTICE, OR OTHER DATA)

U. S. GEOLOGICAL SURVEY  
FARMINGTON, NEW MEXICO

June 6, 1960

NAVAJO - 28

Well No. 1 is located 990 ft. from XX N line and 2310 ft. from XXE W line of sec. 15  
NE 1/4 Sec 15 30-N 17-W NMP

Chimney Rock Cal. San Juan New Mexico.  
(Field) (County or Subdivision) (State or Territory)  
5243

The elevation of the derrick floor above sea level is \_\_\_\_\_ ft.

DETAILS OF WORK

(State names of and expected depths to objective sands; show sizes, weights, and lengths of proposed casings; indicate mudding jobs, cementing points, and all other important proposed work)

Drill with Rotary tools and using Air to 800' or top of  
Sanastee formation, log, and test formation. If productive,  
set 4 1/2" casing and complete well natural.



I understand that this plan of work must receive approval in writing by the Geological Survey before operations may be commenced.

Company Empire States Drilling Corporation  
Address Box 891  
Farmington, New Mexico.  
By M. E. Jackson  
Title President

DEPARTMENT OF THE INTERIOR

UNITED STATES

DEPARTMENT OF THE INTERIOR

AGRICULTURAL SERVICE

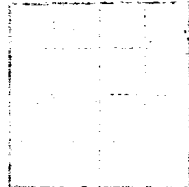

### SUNDRY NOTICES AND REPORTS ON WELLS

NAME OF WELL	...
LOCATION	...
DATE OF INSPECTION	...
...	...

THIS REPORT IS TO BE FILED IN THE OFFICE OF THE DISTRICT ENGINEER AT THE DISTRICT OFFICE OF THE AGRICULTURAL SERVICE, DEPARTMENT OF THE INTERIOR, AT THE FOLLOWING ADDRESS:

Well No. \_\_\_\_\_ is located \_\_\_\_\_ from \_\_\_\_\_

\_\_\_\_\_

The elevation of the ditch from the top of the well is \_\_\_\_\_

#### DETAILS OF WORK

Enter the date of work, amount of water, and other details of the work done in this section.

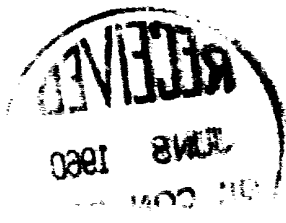

I understand that the above information is true and correct to the best of my knowledge and belief.

Signature: \_\_\_\_\_

Address: \_\_\_\_\_

177

NEW MEXICO OIL CONSERVATION COMMISSION

Well Location and Acreage Dedication Plat

Date 6-1-60

Section A.

Operator Empire States Drilling Corporation Lease Navajo 28  
Well No. 1 Unit Letter B Section 15 Township 30 North Range 17 West NMPN  
Located 990 Feet From North Line, 2310 Feet From East Line  
County San Juan G. L. Elevation 5243 Dedicated Acreage 40 Acres  
Name of Producing Formation Gallup Pool Chimney Rock

1. Is the Operator the only owner\* in the dedicated acreage outlined on the plat below?  
Yes  No
2. If the answer to question one is "no," have the interests of all the owners been consolidated by communitization agreement or otherwise? Yes  No . If answer is "yes,"  
Type of Consolidation \_\_\_\_\_
3. If the answer to question two is "no," list all the owners and their respective interests below:

<u>Owner</u>	<u>Land Description</u>

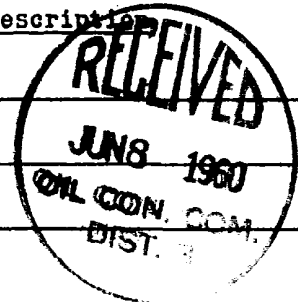

Section B

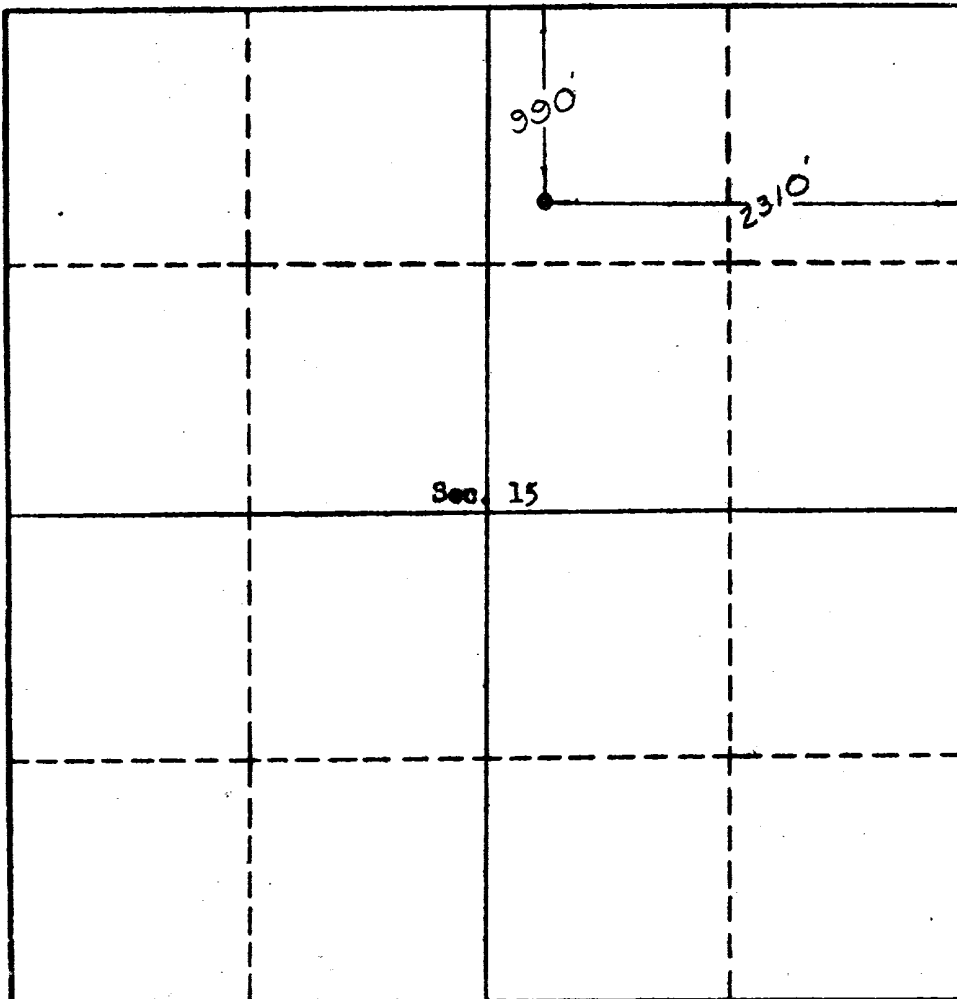

This is to certify that the information in Section A above is true and complete to the best of my knowledge and belief.

Empire States Drlg. Corp.  
(Operator)

P.O. Jackson  
(Representative)

Box 891, Farmington, N.M.  
Address

This is to certify that the well location shown on this plat in Section B was located from first order or second order survey made by me or under my supervision and that the same is true to the best of my knowledge and belief.

Date Surveyed May 27, 1960

Ernest V. Echohawk  
Ernest V. Echohawk  
Registered Land Surveyor.

Certificate No. 1545

1919  
MAY  
100 110