

(SUBMIT IN TRIPLICATE)

UNITED STATES
DEPARTMENT OF THE INTERIOR
GEOLOGICAL SURVEY

Indian Agency _____

Window Rock, Arizona

Allottee _____

Lease No. 14-20-603-3022

SUNDRY NOTICES AND REPORTS ON WELLS

NOTICE OF INTENTION TO DRILL	<input checked="" type="checkbox"/>	SUBSEQUENT REPORT OF WATER SHUT-OFF	
NOTICE OF INTENTION TO CHANGE PLANS		SUBSEQUENT REPORT OF SHOOTING OR ACIDIZING	
NOTICE OF INTENTION TO TEST WATER SHUT-OFF		SUBSEQUENT REPORT OF ALTERING CASING	
NOTICE OF INTENTION TO REDRILL OR REPAIR WELL		SUBSEQUENT REPORT OF REDRILLING OR REPAIR	
NOTICE OF INTENTION TO SHOOT OR ACIDIZE		SUBSEQUENT REPORT OF ABANDONMENT	
NOTICE OF INTENTION TO PULL OR ALTER CASING		SUPPLEMENTARY WELL HISTORY	
NOTICE OF INTENTION TO ABANDON WELL			

(INDICATE ABOVE BY CHECK MARK NATURE OF REPORT, NOTICE, OR OTHER DATA)

May 2, 1961

Well No. Navajo 1-A is located 330 ft. from N line and 3312 ft. from E line of sec. 16

NE 1/4 Sec. 16

(1/4 Sec. and Sec. No.)

30 North 17 West

(Twp.)

(Range)

N.M.P.M.

(Meridian)

Wildcat

(Field)

San Juan

(County or Subdivision)

New Mexico

(State or Territory)

The elevation of the derrick floor above sea level is _____ ft.

DETAILS OF WORK

(State names of and expected depths to objective sands; show sizes, weights, and lengths of proposed casings; indicate mudding jobs, cementing points, and all other important proposed work)

It is intended to drill an 8 3/4" surface hole to 20 ft. and run and cement 20 ft. of 6 1/2" casing with 5 sacks of cement.

After cement has set a 4 3/4" hole will be drilled through the Sanctee formation (approx. 350'), using air as a circulating medium.

Completion procedure will be determined by fluid or gas encountered, logs and samples.

I understand that this plan of work must receive approval in writing by the Geological Survey before operations may be commenced.

Company Drilling & Coring Exploration Co.

Address 1809 Laguna

Farmington, New Mexico

By

Carl E. Harmon

Title

Proprietor

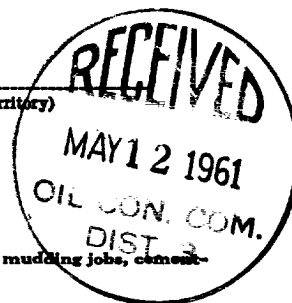

NEW MEXICO OIL CONSERVATION COMMISSION

Well Location and Acreage Dedication Plat

SECTION A.

Date **May 8, 1961**

Operator **Drilling & Coring Exploration Company** Lease **NAVAJO**
Well No. **1** Unit Letter **A** Section **16** Township **30 North** Range **17 West** **134PM**
Located **330** Feet From **North** Line, **2310** Feet From **East** Line
County **San Juan** G. L. Elevation **5218** Dedicated Acreage **40** Acres
Name of Producing Formation **Gallup** Pool **Wildcat**

1. Is the Operator the only owner* in the dedicated acreage outlined on the plat below? Yes ☐ No ☒
2. If the answer to question One is "No," have the interests of all the owners been consolidated by communitization agreement or otherwise? Yes ☒ No ☐ If answer is "Yes," Type of Consolidation **Federal**
3. If the answer to question Two is "No," list all the owners and their respective interests below.

OWNER

LAND DESCRIPTION

SECTION B.

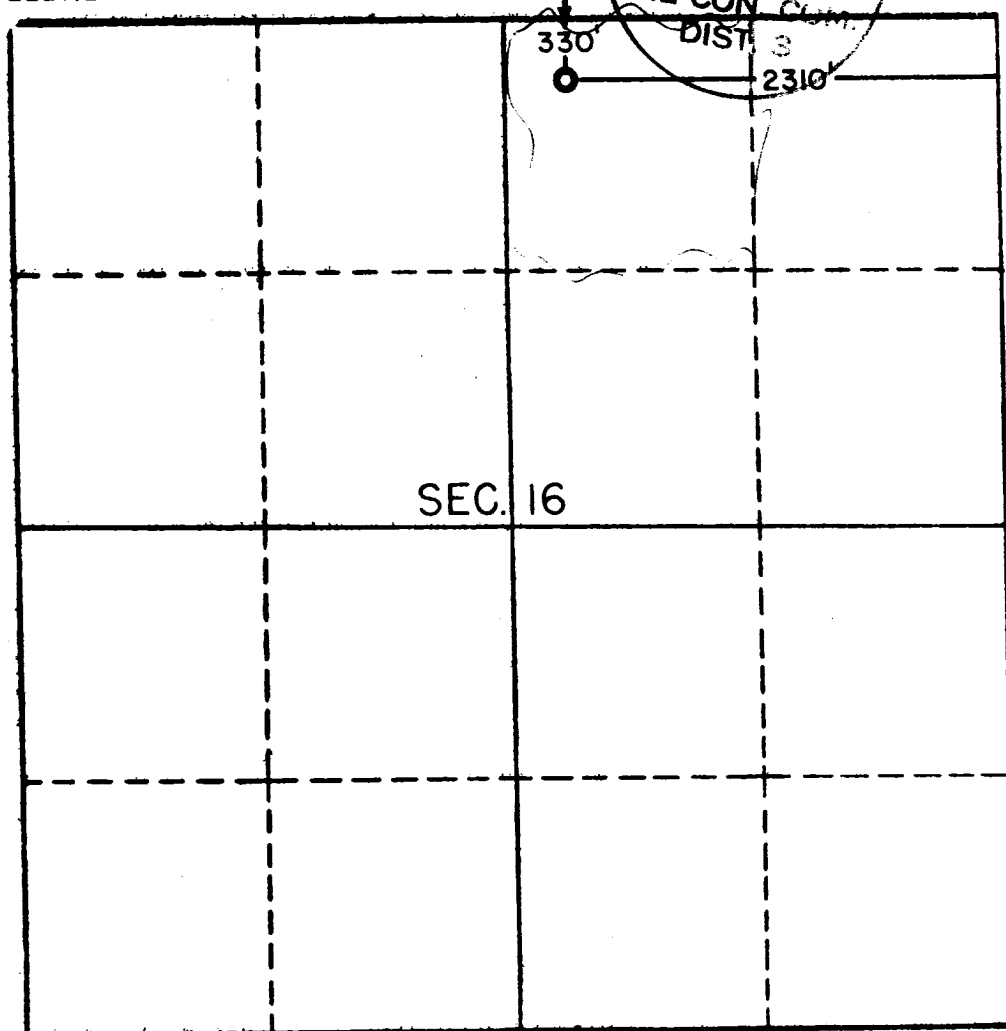

This is to certify that the information in Section A above is true and complete to the best of my knowledge and belief.

Drilling & Coring Expl. Co.

(OPERATOR)
Carl E. Harmon, Prop.

Carl E. Harmon
(REPRESENTATIVE)

1809 Laguna
Farmington, N. M.

This is to certify that the information shown on this plat was plotted from a true survey by my supervisor and is true and correct to my knowledge and belief.

Date Surveyed **May 7, 1961**

Four States Engineering Co.
FARMINGTON, NEW MEXICO

C. L. Blat
REGISTERED ENGINEER OR
LAND SURVEYOR

Certificate No **3084**

