

(SUBMIT IN TRIPLICATE)

Indian Agency Navajo

UNITED STATES
DEPARTMENT OF THE INTERIOR
GEOLOGICAL SURVEY

Allotted Humble O & R Co.
Lease No. 14-20-603-1252

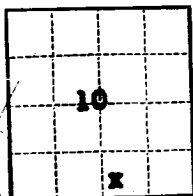

SUNDRY NOTICES AND REPORTS ON WELLS

RECEIVED
NOV 28 1962

NOTICE OF INTENTION TO DRILL	<input checked="" type="checkbox"/>	SUBSEQUENT REPORT OF WATER SHUT-OFF	
NOTICE OF INTENTION TO CHANGE PLANS		SUBSEQUENT REPORT OF SHOOTING OR ACIDIZING	
NOTICE OF INTENTION TO TEST WATER SHUT-OFF		SUBSEQUENT REPORT OF ALTERING CASING	
NOTICE OF INTENTION TO REDRILL OR REPAIR WELL		SUBSEQUENT REPORT OF REDRILLING OR REPAIRS	
NOTICE OF INTENTION TO SHOOT OR ACIDIZE		SUBSEQUENT REPORT OF ABANDONMENT	
NOTICE OF INTENTION TO PULL OR ALTER CASING		SUPPLEMENTARY WELL HISTORY	
NOTICE OF INTENTION TO ABANDON WELL			

(INDICATE ABOVE BY CHECK MARK NATURE OF REPORT, NOTICE, OR OTHER DATA)

Well No. 22 is located 360 ft. from N line and 2125 ft. from E line of sec. 10
SW 1/4 Sec. 10, 30 N 18 W NMPM
(1/4 Sec. and Sec. No.) (Twp.) (Range) (Meridian)
Wilcox San Juan New Mexico
(Field) (County or Subdivision) (State or Territory)

The elevation of the ~~surface~~ ^{ground} above sea level is 4899 ft.

DETAILS OF WORK

(State names of and expected depths to objective sands; show sizes, weights, and lengths of proposed casings; indicate mudding jobs, cementing points, and all other important proposed work)

Objective Sands: Gallup ss. - 450ft.; Dakota ss. - 950 ft.

Casing Program: 60 ft. 8 5/8" 24# Surface casing - cemented to surface
 450 ft. 4 1/2" (Gallup), or 1000 ft. 4 1/2" 9# (Dakota)
 production casing - cemented as necessary.



I understand that this plan of work must receive approval in writing by the Geological Survey before operations may be commenced.

Company Leora O. Shaw
 Address 1007 West Apache Street
Farmington, New Mexico
OK

By Lee W. Kilgore
 Title Agent

NUMBER OF COPIES RECEIVED	
DISTRIBUTION	
SANTA FE	
FILE	
U.S.G.S.	
LAND OFFICE	
TRANSPORTER	OIL GAS
PRODUCTION OFFICE	
OPERATOR	

NEW MEXICO OIL CONSERVATION COMMISSION
WELL LOCATION AND ACREAGE DEDICATION PLAT
 SEE INSTRUCTIONS FOR COMPLETING THIS FORM ON THE REVERSE SIDE

FORM C-128
 Revised 5/1/57

SECTION A

Operator Leora C. Shaw		Lease Nav. Tribe 14-20-603-1252		Well No. Hartley-Navajo # 2
Unit Letter 0	Section 10	Township 30N	Range 18W	County San Juan
Actual Footage Location of Well: 360 feet from the South line and 2125 feet from the EAST line				
Ground Level Elev. 1899	Producing Formation Gallup & Dakota	Pool wildcat	Dedicated Acreage: 40 Acres	

1. Is the Operator the only owner in the dedicated acreage outlined on the plat below? YES ☒ NO ____ . ("Owner" means the person who has the right to drill into and to produce from any pool and to appropriate the production either for himself or for himself and another. (65-3-29 (e) NMSA 1935 Comp.)
2. If the answer to question one is "no," have the interests of all the owners been consolidated by communitization agreement or otherwise? YES ____ NO ____ . If answer is "yes," Type of Consolidation _____
3. If the answer to question two is "no," list all the owners and their respective interests below:

Owner	Land Description

SECTION B

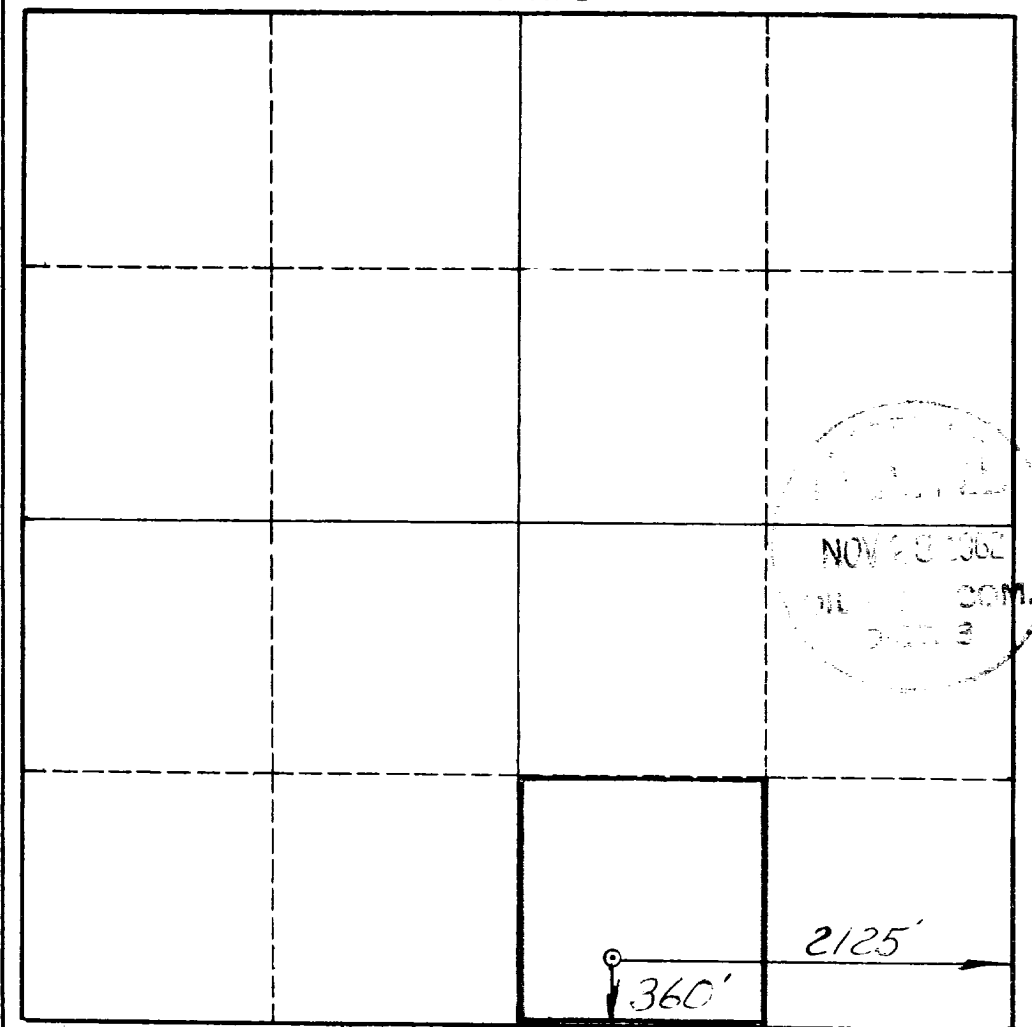

CERTIFICATION

I hereby certify that the information in SECTION A above is true and complete to the best of my knowledge and belief.

Name	<i>Lee H. Figure</i>
Position	Agent
Company	Leora C. Shaw
Date	9/24/62

I hereby certify that the well location shown on the plat in SECTION B was plotted from field notes of actual surveys made by me or under my supervision, and that the same is true and correct to the best of my knowledge and belief.

Date Surveyed	9/19/62
Registered Professional Engineer and/or Land Surveyor	<i>R. J. Seanlon</i>
Certificate No.	1457

INSTRUCTIONS FOR COMPLETION OF FORM C-128

1. Operator shall furnish and certify to the information called for in Section A.
2. Operator shall outline the dedicated acreage for *both* oil and gas wells on the plat in Section B.
3. A registered professional engineer or land surveyor registered in the State of New Mexico or approved by the Commission shall show on the plat the location of the well and certify this information in the space provided.
4. All distances shown on the plat must be from the outer boundaries of the Section.
5. If additional space is needed for listing owners and their respective interests as required in question 3 of Section A, please use space below.