

# EL PASO FIELD SERVICES PRODUCTION PIT CLOSURE

**Maddox WN Federal #2**  
**Meter/Line ID – 75238**

---

## SITE DETAILS

<b>Legals - Twn: 30N</b>	<b>Rng: 13W</b>	<b>Sec: 12</b>	<b>Unit: M</b>
<b>NMOCD Hazard Ranking: 10</b>		<b>Land Type: BLM</b>	
<b>Operator: Conoco</b>		<b>Pit Closure Date: 04/20/94</b>	

---

---

## **RATIONALE FOR RISK-BASED CLOSURE**

---

The pit noted above was assessed and ranked according to the criteria in the New Mexico Oil Conservation Division's (NMOCD) Unlined Surface Impoundment Closure Guidelines.

A test pit was excavated to twelve feet below ground surface and a soil sample was collected for field headspace analysis and laboratory analysis for benzene, total BTEX, and TPH. Groundwater was not encountered in the test pit. The test pit was backfilled and graded in a manner to direct surface runoff away from the pit area. Headspace analysis indicated an organic vapor content of 443 ppm; laboratory analysis indicated a benzene concentration of 0.75 mg/kg, a total BTEX concentration of 182 mg/kg, and a TPH concentration of 961 mg/kg. This site was re-assessed on April 8, 1998, because the initial assessment incorrectly included washes as a surface water body.

El Paso Field Services Company (EPFS) requests closure of the above mentioned production pit location for the following reasons:

- The primary source, discharge to the pit, has been removed for six years.
- The test pit was backfilled and the former pit area graded to direct surface runoff away from the former pit.
- Groundwater was not encountered in the test excavation. In addition, the estimated depth to groundwater is greater than 50 feet; therefore, impact to groundwater is unlikely.
- There are no water supply wells or other sources of fresh water extraction within 1,000 feet of the site.
- Residual hydrocarbons in the soil will degrade naturally with minimal risk to the environment.
- Based on the Hazard Ranking Score, benzene and TPH concentrations were below required remediation levels.

## ATTACHMENT

Revised Field Pit Assessment Form  
Field Pit Remediation/Closure Form

Field Pit Assessment Form  
Laboratory Analytical Results

**REVISED**  
**FIELD PIT SITE ASSESSMENT FORM**

GENERAL

Meter: 75238 Location: Maddox WN Federal #2  
 Operator #: \_\_\_\_\_ Operator Name: \_\_\_\_\_ P/L District: \_\_\_\_\_  
 Coordinates: Letter: M Section 12 Township: 30 Range: 13  
 Or Latitude \_\_\_\_\_ Longitude \_\_\_\_\_  
 Pit Type: Dehydrator \_\_\_\_\_ Location Drip: \_\_\_\_\_ Line Drip: \_\_\_\_\_ Other: \_\_\_\_\_  
 Site Assessment Date: 4/8/98 Area: \_\_\_\_\_ Run: \_\_\_\_\_

SITE ASSESSMENT

**NMOCD Zone:** (From NMOCD Maps) Inside ☐ (1) Outside ☒ (2)

**Land Type:** BLM ☒ (1) State ☐ (2) Fee ☐ (3) Indian \_\_\_\_\_

**Depth to Groundwater**  
 Less Than 50 Feet (20 points) ☐ (1)  
 50 Ft to 99 Ft (10 points) ☒ (2)  
 Greater Than 100 Ft (0 points) ☐ (3)

**Wellhead Protection Area**  
 Is it less than 1000 ft from wells, springs or other sources of fresh water extraction?, or; Is it less than 200 ft from a private domestic water source?  
☐ (1) YES (20 points) ☒ (2) NO (0 points)

**Horizontal Distance to Surface Water Body**  
 Less Than 200 Ft (20 points) ☐ (1)  
 200 Ft to 1000 Ft (10 points) ☐ (2)  
 Greater Than 1000 Ft (0 points) ☒ (3)

Name of Surface Water Body \_\_\_\_\_  
 (Surface Water Body: Perennial Rivers, Streams, Creeks, Irrigation Canals, Ditches, Lakes, Ponds)

Distance to Nearest Ephemeral Stream ☐ (1) < 100' (Navajo Pits Only)  
☐ (2) > 100'

**TOTAL HAZARD RANKING SCORE:** 10 POINTS

REMARKS

Remarks : Site has been re-assessed, due to initial assessment including washes as a Surface Water Body. Site is <100' vertical from center of Farmington Glade Wash.

# FIELD PIT SITE ASSESSMENT FORM

<b>GENERAL</b>	<p>Meter: <u>75238</u> Location: <u>MADDOX WM FEDERAL #2</u></p> <p>Operator #: <u>0286</u> Operator Name: <u>CONOCO</u> P/L District: <u>KUTZ</u></p> <p>Coordinates: Letter: <u>M</u> Section <u>12</u> Township: <u>30</u> Range: <u>13</u></p> <p>Or Latitude _____ Longitude _____</p> <p>Pit Type: Dehydrator <input checked="" type="checkbox"/> Location Drip: _____ Line Drip: _____ Other: _____</p> <p>Site Visit Date: <u>3.24.94</u> Run: <u>02</u> <u>31</u></p>
<b>SITE ASSESSMENT</b>	<div style="display: flex; justify-content: space-between;"> <div style="width: 45%;"> <p><b>NMOCD Zone:</b> Inside _____</p> <p>(From NMOCD Maps) Vulnerable Zone <input checked="" type="checkbox"/></p> <p>Outside <input type="checkbox"/></p> </div> <div style="width: 45%;"> <p><b>Land Type:</b> BLM <input checked="" type="checkbox"/></p> <p>State <input type="checkbox"/></p> <p>Fee <input type="checkbox"/></p> <p>Indian _____</p> </div> </div> <p><b>Depth to Groundwater</b></p> <p>Less Than 50 Feet (20 points) <input type="checkbox"/></p> <p>50 Ft to 99 Ft (10 points) <input type="checkbox"/></p> <p>Greater Than 100 Ft (0 points) <input checked="" type="checkbox"/></p> <p><b>Wellhead Protection Area :</b></p> <p>Is it less than 1000 ft from wells, springs, or other sources of fresh water extraction? , or ; Is it less than 200 ft from a private domestic water source? <input type="checkbox"/> YES (20 points) <input checked="" type="checkbox"/> NO (0 points)</p> <p><b>Horizontal Distance to Surface Water Body</b></p> <p>Less Than 200 Ft (20 points) <input type="checkbox"/></p> <p>200 Ft to 1000 Ft (10 points) <input type="checkbox"/></p> <p>Greater Than 1000 Ft (0 points) <input checked="" type="checkbox"/></p> <p>Name of Surface Water Body _____</p> <p>(Surface Water Body : Perennial Rivers, Major Wash, Streams, Creeks, Irrigation Canals, Ditches, Lakes, Ponds)</p> <p><b>TOTAL HAZARD RANKING SCORE:</b> <u>0</u> POINTS</p>
<b>REMARKS</b>	<p>Remarks : <u>TWO PITS ON LOCATION. WILL CLOSE ONLY ONE.</u></p> <p><u>PIT IS DRY.</u></p>

ORIGINAL PIT LOCATION

## ORIGINAL PIT LOCATION

Original Pit : a) Degrees from North 205° Footage to Wellhead 132'  
b) Degrees from North \_\_\_\_\_ Footage to Dogleg \_\_\_\_\_  
Dogleg Name \_\_\_\_\_  
c) Length : 16' Width : 14' Depth : 1'

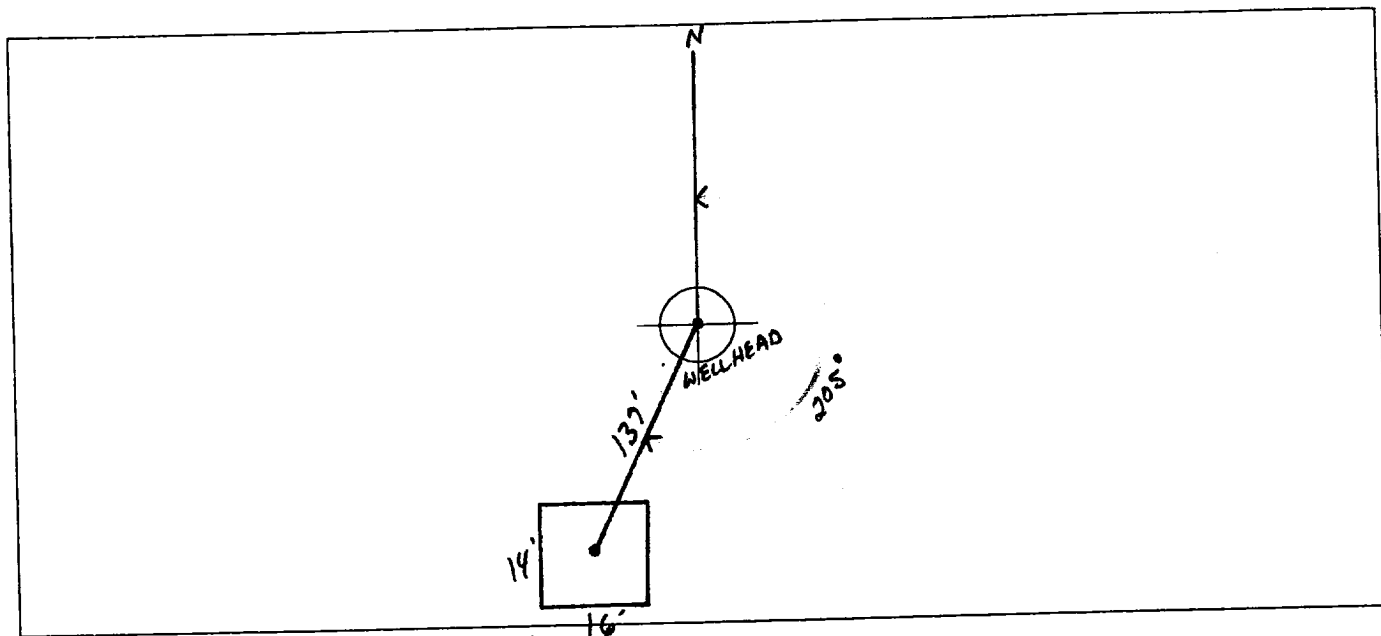

REMARKS

Remarks :

STARTED TAKING PICTURES AT 2:31 P.M.END DUMP

\_\_\_\_\_  
\_\_\_\_\_  
\_\_\_\_\_  
\_\_\_\_\_  
\_\_\_\_\_  
\_\_\_\_\_  
\_\_\_\_\_  
\_\_\_\_\_  
\_\_\_\_\_  
\_\_\_\_\_  
\_\_\_\_\_

Completed By:

Robert Thompson  
Signature

3.24.94  
Date

4.22.94  
RT

# FIELD PIT SITE ASSESSMENT FORM

GENERAL	<p>Meter: <u>75238</u> Location: <u>MADDOX WN FEDERAL #2</u></p> <p>Operator #: _____ Operator Name: _____ P/L District: _____</p> <p>Coordinates: Letter: _____ Section _____ Township: _____ Range: _____</p> <p>Or Latitude _____ Longitude _____</p> <p>Pit Type: Dehydrator _____ Location Drip: _____ Line Drip: _____ Other: _____</p> <p>Site Assessment Date: _____ Area: <u>02</u> Run: <u>31</u></p>
SITE ASSESSMENT	<p><b>NMOCD Zone:</b> (From NMOCD Maps)</p> <p>Inside <input type="checkbox"/> (1) Outside <input checked="" type="checkbox"/> (2)</p> <p><b>Land Type:</b> BLM <input type="checkbox"/> (1) State <input type="checkbox"/> (2) Fee <input type="checkbox"/> (3) Indian _____</p> <p><b>Depth to Groundwater</b></p> <p>Less Than 50 Feet (20 points) <input type="checkbox"/> (1) 50 Ft to 99 Ft (10 points) <input checked="" type="checkbox"/> (2) Greater Than 100 Ft (0 points) <input type="checkbox"/> (3)</p> <p><b>Wellhead Protection Area :</b> Is it less than 1000 ft from wells, springs, or other sources of fresh water extraction? , or ; Is it less than 200 ft from a private domestic water source? <input type="checkbox"/> (1) YES (20 points) <input type="checkbox"/> (2) NO (0 points)</p> <p><b>Horizontal Distance to Surface Water Body</b></p> <p>Less Than 200 Ft (20 points) <input type="checkbox"/> (1) 200 Ft to 1000 Ft (10 points) <input type="checkbox"/> (2) Greater Than 1000 Ft (0 points) <input type="checkbox"/> (3)</p> <p>Name of Surface Water Body _____</p> <p>(Surface Water Body : Perennial Rivers, Major Wash, Streams, Creeks, Irrigation Canals, Ditches, Lakes, Ponds)</p> <p>Distance to Nearest Ephemeral Stream <input type="checkbox"/> (1) &lt; 100' (Navajo Pits Only) <input type="checkbox"/> (2) &gt; 100'</p> <p><b>TOTAL HAZARD RANKING SCORE:</b> <u>10</u> POINTS</p>
REMARKS	<p>Remarks : _____</p> <p>_____</p> <p>_____</p>

# FIELD PIT REMEDIATION/CLOSURE FORM

<b>GENERAL</b>	Meter: <u>75238</u> Location: <u>MADDOX Wn Federal #2</u> Coordinates: Letter: <u>M</u> Section <u>12</u> Township: <u>30</u> Range: <u>13</u> Or Latitude _____ Longitude _____ Date Started : <u>4-20-91</u> Area: <u>02</u> Run: <u>31</u>
<b>FIELD OBSERVATIONS</b>	Sample Number(s): <sup>940839</sup> <u>KD13</u> Sample Depth: <u>12'</u> Feet Final PID Reading <u>443 ppm</u> PID Reading Depth <u>12'</u> Feet Yes No Groundwater Encountered <input type="checkbox"/> (1) <input checked="" type="checkbox"/> (2) Approximate Depth _____ Feet
<b>CLOSURE</b>	Remediation Method : Excavation <input type="checkbox"/> (1) Approx. Cubic Yards <u>0</u> Onsite Bioremediation <input type="checkbox"/> (2) Backfill Pit Without Excavation <input checked="" type="checkbox"/> (3) Soil Disposition: Envirotech <input type="checkbox"/> (1) <input checked="" type="checkbox"/> (3) Tierra Other Facility <input type="checkbox"/> (2) Name: _____ Pit Closure Date: <u>4-20-94</u> Pit Closed By: <u>BEI</u>
<b>REMARKS</b>	Remarks : <u>Dug test hole, took PID Reading + closed pit</u> _____ _____
Signature of Specialist: <u>Henry Denu</u>	



FIELD SERVICES LABORATORY

ANALYTICAL REPORT

PIT CLOSURE PROJECT - Soil

1cc run.  
BTEX

0.5g / 30ml meth

1st run inside VZ  
then later determined outside VZ

SAMPLE IDENTIFICATION

SAMPLE NUMBER:

Field ID

Lab ID

MTR CODE | SITE NAME:

SAMPLE DATE | TIME (Hrs):

SAMPLED BY:

DATE OF TPH EXT. | ANAL.:

DATE OF BTEX EXT. | ANAL.:

TYPE | DESCRIPTION:

KD13	940839
75238	N/A
4/20/94	1210
N/A	
N/A	N/A
5/3/94	5/17/94
VZ	N/A

REMARKS: Re Run BTEX-0.5g Soil and 30ml meth

RESULTS

PARAMETER	RESULT	UNITS	QUALIFIERS			
			DF	Q	M(g)	V(ml)
BENZENE 0.75	<del>40.2</del>	<del>MG/KG</del>				
TOLUENE	65.0	MG/KG				
ETHYL BENZENE	11.2	MG/KG				
TOTAL XYLENES	106	MG/KG				
TOTAL BTEX	182	MG/KG	0.05882		0.51	30
TPH (418.1)	961	MG/KG				
HEADSPACE PID	443	PPM				
PERCENT SOLIDS	94.8	%				

- TPH is by EPA Method 418.1 and BTEX is by EPA Method 8020 -

The Surrogate Recovery was at  
Narrative:

70.3

% for this sample All QA/QC was acceptable.

DF - Dilution Factor Used

Approved By:

John Satchi

Date:

5/21/94



## FIELD SERVICES LABORATORY

## ANALYTICAL REPORT

## PIT CLOSURE PROJECT - Soil

## SAMPLE IDENTIFICATION

SAMPLE NUMBER:

Field ID

Lab ID

MTR CODE | SITE NAME:

SAMPLE DATE | TIME (Hrs):

SAMPLED BY:

DATE OF TPH EXT. | ANAL.:

DATE OF BTEX EXT. | ANAL.:

TYPE | DESCRIPTION:

KD13	940839
75238	NIA
4/20/94	1210
NIA	
4-22-94	4-22-94
4/29/94	4/30/94
VG	Coarse Brown sand

REMARKS:

Wrong Vial spiked - BTEX → rerun

## RESULTS

PARAMETER	RESULT	UNITS	QUALIFIERS			
			DF	Q	M(g)	V(ml)
BENZENE	1.08	MG/KG	20			
TOLUENE	106	MG/KG	20	D1		
ETHYL BENZENE	21.6	MG/KG	20			
TOTAL XYLENES	311	MG/KG	20	D1		
TOTAL BTEX	440	MG/KG	5042		1.19	30
TPH (418.1)	267961	MG/KG			2.03	28
HEADSPACE PID	443	PPM				
PERCENT SOLIDS	94.8%	%				

-- TPH is by EPA Method 418.1 and BTEX is by EPA Method 8020 --

The Surrogate Recovery was at  
Narrative:

101.1

% for this sample All QA/QC was acceptable.

DF = Dilution Factor Used

Approved By:

Date:





## Page \_\_\_\_\_ of \_\_\_\_\_

FM-08-0565A (Rev. 03-9