

COPY TO O.C.C.

(SUBMIT IN TRIPLICATE)

UNITED STATES
DEPARTMENT OF THE INTERIOR
GEOLOGICAL SURVEY

Budget Bureau 49-R308.1
Approval expires 12-31-52

Land Office Santa Fe
Lease No. 678439
Unit Johnston Federal

SUNDRY NOTICES AND REPORTS ON WELLS

NOTICE OF INTENTION TO DRILL	<input checked="" type="checkbox"/>	SUBSEQUENT REPORT OF WATER SHUT-OFF	
NOTICE OF INTENTION TO CHANGE PLANS		SUBSEQUENT REPORT OF SHOOTING OR ACIDIZING	
NOTICE OF INTENTION TO TEST WATER SHUT-OFF		SUBSEQUENT REPORT OF ALTERING CASING	
NOTICE OF INTENTION TO RE-DRILL OR REPAIR WELL		SUBSEQUENT REPORT OF REDRILLING OR REPAIR	
NOTICE OF INTENTION TO SHOOT OR ACIDIZE		SUBSEQUENT REPORT OF ABANDONMENT	
NOTICE OF INTENTION TO PULL OR ALTER CASING		SUPPLEMENTARY WELL HISTORY	
NOTICE OF INTENTION TO ABANDON WELL			

RECEIVED
JUL 31 1953

(INDICATE ABOVE BY CHECK MARK NATURE OF REPORT, NOTICE, OR OTHER DATA) U. S. GEOLOGICAL SURVEY
FARMINGTON, N. M.

July 31, 1953

Well No. 1-X is located 1650 ft. from N line and 900 ft. from E line of sec. 12
SW/4 SW/4 Sec. 12 30N 9W N.M.P.M.
(1/4 Sec. and Sec. No.) (Twp.) (Range) (Meridian)
Blanco San Juan New Mexico
(Field) (County or Subdivision) (State or Territory)

The elevation of the derrick floor above sea level is 5847 ft.

DETAILS OF WORK

(State names of and expected depths to objective sands; show sizes, weights, and lengths of proposed casings; indicate mudding, cementing points, and all other important proposed work)

Mesa Verde Sand test.

Surface Casing: Approximately 200' of 10-3/4" OD 32.75# cemented to surface.
Production Casing: Approximately 4350' of 7" OD 20# and 23# Sals. cemented with 400 sacks.

Well will be drilled with rotary tools to production casing point at approximately 4350', then drilled with gas rotary to total depth of approximately 5000' or through the Point Lookout section of the Mesa Verde formation. If commercial production is indicated, well will be shot with approximately 3 to 4 quarts SNO per foot and cleaned out to total depth after shot.

I understand that this plan of work must receive approval in writing by the Geological Survey before operations may be commenced.

Company ANDERSON-PRICHARD OIL CORPORATION

Address 311 Paramount Building

Denver, Colorado

By Earl Bashara
Title District Superintendent

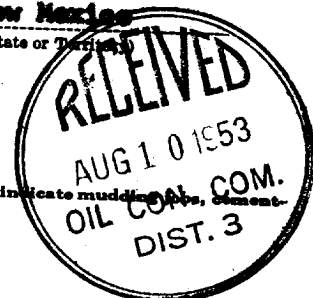

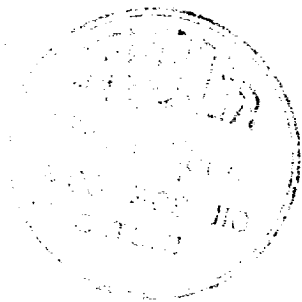

COMPANY ANDERSON PRICHARD OIL CORPORATION

Well Name & No. JOHNSTON NO 1-X - Federal Lease Lease No. 078439

Location 1650 feet from the South Line to 900 feet from the West Line

Being in The NW/4 of the SW/4

Sec. 12, T 30N., R 9W., N.M.P.M., San Juan County, New Mexico

Ground Elevation 5837.72

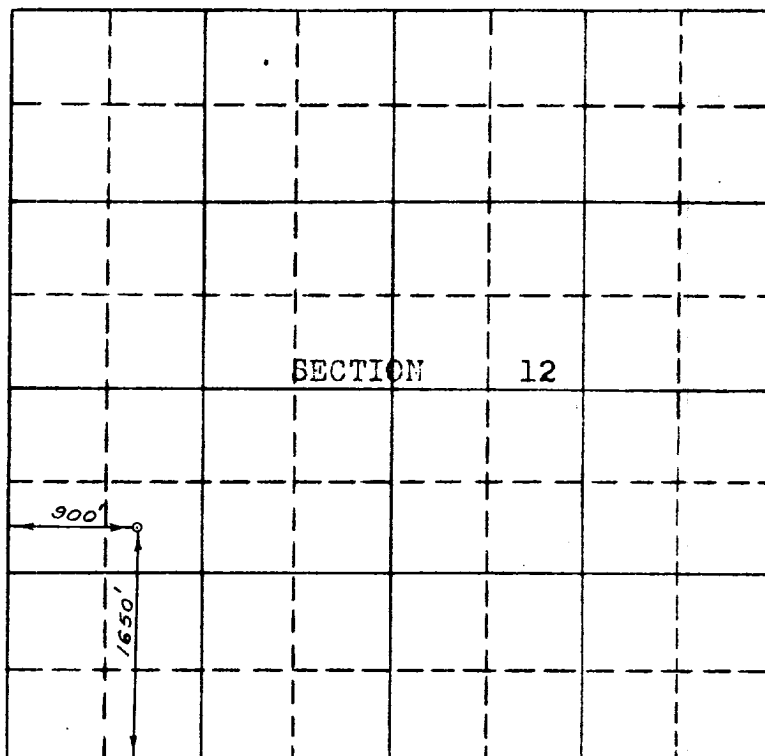

RECEIVED

JUL 31 1953

U. S. GEOLOGICAL SURVEY
FARMINGTON, N. M.

N



Scale -- 4 inches equals 1 mile

Surveyed July 26, 19 53

This is to certify that the above plat was prepared from field notes of actual surveys made by me or under my supervision and that the same are true and correct to the best of my knowledge and belief.

E. O. Walker

Registered Professional
Engineer and Land Surveyor.

Seal:

Farmington, New Mexico