

NEW MEXICO OIL CONSERVATION COMMISSION

SANTA FE, NEW MEXICO

7-3-58

APPLICATION FOR DUAL COMPLETION

Field Name Blanco Mesa Verde & Aztec P. C. Ext.		County San Juan	Date July 25, 1960
Operator El Paso Natural Gas Company		Lease Sunray	Well No. 2-E (1M)
Location of Well L	Section 9	Township 30N	Range 10W

1. Has the New Mexico Oil Conservation Commission heretofore authorized the dual completion of a well in these same pools or in the same zones within one mile of the subject well? YES _____ NO X

2. If answer is yes, identify one such instance: Order No. _____ ; Operator, Lease, and Well No.:

3. The following facts are submitted:	Upper Zone	Lower Zone
a. Name of reservoir	Pictured Cliffs	Mesa Verde
b. Top and Bottom of Pay Section (Perforations)	2996-3020	4585-4656 (Cliff House) 5232-5364 (Point Lookout)
c. Type of production (Oil or Gas)	Gas	Gas
d. Method of Production (Flowing or Artificial Lift)	Flowing	Flowing

4. The following are attached. (Please mark YES or NO)

- Yes a. Diagrammatic Sketch of the Dual Completion, showing all casing strings, including size and setting, top of cement, perforated intervals, tubing strings, including diameters and setting depth, location and type of packers and side door chokes, and such other information as may be pertinent.
- Yes b. Plat showing the location of all wells on applicant's lease, all offset wells on offset leases, and the names and addresses of operators of all leases offsetting applicant's lease.
- No c. Waivers consenting to such dual completion from each offset operator, or in lieu thereof, evidence that said offset operators have been furnished copies of the application.*
- No d. Electrical log of the well or other acceptable log with tops and bottoms of producing zones and intervals of perforation indicated thereon. (If such log is not available at the time application is filed, it shall be submitted as provided by Rule 112-A.)

5. List all offset operators to the lease on which this well is located together with their correct mailing address.

Atlantic Refining Co. - Box 379, Durango, Colorado

Atlantic Refining Co. - Box 520, Casper, Wyoming

Sullivan & Hill - 3828 Willat Avenue, Culver City, California

L. C. Kelly, 309 Bank of America Building, Beverly Hills, California

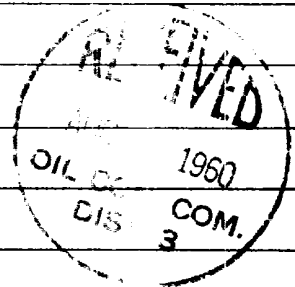

6. Were all operators listed in Item 5 above notified and furnished a copy of this application? YES X NO _____. If answer is yes, give date of such notification **July 25, 1960**.

CERTIFICATE: I, the undersigned, state that I am the **Division Petroleum Engr.** of the **El Paso Natural Gas Co.** (company), and that I am authorized by said company to make this report; and that this report was prepared under my supervision and direction and that the facts stated therein are true, correct and complete to the best of my knowledge.

ORIGINAL SIGNED E. S. OBERLY

Signature

- * Should waivers from all offset operators not accompany an application for administrative approval, the New Mexico Oil Conservation Commission will hold the application for a period of twenty (20) days from date of receipt by the Commission's Santa Fe office. If, after said twenty-day period, no protest nor request for hearing is received by the Santa Fe office, the application will then be processed.
- NOTE: If the proposed dual completion will result in an unorthodox well location and/or a non-standard proration unit in either or both of the producing zones, then separate application for approval of the same should be filed simultaneously with this application.

NEW MEXICO OIL CONSERVATION COMMISSION

SANTA FE, NEW MEXICO

7-3-58

APPLICATION FOR DUAL COMPLETION

Field Name Blanco Mesa Verde & Aztec P. C. Ext.		County San Juan	Date July 25, 1960
Operator El Paso Natural Gas Company		Lease Quarrey	Well No. 2-E (IM)
Location of Well L	Unit 9	Township 30N	Range 10W

1. Has the New Mexico Oil Conservation Commission heretofore authorized the dual completion of a well in these same pools or in the same zones within one mile of the subject well? YES _____ NO X
2. If answer is yes, identify one such instance: Order No. _____; Operator, Lease, and Well No.:

3. The following facts are submitted:	Upper Zone	Lower Zone
a. Name of reservoir	Pictured Cliffs	Mesa Verde
b. Top and Bottom of Pay Section (Perforations)	2996-3020	4585-4656 (Cliff House) 5232-5364 (Point Lookout)
c. Type of production (Oil or Gas)	Gas	Gas
d. Method of Production (Flowing or Artificial Lift)	Flowing	Flowing

4. The following are attached. (Please mark YES or NO)

- Yes a. Diagrammatic Sketch of the Dual Completion, showing all casing strings, including size and setting, top of cement, perforated intervals, tubing strings, including diameters and setting depth, location and type of packers and side door chokes, and such other information as may be pertinent.
- Yes b. Plat showing the location of all wells on applicant's lease, all offset wells on offset leases, and the names and addresses of operators of all leases offsetting applicant's lease.
- No c. Waivers consenting to such dual completion from each offset operator, or in lieu thereof, evidence that said offset operators have been furnished copies of the application.*
- No d. Electrical log of the well or other acceptable log with tops and bottoms of producing zones and intervals of perforation indicated thereon. (If such log is not available at the time application is filed, it shall be submitted as provided by Rule 112-A.)

5. List all offset operators to the lease on which this well is located together with their correct mailing address.

Atlantic Refining Co. - Box 379, Durango, Colorado

Atlantic Refining Co. - Box 520, Casper, Wyoming

Sullivan & Hill - 3828 Willet Avenue, Culver City, California

L. C. Kelly, 305 Bank of America Building, Beverly Hills, California

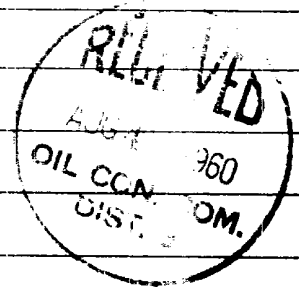

6. Were all operators listed in Item 5 above notified and furnished a copy of this application? YES ++ NO ____ . If answer is yes, give date of such notification July 25, 1960.

CERTIFICATE: I, the undersigned, state that I am the Division Petroleum Engr. of the El Paso Natural Gas Co. (company), and that I am authorized by said company to make this report; and that this report was prepared under my supervision and direction and that the facts stated therein are true, correct and complete to the best of my knowledge.

OR'G'NAL SIGNED E. S. OBERLY

Signature

- * Should waivers from all offset operators not accompany an application for administrative approval, the New Mexico Oil Conservation Commission will hold the application for a period of twenty (20) days from date of receipt by the Commission's Santa Fe office. If, after said twenty-day period, no protest nor request for hearing is received by the Santa Fe office, the application will then be processed.
- NOTE: If the proposed dual completion will result in an unorthodox well location and/or a non-standard proration unit in either or both of the producing zones, then separate application for approval of the same should be filed simultaneously with this application.

STATE OF NEW MEXICO)
)
COUNTY OF SAN JUAN)

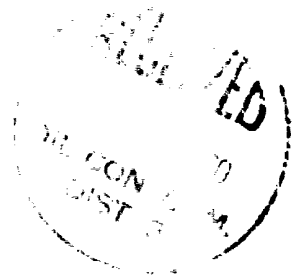

I, D. W. Meehan, being first duly sworn upon my
oath depose and say as follows:

I am an employee of El Paso Natural Gas Co., and that
on May 29, 1960, I was called to the location of the El Paso Natural
Gas Company Sunray No. 2-E (FM) Well located in the NWSW/4 of Section
9, Township 30 North, Range 10 West, N.M.P.M., for advisory service
in connection with installation of a production packer. In my
presence, a Guiberson "Shorty" Model Production Packer was set in
this well at 3216 feet in accordance with the usual practices and
customs of the industry.

D. W. Meehan

Subscribed and sworn to before me this 26th day of July,
1960.

My Commission Expires 6-21-61

Yannick Blau Hall
Notary Public in and for San Juan County,
New Mexico

**PLAT SHOWING LOCATION OF DUALY COMPLETED
El Paso Natural Gas Co. Sunray No. 2-E (PM)
and Offset Acreage**

T-30-N
R-10-W

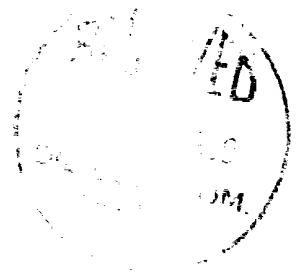
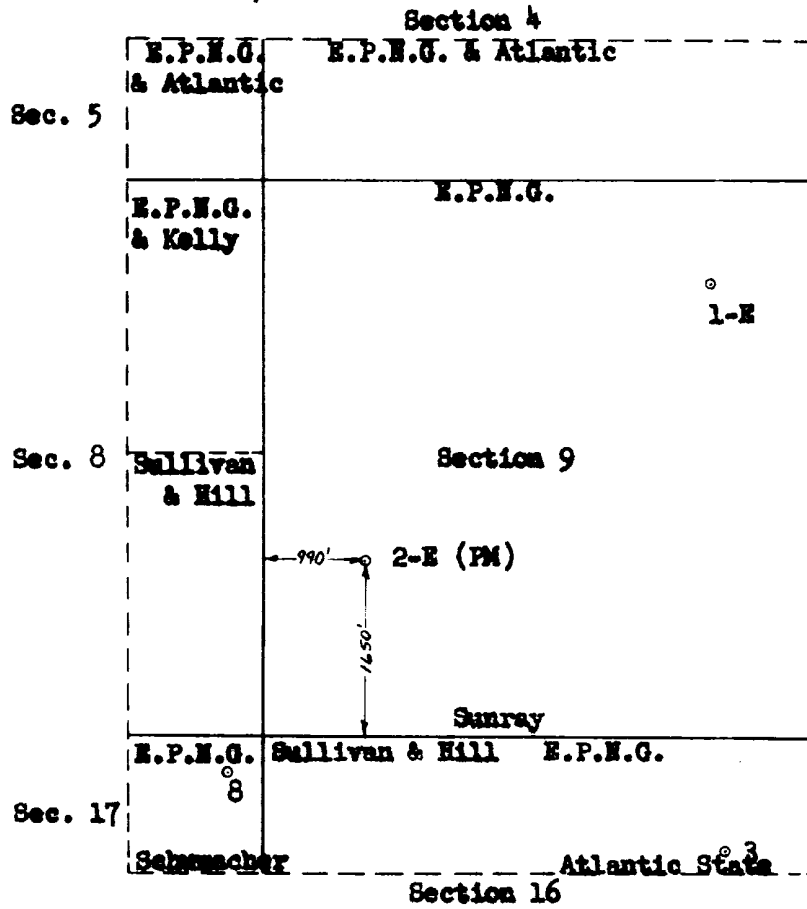

EL PASO NATURAL GAS COMPANY
EL PASO, TEXAS

SCALE	DATE	No.
DRAWN BY	CHECKED BY	

ALL CON. DIST. 1960

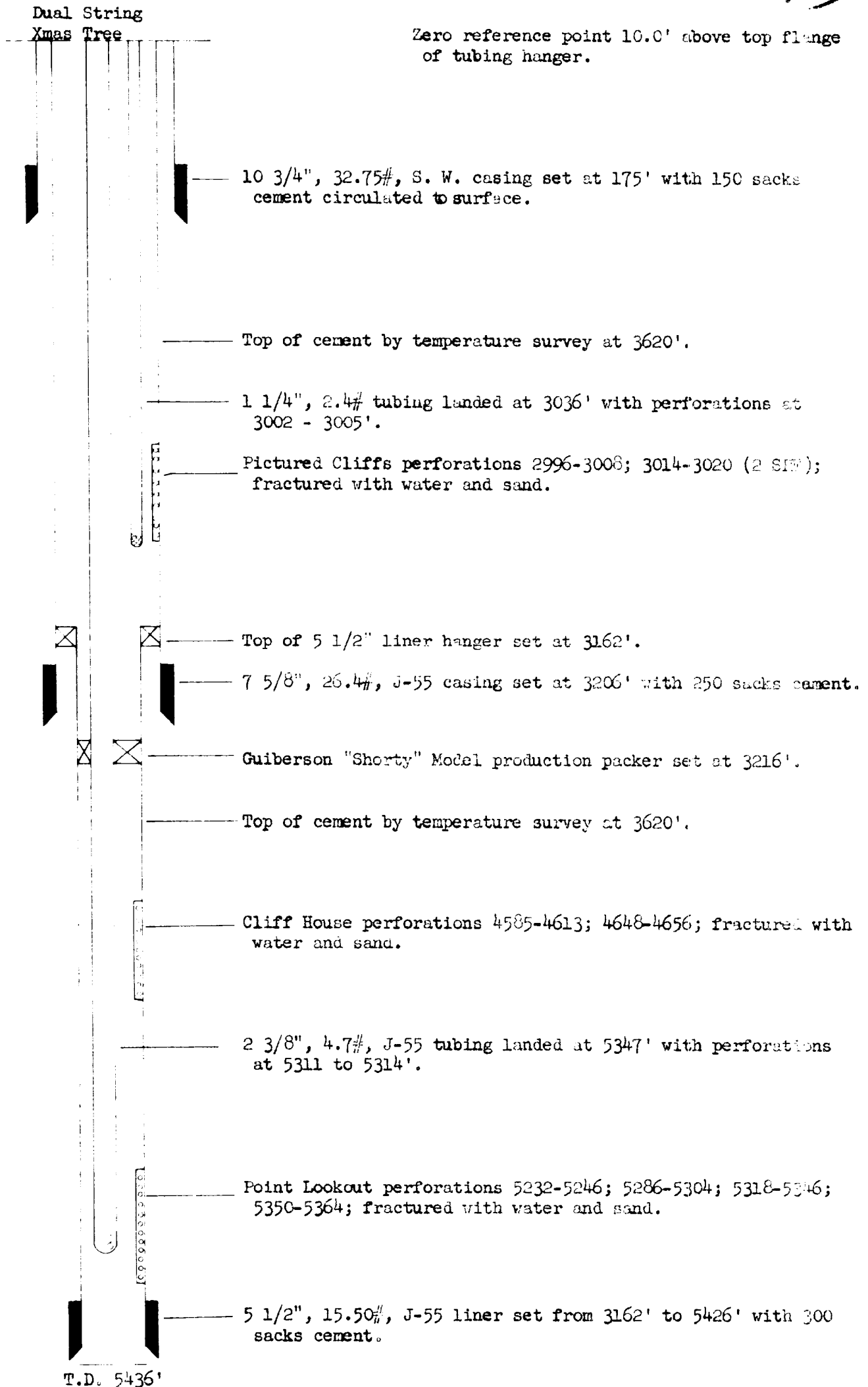

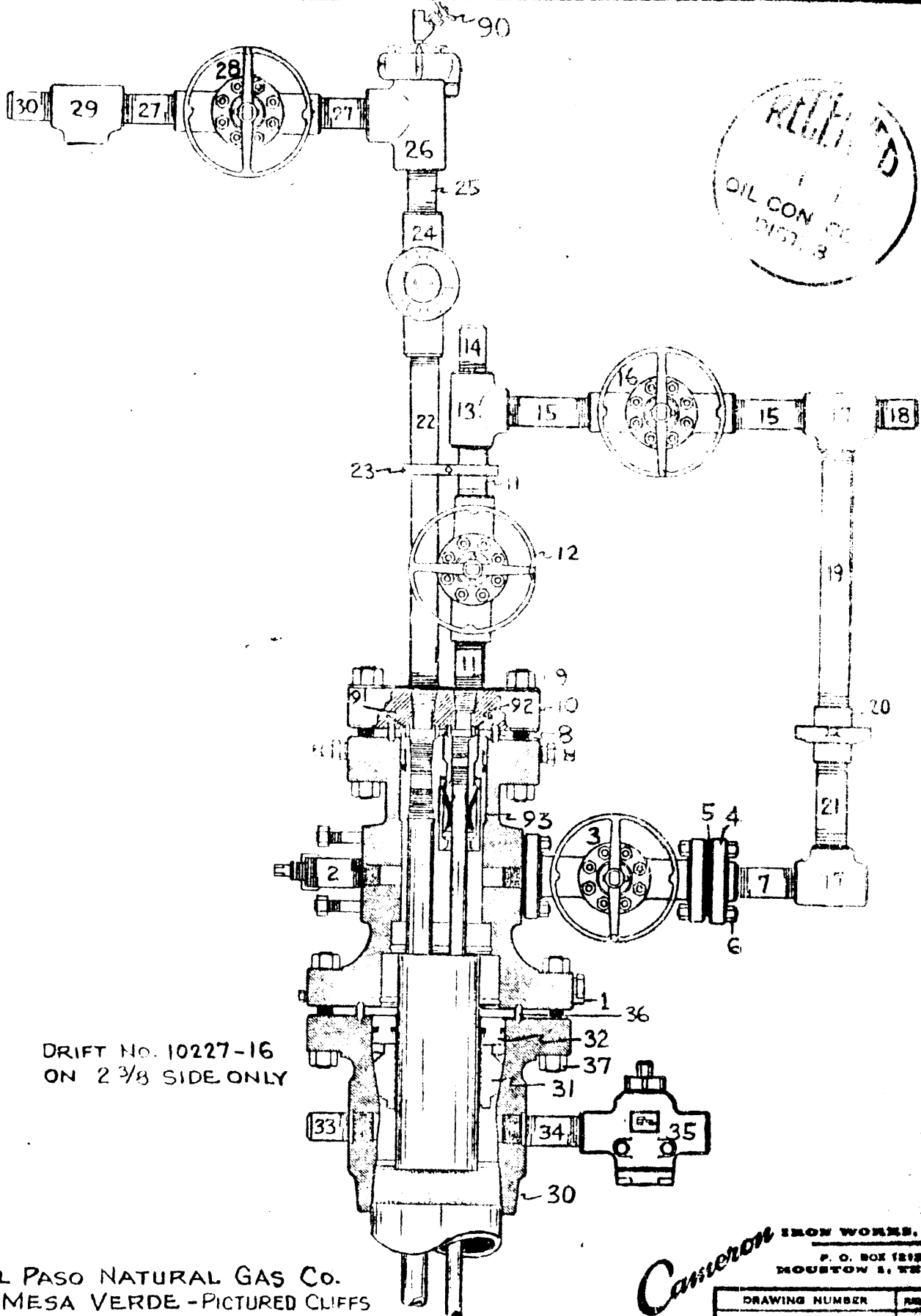

DRIFT NO. 10227-16
ON 2 3/8 SIDE ONLY

EL PASO NATURAL GAS CO.
MESA VERDE - PICTURED CLIFFS

Cameron IRON WORKS, INC.
P. O. BOX 1212
HOUSTON 1, TEXAS

DRAWN BY <u>E. H.</u>	DATE <u>3-17-59</u>	WORKING PRESSURE <u>2,000</u> #	DRIFT NO. _____	DRAWING NUMBER <u>916015</u>	REVISION <u>A</u>
-----------------------	---------------------	---------------------------------	-----------------	------------------------------	-------------------

EL PASO NATURAL GAS COMPANY
OPEN FLOW TEST DATA

DUAL COMPLETION

DATE June 7, 1960

Operator El Paso Natural Gas Company	Lease Sunray No. 2-E (OWWO) (P)
Location 1650S, 990W; 9-30N-10W	County San Juan State New Mexico
Formation Pictured Cliffs	Well Aztec PC
Gravel Diameter 7-5/8 Gravel Size 3206	Gravel Weight 1-1/4 Gravel Volume 3025
Pay Zone 2996 Pay Zone 3020	Pay Zone 5436 c/o 5384 Pay Zone 5/30/60
Stimulation Sand Water Frac.	Stimulation X

Gravel Weight .75	Gravel Volume 12.365
Gravel Weight 950 (PC)	Gravel Weight 962 Gravel Volume 8
Gravel Weight Csg. 192	Gravel Weight 204
Gravel Weight 64 Gravel Volume .9962	Gravel Weight .85
Gravel Weight 1.021	Gravel Volume .670 Gravel Weight .9463

Initial SIPT (MV) = 515 psig

Final SIPT (MV) = 518 psig

Guilberson "Shorty" Packer at 3216

CHOKE VOLUME $Q_c = \frac{C}{P} \times \frac{P}{P_c} \times \frac{P}{P_c} \times \frac{P}{P_c} \times \frac{P}{P_c}$

$$12.365 \times 204 \times .9962 \times .9463 \times 1.021$$

2428

ACF/D

OPEN FLOW $Q_o = \left(\frac{C}{P} \times \frac{P}{P_c} \times \frac{P}{P_c} \times \frac{P}{P_c} \times \frac{P}{P_c} \right)^n$

$$\left(\frac{925444}{880923} \right)^n$$

$$1.0505^{.85} \times 2428 = 1.0428 \times 2428$$

2532

ACF/D

W. D. Dawson

L. D. Galloway
L. D. Galloway

Page 10

OPEN FLOW TEST DATA

DUAL COMPLETION

June 15, 1960

Company	El Paso Natural Gas Company	Sunray No. 2-E (OWWO) (MV)
Location	1650S, 990W; 9-30N-10W	San Juan New Mexico
Property	Mesa Verde	Blanco
Well	7-5/8	2"
Depth	4585	5336
Production	5364	5436 c/o 5384
Notes	Sand Water Frac.	5/30/60
		X

	.75	12.365	5-1/2" liner from 3162 to 5426	
(PC) 950		962	16	(MV) 560
				572
(MV) 152			164	Calc.
				321
64	.9962	.75	1.018	.698
				.9292

Initial SIPT (PC) = 951 psig
Final SIPC (PC) = 955 psig

Guiberson "Shorty" Prod. Packer at 3216

$$12.365 \times 164 \times .9962 \times .9292 \times 1.018$$

1911

10

327184
224143

$$1.4597^{.75} \times 1911 = 1.3275 \times 1911$$

2537

W. D. Dawson

L. D. Galloway