

NEW MEXICO
OIL CONSERVATION COMMISSION

Form C-128

Well Location and/or Gas Proration Plat

Date 10-29-56

Operator Northwest Production Corporation Lease Blanco Unit 30-12

Well No. 3-10 Section 10 Township 30 North Range 12 West NMPM

Located 1510 Feet From South Line, 990 Feet From West Line,

San Juan County, New Mexico. G. L. Elevation 5713, ungraded.

Name of Producing Formation Pictured Cliffs Pool Wildcat Dedicated Acreage 100

(Note: All distances must be from outer boundaries of Section)

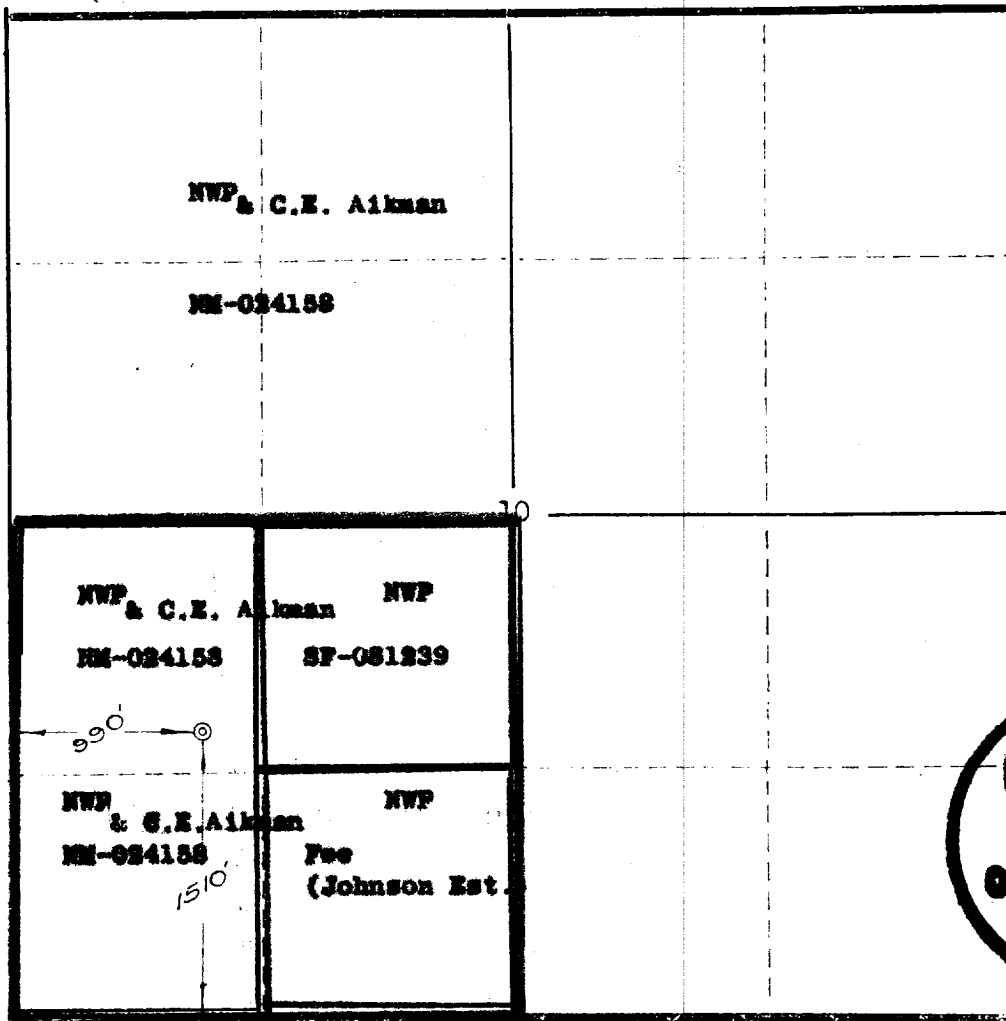

NOTE

This section of form is to be used for gas wells only.

SCALE: 1" = 1000'

1. Is this Well a Dual Comp. ? Yes No ...
2. If the answer to Question 1 is yes, are there any other dually completed wells within the dedicated acreage?
Yes ... No

Name Ray Phillips RAY PHILLIPS
Position Asst. Mgr., Production Operations
Representing Northwest Production Corporation
Address 520 Simms Bldg., Albuquerque, N.M.

This is to certify that the above plat was prepared from field notes of actual surveys made by me or under my supervision and that the same are true and correct to the best of my knowledge and belief.

Date Surveyed October 13, 1956

Ernest V. Echohawk
Reg. Land Surveyor, N. Mex., Reg. No. 1545

OIL CONSERVATION COMMISSION

AZTEC DISTRICT OFFICE

No. Copies Received 3

DISTRIBUTION

	NO. FURNISHED	
Operator	1	
Santa Fe	1	
Proration Office		
State Land Office		
U. S. G. S.		
Transporter		
File	1	✓