

NEW MEXICO OIL CONSERVATION COMMISSION  
WELL LOCATION AND ACREAGE DEDICATION PLAT

Form C-102  
Supersedes C-128  
Effective 1-1-75

All distances must be from the outer boundaries of the Section.

C & E OPERATORS			Lease MARY SHEPHERD		Well No. 1
Map Sheet Z	Section 10	Township 30 NORTH	Range 11 WEST	County SAN JUAN	

Actual Well Location of Well:

1700 feet from the SOUTH line and 1760 feet from the WEST line

Spot Elevation: 5754 Producing Formation: PC Pool: Aztec PC Dedicated Acreage: 16.0 Acres

- Outline the acreage dedicated to the subject well by colored pencil or hatchure marks on the plat below.
- If more than one lease is dedicated to the well, outline each and identify the ownership thereof (both as to working interest and royalty).
- If more than one lease of different ownership is dedicated to the well, have the interests of all owners been consolidated by communitization, unitization, force-pooling, etc?

☐ Yes ☐ No If answer is "yes" type of consolidation \_\_\_\_\_

If answer is "no" list the owners and tract descriptions which have actually been consolidated. (Use reverse side of this form if necessary.) \_\_\_\_\_

No allowable will be assigned to the well until all interests have been consolidated (by communitization, unitization, forced-pooling, or otherwise) or until a non-standard unit, eliminating such interests, has been approved by the Commission.

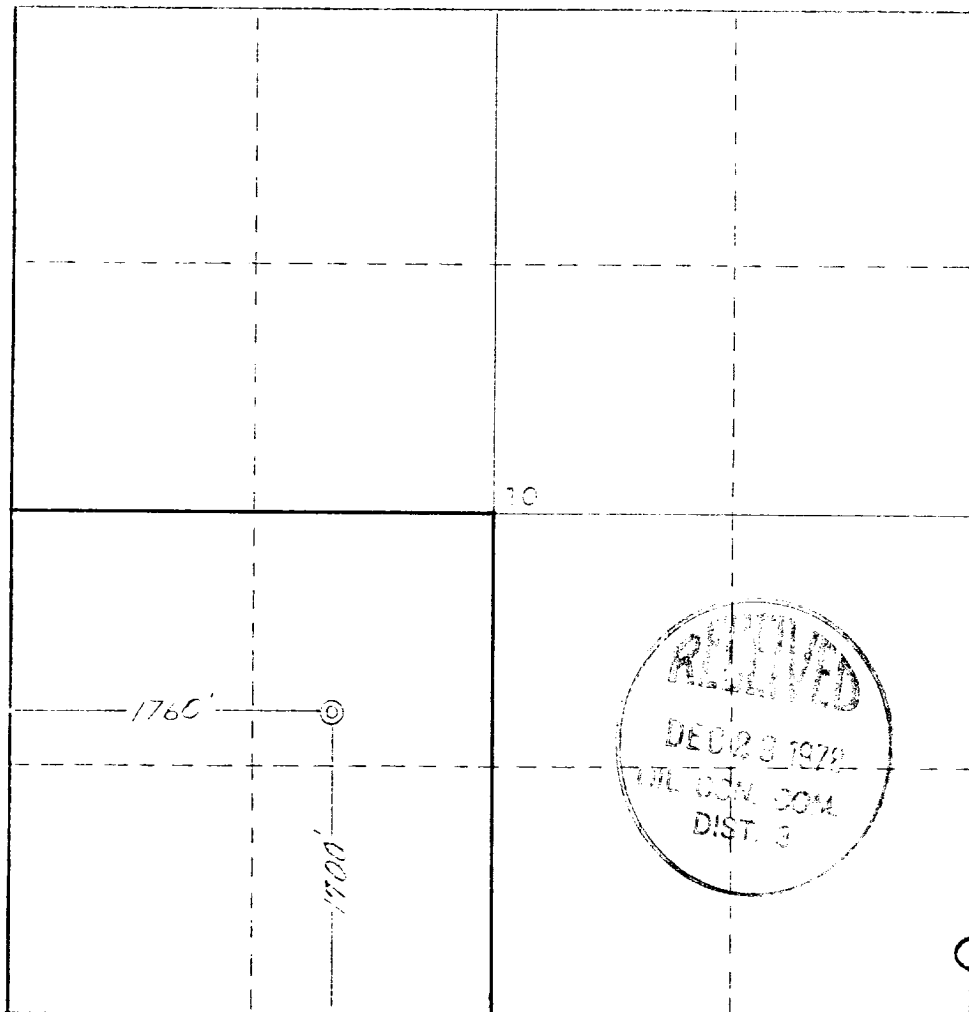

CERTIFICATION

I hereby certify that the information contained herein is true and complete to the best of my knowledge and belief.

*[Signature]*

Name

*[Signature]*

Position

Company

Date

12-29-1978

I hereby certify that this plat was plotted from field notes, actual surveys made in the or under my supervision, and that the same is true and correct to the best of my knowledge and belief.

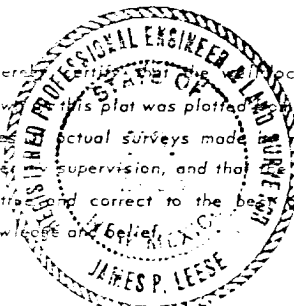

Date Surveyed

20 December 1978

Registered Professional Engineer  
in State of New Mexico

*[Signature]*  
James P. Leese

Certificate No.

1463

Scale: 0 330 660 990 1320 1650 1980 2310 2640 2970 3300 3630 3960 4290 4620 4950 5280 5610 5940 6270 6600