

UNITED STATES
DEPARTMENT OF THE INTERIOR
BUREAU OF LAND MANAGEMENT

SUBMIT IN TRIPLICATE

(Other instructions on
reverse side)

Form approved.
Budget Bureau No. 1004-0136
Expires August 31, 1985

APPLICATION FOR PERMIT TO DRILL, DEEPEN, OR PLUG BACK

1a. TYPE OF WORK

DRILL ☒ Re-entry DEEPEN ☐ PLUG BACK ☐

b. TYPE OF WELL

OIL WELL ☒ GAS WELL ☐ OTHER ☐ SINGLE ZONE ☒ MULTIPLE ZONE ☐

2. NAME OF OPERATOR

Western International Petroleum

3. ADDRESS OF OPERATOR

11801 N. Tatum Blvd., Suite 246, Phoenix, AZ 85028

4. LOCATION OF WELL (Report location clearly and in accordance with any State requirements.)*

At surface

1650' FSL & 2310' FEL

At proposed prod. zone

same

14. DISTANCE IN MILES AND DIRECTION FROM NEAREST TOWN OR POST OFFICE*

BUREAU OF LAND MANAGEMENT
HARMINGTON RESOURCE AREA

15. DISTANCE FROM PROPOSED*

LOCATION TO NEAREST
PROPERTY OR LEASE LINE, FT.
(Also to nearest drlg. unit line, if any)

16. NO. OF ACRES IN LEASE

200

17. NO. OF ACRES ASSIGNED
TO THIS WELL

40

18. DISTANCE FROM PROPOSED LOCATION*

TO NEAREST WELL, DRILLING, COMPLETED,
OR APPLIED FOR, ON THIS LEASE, FT.

19. PROPOSED DEPTH

2224'

20. ROTARY OR CABLE TOOLS

Rotary 0-TD

21. ELEVATIONS (Show whether DF, RT, GR, etc.)

5441' G.L.

DRILLING OPERATIONS AUTHORIZED ARE
SUBJECT TO COMPLIANCE WITH ATTACHED
"GENERAL REQUIREMENTS"

22. APPROX. DATE WORK WILL START*

ASAP

23. PROPOSED CASING AND CEMENTING PROGRAM

This action is subject to administrative
appeal pursuant to 30 CFR 290.

SIZE OF HOLE	SIZE OF CASING	WEIGHT PER FOOT	SETTING DEPTH	QUANTITY OF CEMENT
12 1/4"	9-5/8"	36#	100'	147.5 ft ³ Class B w/2% CaCl ₂
7-7/8"	5-1/2"	15.5#	2223'	59ft ³ , 63.5ft ³ pozmix 2% gel

(NE Hogback Unit #42)

Original Drilling: Formerly Williams #3 (SF 081299). Spudded well 11-8-59. T.D. well @ 2224' on 11-23-59. Perforated intervals 2123'-39' and 2011'-48' and stimulated on 11-29-59. Well was plugged 3-03-70 as follows: set 30sx plug into and across perfs. Perfed 2 holes @ 750 and set 35 sx plug in and outside of casing. Set 10sx plug at surface with dry hole marker. No casing pulled from well.

Re-entry Work: Western Fed #2 (NM 58917). Plan to re-enter to T.D. of 2224' with 4-3/4" bit drilling out cement plugs. Circulating medium will be clear water. Plan to perforate Lower Gallup, acide and test potential. If tests warrant, will fracture stimulate and test further. The gas from this formation ~~is~~/is not dedicated.

ESTIMATED TOPS: Mesaverde - Surface T.D. 224'
Mancos - 510'
Gallup - 1970'

IN ABOVE SPACE DESCRIBE PROPOSED PROGRAM: If proposal is to deepen or plug back, give data on present productive sone and proposed new productive zone. If proposal is to drill or deepen directionally, give pertinent data on subsurface locations and measured and true vertical depths. Give blowout preventer program, if any.

24.

SIGNED

Kevin L. McLeod

TITLE

Agent

DATE

4-15-85

(This space for Federal or State office use)

APPROVED
AS AMENDED

PERMIT NO.

APPROVAL DATE

APPROVED BY

TITLE

DATE

MAY 28 1985

CONDITIONS OF APPROVAL, IF ANY:

ch

MMOCC

/s/ J. Stan McKee

M. MILLENBACH
AREA MANAGER

*See Instructions On Reverse Side

NEW MEXICO OIL CONSERVATION COMMISSION

Well Location and Acreage Dedication Plat

Section A.

Date October 21, 1959

Operator Western International Petroleum Lease Western Fed
Well No. #2 Unit Letter J Section 11 Township 30 North Range 16 West MPM
Located 1650' Feet From South Line 2310' Feet From East Line
County San Juan G. L. Elevation 5441 Dedicated Acreage 40 Acres
Name of Producing Formation Lower-Gallup Pool Horseshoe Gallup Ext.

1. Is the Operator the only owner in the dedicated acreage outlined on the plat below?
Yes X No
2. If the answer to question one is "no," have the interests of all the owners been consolidated by communitization agreement or otherwise? Yes No . If answer is "yes,"
Type of Consolidation
3. If the answer to question two is "no," list all the owners and their respective interests below:

Owner

Land Description

NOTE Original survey done for El Paso Natural Gas Co.
Well Name Williams #3 Lease # SF-081299

Section B

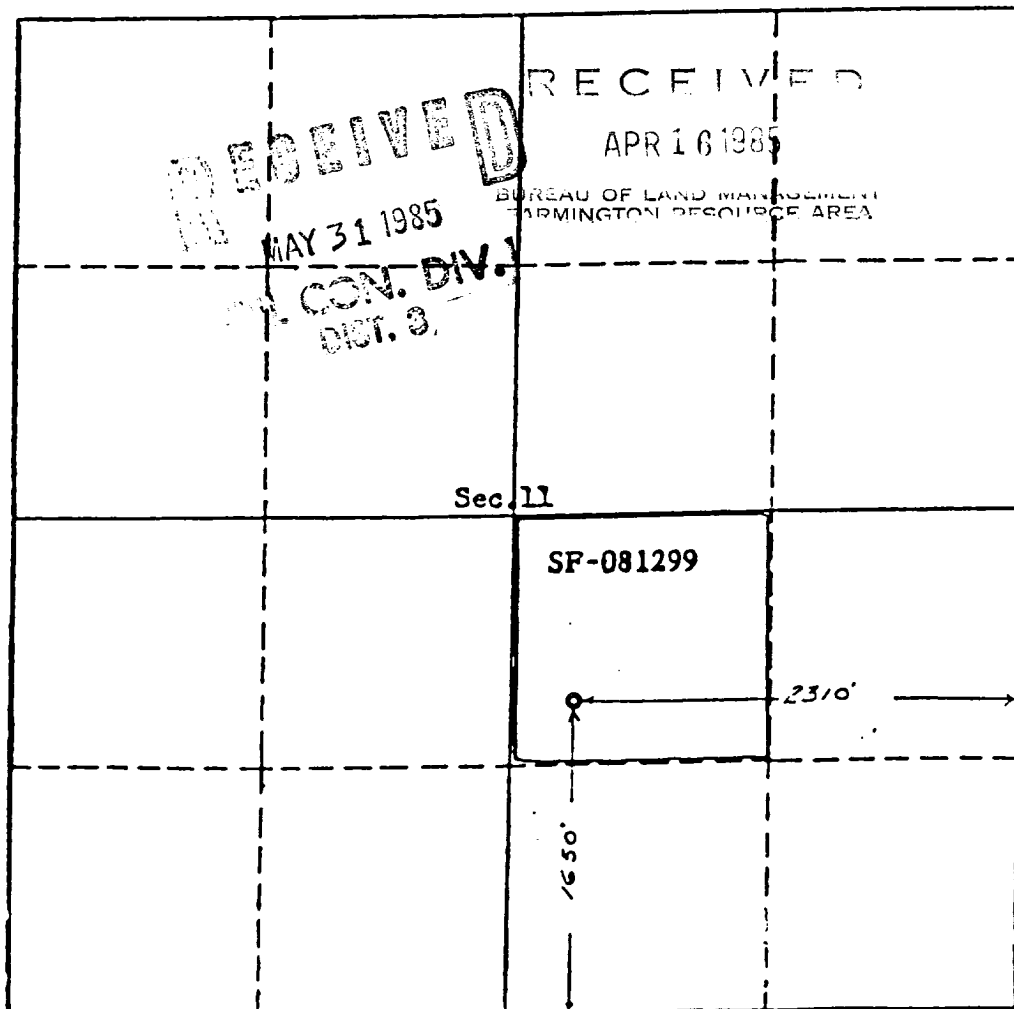

This is to certify that the information in Section A above is true and complete to the best of my knowledge and belief.

Western International Petroleum
(Operator)
Kevin H. McCord, KM Production Co.
(Representative)
11801 N. Tatum Blvd, Suite 246
Phoenix, AZ 85028
Address

This is to certify that the well location shown on the plat in Section B was plotted from the data of a legal survey made by me or under my supervision and that the same is true to the best of my knowledge and belief.

Date Surveyed August 17, 1959

Ernest V. Echshaw
Registered Land Surveyor.

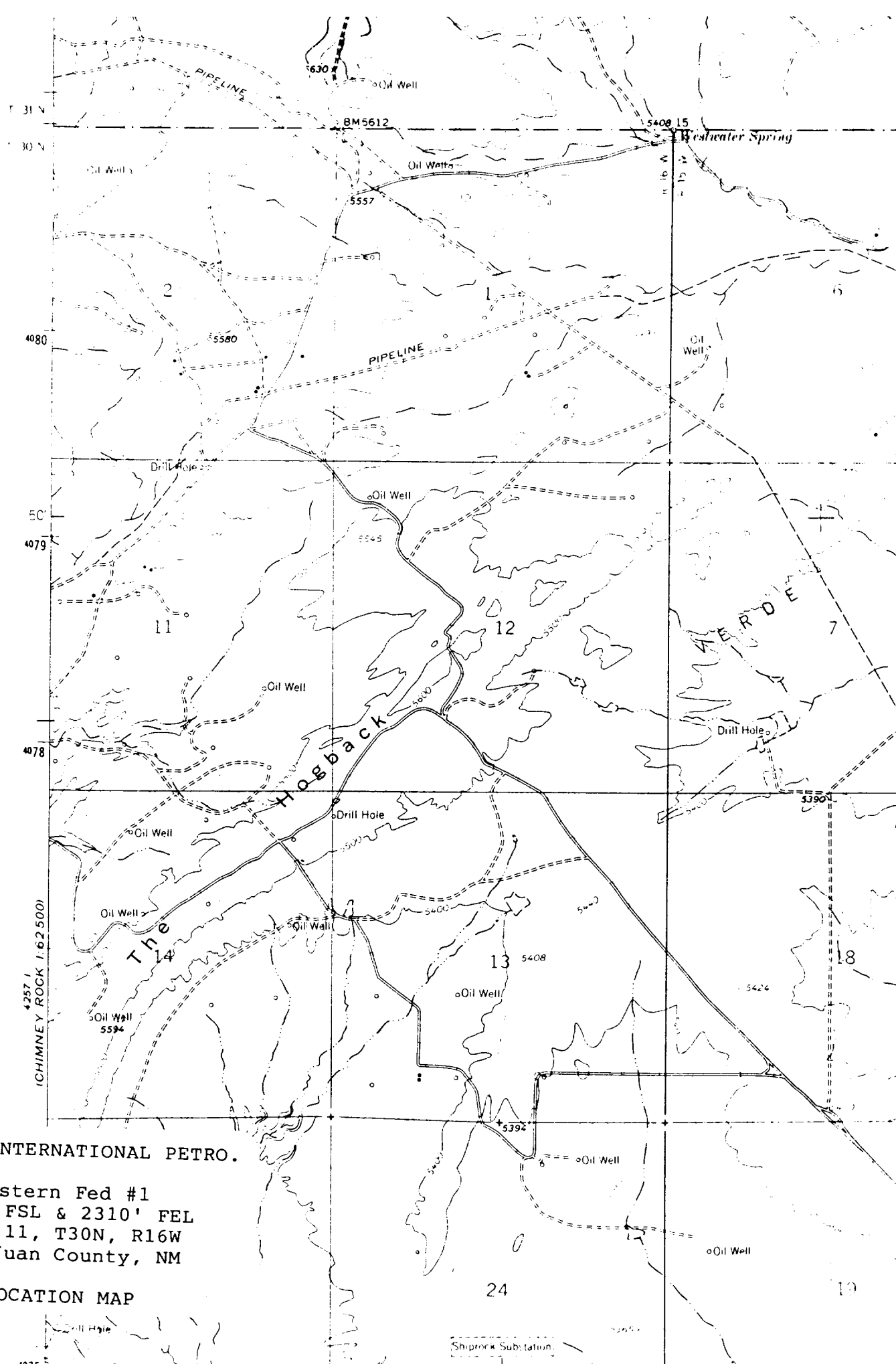

WESTERN INTERNATIONAL PETRO.

Western Fed #1
 1650' FSL & 2310' FEL
 Sec. 11, T30N, R16W
 San Juan County, NM

LOCATION MAP

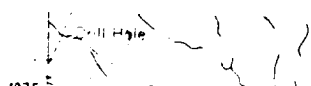

Shiprock Substation