

(SUBMIT IN TRIPLICATE)

Indian Agency **Navajo**

UNITED STATES

DEPARTMENT OF THE INTERIOR
GEOLOGICAL SURVEY

Allottee **Tribal**

Lease No. **21-20-603-2260**

RECEIVED
APR 1 1963
Sec. 12
0 1

SUNDRY NOTICES AND REPORTS ON WELLS

NOTICE OF INTENTION TO DRILL	URGENT REPORT OF WATER SHUTOFF
NOTICE OF INTENTION TO DRILL IN MANY	URGENT REPORT OF SPICHTING OR ACIDIZING
NOTICE OF INTENTION TO TEST WATER WELL	URGENT REPORT OF ALTERING CASING
NOTICE OF INTENTION TO REPAIR OR REPAIR WELL	URGENT REPORT OF REFRILLING OR REPAIR
NOTICE OF INTENTION TO REPAIR ACIDIZE	URGENT REPORT OF ABANDONMENT
NOTICE OF INTENTION TO FILL WATER CANYON	URGENT REPORT OF ABANDONMENT
NOTICE OF INTENTION TO ABANDON WELL	URGENT REPORT OF ABANDONMENT

RECEIVED
APR 1 1963
U.S. GEOLOGICAL SURVEY
FEDERAL BUREAU OF GEOLOGY
NEW MEXICO

(INDICATE ABOVE BY CHECK MARK IN CASE OF REPORT OTHER THAN OTHER DATA)

APR 1 1963

Well No. **1** is located **1520** ft. from **line** and **2000** ft. from **W** line

SW/4 Sec. **12** **30** K **19** W
Twp. and Range

Wildcat **Surface**
New Mexico
State of Texas

The elevation of the ~~Aerick Road~~ **Surface** above sea level is **5260** ft.

RECEIVED
APR 2 1963
OIL CON. COM.
DIST. 3

DETAILS OF WORK

(State names of and expected depths to objective sand, shale, limestone, and lengths of proposed casings; indicate mudding jobs, cementing points, and other special proposed work.)

It is proposed to drill this well with open hole to a depth sufficient to test the Devonian sand. Estimated total depth is 7500'. Anticipated formations to be encountered are Dakota 500', Permian 1500', Permian 7200', and Devonian 7500'.

1500' of Permian sand will be drilled with 1500' casing and cemented from bottom of hole with approximately 100 sacks cement. 1500' of Permian sand will be drilled at approximately 1000' and cemented with approximately 100 sacks cement. If productive sands are encountered 5-1/2" or 7" will be run four 1500' x 10' and cemented with sufficient cement to protect all sands. Possible productive zones will be perforated and tested, and well completed.

I understand that this plan of work must receive approval from the Geological Survey before operations may be commenced.

Company **Oil & Gas**

Address **501 Denver**

Denver, Colorado

By **M. E. Brown**
Title **Division Chief Clerk**

Handwritten signature

NEW MEXICO OIL CONSERVATION COMMISSION
Well Location and Acreage Dedication Plat

SECTION A.

Date April 10, 1963

Operator Sinclair Oil & Gas Company Lease Navajo Tribal 1000 San Juan
Well No. 1 Unit Letter 12 Section 12 Township 30 North Range 19 West NMPM
Located 1820 Feet From South Line, 2070 Feet From West Line
County San Juan G. L. Elevation 5122 Dedicated Acreage 10 Acres
Name of Producing Formation Wash (20 feet Devonian) Pool Widont

1. Is the Operator the only owner* in the dedicated acreage outlined on the plat below? Yes Yes No _____
2. If the answer to question One is "No," have the interests of all the owners been consolidated by communitization agreement or otherwise? Yes _____ No _____. If answer is "Yes," Type of Consolidation _____
3. If the answer to question Two is "No," list all the owners and their respective interests below

OWNER

LAND DESCRIPTION

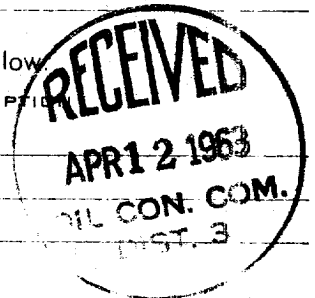

SECTION B.

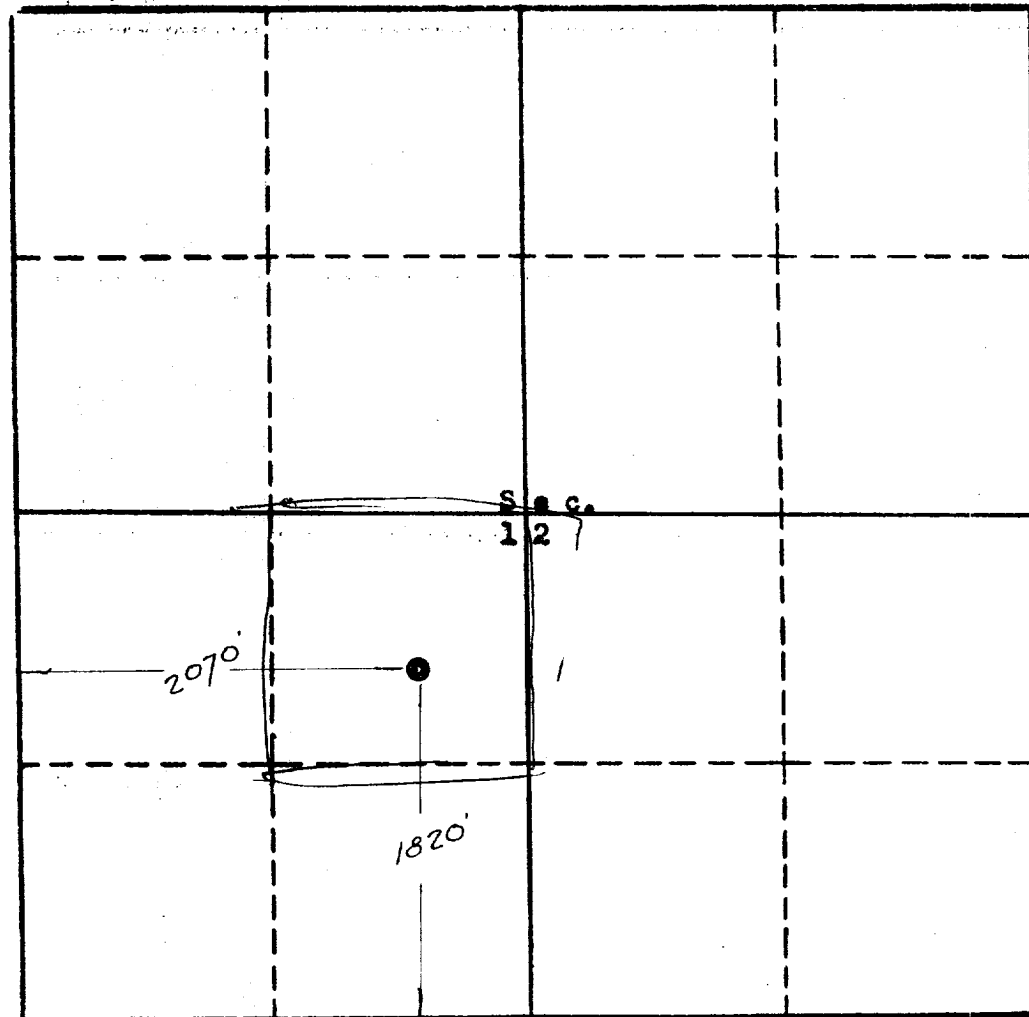

This is to certify that the information in Section A above is true and complete to the best of my knowledge and belief.

SINCLAIR OIL & GAS COMPANY
(OPERATOR)

M. E. Brown
(REPRESENTATIVE)
M. E. Brown

601 Denver Club Building
Denver 2, Colorado

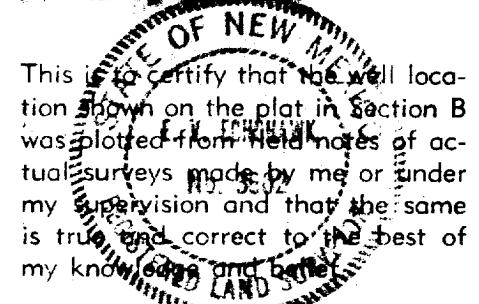

This is to certify that the well location shown on the plat in Section B was plotted from field notes of actual surveys made by me or under my supervision and that the same is true and correct to the best of my knowledge and belief.

Date Surveyed April 2, 1963
Four States Engineering Co.
FARMINGTON, NEW MEXICO

Ernest V. Cabshaw
REGISTERED ENGINEER OR
LAND SURVEYOR

Certificate No. 3602



NEW MEXICO OIL CONSERVATION COMMISSION
Well Location and Acreage Dedication Plat

SECTION A.

Date April 2, 1963

Operator Sinclair Oil & Gas Company Lease Survey 2070 1820 San Juan
 Well No. 1 Unit Letter SP Section 12 Township 30' North Range 19 West NMPM
 Located 1820 Feet From South Line, 2070 Feet From West Line
 County San Juan G. L. Elevation 5122 Dedicated Acreage 10 Acres
 Name of Producing Formation None (to West Downside) Pool 1820

1. Is the Operator the only owner* in the dedicated acreage outlined on the plat below? Yes Yes No _____
2. If the answer to question One is "No," have the interests of all the owners been consolidated by communitization agreement or otherwise? Yes _____ No _____. If answer is "Yes," Type of Consolidation _____
3. If the answer to question Two is "No," list all the owners and their respective interests below:

OWNER LAND DESCRIPTION

SECTION B.

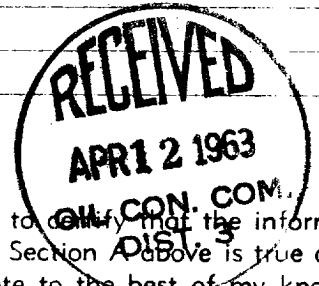
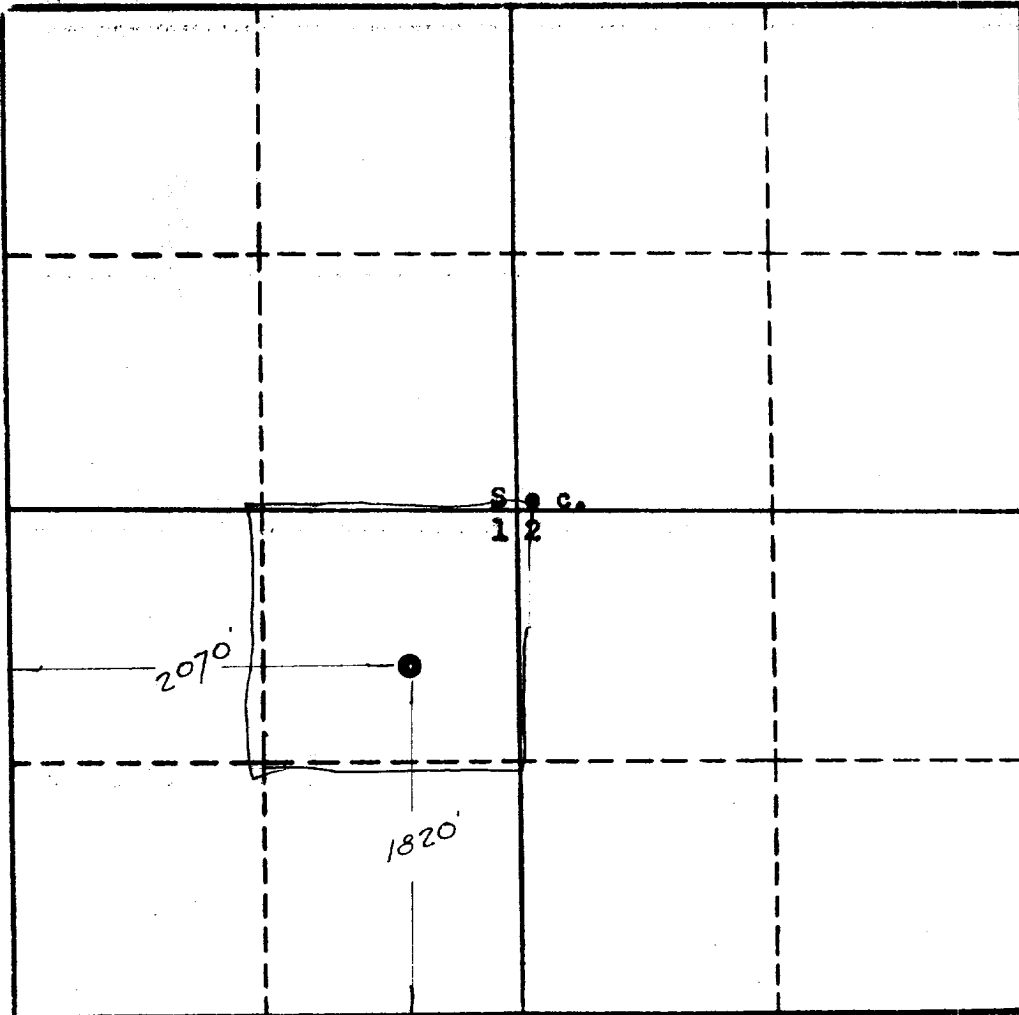

This is to certify that the information in Section A above is true and complete to the best of my knowledge and belief.

SINCLAIR OIL & GAS COMPANY
(OPERATOR)

M. E. Brown
(REPRESENTATIVE)
M. E. BROWN

OIL Survey Club Building
Denver 2, Colorado

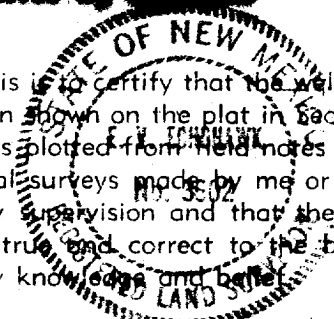

This is to certify that the well location shown on the plat in Section B was plotted from field notes of actual surveys made by me or under my supervision and that the same is true and correct to the best of my knowledge and belief.

Date Surveyed April 2, 1963
Four States Engineering Co.
FARMINGTON, NEW MEXICO

Ernest A. Cabshaw
REGISTERED ENGINEER OR
LAND SURVEYOR

Certificate No. 3602

