

(SUBMIT IN TRIPLICATE)

UNITED STATES
DEPARTMENT OF THE INTERIOR
GEOLOGICAL SURVEY

Land Office SALES - 8
Lease No. VM-04444
Unit _____

SUNDRY NOTICES AND REPORTS ON WELLS

NOTICE OF INTENTION TO DRILL	<input checked="" type="checkbox"/>	SUBSEQUENT REPORT OF WATER SHUT-OFF	
NOTICE OF INTENTION TO CHANGE PLANS		SUBSEQUENT REPORT OF SHOOTING OR ACIDIZING	
NOTICE OF INTENTION TO TEST WATER SHUT-OFF		SUBSEQUENT REPORT OF ALTERING CASING	
NOTICE OF INTENTION TO RE-DRILL OR REPAIR WELL	<input checked="" type="checkbox"/>	SUBSEQUENT REPORT OF RE-DRILLING OR REPAIR	
NOTICE OF INTENTION TO SHOOT OR ACIDIZE		SUBSEQUENT REPORT OF ABANDONMENT	
NOTICE OF INTENTION TO PULL OR ALTER CASING		SUPPLEMENTARY WELL HISTORY	
NOTICE OF INTENTION TO ABANDON WELL			

(INDICATE ABOVE BY CHECK MARK NATURE OF REPORT, NOTICE, OR OTHER DATA)

_____ Feb-25 _____, 19 60

Well No. 2-X is located 2130 ft. from N line and 1850 ft. from E line of sec. 10

NW 35 and Sec. No.) 30N-16W (Range) N. M. P. M.
Horseshoe San Juan New Mexico
(County, or Subdivision) (State)

The elevation of the derrick floor above sea level is 5433 ft.

DETAILS OF WORK

(State names of and expected depths to objective sands; show sizes, weights, and lengths of proposed casings; indicate mudding jobs, cementing points, and all other important proposed work)

We Propose To: Set 100 ft, 10-3/4 surface casing at 100 ft with 100 sacks cement, . Drill to approximately 1800 ft, set 5-1/2 casing at 1800 ft, with 200 sacks cement. Perforate Gallup-Sanastee Sands, Sand Oil Frac, Run 2-3/8 thy and install pump.

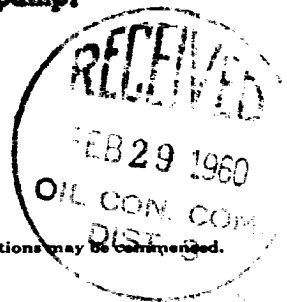

I understand that this plan of work must receive approval in writing by the Geological Survey before operations may be commenced.

Company J. R. Abraham
Address 224-1st National Bank Bldg
Albuquerque, New Mexico

By Pearl Abraham
Title _____



NEW MEXICO OIL CONSERVATION COMMISSION
Well Location and Acreage Dedication Plat

Section A.

Date _____

Operator J.R. ABRAHAM Lease FEDERAL
Well No. 2X Unit Letter _____ Section 10 Township 30 N Range 16 W NMPL
Located 2130 Feet From south Line, 1650 Feet From east Line
County San Juan G. L. Elevation 5433 Dedicated Acreage 40 Acres
Name of Producing Formation _____ Pool _____

1. Is the Operator the only owner* in the dedicated acreage outlined on the plat below?
Yes _____ No _____.
2. If the answer to question one is "no," have the interests of all the owners been consolidated by communitization agreement or otherwise? Yes _____ No _____. If answer is "yes," Type of Consolidation _____
3. If the answer to question two is "no," list all the owners and their respective interests below:

Owner

Land Description

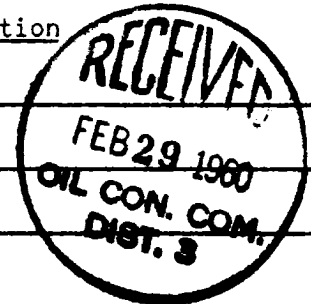

Section B

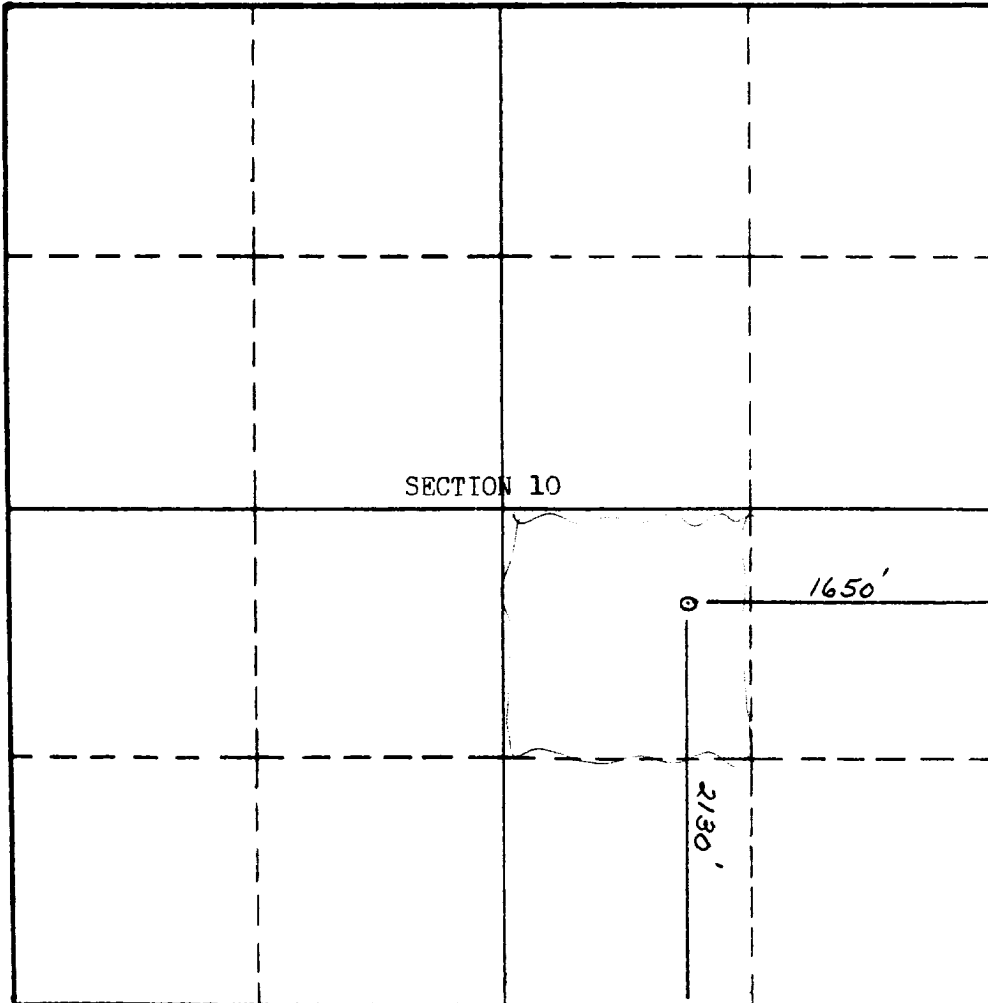

This is to certify that the information in Section A above is true and complete to the best of my knowledge and belief.

(Operator)

(Representative)

Address

This is to certify that the well location shown on the plat in Section B was plotted from field notes of actual surveys made by me or under my supervision and that the same is true and correct to the best of my knowledge and belief.

Date Surveyed Feb. 21, 1960

Stephen H. Kenney
STEPHEN H. KENNEY
Registered Professional
Engineer and/or Land Surveyor.

Certificate No. 003