

(SUBMIT IN TRIPLICATE)

UNITED STATES
DEPARTMENT OF THE INTERIOR
GEOLOGICAL SURVEY

Land Office New Mexico
Lense No. HH 0443
Unit O. J. Hoover "B"

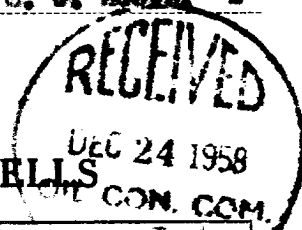

SUNDRY NOTICES AND REPORTS ON WELLS

NOTICE OF INTENTION TO DRILL.....	<input checked="" type="checkbox"/>	SUBSEQUENT REPORT OF WATER SHUT-OFF.....	
NOTICE OF INTENTION TO CHANGE PLANS.....		SUBSEQUENT REPORT OF SHOOTING OR ACIDIZING.....	
NOTICE OF INTENTION TO TEST WATER SHUT-OFF.....		SUBSEQUENT REPORT OF ALTERING CASING.....	
NOTICE OF INTENTION TO RE-DRILL OR REPAIR WELL.....		SUBSEQUENT REPORT OF RE-DRILLING OR REPAIR.....	
NOTICE OF INTENTION TO SHOOT OR ACIDIZE.....		SUBSEQUENT REPORT OF ABANDONMENT.....	
NOTICE OF INTENTION TO PULL OR ALTER CASING.....		SUPPLEMENTARY WELL HISTORY.....	
NOTICE OF INTENTION TO ABANDON WELL.....			

(INDICATE ABOVE BY CHECK MARK NATURE OF REPORT, NOTICE, OR OTHER DATA)

O. J. Hoover "B"

Farmington, New Mexico December 17, 19 58Well No. 5 is located 2120 ft. from NE line and 1830 ft. from EW line of sec. 11SW 1/4 of Section 11
(1/4 Sec. and Sec. No.)T-30-N
(Twp.)R-16-W
(Range)N.M.P.M.
(Meridian)Marschoke Gallup
(Field)San Juan
(County or Subdivision)New Mexico
(State or Territory)

The elevation of the derrick floor above sea level is _____ ft. (To be reported later.)

DETAILS OF WORK

(State names of and expected depths to objective sands; show sizes, weights, and lengths of proposed casings; indicate mudding jobs, cementing points, and all other important proposed work)

We propose to drill the above well to a depth of approximately 2100 feet to test and develop productive Gallup Zones. Stimulation will be as indicated upon penetration of Gallup Pay. Rotary tools will be used to total depth. Casing program will be as follows:

SIZE	DEPTH	CEMENT	REMARKS
8-5/8"	200'		Neat - circulate to surface.
4-1/2"	2100'	175	4% gel and neat.

Copies of location plat are attached. A copy of any survey taken will be submitted upon completion of well.

I understand that this plan of work must receive approval in writing by the Geological Survey before operations may be commenced.

Company Pan American Petroleum CorporationAddress Box 487Farmington, New Mexico

ORIGINAL SIGNED BY

D. J. SCOTT

By

Title Field Clerk

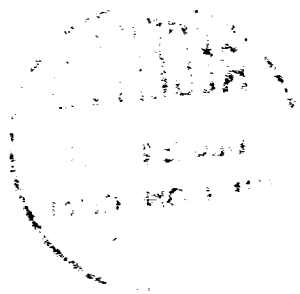

NEW MEXICO OIL CONSERVATION COMMISSION

Well Location and Acreage Dedication Plat

Section A.

Date December 16, 1958

Operator Pan American Petroleum Corporation Lease O. J. Hoover "B"
Well No. 5 Unit Letter K Section 11 Township 30 North Range 16 West NMPM
Located 2120 Feet From South Line, 1830 Feet From West Line
County San Juan G. L. Elevation * Dedicated Acreage 40 Acres
Name of Producing Formation Gallup Pool Horseshoe Gallup

1. Is the Operator the only owner* in the dedicated acreage outlined on the plat below?
Yes X No *To be reported later
2. If the answer to question one is "no," have the interests of all the owners been consolidated by communitization agreement or otherwise? Yes No . If answer is "yes,"
Type of Consolidation
3. If the answer to question two is "no," list all the owners and their respective interests below:

Owner

Land Description



Section. B

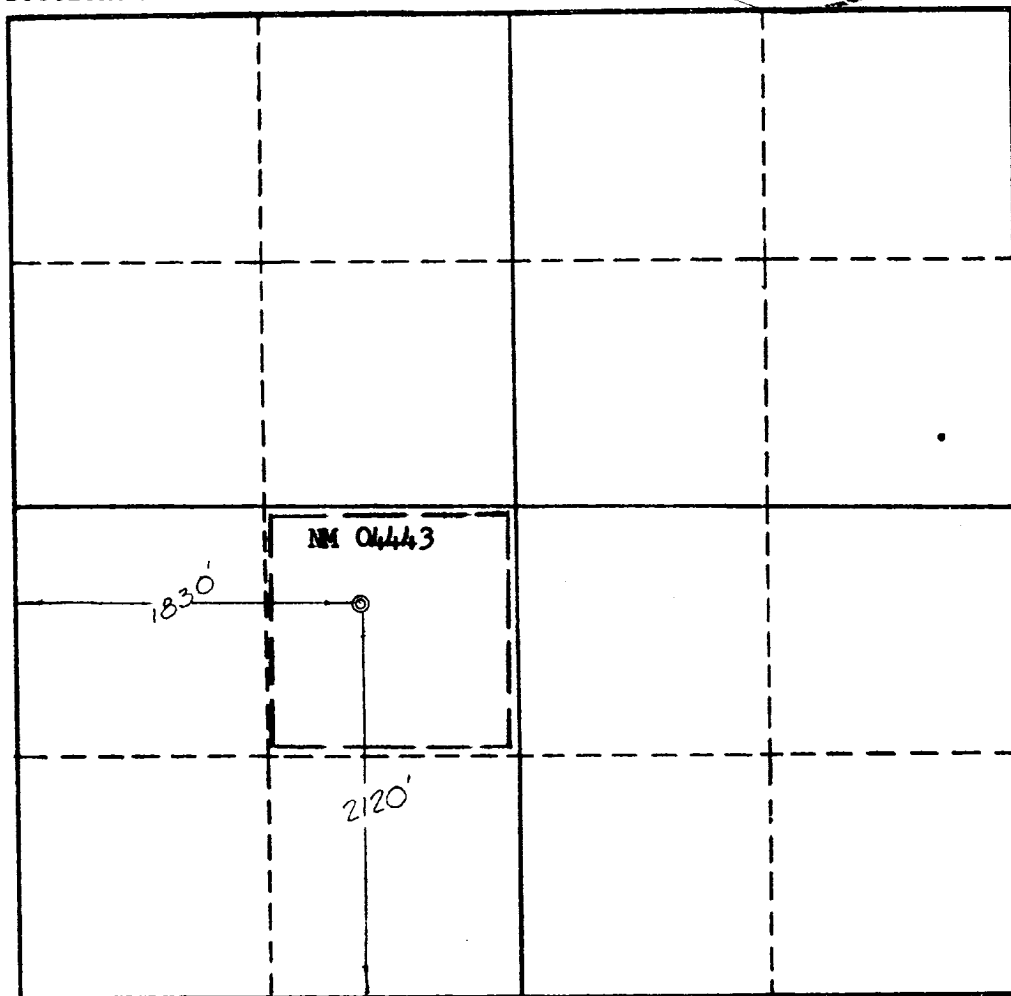

This is to certify that the information in Section A above is true and complete to the best of my knowledge and belief.

PAN AMERICAN PETROLEUM CORP.

(Operator)

R. M. Bauer, Jr. RMBauer, Jr.

(Representative)

Box 487, Farmington, N. Mex

Address

This is to certify that the well location shown on the plat in Section B was plotted from field notes of actual surveys made by me or under my supervision and that the same is true to the best of my knowledge and belief.

Date Surveyed Dec. 14, 1958

Ernest V. Echohawk
Ernest V. Echohawk
Registered Land Surveyor.

Certificate No. 1545

