

NEW MEXICO OIL CONSERVATION COMMISSION
Santa Fe, New Mexico

NOTICE OF INTENTION TO DRILL OR RECOMPLETE

Notice must be given to the District Office of the Oil Conservation Commission and approval obtained before drilling or recomplection begins. If changes in the proposed plan are considered advisable, a copy of this notice showing such changes will be returned to the sender. Submit this notice in QUINTUPLICATE. One copy will be returned following approval. See additional instructions in Rules and Regulations of the Commission.

Dallas, Texas

May 5, 1954

(Place)

(Date)

OIL CONSERVATION COMMISSION
SANTA FE, NEW MEXICO

Gentlemen:

You are hereby notified that it is our intention to commence the (Drilling) (~~Recompletion~~) of a well to be known as **W. P. Carr**

(Company or Operator)

Crandall

Well No. **1**

(Lease)

(Unit)

located **1950** feet from the **North** line and **1712** feet from the **West** line of Section **8** T **30N** R **11W** NMPM.

(GIVE LOCATION FROM SECTION LINE) **Aztec, Pictured Cliffs** Pool, **San Juan** County

If State Land the Oil and Gas Lease is No. _____
If patented land the owner is **Sara Crandall, et al**
Address **Aztec, New Mexico**

We propose to drill well with drilling equipment as follows: **Will set surface casing with cable tools; all other drilling with rotary.**

The status of plugging bond is **approved.**

Drilling Contractor **Greer-Smith Drilling Corp.**
315 1/2 W. Main St.
Farmington, N.M.

We intend to complete this well in the **Pictured Cliffs formation**
formation at an approximate depth of **2155** feet.

CASING PROGRAM

We propose to use the following strings of Casing and to cement them as indicated:

Size of Hole	Size of Casing	Weight per Foot	New or Second Hand	Depth	Sacks Cement
12-5/8"	8-5/8"	28#	New	80-150'	To circulate
7-7/8"	5-1/2"	14#	New	2000'	80-150 sacks

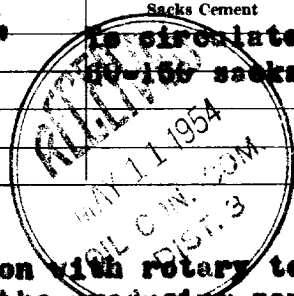

If changes in the above plans become advisable we will notify you immediately.

ADDITIONAL INFORMATION (If recomplection give full details of proposed plan of work.)

We will drill through the Pictured Cliffs formation with rotary tools. After electric logging we will set 8 1/2" casing on top of the producing zone. We will shoot the indicated sections using 2 1/2 to 4 qts. of solid nitro-glycerin per foot.

Approved **6-8**, 19 **54**
Except as follows:

Sincerely yours,

W. P. Carr

By **W P Carr** (Company or Operator)
Operator

Position _____
Send Communications regarding well to

Name **W. P. Carr**
Address **6700 Forest Lane Dallas 30, Texas**

OIL CONSERVATION COMMISSION
By **Ernest Arnold**
Title _____

OIL CONSERVATION COMMISSION

AZTEC DISTRICT OFFICE

No. Copies Received 5

DISTRIBUTION

	NO.	
Operator	/	
Geologist	/	
Production Engineer	/	
State Geologist	/	
U. S. G. S.	/	
Transporter		
File	/	✓

Company W. F. Carr

Lease Crandall Well No. 1

Sec. 8, T. 30N, R. 11W

Location 1950 feet from north line; 1712 feet from west line.

Elevation: 5681.1 GL

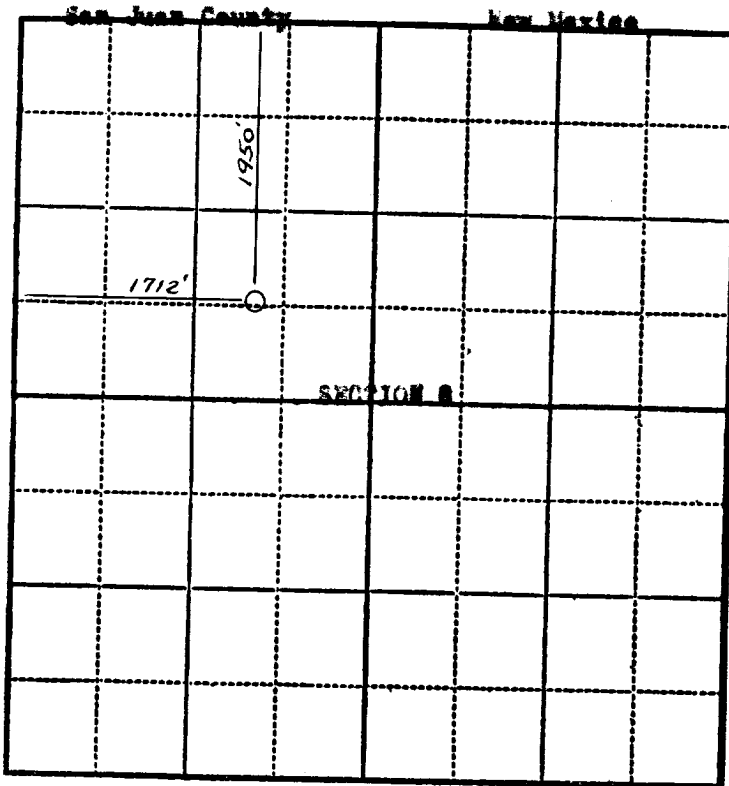

Scale—4 inches equal 1 mile.

This is to certify that the above plat was prepared from field notes of actual surveys made by me or under my supervision and that the same are true and correct to the best of my knowledge and belief.

Stephen H. Lurvey

Seal:

Registered Professional
Engineer and Land Surveyor.

Surveyed April 7, 1954

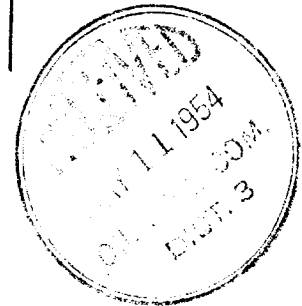

NW 1/4 SECTION 8
TWP 30N R 11 W

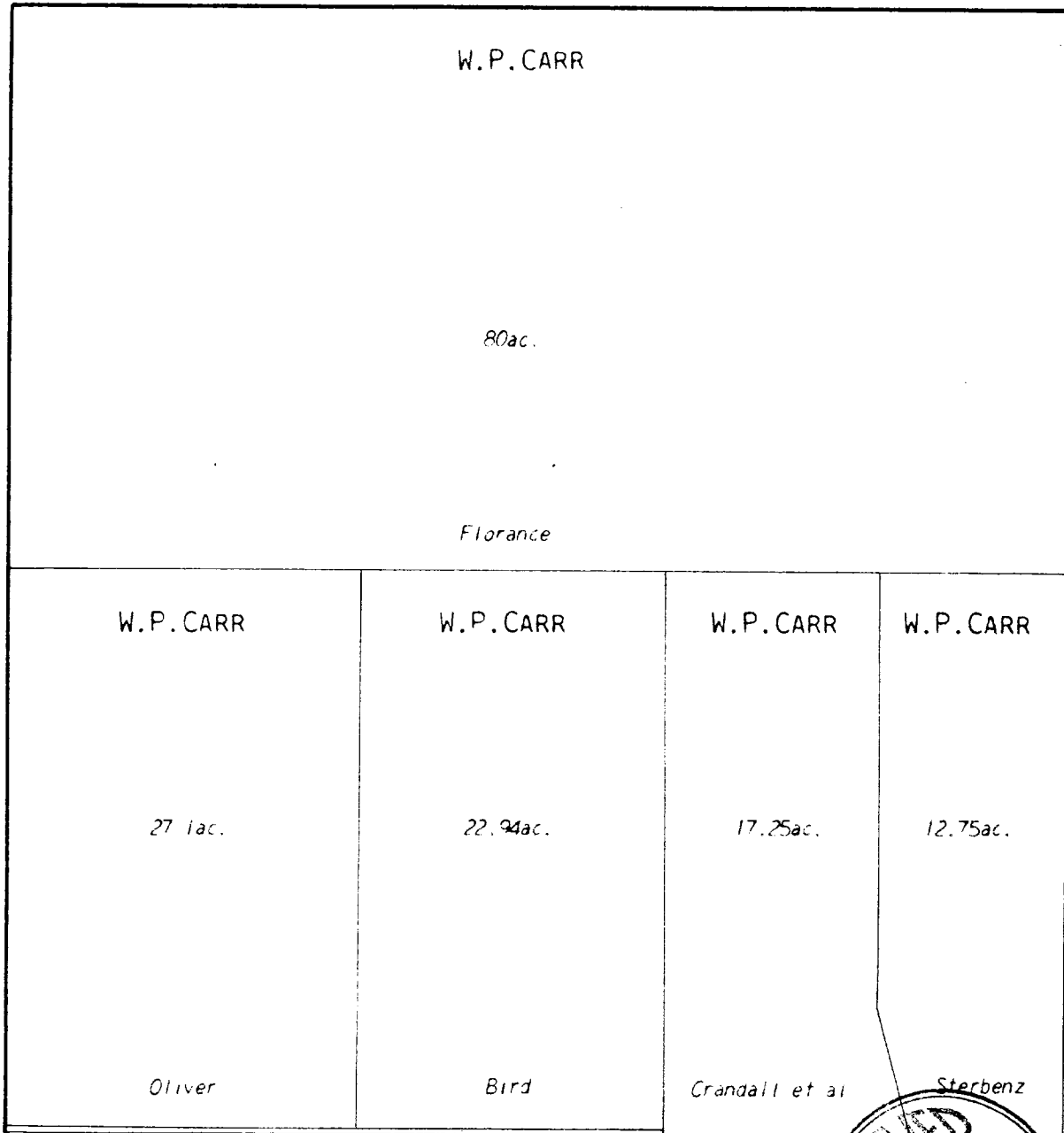

Scale: 1 inch = 400 feet

