

Company W. P. Carr

Lease ..... Well No. ....

Sec. 9, T. 30 N., R. 11 W., N.M.P.M. ....

Location 1137' from the North line and 1753' from the East line.

Elevation 5615 Ungraded ground.

San Juan County

New Mexico

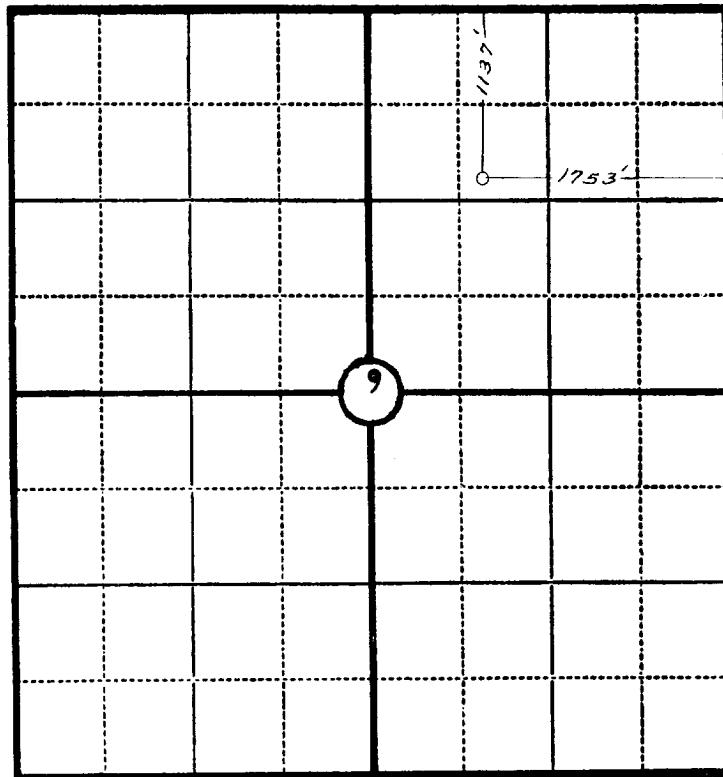

Scale—4 inches equal 1 mile.

This is to certify that the above plat was prepared from field notes of actual surveys made by me or under my supervision and that the same are true and correct to the best of my knowledge and belief.

Seal:

*James P. Leese*  
Registered Professional  
~~Engineer~~ and Land Surveyor.

James P. Leese  
N. Mex. Reg. No. 1463

Surveyed September 2, 1953

OIL CONSERVATION COMMISSION

AZTEC DISTRICT OFFICE

No. Copies Received 6

DISTRIBUTION

	NO. FURNISHED	
Operator	<u>2</u>	
Santa Fe	<u>1</u>	
Proration Office		
State Land Office		
U. S. G. S.	<u>2</u>	
Transporter		
File	<u>1</u>	<input checked="" type="checkbox"/>