

NEW MEXICO OIL CONSERVATION COMMISSION  
Santa Fe, New Mexico

NOTICE OF INTENTION TO DRILL OR RECOMPLETE

Notice must be given to the District Office of the Oil Conservation Commission and approval obtained before drilling or recompletion begins. If changes in the proposed plan are considered advisable, a copy of this notice showing such changes will be returned to the sender. Submit this notice in QUINTUPPLICATE. One copy will be returned following approval. See additional instructions in Rules and Regulations of the Commission.

Dallas, Texas

May 5, 1954

(Place)

(Date)

OIL CONSERVATION COMMISSION  
SANTA FE, NEW MEXICO

Gentlemen:

You are hereby notified that it is our intention to commence the (Drilling) (~~RECOMPLETION~~) of a well to be known as

W. P. Carr

(Company or Operator)

Robert C. Brown

(Lease)

Well No. 1

in (Unit)

The well is

located 1390 feet from the North line and 1900 feet from the West line of Section 9, T. 30N, R. 11W, NMPM.

(GIVE LOCATION FROM SECTION LINE) Astec, Pictured Cliffs Pool, San Juan County

If State Land the Oil and Gas Lease is No.

Robert C. Brown

If patented land the owner is Astec, New Mexico

Address

We propose to drill well with drilling equipment as follows: Will set surface casing with cable tools; all other drilling with rotary.

The status of plugging bond is approved.

Drilling Contractor Greer-Smith Drilling Corp.  
310 1/2 W. Main St.  
Farmington, N.M.

We intend to complete this well in the Pictured Cliffs formation  
3120 feet.

CASING PROGRAM

We propose to use the following strings of Casing and to cement them as indicated:

Size of Hole	Size of Casing	Weight per Foot	New or Second Hand	Depth	Sacks Cement
12-3/8"	8-5/8"	28#	New	80-150'	To circulate
7-7/8"	5-1/2"	14#	New	2045'	80-150 sacks

If changes in the above plans become advisable we will notify you immediately.

ADDITIONAL INFORMATION (If recompletion give full details of proposed plan of work.)

We will drill through the Pictured Cliffs formation with rotary tools. After electric logging we will set 8 1/2" casing on top of the producing zone. We will shoot the indicated sections using 2 1/2 to 4 qts. of solid nitro-glycerin per foot.

Approved: 6-8, 1954, 57

Except as follows:

Sincerely yours,

W. P. Carr

(Company or Operator)

By

Operator

Position

Send Communications regarding well to

Name

W. P. Carr

Address

6700 Forest Lane  
Dallas 30, Texas

OIL CONSERVATION COMMISSION

By

Oil and Gas Inspector Dist. #3.

Title

OIL CONSERVATION COMMISSION		
AZTEC DISTRICT OFFICE		
No. Copies Received		5
DISTRIBUTION		
	NO. FURNISHED	
Operator	/	
Santa Fe	/	
Proration Office		
State Land Office	/	
U. S. G. S.	/	
Transporter		
File	/	✓

Company W.P.Carr

Lease Brown Well No. 1

Sec. 9, T. 20N, R. 11W

Location 1899 feet from north line; 1900 feet  
from west line.

Elevation: 5612.9 GL

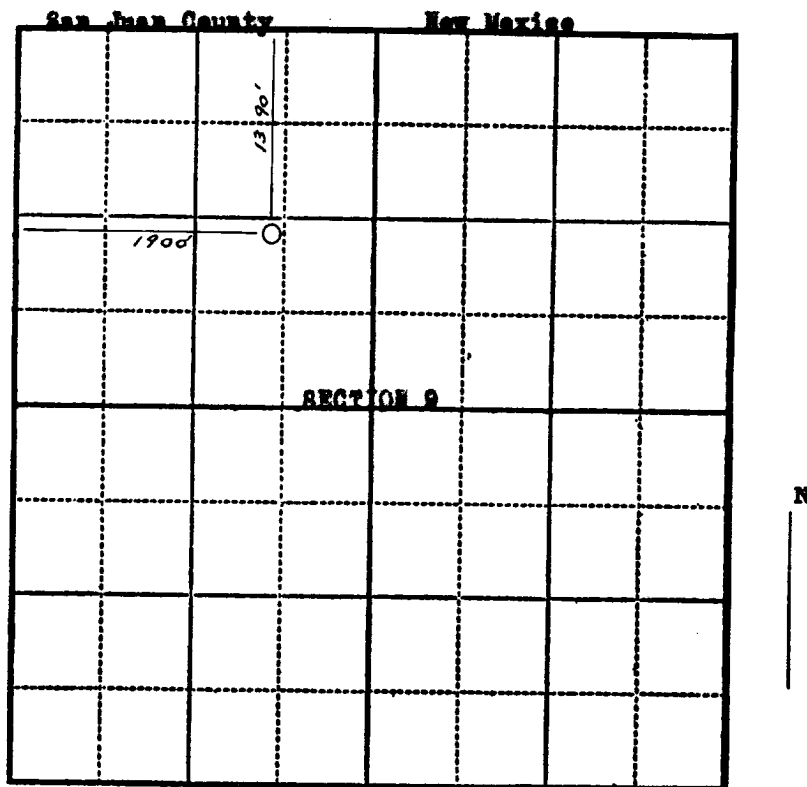

Scale—4 inches equal 1 mile.

This is to certify that the above plat was prepared from field notes of actual surveys made by me or under my supervision and that the same are true and correct to the best of my knowledge and belief.

*Stephen H. Kinney*

Seal:

Registered Professional  
Engineer and Land Surveyor.

Surveyed April 7, 19 54

NW 1/4 SECTION 9  
TWP 30 N R 11 W

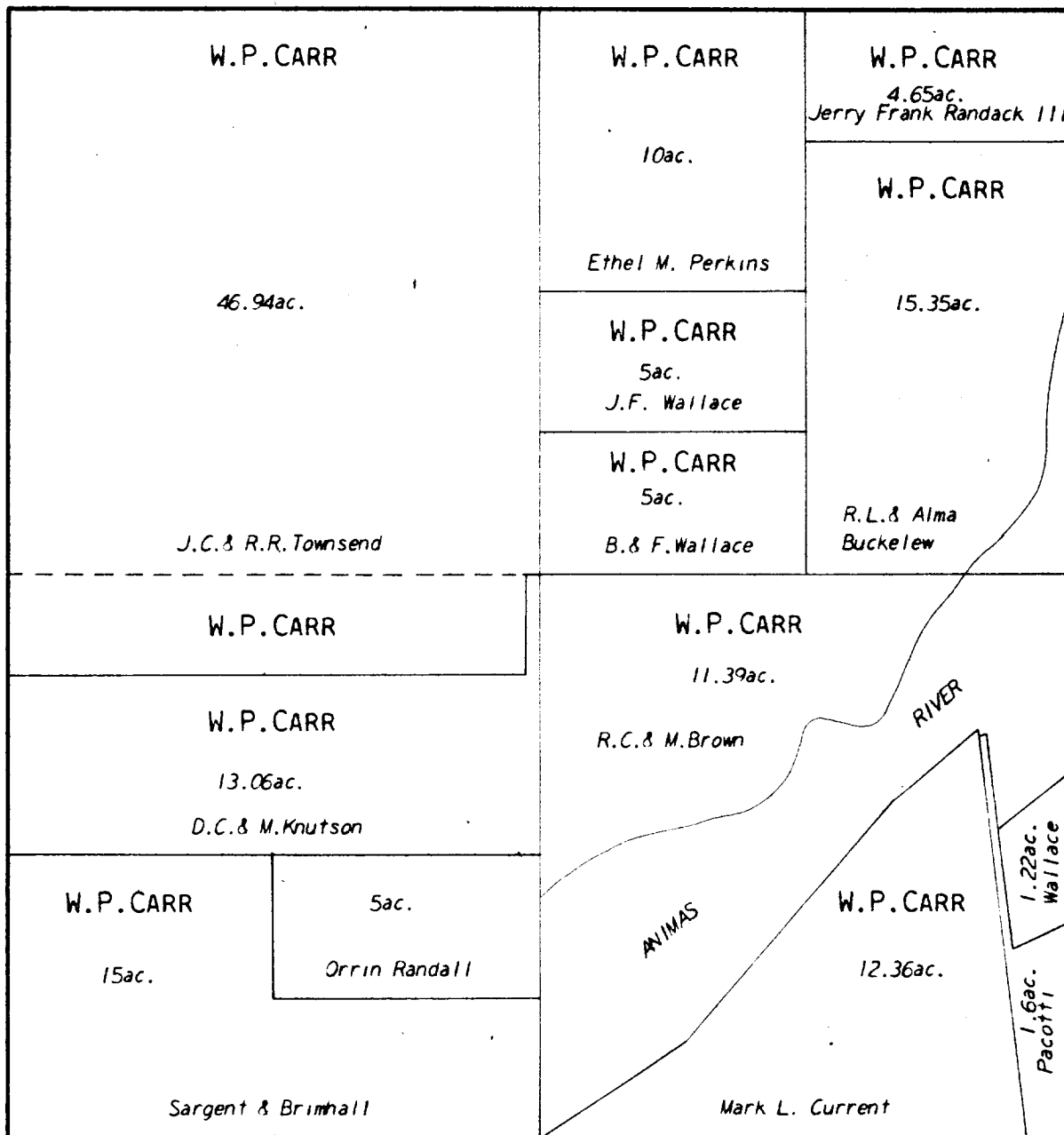

Scale: 1 inch = 400 feet

