

Santa Fe

Land Office

35193

Lease No.

Fiddle

Unit

RECEIVED

APR 22 1953

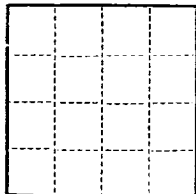
U. S. GEOLOGICAL SURVEY
FARMINGTON, N. M.(SUBMIT IN TRIPLICATE)
UNITED STATES
DEPARTMENT OF THE INTERIOR
GEOLOGICAL SURVEY

SUNDRY NOTICES AND REPORTS ON WELLS

NOTICE OF INTENTION TO DRILL.....	<input checked="" type="checkbox"/>	SUBSEQUENT REPORT OF WATER SHUT-OFF.....	
NOTICE OF INTENTION TO CHANGE PLANS.....		SUBSEQUENT REPORT OF SHOOTING OR ACIDIZING.....	
NOTICE OF INTENTION TO TEST WATER SHUT-OFF.....		SUBSEQUENT REPORT OF ALTERING CASING.....	
NOTICE OF INTENTION TO RE-DRILL OR REPAIR WELL.....		SUBSEQUENT REPORT OF RE-DRILLING OR REPAIR.....	
NOTICE OF INTENTION TO SHOOT OR ACIDIZE.....		SUBSEQUENT REPORT OF ABANDONMENT.....	
NOTICE OF INTENTION TO PULL OR ALTER CASING.....		SUPPLEMENTARY WELL HISTORY.....	
NOTICE OF INTENTION TO ABANDON WELL.....			

(INDICATE ABOVE BY CHECK MARK NATURE OF REPORT, NOTICE, OR OTHER DATA)

April 21, 1953

Well No. 3 is located 990 ft. from ~~XXXX~~ (N) line and 1650 ft. from ~~XXXX~~ (E) line of sec. 10
 NE Section 10 30N 9W N. M. P. 11
 (1/4 Sec. and Sec. No.) (Twp.) (Range) (Meridian)
 Blanco San Juan New Mexico
 (Field) (County or Subdivision) (State or Territory)

The elevation of the derrick floor above sea level is 6033 ft.

DETAILS OF WORK

(State names of and expected depths to objective sands; show sizes, weights, and lengths of proposed casings; indicate mudding jobs, cementing points, and all other important proposed work)

It is intended to drill a well with Rotary tools through the Mesaverde, drilling the pay with gas circulation and to shoot the entire Mesaverde with two quarts of S.N.G. per foot. Total Depth 5254'.

Casing Program:

9 5/8 @ 160' with 125 sacks of regular cement circulated to surface.
 7' @ 4424' with 300 sacks of regular cement.

The E $\frac{1}{2}$ of Section 10 is dedicated to this well.

I understand that this plan of work must receive approval in writing by the Geological Survey before operations may be commenced.

Company EL PASO NATURAL GAS COMPANY

Address BOX 997

FARMINGTON, NEW MEXICO

By

Title Petroleum Engineer.

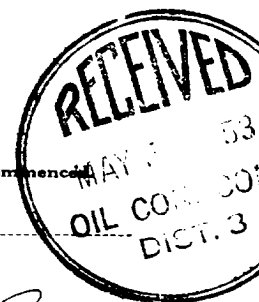

COMPANY EL PASO NATURAL GAS CO.

Well Name & No. Riddle No. 3 Lease No. SF 081098

Location 990 feet from the North line. 1650 feet from the East line.

Being in NW $\frac{1}{4}$ of the NE $\frac{1}{4}$

Sec. 10, T30N., R9W., N.M.P.M., San Juan County, New Mexico

Ground Elevation 6023.85

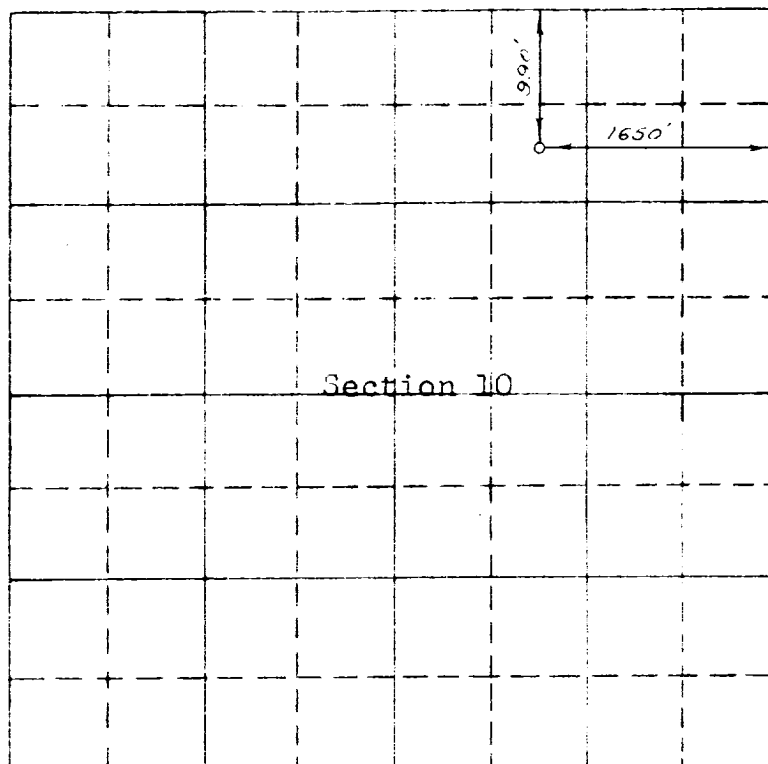

RECEIVED

APR 28 1953

U.S. GEOLOGICAL SURVEY
FARMINGTON, N. M.

Scale -- 4 inches equals 1 mile

Surveyed June 28, , 19 52

This is to certify that the above plat was prepared from field notes of actual surveys made by me or under my supervision and that the same are true and correct to the best of my knowledge and belief.

C. O. Walker

Registered Professional
Engineer and Land Surveyor.

Seal:

Farmington, New Mexico

