

(SUBMIT IN TRIPLICATE)

Indian Agency Window Rock

UNITED STATES
DEPARTMENT OF THE INTERIOR
GEOLOGICAL SURVEY

Allottee _____
Lease No. 14-20-603-2029

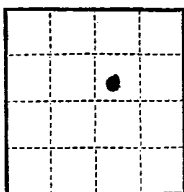

SUNDRY NOTICES AND REPORTS ON WELLS

NOTICE OF INTENTION TO DRILL	<input checked="" type="checkbox"/>	SUBSEQUENT REPORT OF WATER SHUT-OFF	
NOTICE OF INTENTION TO CHANGE PLANS		SUBSEQUENT REPORT OF SHOOTING OR ACIDIZING	
NOTICE OF INTENTION TO TEST WATER SHUT-OFF		SUBSEQUENT REPORT OF ALTERING CASING	
NOTICE OF INTENTION TO REDRILL OR REPAIR WELL		SUBSEQUENT REPORT OF REDRILLING OR REPAIR	
NOTICE OF INTENTION TO SHOOT OR ACIDIZE		SUBSEQUENT REPORT OF ABANDONMENT	
NOTICE OF INTENTION TO PULL OR ALTER CASING		SUPPLEMENTARY WELL HISTORY	
NOTICE OF INTENTION TO ABANDON WELL			

RECEIVED
JUN 7 1960
U. S. GEOLOGICAL SURVEY
FARMINGTON, NEW MEXICO

(INDICATE ABOVE BY CHECK MARK NATURE OF REPORT, NOTICE, OR OTHER DATA)

June 6, 1960

NAVAJO - 29

Well No. 1 is located 2310 ft. from N line and 2310 ft. from E line of sec. 9

SW 1/4, NE 1/4 Sec 9
(1/4 Sec. and Sec. No.)

30-N
(Twp.)

17-W
(Range)

17-N
(Meridian)

Chimney Rock
(Field)

San Juan County
(County or Subdivision)

New Mexico
(State or Territory)

The elevation of the derrick floor above sea level is 5133 ft.

DETAILS OF WORK

(State names of and expected depths to objective sands; show sizes, weights, and lengths of proposed casings; indicate mudding jobs, cementing points, and all other important proposed work)

Drill with Rotary Tools and using Air to 800' or top of
Sanstee formation, log, and test formation. If productive,
set 4 1/2" casing and complete well natural.

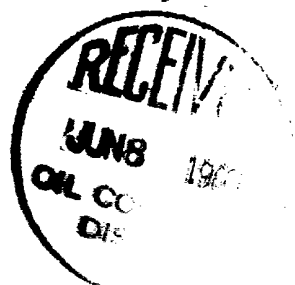

I understand that this plan of work must receive approval in writing by the Geological Survey before operations may be commenced.

Company Empire States Drilling Corp

Address Box 891

Farmington, New Mexico

By

Title

R. E. Jackson
resident

100-100000-100000

100-100000-100000

100-100000-100000

100-100000-100000

100-100000-100000

100-100000-100000

100-100000-100000

100-100000-100000

100-100000-100000

100-100000-100000

100-100000-100000

100-100000-100000

100-100000-100000

100-100000-100000

100-100000-100000

100-100000-100000

100-100000-100000

100-100000-100000



100-100000-100000

100-100000-100000

100-100000-100000

100-100000-100000

100-100000-100000

NEW MEXICO OIL CONSERVATION COMMISSION

Well Location and Acreage Dedication Plat

Section A.

Date 6-1-60

Operator Empire States Drilling Corporation Lease Nava jo 29
Well No. 1 Unit Letter G Section 9 Township 30 North Range 17 West NMPM
Located 2310 Feet From North Line, 2310 Feet From East Line
County San Juan G. L. Elevation 5133 Dedicated Acreage 40 Acres
Name of Producing Formation Gallup Pool Chimney Rock

1. Is the Operator the only owner* in the dedicated acreage outlined on the plat below?
Yes ☒ No ☐
2. If the answer to question one is "no," have the interests of all the owners been consolidated by communitization agreement or otherwise? Yes ☐ No ☐ If answer is "yes,"
Type of Consolidation _____
3. If the answer to question two is "no," list all the owners and their respective interests below:

Owner

Land Description

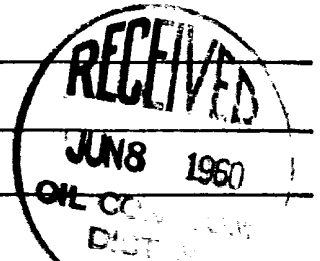

Section. B

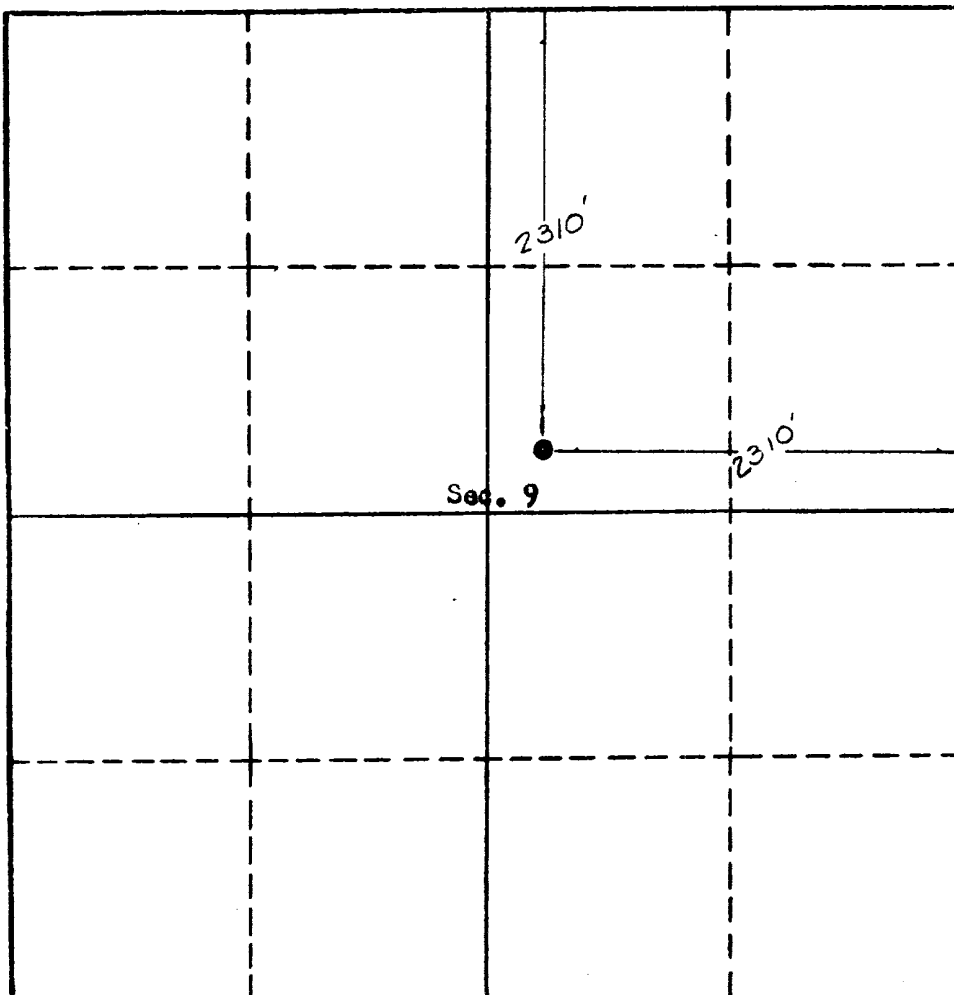

This is to certify that the information in Section A above is true and complete to the best of my knowledge and belief.

Empire States Drlg. Corp.
(Operator)
W. E. Jackson
(Representative)

Box 891, Farmington, N.M.
Address

This is to certify that the well location shown on the plat in Section B was based on field notes of actual surveys made by me or under my supervision and that the same is true and correct to the best of my knowledge and belief.

Date Surveyed May 27, 1960

Ernest V. Echoshawk
Ernest V. Echoshawk
Registered Land Surveyor.

Certificate No. 1545

14-00000

1001 5748