

			X

(SUBMIT IN TRIPLICATE)

UNITED STATES
DEPARTMENT OF THE INTERIOR
GEOLOGICAL SURVEY

Land Office Santa Fe
Lease No. MD-024158
Unit _____

SUNDRY NOTICES AND REPORTS ON WELLS

NOTICE OF INTENTION TO DRILL	X	SUBSEQUENT REPORT OF WATER SHUT-OFF	
NOTICE OF INTENTION TO CHANGE PLANS		SUBSEQUENT REPORT OF SHOOTING OR ACIDIZING	
NOTICE OF INTENTION TO TEST WATER SHUT-OFF		SUBSEQUENT REPORT OF ALTERING CASING	
NOTICE OF INTENTION TO RE-DRILL OR REPAIR WELL		SUBSEQUENT REPORT OF RE-DRILLING OR REPAIR	
NOTICE OF INTENTION TO SHOOT OR ACIDIZE		SUBSEQUENT REPORT OF ABANDONMENT	
NOTICE OF INTENTION TO PULL OR ALTER CASING		SUPPLEMENTARY WELL HISTORY	
NOTICE OF INTENTION TO ABANDON WELL			

(INDICATE ABOVE BY CHECK MARK NATURE OF REPORT, NOTICE, OR OTHER DATA)

R. E. McKenzie Gas Unit "A" December 22, 1961

Well No. 1 is located 910 ft. from N line and 805 ft. from E line of sec. 9

NE/4 Section 9

30N

12W

N.M.P.M.

(Twp.)

(Range)

(Meridian)

San Juan

San Juan

New Mexico

(Field)

(County or Subdivision)

(State or Territory)

ground level

The elevation of the derrick floor above sea level is 5806 ft.

DETAILS OF WORK

(State names of and expected depths to objective sands; show sizes, weights, and lengths of proposed casings; indicate mudlogging jobs, cementing points, and all other important proposed work)

Drill and complete subject well as follows:

1. Drill 11" hole to 250'. Set 8-5/8" OD, 24#, J-55, STAC casing at 250' and circulate cement to surface. WOC 12 hours. Pressure test casing after WOC 8 hours.
2. Drill 7-7/8" hole to TD, approximately 6720'.
3. Run KB-Induction and Gamma Ray-Sonic logs.
4. Run 5-1/2" OD, 14# and 15.5#, J-55 casing through lowest pay. Set stage collar 50' below base of Pictured Cliff and cement in two stages. First stage: 250 ax 50-50 Pozmix 2% gel. Second stage: 50 ax 50-50 Pozmix 6% gel. WOC. Pressure test casing.
5. Perforate, fracture, and clean up well. Run potential test and clean location.

I understand that this plan of work must receive approval in writing by the Geological Survey before operations may be commenced.

Company TENNECO OIL COMPANY

Address P. O. Box 1714

Durango, Colorado

By B. Plumb B. Plumb

Title District Production Supt.

NUMBER OF COPIES RECEIVED	
DISTRIBUTION	
SANTAFE	
FILE	
U.S.G.S.	
LAND OFFICE	
TRANSPORTER	OIL GAS
PRODUCTION OFFICE	
OPERATOR	

NEW MEXICO OIL CONSERVATION COMMISSION
WELL LOCATION AND ACREAGE DEDICATION PLAT
 SEE INSTRUCTIONS FOR COMPLETING THIS FORM ON THE REVERSE SIDE

FORM C-128
 Revised 5/1/57

SECTION A

Operator Tenneco Oil Company			Lease R. E. McKenzie Gas Unit "A"		Well No. 1
Unit Letter A	Section 9	Township 30 North	Range 12 West	County San Juan	

Actual Footage Location of Well:

910	feet from the	North	line and	805	feet from the	East	line
Ground Level Elev. 5806' ungraded	Producing Formation Dakota & Gallup		Pool Basin Dakota Wildcat Gallup		Dedicated Acreage: 320 Acres		

1. Is the Operator the only owner in the dedicated acreage outlined on the plat below? YES ☒ NO ____ . ("Owner" means the person who has the right to drill into and to produce from any pool and to appropriate the production either for himself or for himself and another. (65-3-29 (e) NMSA 1935 Comp.)
2. If the answer to question one is "no," have the interests of all the owners been consolidated by communization agreement or otherwise? YES ____ NO ____ . If answer is "yes," Type of Consolidation ____
3. If the answer to question two is "no," list all the owners and their respective interests below:

Owner	Land Description

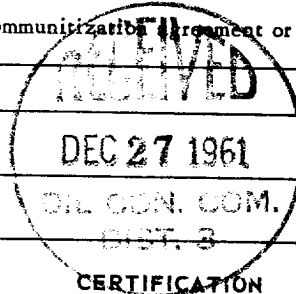

SECTION B

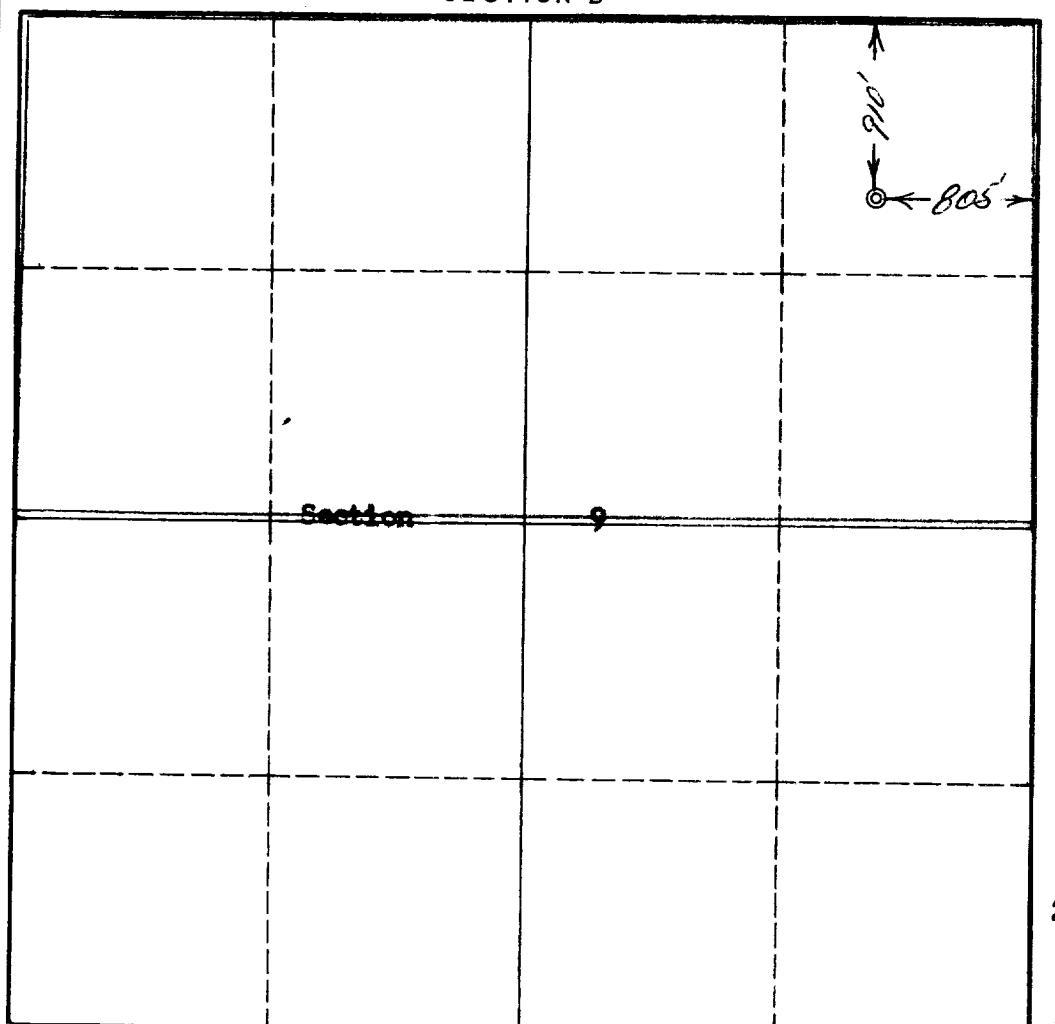

I hereby certify that the information in SECTION A above is true and complete to the best of my knowledge and belief.

L. B. Plumb
Name
Dist. Production Supt.
Position
TENNECO OIL COMPANY
Company
December 22, 1961
Date

I hereby certify that the well location shown on the plat in SECTION B was plotted from field notes of actual surveys made by me or under my supervision, and that the same is true and correct to the best of my knowledge and belief.

Date Surveyed
21 December 1961
Registered Professional Engineer and/or Land Surveyor
Robert H. Bink
San Juan Engineering Co.
Certificate No.

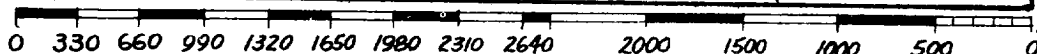

PE & LS 2463

INSTRUCTIONS FOR COMPLETION OF FORM C-128

1. Operator shall furnish and certify to the information called for in Section A.
2. Operator shall outline the dedicated acreage for *both* oil and gas wells on the plat in Section B.
3. A registered professional engineer or land surveyor registered in the State of New Mexico or approved by the Commission shall show on the plat the location of the well and certify this information in the space provided.
4. All distances shown on the plat must be from the outer boundaries of the Section.
5. If additional space is needed for listing owners and their respective interests as required in question 3 of Section A, please use space below.