

X			

(SUBMIT IN TRIPLICATE)

UNITED STATES
DEPARTMENT OF THE INTERIOR
GEOLOGICAL SURVEY

Land Office **SF**
Lease No. **081298**
Unit **Williams**

SUNDRY NOTICES AND REPORTS ON WELLS

NOTICE OF INTENTION TO DRILL.....	X	SUBSEQUENT REPORT OF WATER SHUT-OFF.....	
NOTICE OF INTENTION TO CHANGE PLANS.....		SUBSEQUENT REPORT OF SHOOTING OR ACIDIZING.....	
NOTICE OF INTENTION TO TEST WATER SHUT-OFF.....		SUBSEQUENT REPORT OF ALTERING CASING.....	
NOTICE OF INTENTION TO RE-DRILL OR REPAIR WELL.....		SUBSEQUENT REPORT OF RE-DRILLING OR REPAIR.....	
NOTICE OF INTENTION TO SHOOT OR ACIDIZE.....		SUBSEQUENT REPORT OF ABANDONMENT.....	
NOTICE OF INTENTION TO PULL OR ALTER CASING.....		SUPPLEMENTARY WELL HISTORY.....	
NOTICE OF INTENTION TO ABANDON WELL.....			

(INDICATE ABOVE BY CHECK MARK NATURE OF REPORT, NOTICE, OR OTHER DATA)

September 29, 1958

Well No. **1-A** is located **660** ft. from **N** line and **660** ft. from **W** line of sec. **12**

NW NW/4 Section 12 **30-N** **16-W** **NMPM**
(1/4 Sec. and Sec. No.) (Twp.) (Range) (Meridian)
Undesignated **San Juan** **New Mexico**
(Field) (County or Subdivision) (State or Territory)

The elevation of the derrick floor above sea level is **5500** ft.

DETAILS OF WORK

(State names of and expected depths to objective sands; show sizes, weights, and lengths of proposed casings; indicate mudding jobs, cementing points, and all other important proposed work)

It is intended to drill a well through the Lower Gallup Formation using rotary tools and mud circulation. Possible productive intervals will be perforated and sandoil fractured.

Estimated Total Depth 2225'.

Casing Program:

10-3/4" at 127' with 150 sacks cement circulated to surface.

5-1/2" at 2225' with 150 sacks cement for First Stage. Two Stage collar will be placed below Point Lookout and 100 sacks cement circulated across Point Lookout.

The NW NW/4 of Section 12 is dedicated to this well.

NW NW/4 Section 12 SF-081298

I understand that this plan of work must receive approval in writing by the Geological Survey before operations may be commenced

Company **El Paso Natural Gas Products Company**

Address **Post Office Box 1565**
Farmington, New Mexico

ORIGINAL SIGNED BY: WILLIAM K. GLAENER

By _____

Title **Petroleum Engineer**

NEW MEXICO OIL CONSERVATION COMMISSION
Well Location and Acreage Dedication Plat

Section A.

Date September 29, 1958

Operator El Paso Natural Gas Products Co. Lease Williams SF-081298
Well No. 1-A Unit Letter D Section 12 Township 30 N Range 16 W NMPM
Located 660 Feet From north Line, 660 Feet From west Line
County San Juan G. L. Elevation 5493 Dedicated Acreage 40 Acres
Name of Producing Formation Gallop Pool Undesignated

1. Is the Operator the only owner* in the dedicated acreage outlined on the plat below?
Yes X No .
2. If the answer to question one is "no," have the interests of all the owners been consolidated by communitization agreement or otherwise? Yes No . If answer is "yes," Type of Consolidation
3. If the answer to question two is "no," list all the owners and their respective interests below:

Owner

Land Description

RECEIVED

SEP 29 1958

U. S. DEPT. OF THE INTERIOR
BUREAU OF LAND MANAGEMENT

RECEIVED

SEP 30 1958

OIL & GAS COM.
DIST. 3

Section B

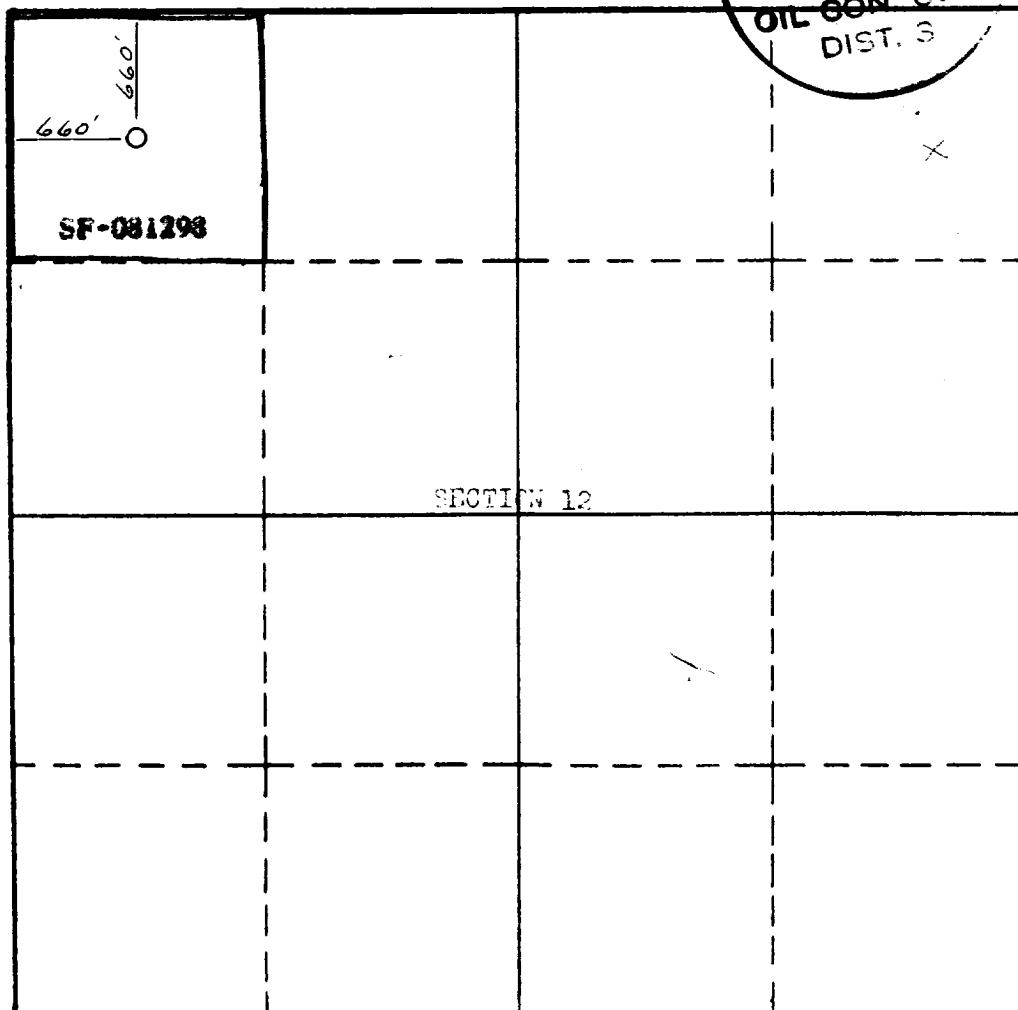

This is to certify that the information in Section A above is true and complete to the best of my knowledge and belief.

El Paso Natural Gas Products Co.
(Operator)

William K. Grayson
(Representative)

Box 1565, Farmington, New Mexico
Address

This is to certify that the well location shown on the plat in Section B was plotted from field notes of actual surveys made by me or under my supervision and that the same is true and correct to the best of my knowledge and belief.

Date Surveyed Sept. 26, 1958
Stephen H. Kinney
STEPHEN H. KINNEY, P.E.

Registered Professional
Engineer and/or Land Surveyor.

Certificate No. 801