

## NEW MEXICO OIL CONSERVATION COMMISSION

Santa Fe, New Mexico

## NOTICE OF INTENTION TO DRILL OR RECOMPLETE

Notice must be given to the District Office of the Oil Conservation Commission and approval obtained before drilling or recompletion begins. If changes in the proposed plan are considered advisable, a copy of this notice showing such changes will be returned to the sender. Submit this notice in **QUINTUPLICATE**. One copy will be returned following approval. See additional instructions in Rules and Regulations of the Commission.

Dallas, Texas

(Place)

May 5, 1954

(Date)

OIL CONSERVATION COMMISSION  
SANTA FE, NEW MEXICO

Gentlemen:

You are hereby notified that it is our intention to commence the (Drilling) ~~XXXXXXXX~~ of a well to be known as

W. P. Carr

(Company or Operator)

Roberts

(Lease)

Well No. 1, in \_\_\_\_\_, The well is

located 790 feet from the \_\_\_\_\_ line and 790 feet from the \_\_\_\_\_

East

South

line of Section 4, T. 30N, R. 11W, NMPM.

(GIVE LOCATION FROM SECTION LINE) Aztec Pictured Cliffs Pool, San Juan County

D	C	B	A
E	F	G	H
L	K	J	I
M	N	O	P

If State Land the Oil and Gas Lease is No.

If patented land the owner is K. M. Roberts

Address Aztec, New Mexico

We propose to drill well with drilling equipment as follows: Will set surface casing with cable tools; all other drilling with rotary.

The status of plugging bond is approved.

Drilling Contractor Greer-Smith Drilling Corp.

315 1/2 W. Main St.

Farmington, New Mexico

We intend to complete this well in the Pictured Cliffs formation

formation at an approximate depth of 3150 feet.

## CASING PROGRAM

We propose to use the following strings of Casing and to cement them as indicated:

Size of Hole	Size of Casing	Weight per Foot	New or Second Hand	Depth	Sacks Cement
12-5/8"	8-5/8"	28#	New	50-150'	To circulate
7-7/8"	5-1/2"	14#	New	2075'	60-150 sacks

If changes in the above plans become advisable we will notify you immediately.

ADDITIONAL INFORMATION (If recompletion give full details of proposed plan of work.)

We will drill through the Pictured Cliffs formation with rotary tools. After electric logging we will set 8 1/2" casing on top of the producing zone. We will shoot the indicated sections using 2 1/2 to 4 qts. of solid nitroglycerin per foot.

Approved \_\_\_\_\_, 19\_\_\_\_

Except as follows:

OIL CONSERVATION COMMISSION

Original signed by  
John J. Abendschan

By \_\_\_\_\_

Title PETROLEUM ENGINEER DIST. NO. 3

Sincerely yours,

W. P. Carr

(Company or Operator)

By \_\_\_\_\_

Operator

Position \_\_\_\_\_

Send Communications regarding well to

Name \_\_\_\_\_

Address \_\_\_\_\_

6700 Forest Lane  
Dallas 30, Texas

Company W.P. Carr

Lease Roberts Well No. 1

Sec. 4, T. 30N, R. 11W

Location 790 feet from south line; 790 feet  
from east line.

Elevation: 5615 GL

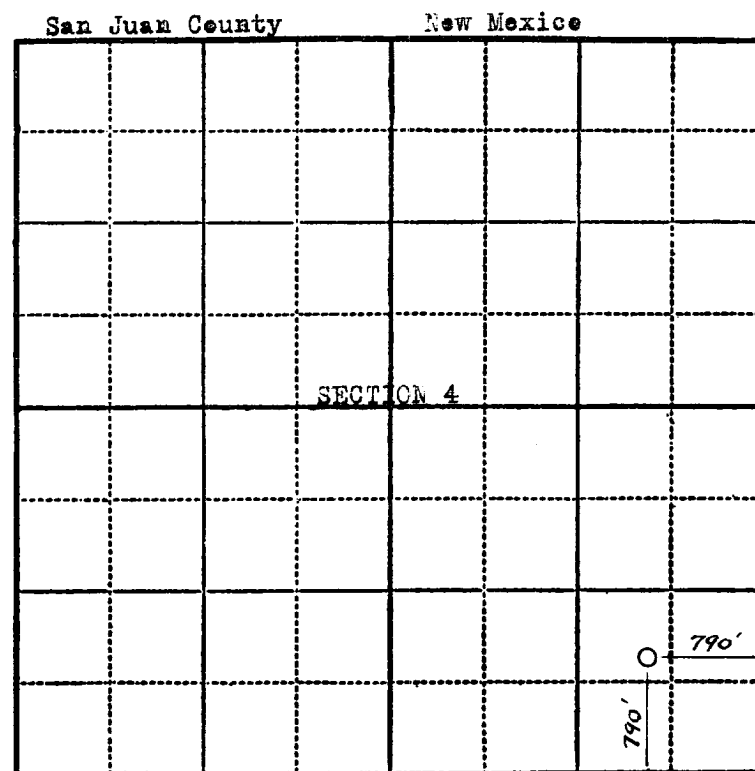

Scale—4 inches equal 1 mile.

This is to certify that the above plat was prepared from field notes of actual surveys made by me or under my supervision and that the same are true and correct to the best of my knowledge and belief.

Stephen H. Kinney

Seal:

Registered Professional  
Engineer and Land Surveyor.



Surveyed April 8, 1954

SE 1/4 SECTION 4

TWP 30 N R 11 W

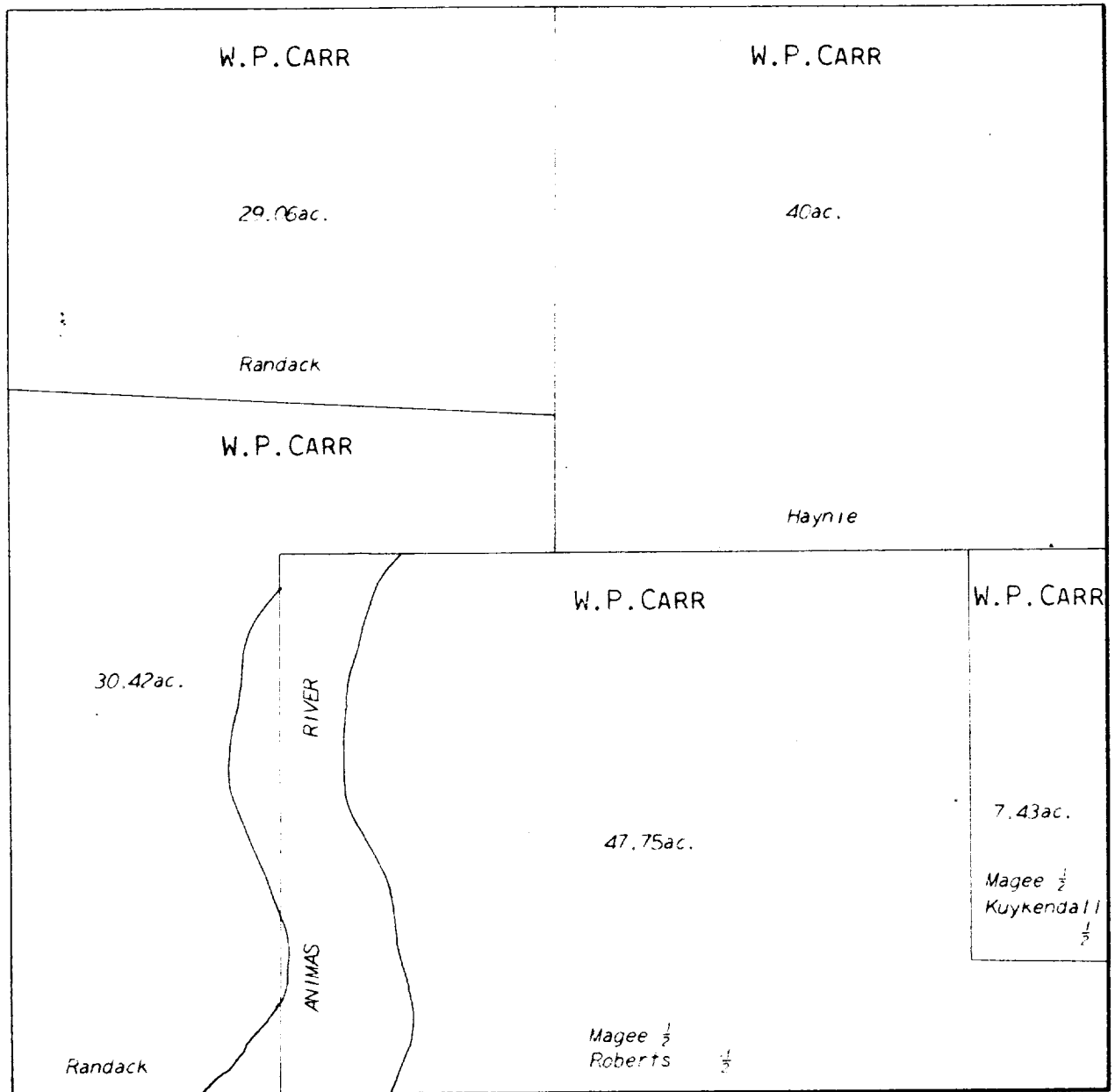

Scale: 1 inch = 400 feet



OIL CONSERVATION COMMISSION  
AZTEC DISTRICT OFFICE

No. Copies Received 5

DISTRIBUTION

	NO. FURNISHED	
Operator	<u>1</u>	
Santa Fe	<u>1</u>	
Exploration Office		
State Land Office		
U. S. G. S.	<u>2</u>	
Transporter		
File	<u>1</u>	<input checked="" type="checkbox"/>