

APPROVED (SUBMIT IN TRIPLICATE)
APR 3 1961
UNITED STATES
DEPARTMENT OF THE INTERIOR
RICHARD B. KRAH
GEOLOGICAL SURVEY
Rudolph C. Baker, Jr.

Indian Agency Navajo
Allottee _____
Lease No. 14-20-603-2021

SUNDRY NOTICES AND REPORTS ON WELLS

NOTICE OF INTENTION TO DRILL	<input checked="" type="checkbox"/>	SUBSEQUENT REPORT OF WATER SHUT-OFF
NOTICE OF INTENTION TO CHANGE PLANS		SUBSEQUENT REPORT OF SHOOTING OR ACIDIZING
NOTICE OF INTENTION TO TEST WATER SHUT-OFF		SUBSEQUENT REPORT OF ALTERING CASING
NOTICE OF INTENTION TO REDRILL OR REPAIR WELL		SUBSEQUENT REPORT OF REDRILLING OR REPAIR
NOTICE OF INTENTION TO SHOOT OR ACIDIZE		SUBSEQUENT REPORT OF ABANDONMENT
NOTICE OF INTENTION TO PULL OR ALTER CASING		SUPPLEMENTARY WELL HISTORY
NOTICE OF INTENTION TO ABANDON WELL		

(INDICATE ABOVE BY CHECK MARK NATURE OF REPORT, NOTICE, OR OTHER DATA)

U. S. GEOLOGICAL SURVEY
WASHINGTON, NEW MEXICO

March 28, 1961

No. 1 Price
Well No. Dayless is located 330 ft. from N line and 2310 ft. from E line of sec. 8

RB 8 30N 17W MAPM
(1/4 Sec. and Sec. No.) (Twp.) (Range) (Meridian)
South Dakota San Juan New Mexico
(Field) (County or Subdivision) (State or Territory)

The elevation of the derrick floor above sea level is 5042 ft.

DETAILS OF WORK

(State names of and expected depths to objective sands; show sizes, weights, and lengths of proposed casings; indicate mudding jobs, cementing points, and all other important proposed work)

Set 30' - 7 7/8" surface pipe w/20 sx cement - drill 6 3/4" hole thru Gallup. If wet will set 5 1/2" casing and drill 4 3/4" to test Dakota



I understand that this plan of work must receive approval in writing by the Geological Survey before operations may be commenced.

Company R. L. Dayless
Address Box 1541
Farmington, N. M.
By R. L. Dayless
Title Partner

100-100000

100-100000

100-100000

100-100000

100-100000

100-100000

100-100000

100-100000

100-100000

100-100000

100-100000

100-100000

100-100000

100-100000

100-100000

100-100000

100-100000

100-100000

100-100000

100-100000

100-100000

100-100000

100-100000

100-100000

100-100000

100-100000

100-100000

100-100000

100-100000

100-100000

100-100000

100-100000

100-100000

100-100000

100-100000

100-100000

100-100000

100-100000

100-100000

100-100000

100-100000

100-100000

100-100000

100-100000

100-100000

100-100000

100-100000

100-100000

100-100000

100-100000

NUMBER OF COPIES RECEIVED	
DISTRIBUTION	
SANTA FE	
W.F.E.	
U.S.G.S.	
LAND OFFICE	
TRANSPORTER	OIL GAS
PRODUCTION OFFICE	
OPERATOR	

NEW MEXICO OIL CONSERVATION COMMISSION
WELL LOCATION AND ACREAGE DEDICATION PLAT
 SEE INSTRUCTIONS FOR COMPLETING THIS FORM ON THE REVERSE SIDE

FORM C-128
 Revised 5/1/57

SECTION A

Operator R. L. BAYLESS			Lease Wavajo Tribal 14-20-603-2031		Well No. #1 Fries Bayless
Unit Letter B	Section 8	Township 30 NORTH	Range 17 WEST	County SAN JUAN	
Actual Footage Location of Well: 330 feet from the NORTH line and 2310 feet from the EAST line					
Ground Level Elev. 5041.8	Producing Formation	Pool Salt Creek Salt Creek		Dedicated Acreage: 4000 Acres	

1. Is the Operator the only owner in the dedicated acreage outlined on the plat below? YES ☒ NO ____ . ("Owner" means the person who has the right to drill into and to produce from any pool and to appropriate the production either for himself or for himself and another. (65-3-29 (e) NMSA 1935 Comp.)
2. If the answer to question one is "no," have the interests of all the owners been consolidated by communitization agreement or otherwise? YES ____ NO ____ . If answer is "yes," Type of Consolidation ____
3. If the answer to question two is "no," list all the owners and their respective interests below:

Owner	Land Description

SECTION B

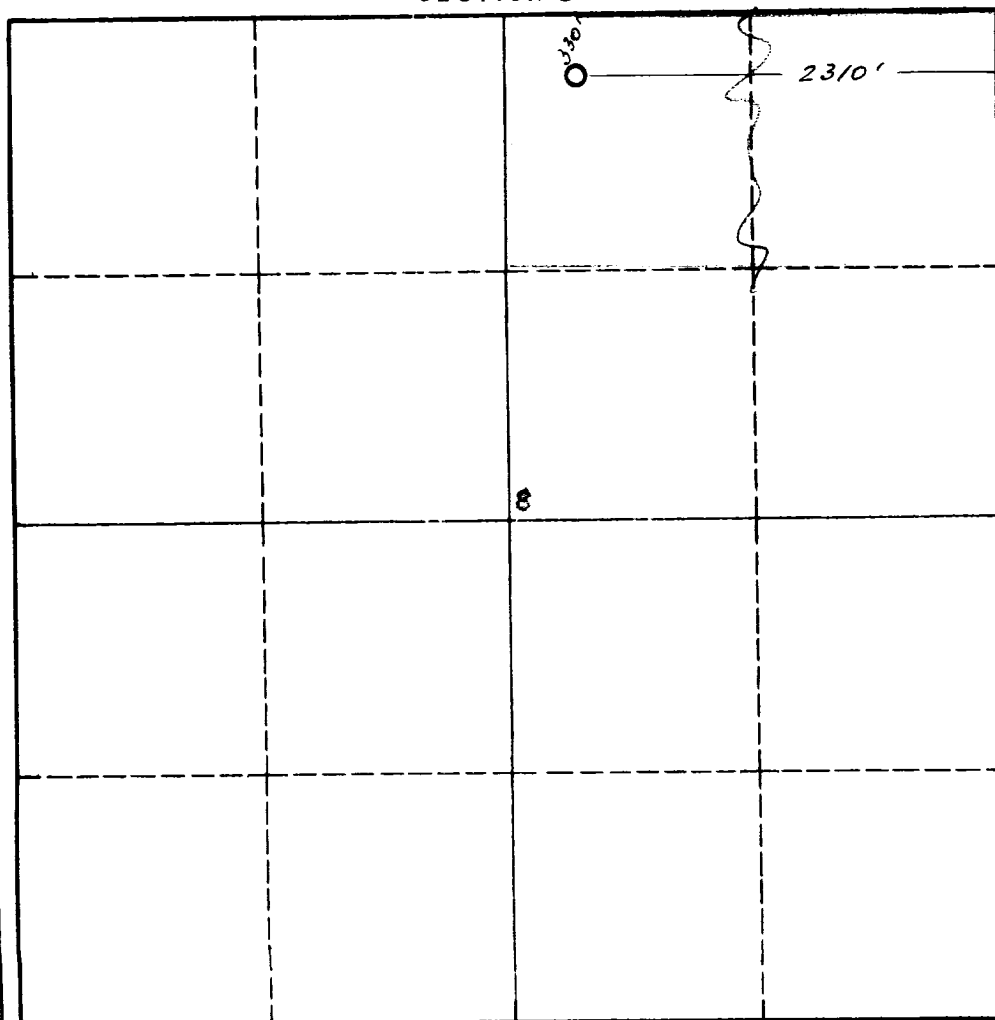

CERTIFICATION

I hereby certify that the information in SECTION A above is true and complete to the best of my knowledge and belief.

R. L. Bayless

Name	R. L. Bayless
Position	Operator
Company	Bayless
Date	April 1, 1961

I hereby certify that the well location shown on the plat in SECTION B was plotted from field notes of actual surveys made by me or under my supervision, and that the same is true and correct to the best of my knowledge and belief.

Date Surveyed	27 March 1961
Registered Professional Engineer and/or Land Surveyor	James P. Loese
Certificate No.	1463

0 330 660 990 1320 1650 1980 2310 2640 2000 1500 1000 500 0

INSTRUCTIONS FOR COMPLETION OF FORM C-128

1. Operator shall furnish and certify to the information called for in Section A.
2. Operator shall outline the dedicated acreage for *both* oil and gas wells on the plat in Section B.
3. A registered professional engineer or land surveyor registered in the State of New Mexico or approved by the Commission shall show on the plat the location of the well and certify this information in the space provided.
4. All distances shown on the plat must be from the outer boundaries of the Section.
5. If additional space is needed for listing owners and their respective interests as required in question 3 of Section A, please use space below.