

Company W.P.Carr

Lease Bandy Well No. 1

Sec. 3, T. 30N, R. 11W

Location 1196 feet from south line; 1992 feet from west line.

Elevation: 5682.6 GL

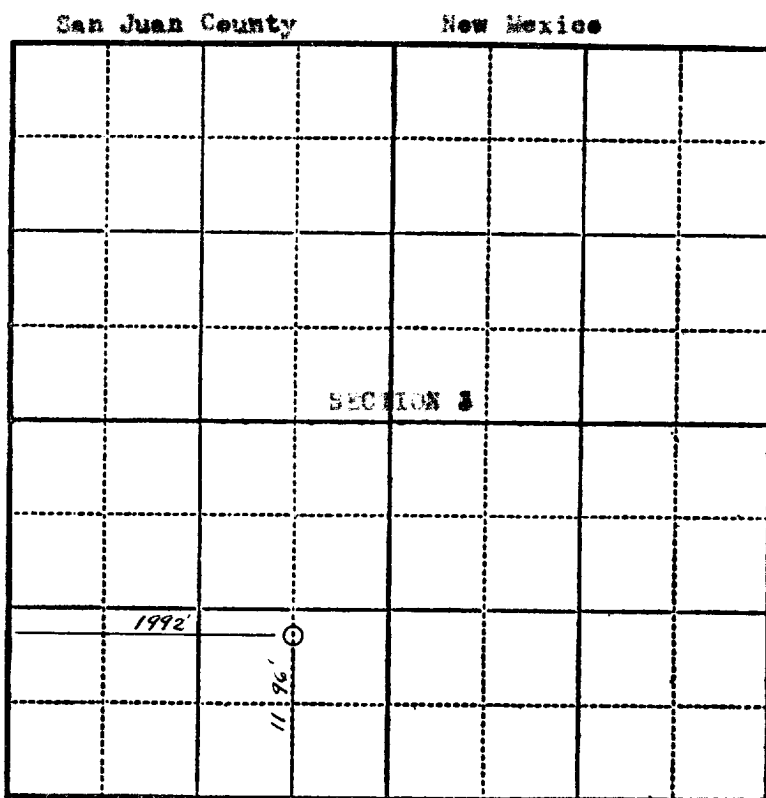

Scale—4 inches equal 1 mile.

This is to certify that the above plat was prepared from field notes of actual surveys made by me or under my supervision and that the same are true and correct to the best of my knowledge and belief.

Stephen H. Kinney

Seal:

Registered Professional
Engineer and Land Surveyor.

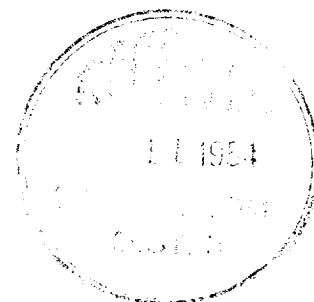

Surveyed April 6, 1954