

NUMBER OF COPIES RECEIVED	
DISTRIBUTION	
SANTA FE	
FILE	
U.S.G.S.	
LAND OFFICE	
TRANSPORTER	OIL GAS
PRODUCTION OFFICE	
OPERATOR	

NEW MEXICO OIL CONSERVATION COMMISSION
Santa Fe, New Mexico

Form C-101
Revised (12/1/55)

NOTICE OF INTENTION TO DRILL

Notice must be given to the District Office of the Oil Conservation Commission and approval obtained before drilling or recompletion begins. If changes in the proposed plan are considered advisable, a copy of this notice showing such changes will be returned to the sender. Submit this notice in QUINTUPLICATE. One copy will be returned following approval. See additional instructions in Rules and Regulations of the Commission. If State Land submit 6 Copies Attach Form C- 128 in triplicate to first 3 copies of form C-101

CONSOLIDATED OIL & GAS, INC.
(Please)

June 27, 1961
(Date)

OIL CONSERVATION COMMISSION
SANTA FE, NEW MEXICO

Gentlemen:

You are hereby notified that it is our intention to commence the Drilling of a well to be known as

CONSOLIDATED OIL & GAS INC.

(Company, or Operator)

Clayton

(Lease)

Well No. **1-2**, in **N** (Unit) The well is

located **990'** feet from the **South** line and **1850'** feet from the **West** line of Section **2**, T. **30N**, R. **12W**, NMPM.

(GIVE LOCATION FROM SECTION LINE) **Basin Dakota** Pool, **San Juan** County

If State Land the Oil and Gas Lease is No.

If patented land the owner is

Jake Brown

Address

Durango, Colorado

We propose to drill well with drilling equipment as follows:

The status of plugging bond is

Permanent

Drilling Contractor

Huron Drilling Co., Inc.

We intend to complete this well in the

Dakota

formation at an approximate depth of

7100'

feet.

CASING PROGRAM

We propose to use the following strings of Casing and to cement them as indicated:

Size of Hole	Size of Casing	Weight per Foot	New or Second Hand	Depth	Sacks Cement
15"	10 3/4	40#	Second Hand	200'	150
8 3/4	5 1/2	15 1/2#	New	7100'	See Below

If changes in the above plans become advisable we will notify you immediately.

ADDITIONAL INFORMATION (If recompletion give full details of proposed plan of work.)

- 1. Dakota - 250 sx.**
- 2. MV - 250 sx. (Stage Collar)**
- 3. PC - 200 sx. (Stage Collar)**

Approved 6-29, 1961
Except as follows:

Sincerely yours,

CONSOLIDATED OIL & GAS, INC.

By

Position

Division Manager

Send Communications regarding well to

Name

Suite 2112 Tower Bldg.

Address

Denver 2, Colorado

OIL CONSERVATION COMMISSION

By

Eunice C. Ames

NUMBER OF COPIES RECEIVED	
DISTRIBUTION	
SANTA FE	
FILE	
U.S.G.S.	
LAND OFFICE	
TRANSPORTER	OIL GAS
PRORATION OFFICE	
OPERATOR	

NEW MEXICO OIL CONSERVATION COMMISSION
WELL LOCATION AND ACREAGE DEDICATION PLAT
 SEE INSTRUCTIONS FOR COMPLETING THIS FORM ON THE REVERSE SIDE

FORM C-128
 Revised 5/1/57

SECTION A

Operator CONSOLIDATED OIL AND GAS, INC.		Lease Clayton		Well No. 1-2
Unit Letter N	Section 2	Township 30 NORTH	Range 12 WEST	County SAN JUAN
Actual Footage Location of Well: 990 feet from the SOUTH line and 1850 feet from the WEST line				
Ground Level Elev. 5769.0	Producing Formation Mesaverde & Dakota	Pool Blanco MV & Basin Dakota	Dedicated Acreage: 320 Acres	

Ref: GLO plat dated 7 April 1961

1. Is the Operator the only owner in the dedicated acreage outlined on the plat below? YES ☒ NO ____ . ("Owner" means the person who has the right to drill into and to produce from any pool and to appropriate the production either for himself or for himself and another. (65-3-29 (e) NMSA 1935 Comp.)
2. If the answer to question one is "no," have the interests of all the owners been consolidated by communitization agreement or otherwise? YES ____ NO ____ . If answer is "yes," Type of Consolidation ____
3. If the answer to question two is "no," list all the owners and their respective interests below:

Owner	Land Description

RECEIVED

JUL 5 1961

**OIL CON. COM.
 DIST. 3
 CERTIFICATION**

SECTION B

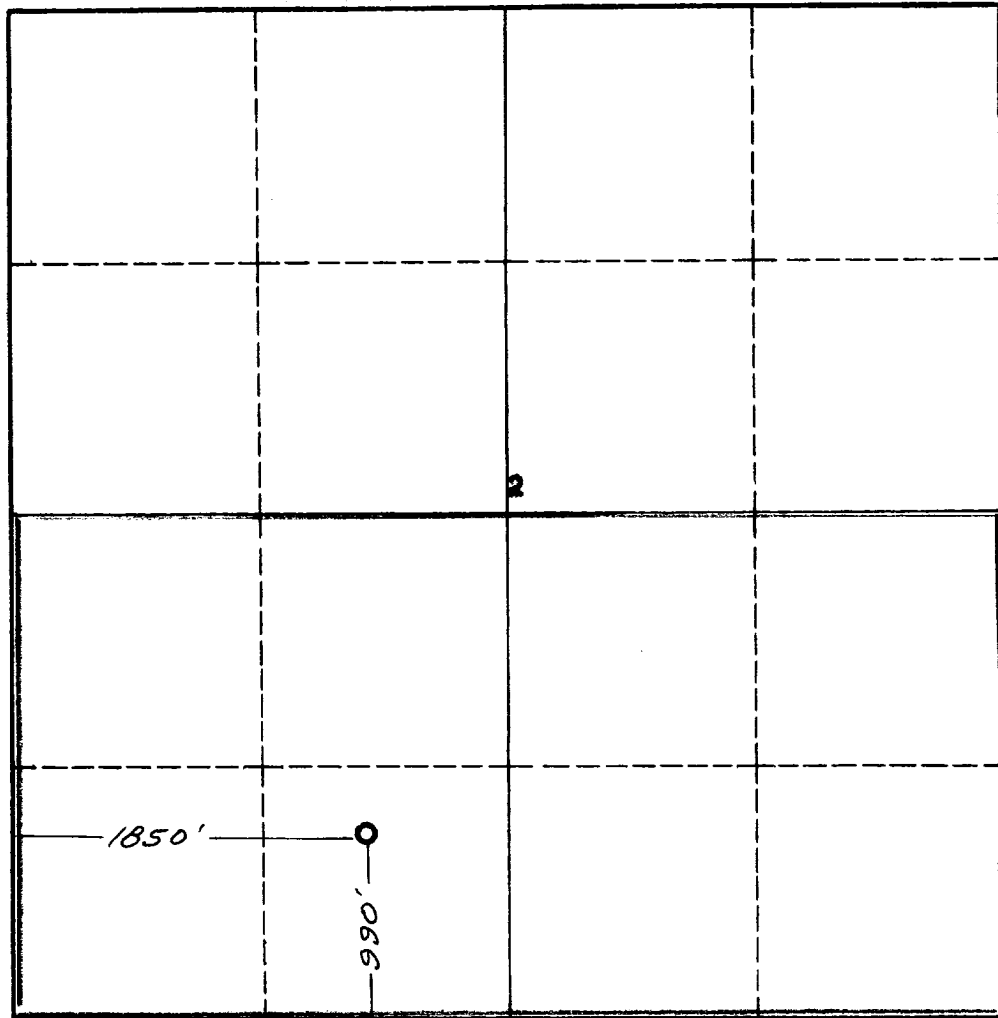

I hereby certify that the information in SECTION A above is true and complete to the best of my knowledge and belief.

Name <i>[Signature]</i>
Position Vice President
Company Consolidated Oil & Gas, Inc.
Date 6/26/61

I hereby certify that the well location shown on the plat in SECTION B was plotted from field notes of actual surveys made by me or under my supervision, and that the same is true and correct to the best of my knowledge and belief.

Date Surveyed 25 June 1961
Registered Professional Engineer and/or Land Surveyor <i>[Signature]</i> James P. Leese 1463
Certificate No. San Juan Engineering Company



INSTRUCTIONS FOR COMPLETION OF FORM C-128

1. Operator shall furnish and certify to the information called for in Section A.
2. Operator shall outline the dedicated acreage for *both* oil and gas wells on the plat in Section B.
3. A registered professional engineer or land surveyor registered in the State of New Mexico or approved by the Commission shall show on the plat the location of the well and certify this information in the space provided.
4. All distances shown on the plat must be from the outer boundaries of the Section.
5. If additional space is needed for listing owners and their respective interests as required in question 3 of Section A, please use space below.