

UNITED STATES  
DEPARTMENT OF THE INTERIOR  
GEOLOGICAL SURVEY

APPLICATION FOR PERMIT TO DRILL, DEEPEN, OR PLUG BACK

1a. TYPE OF WORK  
 DRILL       DEEPEN       PLUG BACK

b. TYPE OF WELL  
 OIL WELL       GAS WELL       OTHER       SINGLE ZONE       MULTIPLE ZONE

2. NAME OF OPERATOR  
**PAN AMERICAN PETROLEUM CORPORATION**

3. ADDRESS OF OPERATOR  
**P. O. Box 480, Farmington, New Mexico**

4. LOCATION OF WELL (Report location clearly and in accordance with any State requirements.)\*  
**975 FWL and 1095 FSL Section 3, T-30N, R-12W**  
 At proposed prod. zone  
**Same**

5. LEASE DESIGNATION AND SERIAL NO.  
**SF 081239**

6. IF INDIAN, ALLOTTEE OR TRIBE NAME

7. UNIT AGREEMENT NAME

8. FARM OR LEASE NAME  
**L. C. Kelly**

9. WELL NO.  
**4**

10. FIELD AND POOL, OR WILDCAT  
**Basin Dakota**

11. SEC., T., R., M., OR BLK. AND SURVEY OR AREA  
**SW/4 SW/4 Section 3 T-30N, R-12W**

12. COUNTY OR PARISH  
**San Juan**

13. STATE  
**New Mexico**

14. DISTANCE IN MILES AND DIRECTION FROM NEAREST TOWN OR POST OFFICE\*  
**3 miles North of Flora Vista, New Mexico**

15. DISTANCE FROM PROPOSED\* LOCATION TO NEAREST PROPERTY OR LEASE LINE, FT. (Also to nearest drlg. unit line, if any)  
**975**

16. NO. OF ACRES IN LEASE  
**2522.59**

17. NO. OF ACRES ASSIGNED TO THIS WELL  
**320**

18. DISTANCE FROM PROPOSED LOCATION\* TO NEAREST WELL, DRILLING, COMPLETED, OR APPLIED FOR, ON THIS LEASE, FT.  
**6000'**

19. PROPOSED DEPTH  
**6800**

20. ROTARY OR CABLE TOOLS  
**Rotary**

21. ELEVATIONS (Show whether DF, RT, GR, etc.)  
**To Be Reported Later**

22. APPROX. DATE WORK WILL START\*  
**July 2, 1964**

23. PROPOSED CASING AND CEMENTING PROGRAM

SIZE OF HOLE	SIZE OF CASING	WEIGHT PER FOOT	SETTING DEPTH	QUANTITY OF CEMENT
12-1/4"	8-5/8"	24#	350'	250 Sacks
7-7/8"	4-1/2"	105#	6800'	1600 Sacks *

\* Cemented by two stage method with stage tool set 100' below base of case hole.

Copies of location plat are attached.  
 Copies of any logs run will be furnished upon completion of well.  
 Stimulation will be as indicated upon reaching total depth.

Verbal approval received June 25, 1964 Krahl to Hollingsworth.

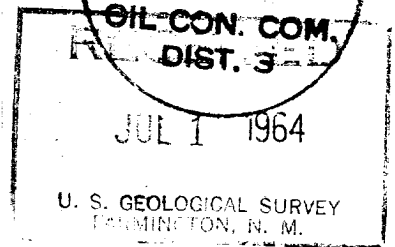
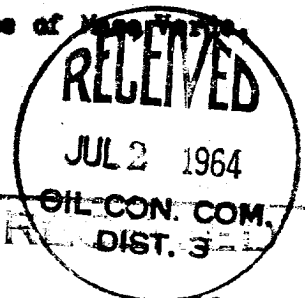

IN ABOVE SPACE DESCRIBE PROPOSED PROGRAM: If proposal is to deepen or plug back, give data on present productive zone and proposed new productive zone. If proposal is to drill or deepen directionally, give pertinent data on subsurface locations and measured and true vertical depths. Give blowout preventer program, if any.

24. **Fred L. Nabors, District Engineer**

SIGNED F. H. HOLLINGSWORTH TITLE \_\_\_\_\_ DATE **June 30, 1964**

(This space for Federal or State office use)

PERMIT NO. \_\_\_\_\_ APPROVAL DATE \_\_\_\_\_

APPROVED BY [Signature] TITLE \_\_\_\_\_ DATE \_\_\_\_\_

CONDITIONS OF APPROVAL, IF ANY:

## Instructions

**General:** This form is designed for submitting proposals to perform certain well operations, as indicated, on all types of lands and leases for appropriate action by either a Federal or a State agency, or both, pursuant to applicable Federal and/or State laws and regulations. Any necessary special instructions concerning the use of this form and the number of copies to be submitted, particularly with regard to local, area, or regional procedures and practices, either are shown below or will be issued by, or may be obtained from, the local Federal and/or State office.

**Item 1:** If the proposal is to redrill to the same reservoir at a different subsurface location or to a new reservoir, use this form with appropriate notations. Consult applicable State or Federal regulations concerning subsequent work proposals or reports on the well.

**Item 4:** If there are no applicable State requirements, locations on Federal or Indian land should be described in accordance with Federal requirements. Consult local State or Federal office for specific instructions.

**Item 14:** Needed only when location of well cannot readily be found by road from the land or lease description. A plat, or plats, separate or on this reverse side, showing the roads to, and the surveyed location of, the well, and any other required information, should be furnished when required by Federal or State agency offices.

**Items 15 and 18:** If well is to be, or has been directionally drilled, give distances for subsurface location of hole in any present or objective production zone.

**Item 22:** Consult applicable Federal or State regulations, or appropriate officials, concerning approval of the proposal before operations are started.

Well Location and Acreage Dedication Plat

Section A.

Date June 25, 1964

Operator PAN AMERICAN PETROLEUM CORPORATION Leasee L. C. KELLY  
 Well No. 4 Unit Letter M Section 3 Township 30 NORTH Range 12 WEST NMPM  
 Located 1095 Feet From the SOUTH Line 975 Feet From the WEST Line  
 County SAN JUAN G. L. Elevation REPORT LATER Dedicated Acres 320.21 Acres  
 Name of Producing Formation DAKOTA Pool BASIN DAKOTA

1. Is the Operator the only owner in the dedicated acreage outlined on the plat below?  
 Yes  No
2. If the answer to question one is "no", have the interests of all the owners been consolidated by communitization agreement or otherwise? Yes  No  If answer is "yes", Type of Consolidation.
3. If the answer to question two is "no", list all the owners and their respective interests below:

Owner \_\_\_\_\_ Land Description \_\_\_\_\_

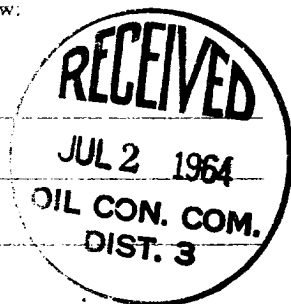

Section B.

Note: All distances must be from outer boundaries of section.

This is to certify that the information in Section A above is true and complete to the best of my knowledge and belief.

PAN AMERICAN PETROLEUM CORP.  
*F. H. Hollingsworth*  
F. H. Hollingsworth  
 (Representative)  
P. O. Box 480  
 (Address)  
Farmington, New Mexico

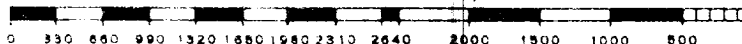
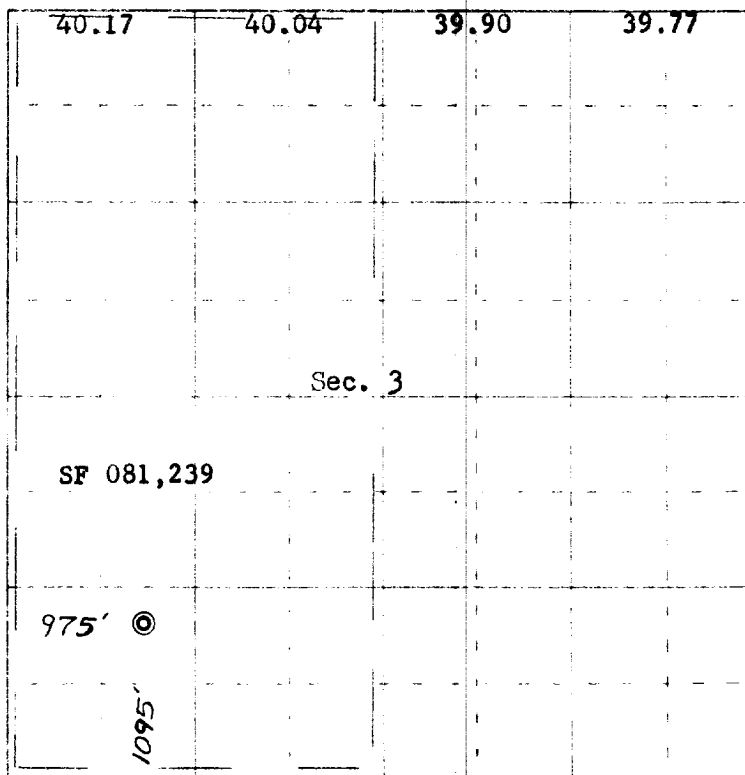

Scale 4 inches equal 1 mile

Ref: GLO plat dated 7 April 1881

This is to certify that the above plat was prepared from field notes of actual surveys made by me or under my supervision and that the same are true and correct to the best of my knowledge and belief.

Date Surveyed June 23, 1964

*James P. Leese*  
 Registered Professional Engineer and/or Land Surveyor  
 James P. Leese, N. Mex. Reg. No. 1463

