

X			

(SUBMIT IN TRIPLICATE)

UNITED STATES
DEPARTMENT OF THE INTERIOR
GEOLOGICAL SURVEY

Land Office **SF**
Lease No. **081226**
Unit **Horseshoe Canyon**

SUNDRY NOTICES AND REPORTS ON WELLS

NOTICE OF INTENTION TO DRILL	X	SUBSEQUENT REPORT OF WATER SHUT-OFF
NOTICE OF INTENTION TO CHANGE PLANS		SUBSEQUENT REPORT OF SHOOTING OR ACIDIZING
NOTICE OF INTENTION TO TEST WATER SHUT-OFF		SUBSEQUENT REPORT OF ALTERING CASING
NOTICE OF INTENTION TO RE-DRILL OR REPAIR WELL		SUBSEQUENT REPORT OF RE-DRILLING OR REPAIR
NOTICE OF INTENTION TO SHOOT OR ACIDIZE		SUBSEQUENT REPORT OF ABANDONMENT
NOTICE OF INTENTION TO PULL OR ALTER CASING		SUPPLEMENTARY WELL HISTORY
NOTICE OF INTENTION TO ABANDON WELL		

(INDICATE ABOVE BY CHECK MARK NATURE OF REPORT, NOTICE, OR OTHER DATA)

ORAL APPROVAL OBTAINED 12-29-58.

December 29 19 58

Well No. 13 is located 660 ft. from N line and 3300 ft. from E line of sec. 4

SE SW/4 Sec. 4 30N 16W NMPM
(1/4 Sec. and Sec. No.) (Twp.) (Range) (Meridian)

Horseshoe Gallup San Juan New Mexico
(Field) (County or Subdivision) (State or Territory)

The elevation of the derrick floor above sea level is 5334 ft.

DETAILS OF WORK

(State names of and expected depths to objective sands; show sizes, weights, and lengths of proposed casings; indicate mudding jobs, cementing points, and all other important proposed work)

It is intended to drill a well through the Lower Gallup Formation using rotary tools and mud circulation. Possible productive intervals will be perforated and sandoil fractured. Estimated Total Depth 1220'.

Casing Program:

8-5/8" at 100' with 100 sacks cement circulated to surface.

5-1/2" at 1220' with 100 sacks cement.

The SE/4 SW/4 of Section 4 is dedicated to this well.

SE /4 SW/4 Section 4 SF-081226

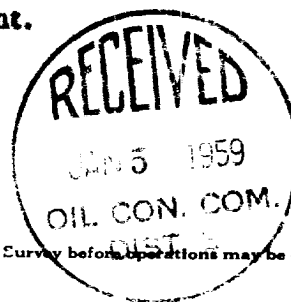

I understand that this plan of work must receive approval in writing by the Geological Survey before operations may be commenced.

Company El Paso Natural Gas Products Company

Address Post Office Box 1565
Farmington, New Mexico

ORIGINAL SIGNED BY: JOSEPH E. KREGER

By _____
Title **Petroleum Engineer**

1. The first part of the document discusses the importance of maintaining accurate records of all transactions and activities. It emphasizes the need for transparency and accountability in financial reporting.

2. The second part of the document outlines the various methods and techniques used to collect and analyze data. It includes a detailed description of the experimental procedures and the statistical analysis performed.

3. The third part of the document presents the results of the study. It includes a series of tables and graphs that illustrate the findings of the research. The data shows a clear trend of increasing activity over time.

4. The fourth part of the document discusses the implications of the findings. It suggests that the results have significant implications for the field of study and may lead to further research in this area.

5. The fifth part of the document provides a conclusion and summarizes the key points of the study. It reiterates the importance of accurate record-keeping and the need for ongoing research in this field.

6. The sixth part of the document includes a list of references and a bibliography. It cites various sources that have been consulted during the research process.

7. The seventh part of the document contains a list of appendices and supplementary materials. These include additional data, charts, and documents that provide further detail on the study.

8. The eighth part of the document includes a list of figures and tables. These are numbered and labeled to correspond with the text and provide a visual representation of the data.

9. The ninth part of the document contains a list of footnotes and endnotes. These provide additional information and clarification on specific points mentioned in the text.

10. The tenth part of the document includes a list of acknowledgments and a thank you note. It expresses appreciation to the individuals and organizations that have supported the research.

NEW MEXICO OIL CONSERVATION COMMISSION

Well Location and Acreage Dedication Plat

Section A.

Date **December 29, 1958**

Operator **EL PASO NATURAL GAS PRODUCTS COMPANY** Lease **HORSESHOE CANYON** **SF-081226**
 Well No. **13** Unit Letter **N** Section **4** Township **30 NORTH** Range **16 WEST** NMPM
 Located **660** Feet From **the SOUTH** Line **3300** Feet From **the EAST** Line
 County **SAN JUAN** G. L. Elevation **5326.0** Dedicated Acreage **40** Acres
 Name of Producing Formation **Gallup** Pool **Horseshoe Gallup**

1. Is the Operator the only owner in the dedicated acreage outlined on the plat below?
 Yes **X** No
2. If the answer to question one is "no", have the interests of all the owners been consolidated by communitization agreement or otherwise? Yes No If answer is "yes", Type of Consolidation.

3. If the answer to question two is "no", list all the owners and their respective interests below:

Owner

Land Description



RECEIVED

Section B.

Note: All distances must be from outer boundaries of section.

This is to certify that the information in Section A above is true and complete to the best of my knowledge and belief.

El Paso Natural Gas Products Co.

(Operator)

ORIGINAL SIGNED BY: JOSEPH E. KREGER

(Representative)

Post Office Box 1565

(Address)

Farmington, New Mexico

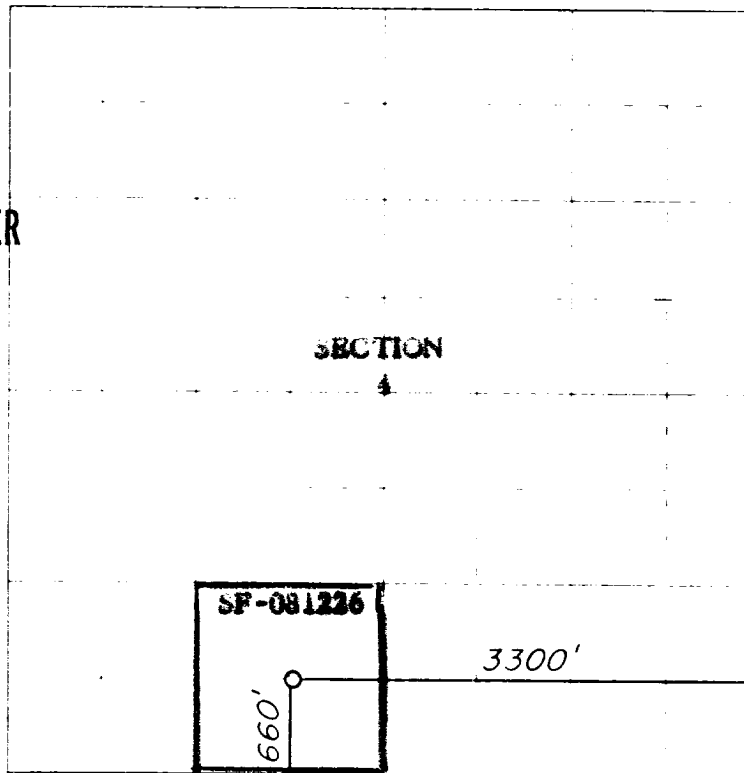

0 330 660 990 1320 1650 1980 2310 2640 2970 3300 3630 3960 4290 4620 4950 5280 5610 5940 6270 6600

Scale 4 inches equal 1 mile

This is to certify that the above plat was prepared from field notes of actual surveys made by me or under my supervision and that the same are true and correct to the best of my knowledge and belief.

(Seal)



Farmington, New Mexico

Date Surveyed **23 DECEMBER 1958**

James P. Lerea
 Registered Professional Engineer and/or Land Surveyor
 JAMES P. LEREA NEW MEXICO REG. NO. 2172