

(SUBMIT IN TRIPLICATE)

UNITED STATES
DEPARTMENT OF THE INTERIOR
GEOLOGICAL SURVEY

Indian Agency Navajo

Allottee Marathon Canyon

Lease No. 2-22-50-733

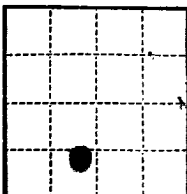

SUNDRY NOTICES AND REPORTS ON WELLS

NOTICE OF INTENTION TO DRILL	<input checked="" type="checkbox"/>	SUBSEQUENT REPORT OF WATER SHUT-OFF	
NOTICE OF INTENTION TO CHANGE PLANS		SUBSEQUENT REPORT OF SHOOTING OR ACIDIZING	
NOTICE OF INTENTION TO TEST WATER SHUT-OFF		SUBSEQUENT REPORT OF ALTERING CASING	
NOTICE OF INTENTION TO REDRILL OR REPAIR WELL		SUBSEQUENT REPORT OF REDRILLING OR REPAIR	
NOTICE OF INTENTION TO SHOOT OR ACIDIZE		SUBSEQUENT REPORT OF ABANDONMENT	
NOTICE OF INTENTION TO PULL OR ALTER CASING		SUPPLEMENTARY WELL HISTORY	
NOTICE OF INTENTION TO ABANDON WELL			

(INDICATE ABOVE BY CHECK MARK NATURE OF REPORT, NOTICE, OR OTHER DATA)

June 18, 1952

Well No. 7 is located 990 ft. from S line and 2310 ft. from W line of sec. 5
SW 1/4 5 30N 16W N.M.P.M.
 (1/4 Sec. and Sec. No.) (Twp.) (Range) (Meridian)
Marathon Canyon Sag. Juan New Mexico
 (Field) (County or Subdivision) (State or Territory)

The elevation of the derrick floor above sea level is 5307 ft. Ungraded

DETAILS OF WORK

(State names of and expected depths to objective sands; show sizes, weights, and lengths of proposed casings; indicate mudlogging jobs, cementing points, and all other important proposed work)

Objective Horizon: Lower Gallup at 1300'
 Surface String: 8 5/8" 24' at approximately 80'
 Oil String: 5 1/2" at T.B.
 Cementing Intervals: 0' to 80', Estimate 600' to T.B.



I understand that this plan of work must receive approval in writing by the Geological Survey before operations are commenced.

Company Petro-Atlas, Inc.

Address 789 East Main St.

Farmington, New Mexico

By Louis Kramer

Title Superintendent

STANDARD NATIONAL

STANDARD NATIONAL

STANDARD NATIONAL

STANDARD NATIONAL

STANDARD NATIONAL

STANDARD NATIONAL

STANDARD NATIONAL

STANDARD NATIONAL

STANDARD NATIONAL

STANDARD NATIONAL

STANDARD NATIONAL

STANDARD NATIONAL

STANDARD NATIONAL

STANDARD NATIONAL

STANDARD NATIONAL

STANDARD NATIONAL

STANDARD NATIONAL

STANDARD NATIONAL

STANDARD NATIONAL

STANDARD NATIONAL

STANDARD NATIONAL

NEW MEXICO OIL CONSERVATION COMMISSION
WELL LOCATION AND ACREAGE DEDICATION PLAT

FORM C-128
Revised 5/1/57

SEE INSTRUCTIONS FOR COMPLETING THIS FORM ON THE REVERSE SIDE

SECTION A

Operator PETRO ATLAS, INC.		Lease Horseehoe Canyon "D"		Well No. 7
Unit Letter N	Section 5	Township 30 NORTH	Range 6 WEST	County SAN JUAN
Actual Footage Location of Well: 990 feet from the SOUTH line and 2310 feet from the WEST line				
Ground Level Elev. 5307.0	Producing Formation Gallup	Pool Horseehoe Gallup	Dedicated Acreage: 40 Acres	

1. Is the Operator the only owner in the dedicated acreage outlined on the plat below? YES _____ NO _____. ("Owner" means the person who has the right to drill into and to produce from any pool and to appropriate the production either for himself or for himself and another. (65-3-29 (e) NMSA 1935 Comp.)
2. If the answer to question one is "no," have the interests of all the owners been consolidated by communization agreement or otherwise? YES _____ NO _____. If answer is "yes," Type of Consolidation _____
3. If the answer to question two is "no," list all the owners and their respective interests below:

Owner	Land Description

SECTION B

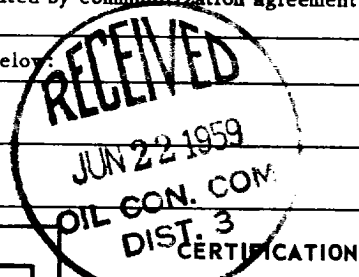
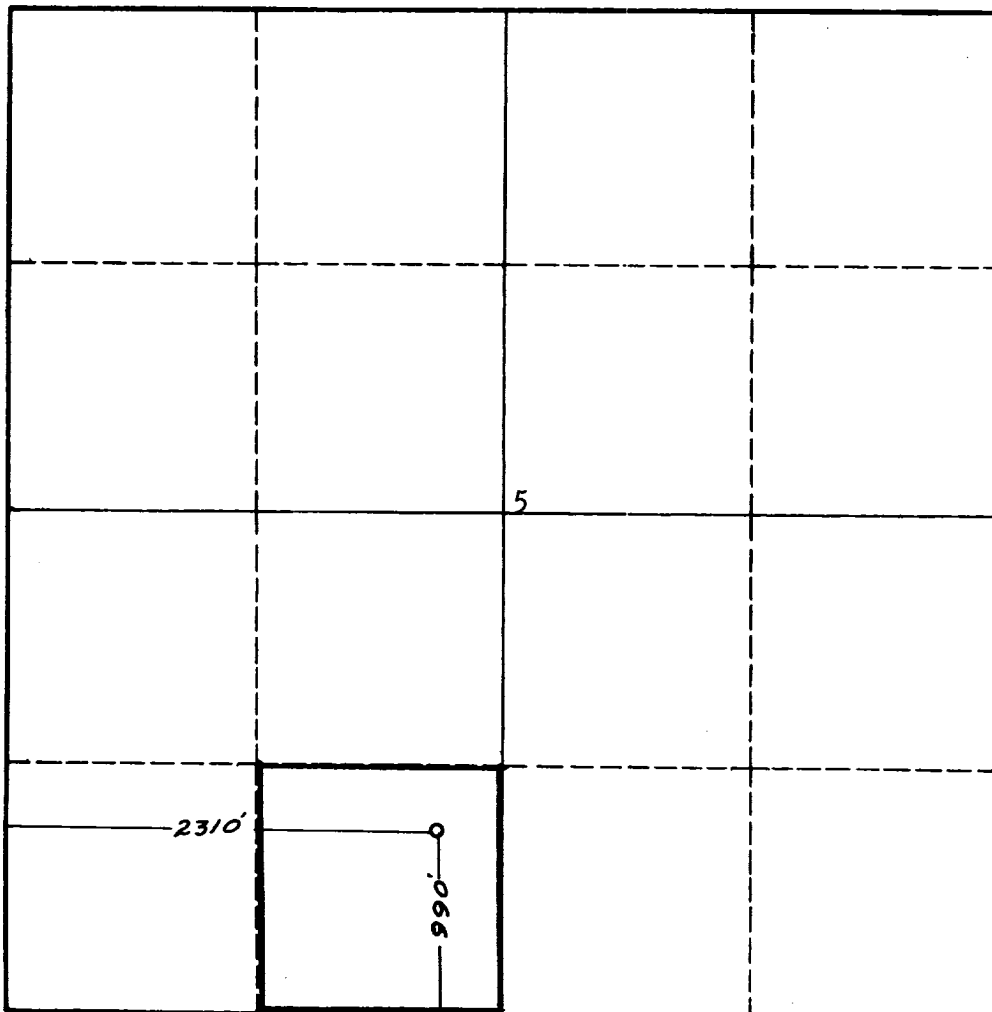

I hereby certify that the information in SECTION A above is true and complete to the best of my knowledge and belief.

Name Lennie Dyer
Position Superintendent
Company Petro-Atlas, Inc.
Date 6-18-59

I hereby certify that the well location shown on the plat in SECTION B was plotted from field notes of actual surveys made by me or under my supervision, and that the same is true and correct to the best of my knowledge and belief.

Date Surveyed 17 June 1959
Registered Professional Engineer and/or Land Surveyor James P. Lease
Certificate No. 1463

0 330 660 990 1320 1650 1980 2310 2640 2000 1500 1000 500 0

INSTRUCTIONS FOR COMPLETION OF FORM C-128

1. Operator shall furnish and certify to the information called for in Section A.
2. Operator shall outline the dedicated acreage for *both* oil and gas wells on the plat in Section B.
3. A registered professional engineer or land surveyor registered in the State of New Mexico or approved by the Commission shall show on the plat the location of the well and certify this information in the space provided.
4. All distances shown on the plat must be from the outer boundaries of the Section.
5. If additional space is needed for listing owners and their respective interests as required in question 3 of Section A, please use space below.