

District I
P.O. Box 1980, Hobbs, NM

State of New Mexico
Energy, Minerals and Natural Resources Department

OK
SUBMIT 1 COPY TO
APPROPRIATE
DISTRICT OFFICE
AND 1 COPY TO
SANTA FE OFFICE

District II
P.O. Drawer DD, Artesia, NM 88221

OIL CONSERVATION DIVISION

District III
1000 Rio Brazos Rd, Aztec, NM 87410

2040 South Pacheco Street
Santa Fe, New Mexico 87505

PIT REMEDIATION AND CLOSURE REPORT

Operator: <u>PNM Gas Services (Burlington)</u> Telephone: <u>324-3764</u>													
Address: <u>603 W. Elm Street Farmington, NM 87401</u>													
Facility or Well Name: <u>Reid A #2</u>													
Location:	Unit <u> L </u> Sec <u> 1 </u> T <u> 30 N </u> R <u> 13 W </u> County <u> San Juan </u>												
Pit Type:	Separator <input type="checkbox"/> Dehydrator <input checked="" type="checkbox"/> Other _____												
Land Type:	BLM <input type="checkbox"/> State <input type="checkbox"/> Fee <input checked="" type="checkbox"/> Other _____												
Pit Location:	Pit dimensions: length <u> 15 ' </u> width <u> 15 ' </u> depth <u> 3 ' </u>												
(Attach diagram)	Reference: wellhead <input checked="" type="checkbox"/> other _____												
	Footage from reference: <u> 69' </u>												
	Direction from reference: <u> 82 </u> Degrees <input type="checkbox"/> East North <input checked="" type="checkbox"/>												
	of												
	<input checked="" type="checkbox"/> West South <input type="checkbox"/>												
Depth to Ground Water:	<table style="width:100%; border: none;"> <tr> <td style="width:50%;"></td> <td style="width:30%;">Less than 50 feet</td> <td style="width:20%; text-align: right;">(20 points)</td> </tr> <tr> <td></td> <td>50 feet to 99 feet</td> <td style="text-align: right;">(10 points)</td> </tr> <tr> <td></td> <td>Greater than 100 feet</td> <td style="text-align: right;">(0 points)</td> </tr> <tr> <td style="border-top: 1px solid black;"></td> <td></td> <td style="text-align: right; border-top: 1px solid black;"><u> 0 </u></td> </tr> </table>		Less than 50 feet	(20 points)		50 feet to 99 feet	(10 points)		Greater than 100 feet	(0 points)			<u> 0 </u>
	Less than 50 feet	(20 points)											
	50 feet to 99 feet	(10 points)											
	Greater than 100 feet	(0 points)											
		<u> 0 </u>											
Wellhead Protection Area:	<table style="width:100%; border: none;"> <tr> <td style="width:50%;"></td> <td style="width:30%;">Yes</td> <td style="width:20%; text-align: right;">(20 points)</td> </tr> <tr> <td></td> <td>No</td> <td style="text-align: right;">(0 points)</td> </tr> <tr> <td style="border-top: 1px solid black;"></td> <td></td> <td style="text-align: right; border-top: 1px solid black;"><u> 0 </u></td> </tr> </table>		Yes	(20 points)		No	(0 points)			<u> 0 </u>			
	Yes	(20 points)											
	No	(0 points)											
		<u> 0 </u>											
Distance to Surface Water:	<table style="width:100%; border: none;"> <tr> <td style="width:50%;"></td> <td style="width:30%;">Less than 200 feet</td> <td style="width:20%; text-align: right;">(20 points)</td> </tr> <tr> <td></td> <td>200 feet to 1,000 feet</td> <td style="text-align: right;">(10 points)</td> </tr> <tr> <td></td> <td>Greater than 1,000 feet</td> <td style="text-align: right;">(0 points)</td> </tr> <tr> <td style="border-top: 1px solid black;"></td> <td></td> <td style="text-align: right; border-top: 1px solid black;"><u> 0 </u></td> </tr> </table>		Less than 200 feet	(20 points)		200 feet to 1,000 feet	(10 points)		Greater than 1,000 feet	(0 points)			<u> 0 </u>
	Less than 200 feet	(20 points)											
	200 feet to 1,000 feet	(10 points)											
	Greater than 1,000 feet	(0 points)											
		<u> 0 </u>											
RANKING SCORE (TOTAL POINTS):		<u> 0 </u>											

RECEIVED
JAN 31 2000
OIL CON. DIV.
DIST. 3

Reid A #2

Date Remediation Started: 06/15/1999 Date Completed: 06/15/1999

Remediation Method: Excavation Approx. Cubic Yard 33

(Check all appropriate sections)

Landfarmed Amount Landfarmed (cubic yds) 33

Other _____

Remediation Location: Onsite Offsite _____

(i.e., landfarmed onsite, name and location of offsite facility)

Backfill Material Location: _____

General Description of Remedial Action:

Excavated contaminated soil to a pit size of 16' X 14' X 4' and landfarmed soil onsite within a bermed area at a depth of 6" to 12". Soil was aerated by disking/plowing until soil met regulatory levels.

Ground Water Encountered: No Yes Depth _____

Final Pit Closure Sampling:

Sample Location 5 pt composite-bottom

(if multiple samples, attach sample result and diagram of sample locations and depths.)

Sample depth 4'

Sample date 06/15/1999 Sample time 12:50:00 PM

Sample Results

Benzene (ppm) < 0.1

Total BTEX (ppm) 37.2

Field headspace (ppm) _____

TPH (ppm) 250.00 Method 8015B

Vertical Extent (ft) _____ Risk Analysis form attached Yes No

Ground Water Sample: Yes No (If yes, see attached Groundwater Site Summary Report)

I HEREBY CERTIFY THAT THE INFORMATION ABOVE IS TRUE AND COMPLETE TO THE BEST OF MY KNOWLEDGE AND MY BELIEF

DATE January 24, 2000

SIGNATURE Maureen Gannon

PRINTED NAME **Maureen Gannon**
AND TITLE **Project Manager**

Reid A #2
 (L) 1-30N-13W
 Burlington
 6-15-94 @ 1129
 82° w of 2

N

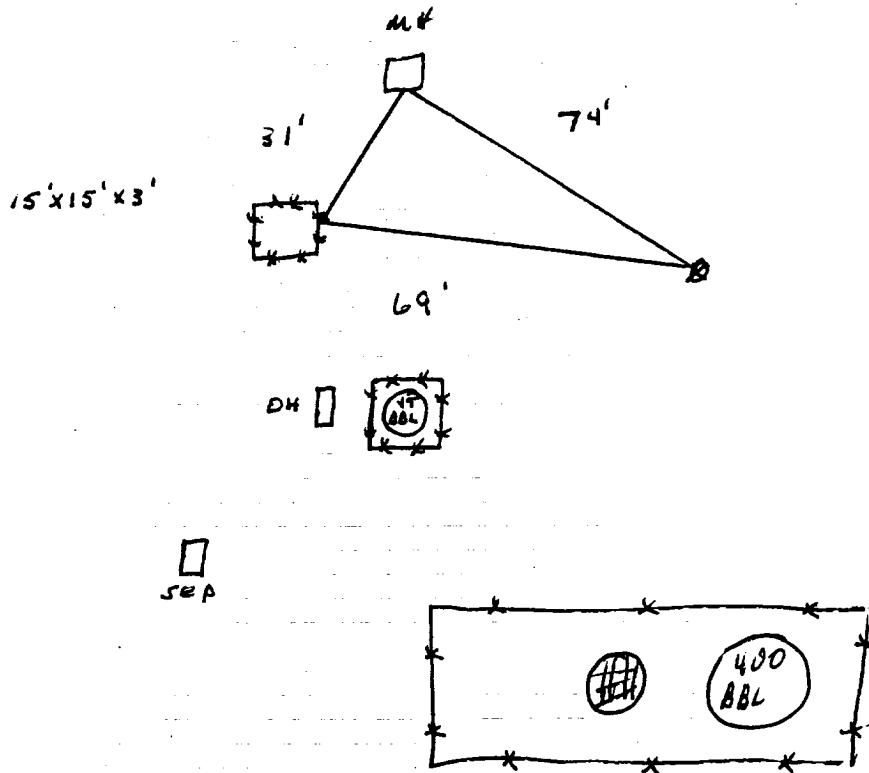

Excavation Sampling

16'(N+S) x 14'(E+W) x 4'(D)

PID Reading

3' - 839 ppm
 4' - 966 ppm

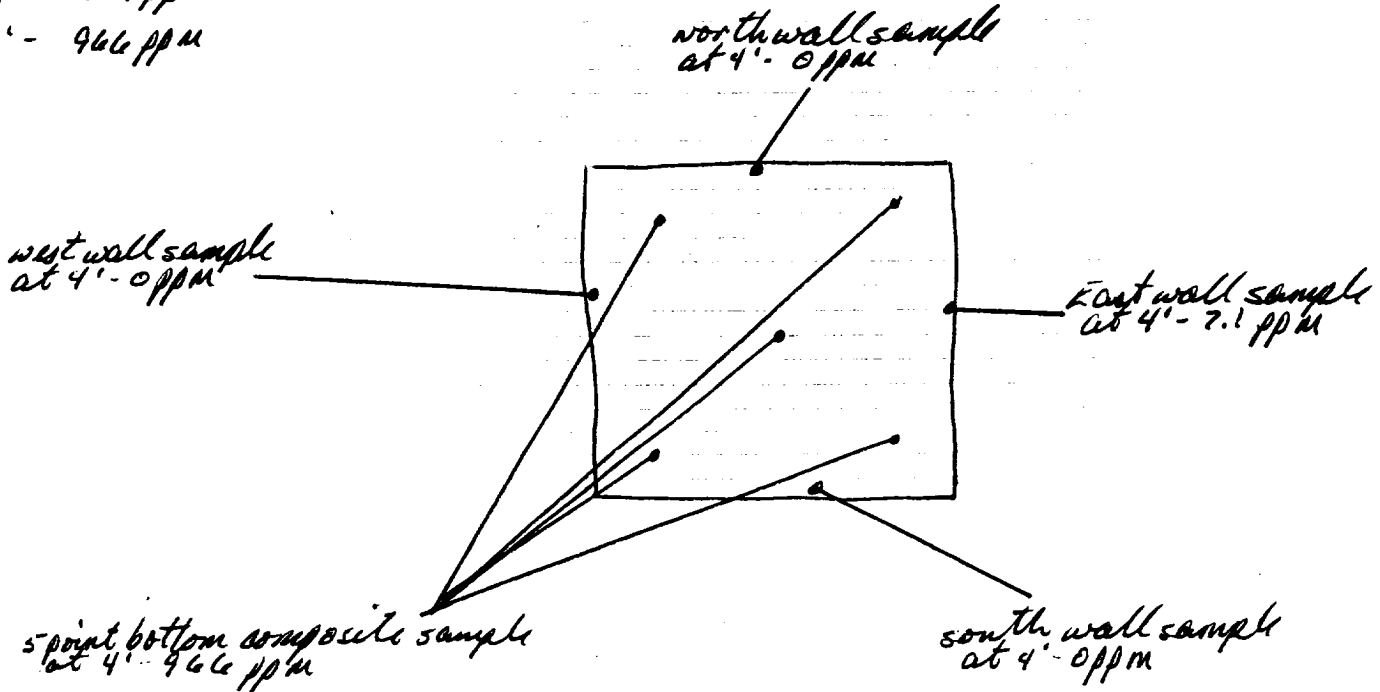

int to coal

OFF: (505) 325-5667



LAB: (505) 325-1556

On Site Technologies, LTD.

Date: 30-Jun-99

CLIENT: PNM - Public Service Company of NM

Project: PNM Pit Remediation

Lab Order: 9906054

CASE NARRATIVE

Samples were analyzed using the methods outlined in the following references:

Test Methods for Evaluating Solid Waste, Physical/Chemical Methods, SW846, 3rd Edition

All method blanks, laboratory spikes, and/or matrix spikes met quality assurance objectives.

RH

OFF: (505) 325-5667



LAB: (505) 325-1556

ANALYTICAL REPORT

Date: 30-Jun-99

Client:	PNM - Public Service Company of NM	Client Sample Info:	Reid A2
Work Order:	9906054	Client Sample ID:	9906151250; 5pt. Bottom Comp
Lab ID:	9906054-08A	Matrix:	SOIL
Project:	PNM Pit Remediation	Collection Date:	6/15/99 12:50:00 PM
		COC Record:	7639

Parameter	Result	PQL	Qual	Units	DF	Date Analyzed
DIESEL RANGE ORGANICS		SW8015B				Analyst: DC
T/R Hydrocarbons: C10-C28	250	25		mg/Kg	1	6/28/99
AROMATIC VOLATILES BY GC/PID		SW8021B				Analyst: DC
Benzene	ND	100		µg/Kg	100	6/24/99
Toluene	2400	200		µg/Kg	100	6/24/99
Ethylbenzene	1000	100		µg/Kg	100	6/24/99
m,p-Xylene	25000	200		µg/Kg	100	6/24/99
o-Xylene	8800	100		µg/Kg	100	6/24/99

37200
37.20 ppm

Qualifiers:

PQL - Practical Quantitation Limit	S - Spike Recovery outside accepted recovery limits
ND - Not Detected at Practical Quantitation Limit	R - RPD outside accepted recovery limits
J - Analyte detected below Practical Quantitation Limit	E - Value above quantitation range
B - Analyte detected in the associated Method Blank	Surr: - Surrogate

OFF: (505) 325-5667



LAB: (505) 325-1556

ANALYTICAL REPORT

Date: 30-Jun-99

Client:	PNM - Public Service Company of NM	Client Sample Info:	Reid A2
Work Order:	9906054	Client Sample ID:	9906151255; 4pt. Wall Comp
Lab ID:	9906054-09A	Matrix:	SOIL
Project:	PNM Pit Remediation	Collection Date:	6/15/99 12:55:00 PM
		COC Record:	7639

Parameter	Result	PQL	Qual	Units	DF	Date Analyzed
DIESEL RANGE ORGANICS		SW8015B				Analyst: DC
T/R Hydrocarbons: C10-C28	ND	25		mg/Kg	1	6/25/99

Qualifiers:

PQL - Practical Quantitation Limit	S - Spike Recovery outside accepted recovery limits
ND - Not Detected at Practical Quantitation Limit	R - RPD outside accepted recovery limits
J - Analyte detected below Practical Quantitation Limit	E - Value above quantitation range
B - Analyte detected in the associated Method Blank	Surr: - Surrogate

Rid AZ LF

↑
N

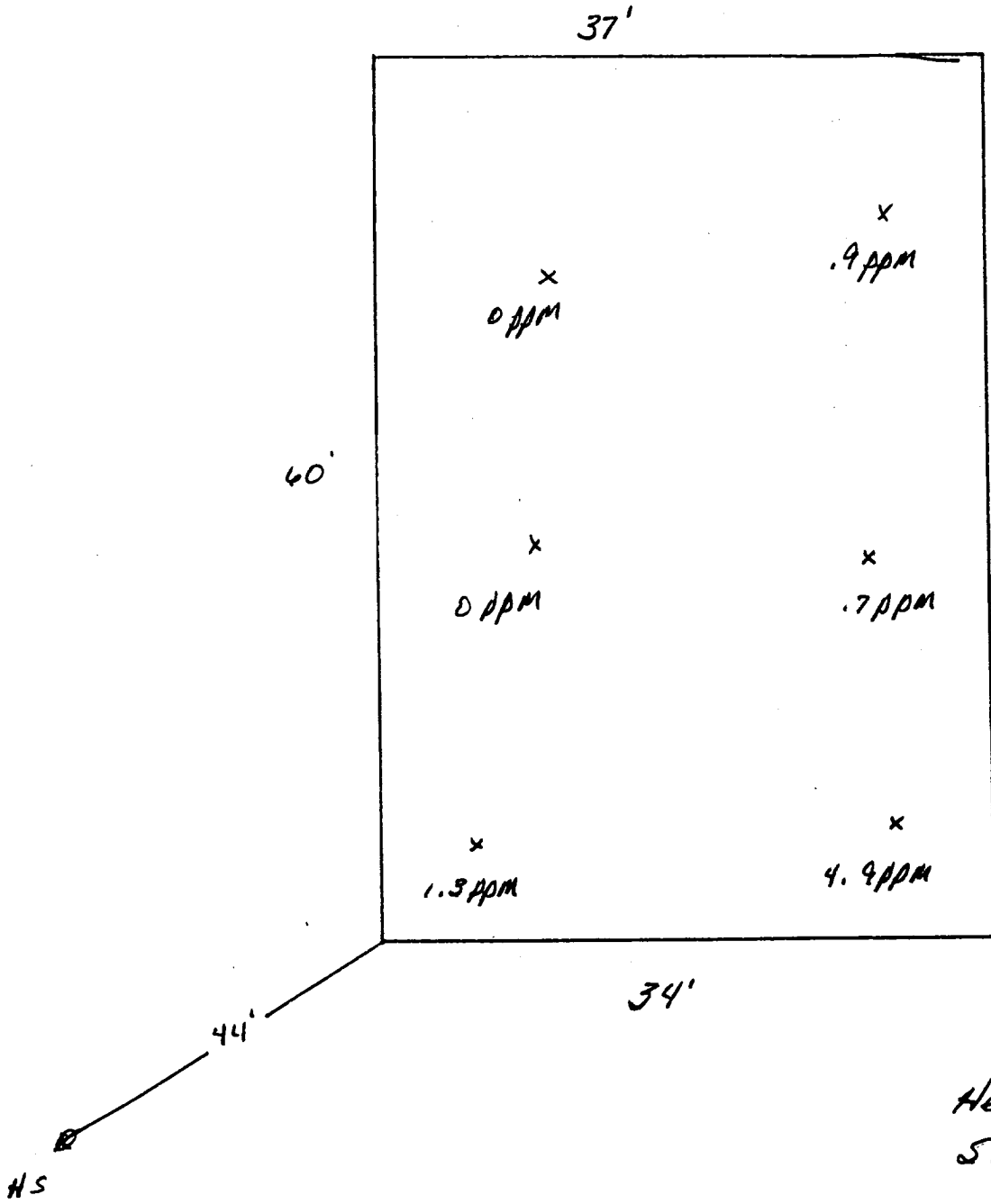

2" - 12"

Head space - 17.5 ppm
Sample # - 4408131316

not to scale

ON SITE

OFF: (505) 325-5667

LAB: (505) 325-1556

TECHNOLOGIES, LTD.

On Site Technologies, LTD.

Date: 20-Aug-99

CLIENT: PNM - Public Service Company of NM
Project: PNM Pit Remediation Landfarms
Lab Order: 9908037

CASE NARRATIVE

Samples were analyzed using the methods outlined in the following references:

Test Methods for Evaluating Solid Waste, Physical/Chemical Methods, SW846, 3rd Edition

All method blanks, laboratory spikes, and/or matrix spikes met quality assurance objectives.

OFF: (505) 325-5667



LAB: (505) 325-1556

ANALYTICAL REPORT

Date: 20-Aug-99

Client:	PNM - Public Service Company of NM	Client Sample Info:	Reid A2 LF
Work Order:	9908037	Client Sample ID:	9908131316; 6pt. Composite
Lab ID:	9908037-04A	Matrix:	SOIL
Project:	PNM Pit Remediation Landfarms	Collection Date:	08/13/1999 1:16:00 PM
		COC Record:	7654

Parameter	Result	PQL	Qual	Units	DF	Date Analyzed
DIESEL RANGE ORGANICS		SW8015B				Analyst: DC
T/R Hydrocarbons: C10-C28	ND	25		mg/Kg	1	08/17/1999

Qualifiers:

- PQL - Practical Quantitation Limit
- ND - Not Detected at Practical Quantitation Limit
- J - Analyte detected below Practical Quantitation Limit
- B - Analyte detected in the associated Method Blank

- S - Spike Recovery outside accepted recovery limits
- R - RPD outside accepted recovery limits
- E - Value above quantitation range
- Surr: - Surrogate