

(SUBMIT IN TRIPLICATE)

UNITED STATES
DEPARTMENT OF THE INTERIOR
GEOLOGICAL SURVEY

Land Office **SF**
Lease No. **079349 C 79439**
Unit **Horseshoe Canyon**

SUNDRY NOTICES AND REPORTS ON WELLS

NOTICE OF INTENTION TO DRILL	<input checked="" type="checkbox"/>	SUBSEQUENT REPORT OF WATER SHUT-OFF	
NOTICE OF INTENTION TO CHANGE PLANS		SUBSEQUENT REPORT OF SHOOTING OR ACIDIZING	
NOTICE OF INTENTION TO TEST WATER SHUT-OFF		SUBSEQUENT REPORT OF ALTERING CASING	
NOTICE OF INTENTION TO RE-DRILL OR REPAIR WELL		SUBSEQUENT REPORT OF RE-DRILLING OR REPAIR	
NOTICE OF INTENTION TO SHOOT OR ACIDIZE		SUBSEQUENT REPORT OF ABANDONMENT	
NOTICE OF INTENTION TO PULL OR ALTER CASING		SUPPLEMENTARY WELL HISTORY	
NOTICE OF INTENTION TO ABANDON WELL			

(INDICATE ABOVE BY CHECK MARK NATURE OF REPORT, NOTICE, OR OTHER DATA)

January 3, 1958

Well No. **7** is located **1673** ft. from **N** line and **1638** ft. from **W** line of sec. **3**
NE SW/4 Sec. 3 **30-N** **16-W** **NMPM**
(1/4 Sec. and Sec. No.) (Twp.) (Range) (Meridian)
Horseshoe Canyon **San Juan** **New Mexico**
(Field) (County or Subdivision) (State or Territory)

The elevation of the derrick floor above sea level is **3643** ft.

DETAILS OF WORK

(State names of and expected depths to objective sands; show sizes, weights, and lengths of proposed casings; indicate mudding jobs, cementing points, and all other important proposed work)

It is intended to drill a well using rotary tools and mud circulation through the Gallup Formation. Production casing will be set and possible productive intervals will be perforated and fractured.

Estimated Total Depth 1670'.

Casing Program:

8-5/8" at 100' with 125 sacks cement circulated to surface.

5-1/2" at 1670' with 100 sacks cement.

The NE SW/4 of Section 3 is dedicated to this well.

NE SW/4 Section 3 SF-079439

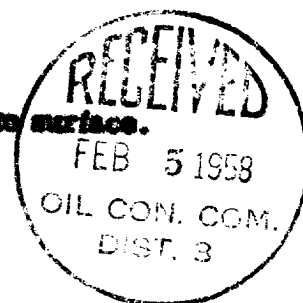

I understand that this plan of work must receive approval in writing by the Geological Survey before operations may be commenced.

Company **El Paso Natural Gas Products Company**

Address **Post Office Box 1568**

Farmington, New Mexico

ORIGINAL SIGNED BY: JOSEPH E. KREGER

By

Title **Petroleum Engineer**

NEW MEXICO OIL CONSERVATION COMMISSION

Well Location and Acreage Dedication Plat

Section A.

Date January 31, 1958

Operator El Paso Natural Gas Products Company Lease Horseshoe Canyon SF - 079439
Well No. 7 Unit Letter K Section 3 Township 30 North Range 16 West NMPM
Located 1673 Feet From South Line, 1628 Feet From West Line
County San Juan G. L. Elevation 5633 Dedicated Acreage 40 Acres
Name of Producing Formation Gallup Pool Horseshoe-Gallup 141

1. Is the Operator the only owner* in the dedicated acreage outlined on the plat below?
Yes x No
2. If the answer to question one is "no," have the interests of all the owners been consolidated by communitization agreement or otherwise? Yes No . If answer is "yes,"
Type of Consolidation
3. If the answer to question two is "no," list all the owners and their respective interests below:

Owner

Land Description

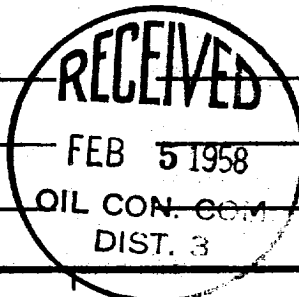

Section. B

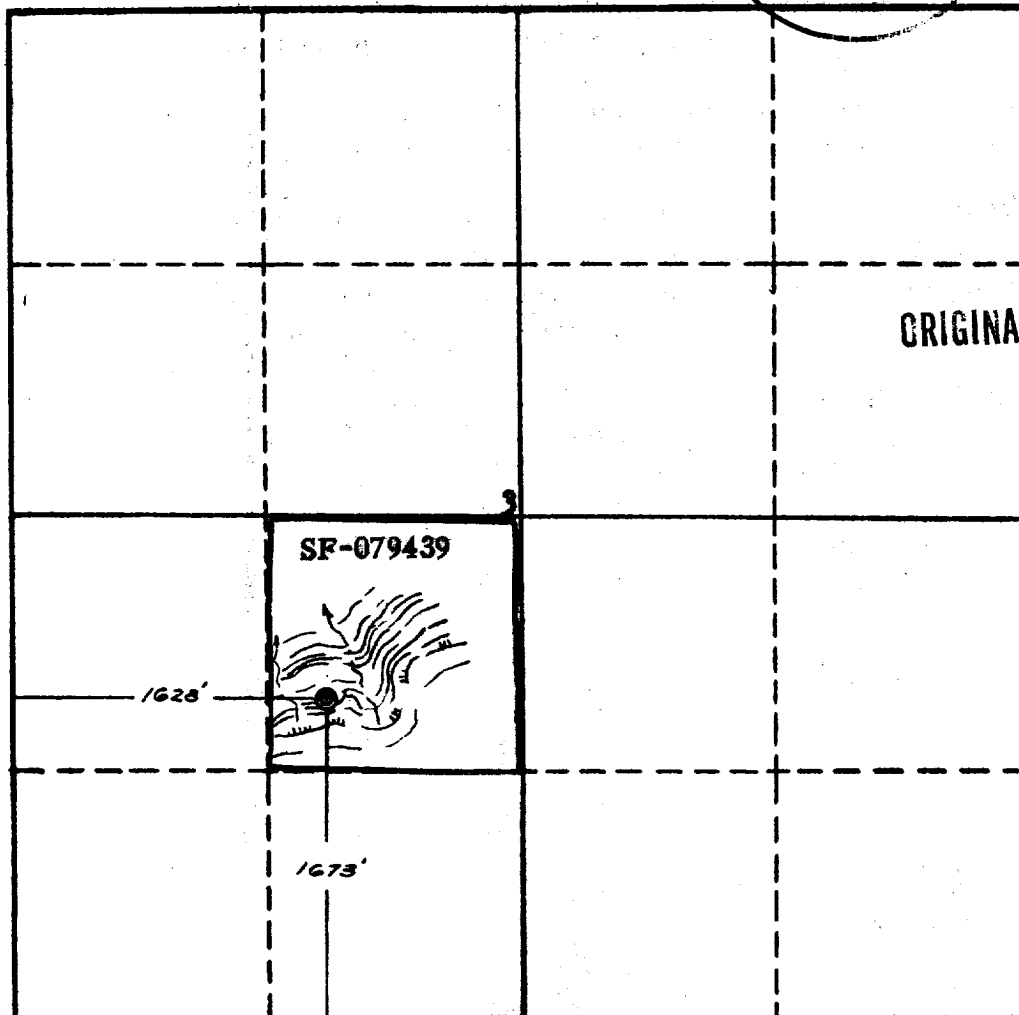

This is to certify that the information in Section A above is true and complete to the best of my knowledge and belief.

El Paso Natural Gas Products Co.

ORIGINAL SIGNED BY: (Operator) JOSEPH E. KREGER

(Representative)

Box 1565, Farmington, New Mexico

Address

This is to certify that the well location shown on the plat in Section A was located from field notes of actual surveys made by me or under my supervision and that the same is true to the best of my knowledge and belief.

Date Surveyed Jan. 28, 1958

Ernest V. Echhawk
Ernest V. Echhawk
Registered Land Surveyor.

Certificate No. 1545

